

- NOTES:
1. THE CONTRACTOR SHALL PRESERVE AND REPLACE ALL EXISTING STREET SIGNS AND THEIR SUPPORTS AS NEAR AS POSSIBLE TO THEIR ORIGINAL LOCATION OR AS DETERMINED BY THE ENGINEER. THIS WORK SHALL BE INCIDENTAL TO THE CONTRACT. DAMAGE AS A RESULT OF CONSTRUCTION OPERATIONS SHALL BE REPAIRED OR REPLACED AT THE CONTRACTOR'S EXPENSE.
  2. ALL NEW SIGNS ARE TO BE DIAMOND GRADE REFLECTIVITY.
  3. ALL SIGNS SHALL BE OF CONVENTIONAL ROADS SIZE AS INDICATED IN THE LATEST VERSION OF THE MUTCD UNLESS OTHERWISE NOTED.

F.A.U. ROUTE NO.	SECTION	COUNTY	TOTAL SHEETS	SHEET NO.
2774	99-00073-00-WR	COOK	116	60
STA.	TO STA.			
FED. ROAD DIST. NO. 1	ILLINOIS	FED AID PROJECT		
		CMM-7003 (750)		

CONTRACT NO. 83727

SCHEDULE OF LANDSCAPING PLANTINGS		
CHANCELLOR LINDEN	EACH	2
THORNLESS COMMON HONEYLOCUST	EACH	1

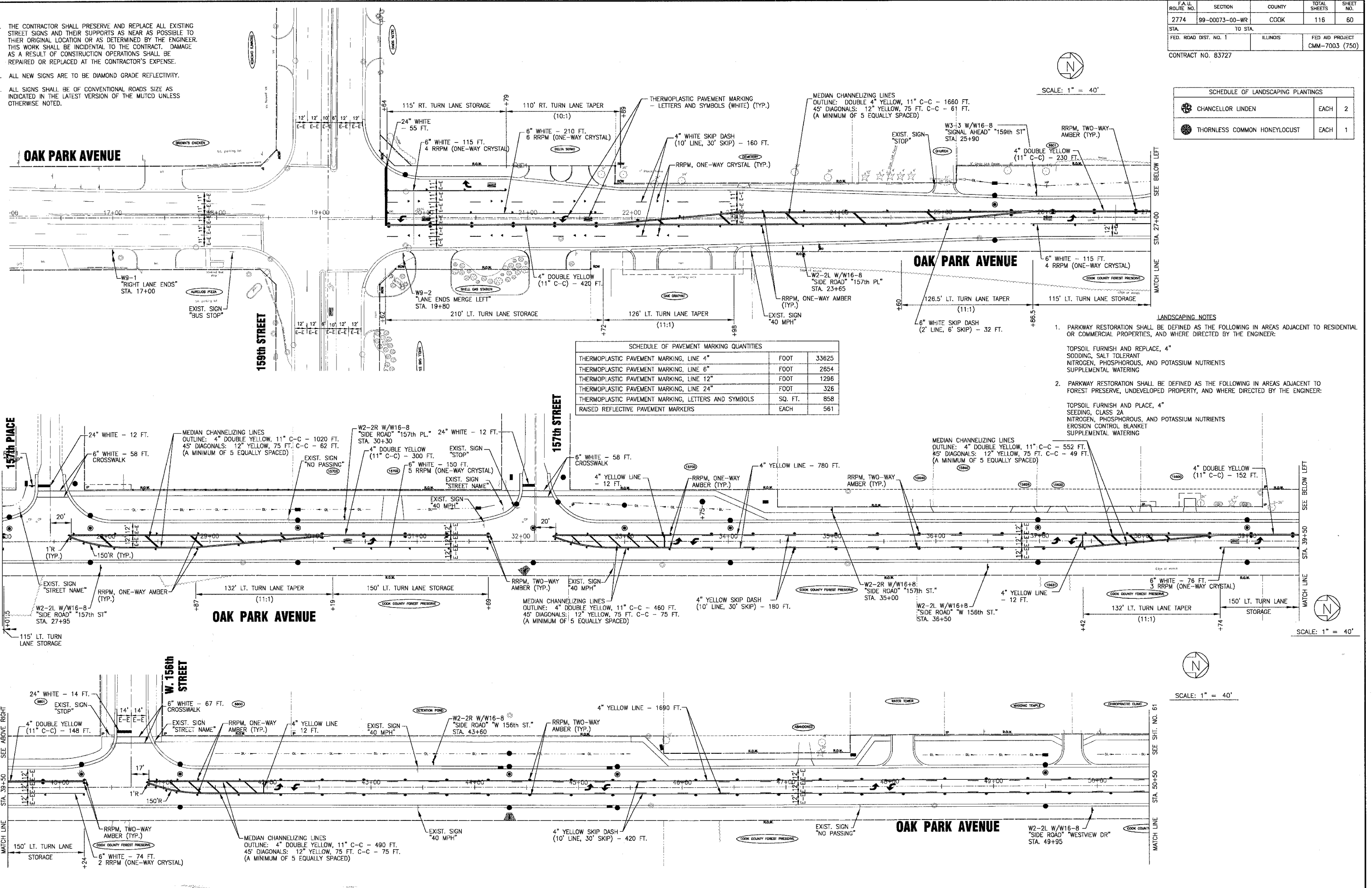

SCHEDULE OF PAVEMENT MARKING QUANTITIES		
THERMOPLASTIC PAVEMENT MARKING, LINE 4"	FOOT	33625
THERMOPLASTIC PAVEMENT MARKING, LINE 6"	FOOT	2854
THERMOPLASTIC PAVEMENT MARKING, LINE 12"	FOOT	1296
THERMOPLASTIC PAVEMENT MARKING, LINE 24"	FOOT	326
THERMOPLASTIC PAVEMENT MARKING, LETTERS AND SYMBOLS	SQ. FT.	858
RAISED REFLECTIVE PAVEMENT MARKERS	EACH	561

SCALE: 1" = 40'

- LANDSCAPING NOTES
1. PARKWAY RESTORATION SHALL BE DEFINED AS THE FOLLOWING IN AREAS ADJACENT TO RESIDENTIAL OR COMMERCIAL PROPERTIES, AND WHERE DIRECTED BY THE ENGINEER:  
TOPSOIL FURNISH AND REPLACE, 4" SODDING, SALT TOLERANT NITROGEN, PHOSPHOROUS, AND POTASSIUM NUTRIENTS SUPPLEMENTAL WATERING
  2. PARKWAY RESTORATION SHALL BE DEFINED AS THE FOLLOWING IN AREAS ADJACENT TO FOREST PRESERVE, UNDEVELOPED PROPERTY, AND WHERE DIRECTED BY THE ENGINEER:  
TOPSOIL FURNISH AND PLACE, 4" SEEDING, CLASS 2A NITROGEN, PHOSPHOROUS, AND POTASSIUM NUTRIENTS EROSION CONTROL BLANKET SUPPLEMENTAL WATERING

SCALE: 1" = 40'

Land Projects 2001\WORK\BAM-DWGS\OAKPARK\2014-06-16-STR.P.dwg  
 Plotter: 24336536825-642 By: JLUK  
 Date: 6/23/14  
 Project: Oak Park Avenue  
 Drawing: Landscaping  
 Scale: 4"=30'-05"

CONSULTANTS	REV	DATE	DESCRIPTION
	1	4-28-06	PER IDOT AND COOK COUNTY COMMENTS

\* - REFER TO EQUIPMENT MANUFACTURER'S SHOP DRAWINGS

**BAKSTER & WOODMAN**  
 Consulting Engineers

*Baxter & Woodman*  
 Crystal Lake, Illinois 815.469.1260  
 Burlington, Wisconsin 262.763.7851  
 Mokena, Illinois 708.478.2030  
 DeKalb, Illinois 815.797.9111  
 Crystal Lake, Illinois 847.233.5088  
 Rockford, Illinois 815.469.1651  
 Plainfield, Illinois 815.609.7425

**CITY OF OAK FOREST, ILLINOIS**  
**OAK PARK AVENUE PROJECT**

**PAVEMENT MARKING, SIGNAGE AND LANDSCAPING PLAN ON OAK PARK AVENUE**  
 STA. 16+00 TO STA. 50+50

DESIGNED BY	NJP	SCALE	HORIZ: 1"=40'
DRAWN BY	UKB	PROJECT NO.	020146
CHECKED BY	NJP	SHEET NO.	60 OF 116
DATE	1-20-05		