

P.A.L. NO.	SECTION	COUNTY	SHEET NO.	SHEET TOTAL
2774	99-00073-00-WF	COOK	116	91
STA.	TO STA.			
FED. ROAD DIST. NO.	BUILDING	FED. AID PROJECT		
CONTRACT NO.: 83727		CMM-7003 (750)		

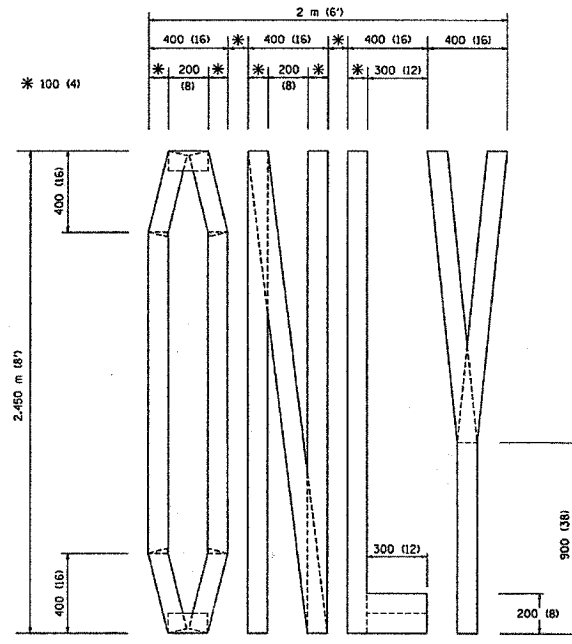

QUANTITY  
 100 (4) LINE = 19.7 m (64.1 ft.)  
 1.97 sq. m (21.1 sq. ft.)

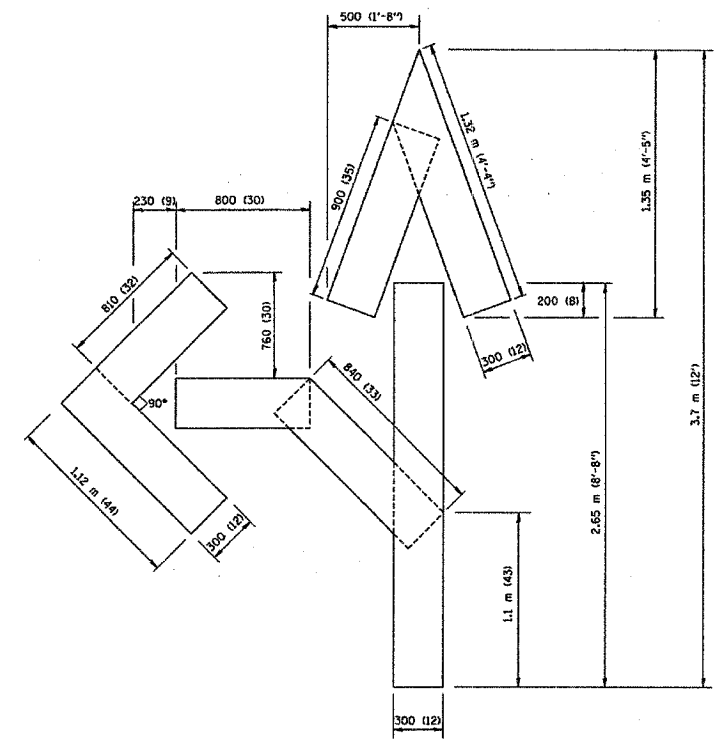

QUANTITY  
 100 (4) LINE = 25.3 m (82.5 ft.)  
 2.53 sq. m (27.5 sq. ft.)

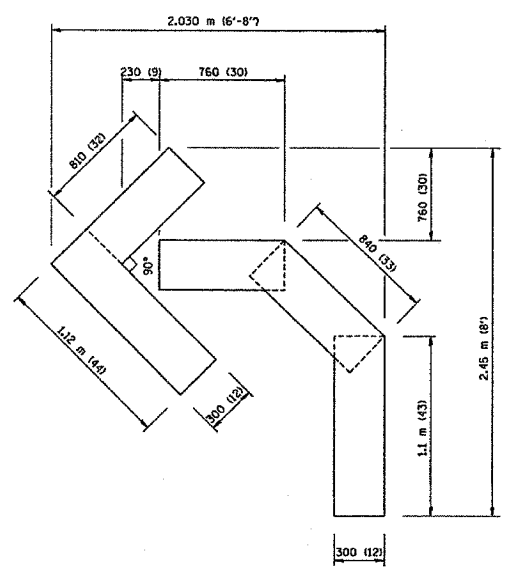

QUANTITY  
 100 (4) LINE = 13.9 m (45.5 ft.)  
 1.39 sq. m (15.2 sq. ft.)

All dimensions are in millimeters (inches) unless otherwise shown.

ILLINOIS DEPARTMENT OF TRANSPORTATION	
<b>PAVEMENT MARKING LETTERS AND SYMBOLS FOR TRAFFIC STAGING</b>	
SCALE: NONE	DRAWN BY CADD
DATE 10/18/2002	CHECKED BY
	TC-16
	REVISION DATE: 08/28/00

REVISIONS	
NAME	DATE
T. RAMMACHER	09/18/94
J. OBERLIE	06/01/96
T. RAMMACHER	06/05/96
T. RAMMACHER	11/04/97
T. RAMMACHER	03/02/98
E. GOMEZ	08/28/00

Friday, October 18, 2006 10:02:21 AM  
 C:\Program Files\Autodesk\AutoCAD 2006\Projects\Jctns\PAVEMENT\TTC16.dwg LV+35,63  
 VHTC

Copyright © 2004, T.T. Baker, Inc. & Associates, Inc.  
 All rights reserved. No part of this publication may be reproduced, stored in a retrieval system, or transmitted, in any form or by any means, electronic, mechanical, photocopying, recording, or by any information storage and retrieval system, without the prior written permission of T.T. Baker, Inc. & Associates, Inc.