

F.A. RTE.	SECTION	COUNTY	TOTAL SHEETS	SHEET NO.
2774	00-0073-00-WR	COOK	116	93A
STA.	TO STA.			
FED. ROAD DIST. NO.	ILLINOIS	FED. AID PROJECT		
CONTRACT NO.: 83727	CMM-7003 (750)			

ROUTE MARKERS

FOR U.S. ROUTES MI-40-2424

FOR ILLINOIS ROUTES MI-50-2424

R.R. UNMARKED ROUTES SPECIAL 24" x 18" VARIABLE 4" BLACK LETTERS ON WHITE REFLECTIVE BACKGROUND

ARROWS SIGNS

M5-1L-2115

M5-1R-2115

M6-1L-2115

M6-1R-2115

M6-3-2115

CARDINAL DIRECTION & DETOUR SIGNS

NORTH M3-1-219

EAST M3-2-219

SOUTH M3-3-219

WEST M3-4-219

DETOUR MI-7-219

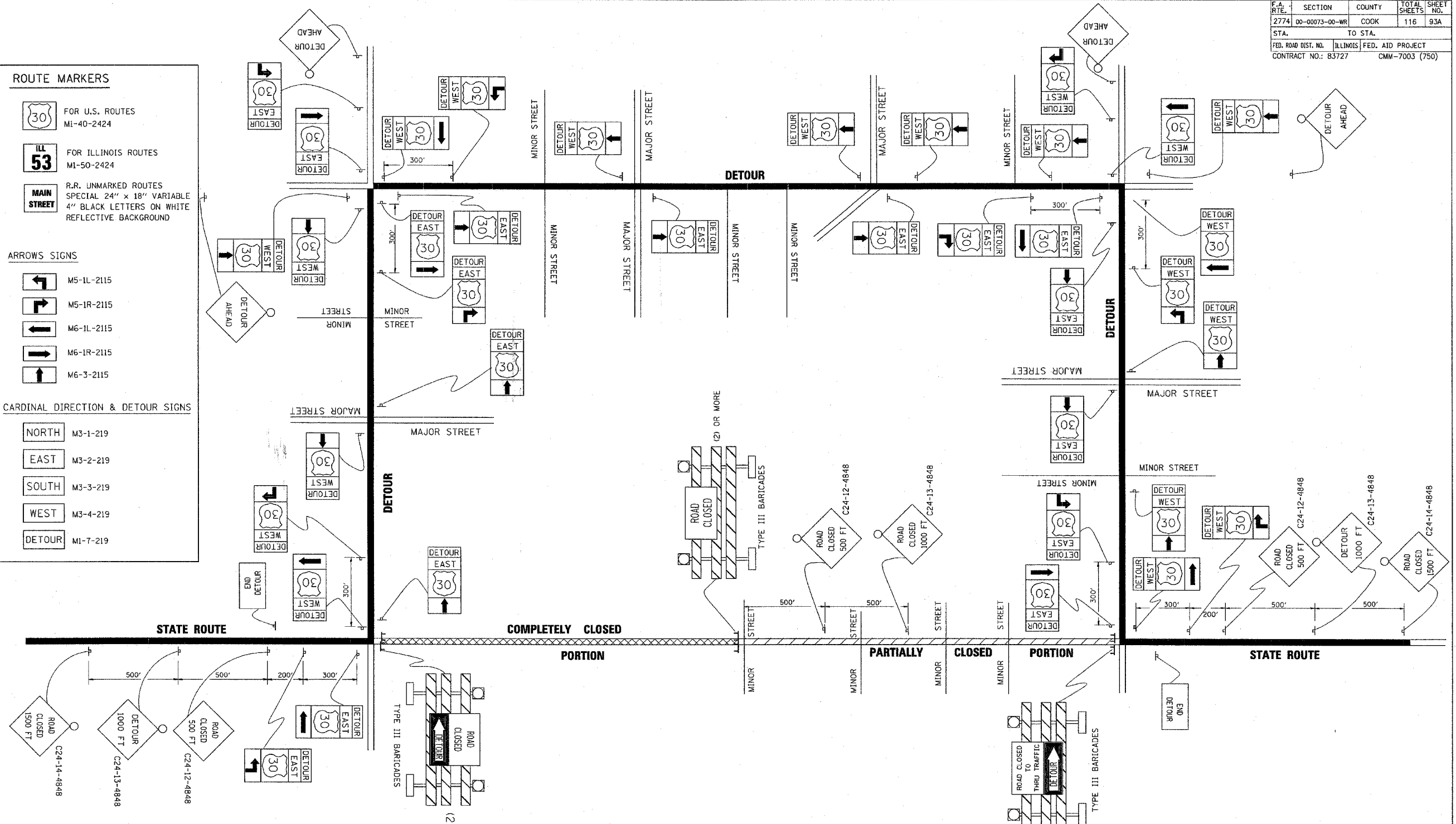

REVISIONS	
NAME	DATE

ILLINOIS DEPARTMENT OF TRANSPORTATION

TYPICAL MARKING FOR CLOSING STATE HIGHWAYS

SCALE: NONE DRAWN BY

DATE: **DATE** CHECKED BY

TC-21

NOT TO SCALE
 DATE: 04/06
 DRAWN BY: J. B. BAKER & ASSOCIATES, INC.
 1100 N. WILSON AVENUE, SUITE 100, DEERFIELD, IL 60015
 TEL: 847-470-0800 FAX: 847-470-0801
 WWW: WWW.JBBANDASSOCIATES.COM