

F.A.U. ROUTE NO.	SECTION	COUNTY	TOTAL SHEETS	SHEET NO.
2774	99-00073-00-WR	COOK	116	104
STA.	TO STA.	ILLINOIS	FED AID PROJECT	
FED. ROAD DIST. NO. 1			CMM-7003 (750)	
CONTRACT NO. 83727				

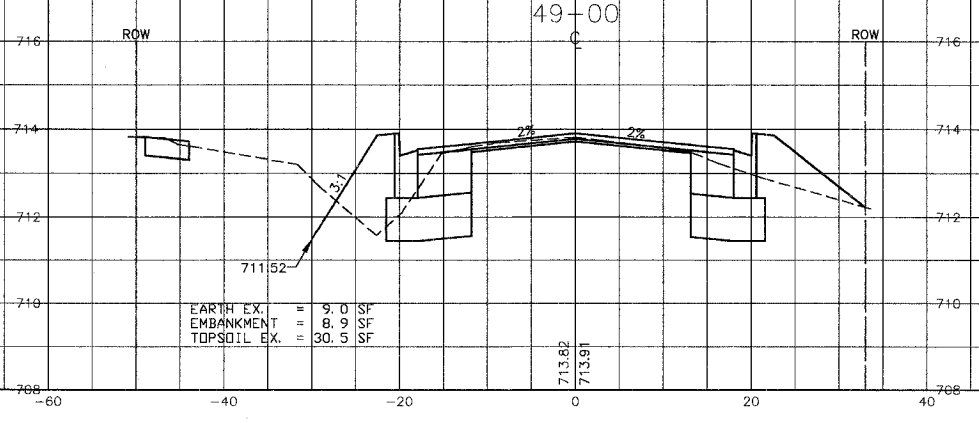
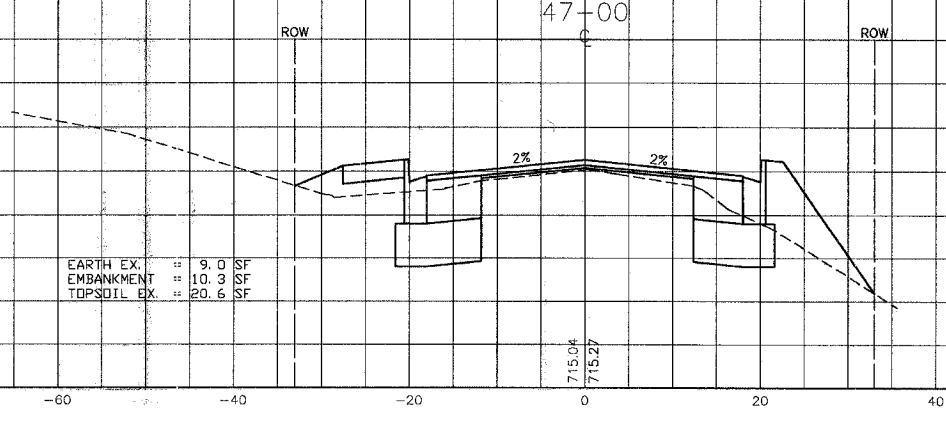
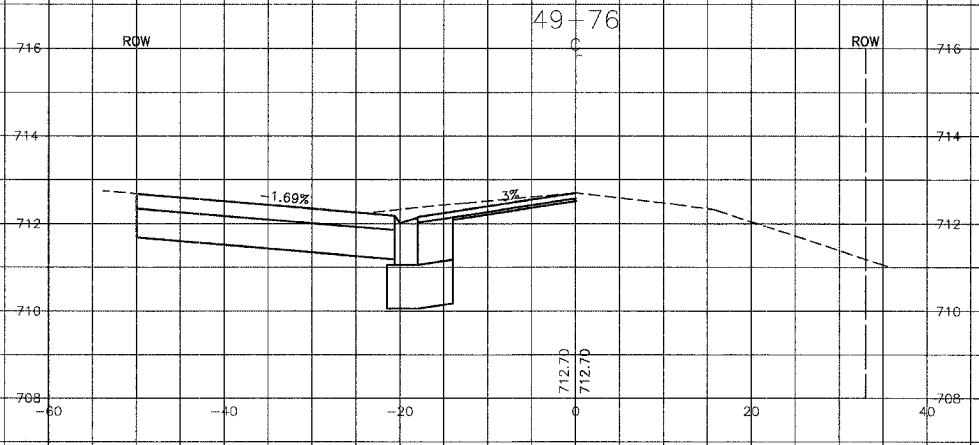
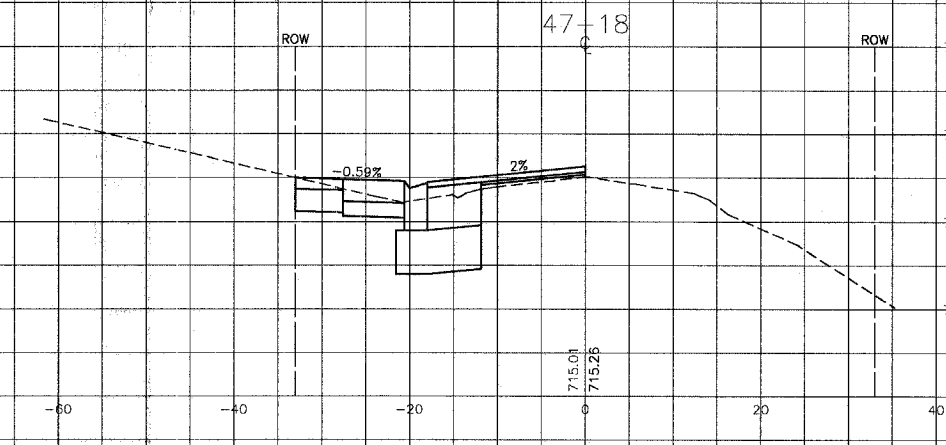
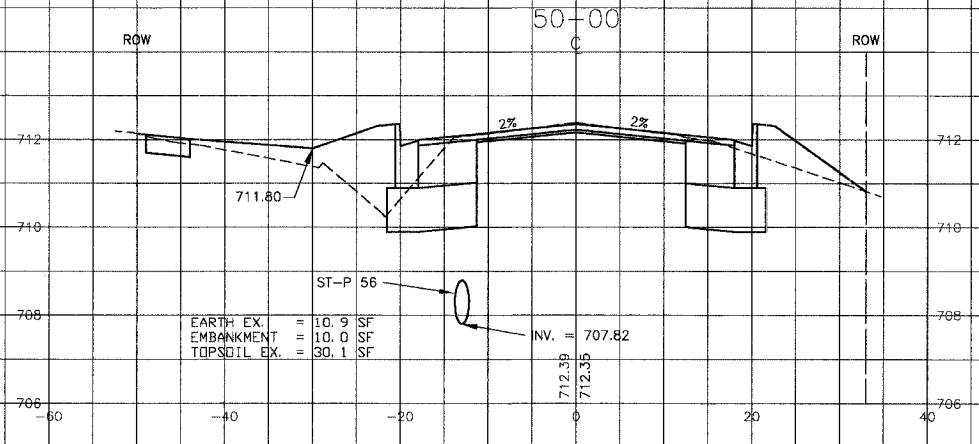
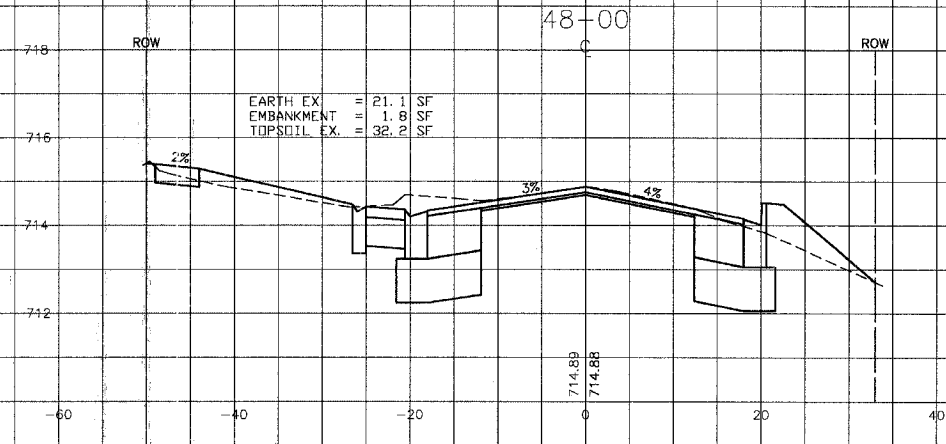
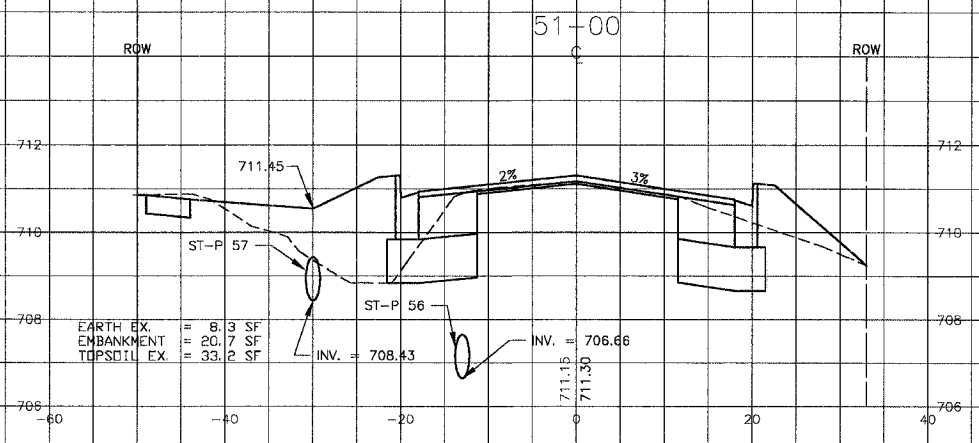
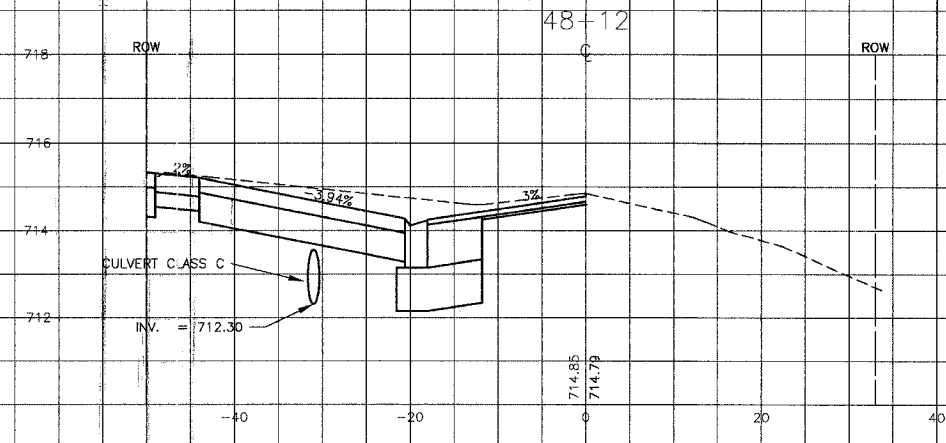

EARTH EX. = 21.1 SF  
 EMBANKMENT = 1.8 SF  
 TOPSOIL EX. = 32.2 SF

EARTH EX. = 8.3 SF  
 EMBANKMENT = 20.7 SF  
 TOPSOIL EX. = 33.2 SF

EARTH EX. = 10.9 SF  
 EMBANKMENT = 10.0 SF  
 TOPSOIL EX. = 30.1 SF

EARTH EX. = 9.0 SF  
 EMBANKMENT = 10.3 SF  
 TOPSOIL EX. = 20.6 SF

EARTH EX. = 9.0 SF  
 EMBANKMENT = 8.9 SF  
 TOPSOIL EX. = 30.5 SF

I:\OAKF\020146\Drawings\OAKF\47-51.dwg  
 Plotted: 4-30-06 @ 12:23pm By: 23 luk  
 Copyright © 2004, by Baxter & Woodman, Inc.  
 State of Illinois - Professional Design Firm  
 License No. - 184-001121 - Expires 4-30-05

CONSULTANTS	REV. NO.	DATE	DESCRIPTION
	1	4-28-06	PER IDOT AND COOK COUNTY COMMENTS

\* - REFER TO EQUIPMENT MANUFACTURER'S SHOP DRAWINGS

**Baxter & Woodman**  
 Crystal Lake, Illinois 815.439.1260  
 Burlington, Wisconsin 262.763.7931  
 Mokena, Illinois 708.478.2090  
 DeKalb, Illinois 815.787.3111  
 Graylake, Illinois 847.253.5089  
 Rockford, Illinois 815.489.1551  
 Plainfield, Illinois 815.609.7425

**CITY OF OAK FOREST, ILLINOIS**  
**OAK PARK AVENUE PROJECT**

**CROSS SECTIONS**  
**OAK PARK AVENUE**  
**STA. 47+00 TO STA. 51+00**

DESIGNED BY	SCALE	VERT: 1"=2'
PAW	HORIZ: 1"=10'	
DRAWN BY	PROJECT NO.	020146
UKB	SHEET NO.	
CHECKED BY		
NJP		
DATE		
1-20-05		<b>104 OF 116</b>