

F.A.U. ROUTE NO.	SECTION	COUNTY	TOTAL SHEETS	SHEET NO.
2774	99-00073-00-WR	COOK	116	114
STA.	TO STA.		FED AID PROJECT	
FED. ROAD DIST. NO. 1	ILLINOIS		CMM-7003 (750)	
CONTRACT NO. 83727				

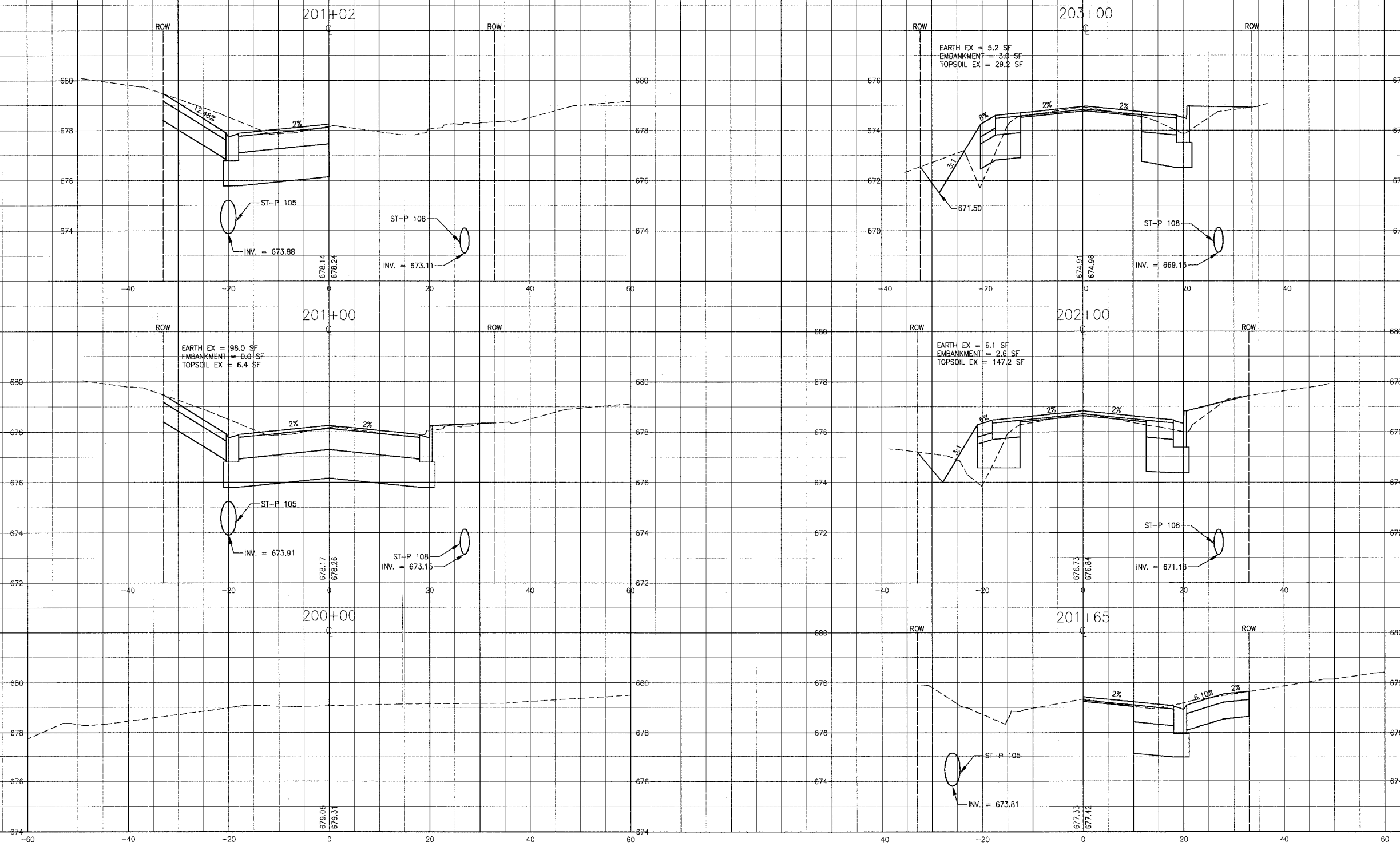

I:\OAKF\20146\DWG\JUSTAMERE-AS.dwg  
 Plotted: 5-28-06 @ 1:32pm By: 354njp  
 Copyright © 2004, By Baxter & Woodman, Inc.  
 State of Illinois - Professional Design Firm  
 License No. - 184-001121 Expires 4-30-05

CONSULTANTS	REV. NO.	DATE	DESCRIPTION
	1	4-28-06	PER IDOT AND COOK COUNTY COMMENTS
	2	5-8-06	PER IDOT COMMENTS

\* - REFER TO EQUIPMENT MANUFACTURER'S SHOP DRAWINGS

**Baxter & Woodman**  
 Crystal Lake, Illinois 815.459.1300  
 Burlington, Wisconsin 262.763.7854  
 Mobern, Illinois 708.478.2080  
 DeKalb, Illinois 815.787.3111  
 Crystal Lake, Illinois 847.223.5088  
 Rockford, Illinois 815.489.1551  
 Plainfield, Illinois 815.609.7425

**CITY OF OAK FOREST, ILLINOIS**  
**OAK PARK AVENUE PROJECT**

**CROSS SECTIONS**  
**JUSTAMERE ROAD**  
**STA. 200+00 TO STA. 203+00**

DESIGNED BY PAW	SCALE VERT: 1"=2'
DRAWN BY UKR	HORIZ: 1"=10'
CHECKED BY LDH	PROJECT NO. 020146
DATE 1-20-05	SHEET NO. 114 OF 116