

FILE NO.	SECTION	COUNTY	TOTAL SHEETS	SHEET NO.
3809	05-00050-00-CH	DUPAGE	36	9
PAVEMENT MARKING AND SIGNING PLAN				
FED. ROAD DISTRICT 7	ILLINOIS	FED. AID PROJECT F-0021(068)		

CONTRACT NO. 83852

- ① STA. 24+65, 26' RT
INSTALL SIGN R3-Bb-4530
- ② STA. 27+06, 6' LT
REMOVE SIGN PANEL ASSEMBLY - TYPE A
- ③ STA. 27+71, 8' LT
REMOVE SIGN PANEL ASSEMBLY - TYPE A
- ④ STA. 49+03, 39' RT
EXISTING SIGN TO REMAIN
- ⑤ STA. 50+14, 33' LT
EXISTING SIGN TO REMAIN
- ⑥ STA. 51+00, 19' LT
INSTALL SIGN R3-Bb-4530
- ⑦ STA. 51+93, 29' RT
EXISTING SIGN TO REMAIN

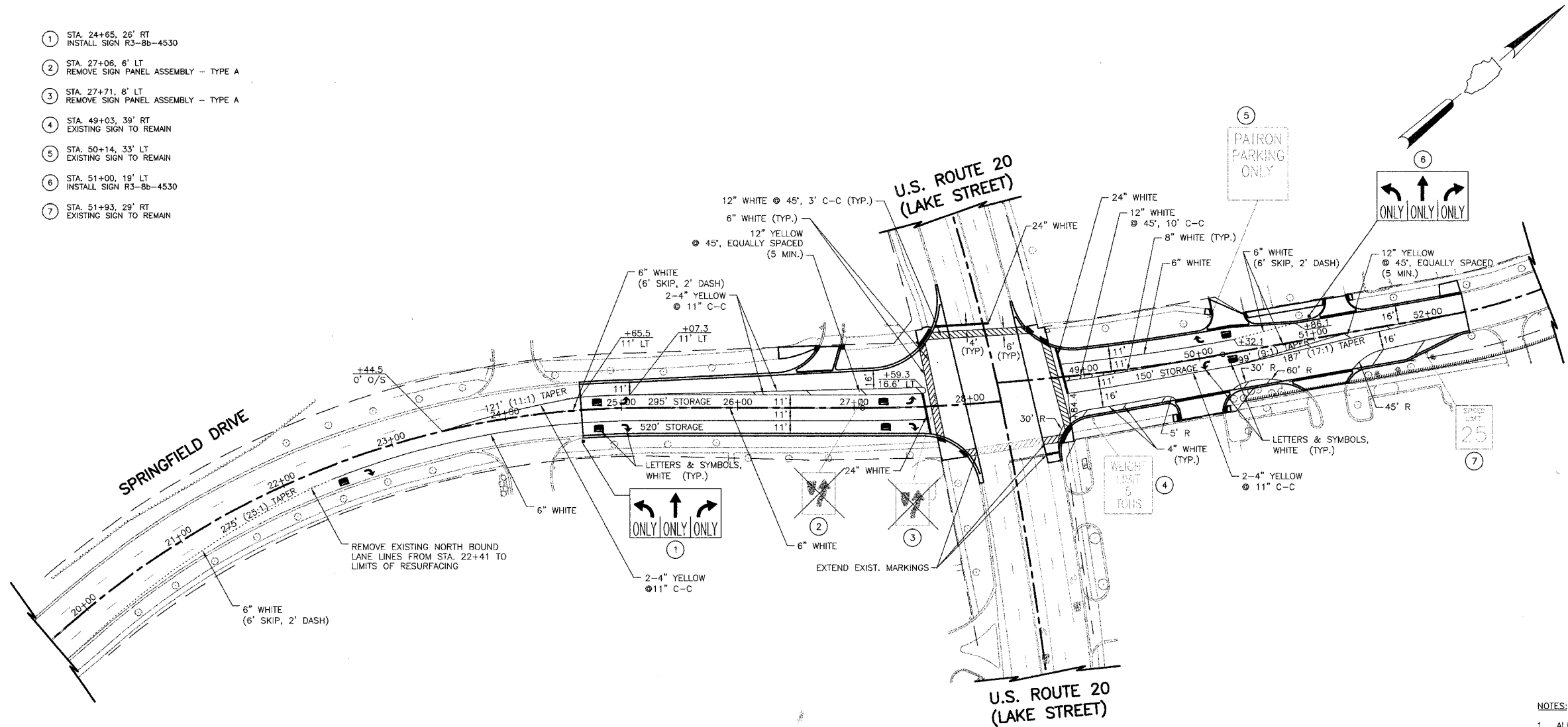

- NOTES:
- ALL PAVEMENT MARKINGS SHALL BE THERMOPLASTIC.
 - LARGE LETTERS AND SYMBOLS SHALL BE USED FOR LEFT AND RIGHT TURN ONLY MARKINGS.

REVISIONS	
NAME	DATE

ILLINOIS DEPARTMENT OF TRANSPORTATION

PAVEMENT MARKING AND SIGNING PLAN

SPRINGFIELD DRIVE

SCALE IN FEET

50 0 50

DRAWN BY: KRK
CHECKED BY: JRV
DATE: 04/04/06