

F.A.U. RTE.	SECTION	COUNTY	TOTAL SHEETS	SHEET NO.
3809	05-00050-00-CH	DUPAGE	36	31
INTERCONNECT SCHEMATIC AND SCHEDULE OF QUANTITIES				
FED. ROAD DISTRICT NO. 7	ILLINOIS	FED. AID PROJECT F-0021(066)		

CONTRACT NO. 83852

INTERCONNECT SCHEDULE OF QUANTITIES

DESCRIPTION	UNIT	QNTY.
CONDUIT IN TRENCH, 2" DIA., GALVANIZED STEEL	FOOT	465
CONDUIT PUSHED, 2" DIA., GALVANIZED STEEL	FOOT	70
TRENCH AND BACKFILL FOR ELECTRICAL WORK	FOOT	465
DRILL EXISTING HANDHOLE	EACH	1
REMOVE ELECTRIC CABLE FROM CONDUIT	FOOT	2223
ELECTRIC CABLE IN CONDUIT, TRACER, NO.14 1 C	FOOT	2330
FIBER OPTIC CABLE IN CONDUIT, NO. 62.5/125, MM12F & SM12F	FOOT	2354
REMOVE FIBER OPTIC CABLE FROM CONDUIT	FOOT	1778
RE-OPTIMIZE TRAFFIC SIGNAL SYSTEM	L SUM	1

INTERCONNECT SCHEMATIC LEGEND

- EXISTING INTERSECTION CONTROLLER
- PROPOSED INTERSECTION CONTROLLER
- EXISTING MASTER CONTROLLER
- PROPOSED MASTER CONTROLLER
- MASTER MASTER CONTROLLER
- EXISTING INTERSECTION & SAMPLING (SYSTEM) DETECTORS
- PROPOSED INTERSECTION & SAMPLING (SYSTEM) DETECTORS
- EXISTING INTERSECTION DETECTORS
- PROPOSED SAMPLING (SYSTEM) DETECTORS
- EXISTING SAMPLING (SYSTEM) DETECTORS
- PROPOSED SAMPLING (SYSTEM) DETECTORS
- EXISTING SAMPLING (SYSTEM) DETECTORS PROPOSED INTERSECTION AND SAMPLING (SYSTEM) DETECTORS
- EXISTING SAMPLING (SYSTEM) DETECTORS PROPOSED SAMPLING (SYSTEM) DETECTORS
- EXISTING PREFORMED INTERSECTION & SAMPLING (SYSTEM) DETECTORS
- PROPOSED PREFORMED INTERSECTION & SAMPLING (SYSTEM) DETECTORS
- EXISTING SAMPLING (SYSTEM) PREFORMED DETECTORS
- PROPOSED SAMPLING (SYSTEM) PREFORMED DETECTORS
- EXISTING FIBER OPTIC CABLE IN CONDUIT, NO. 62.5/125, MM12F SM12F
- PROPOSED FIBER OPTIC CABLE IN CONDUIT, NO. 62.5/125, MM12F SM12F
- EXISTING INTERCONNECT CABLE - NO. 62.5/125 12F FIBER OPTIC CABLE
- PROPOSED INTERCONNECT CABLE - NO. 62.5/125 12F FIBER OPTIC CABLE
- EXISTING INTERCONNECT CABLE - NO. 18 3 PAIR TWISTED, SHIELDED
- PROPOSED INTERCONNECT CABLE - NO. 18 3 PAIR TWISTED, SHIELDED
- EXISTING LOOP DETECTOR CABLE - 2/C TWISTED, SHIELDED
- PROPOSED LOOP DETECTOR CABLE - 2/C TWISTED, SHIELDED
- EXISTING ELECTRIC CABLE 1/C (AS SPECIFIED)
- PROPOSED ELECTRIC CABLE 1/C (AS SPECIFIED)
- EXISTING TELEPHONE CONNECTION
- PROPOSED TELEPHONE CONNECTION

THE TRAFFIC SIGNAL CONTROLLER EQUIPMENT FOR THIS PROJECT SHALL BE "EAGLE" BRAND TO MATCH THE EXISTING ADJACENT SYSTEM.

VILLAGE OF SCHAUMBURG
INTERCONNECT SCHEMATIC SCHEDULE OF QUANTITIES
 U.S. RTE. 20 (LAKE ST.)
 BARTLETT ROAD TO SPRINGFIELD DRIVE

REVISIONS	
NAME	DATE

NOT TO SCALE
 DATE: 4/04/2006
 DRAWN BY: CJT
 DESIGNED BY: CJT
 CHECKED BY: JUE

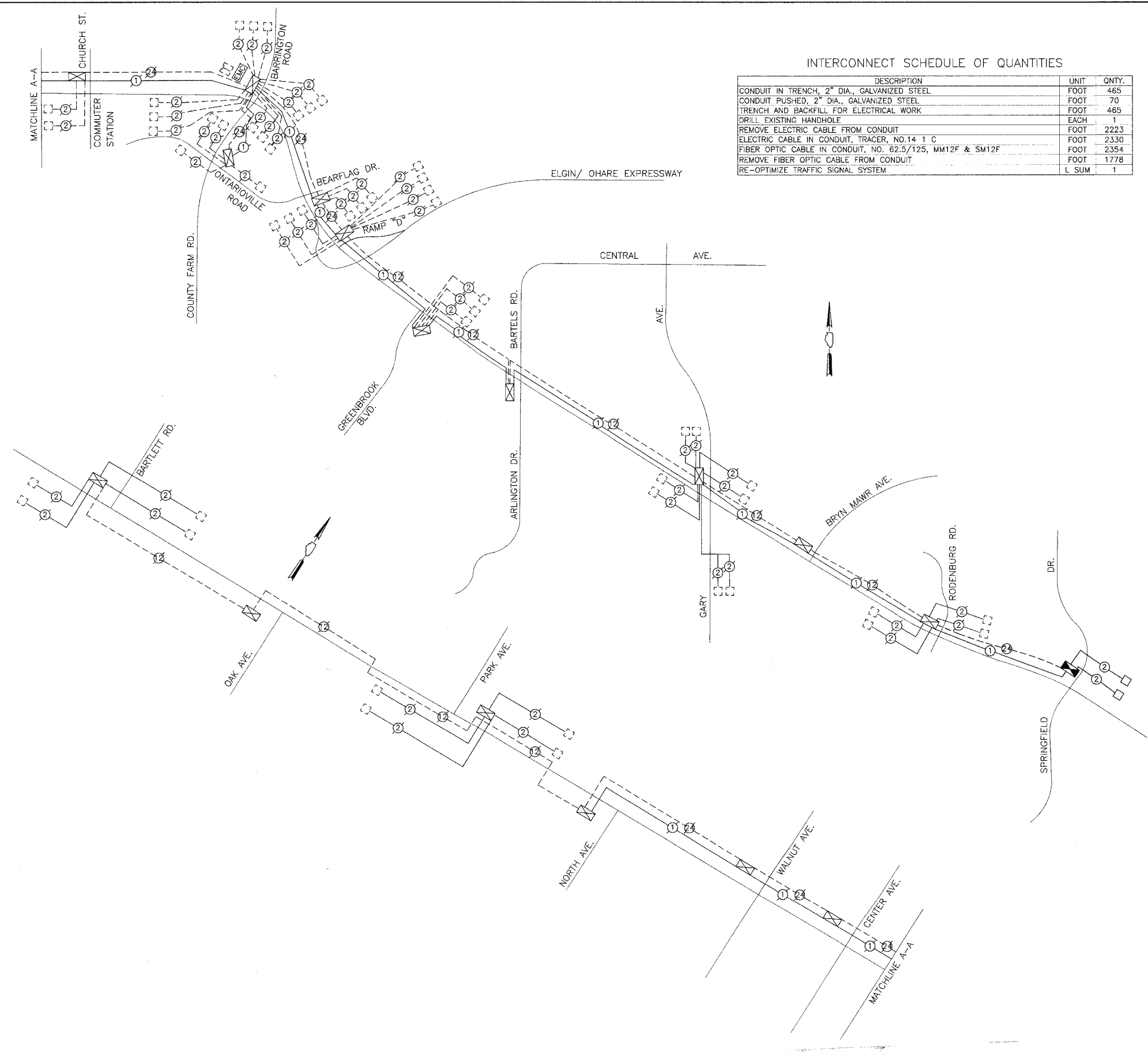

ALL DIMENSIONS SHOWN ARE IN FEET AND INCHES UNLESS OTHERWISE SPECIFIED. RECORD DRAWING SHALL BE USED TO VERIFY ALL DIMENSIONS. ALL DIMENSIONS SHALL BE TO THE CENTERLINE UNLESS OTHERWISE SPECIFIED.