

F.A.U. RTE.	SECTION	COUNTY	TOTAL SHEETS	SHEET NO.
168	05-00010-00-RS	MCHENRY	25	22
STA.	194+50	TO STA.	202+33	
FED. ROAD DIST. NO. 1		ILLINOIS	HIGHWAY PROJECT	
CONTRACT # 83854				

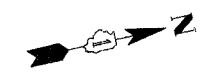
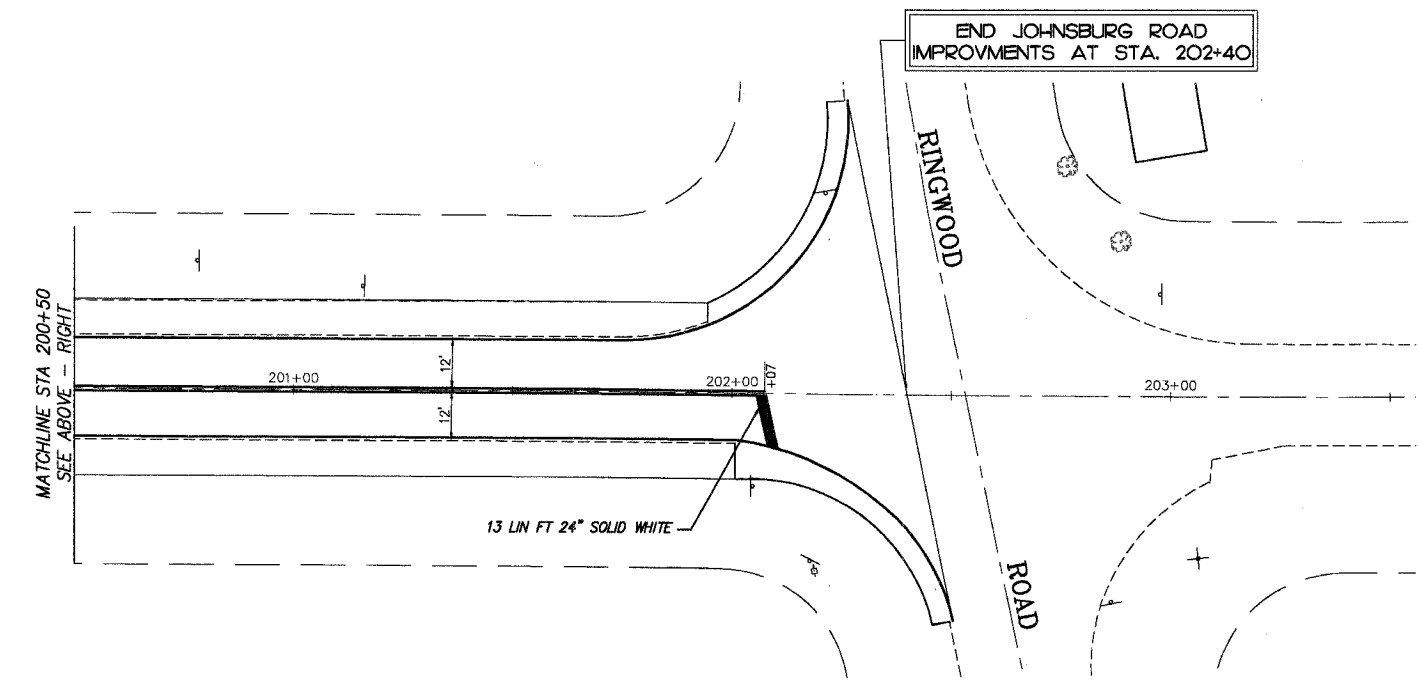
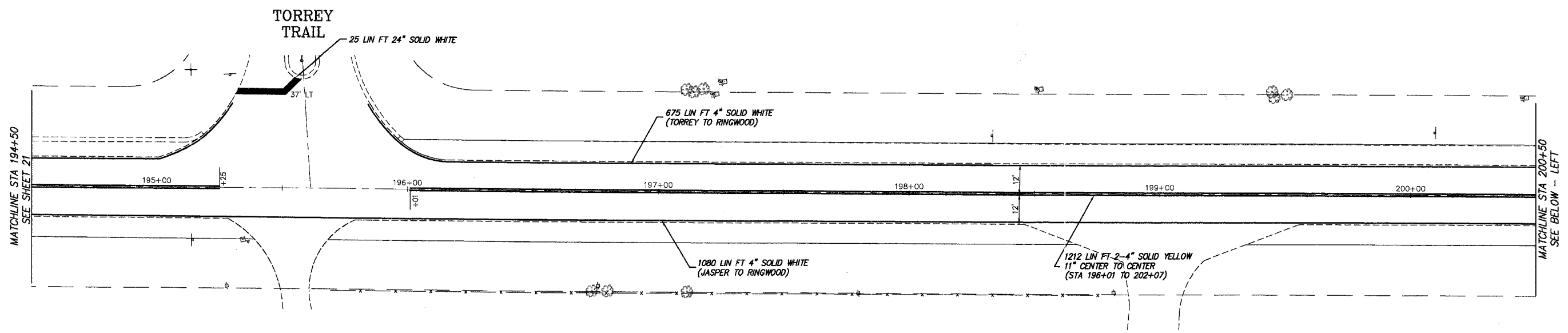
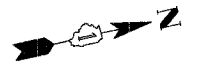

PLOT FILE: STANDARD
 MARK: 01-22
 COMP. FILE: 051006-803.DWG

REVISIONS	
NO.	DATE
7.	
6.	
5.	
4.	
3.	
2.	
1.	

SMITH ENGINEERING CONSULTANTS, INC.
 CIVIL/STRUCTURAL ENGINEERS AND SURVEYORS
 4500 PERRY PARKWAY, SUITE 301
 MCHENRY, ILLINOIS 60050
 PH: 815-385-1770 FAX: 815-385-1781
 www.smithengineering.com E-MAIL: sec@smithengineering.com
 MCHENRY HUNTLEY YORKVILLE
 ILLINOIS PROFESSIONAL DESIGN FIRM # 184-000108

ILLINOIS DEPARTMENT OF TRANSPORTATION

 VILLAGE OF JOHNSBURG
 JOHNSBURG ROAD
 PAVEMENT MARKING PLAN

 SCALE: 1" = 20'
 DATE 01-10-06
 DRAWN BY TK
 CHECKED BY TEH