

F.A.L. RTE.	SECTION	COUNTY	TOTAL SHEETS	SHEET NO.
3580	04-00043-00-TL	WILL	54	51
STA.	TO STA.			
FED. ROAD DIST. NO.	ILLINOIS	FED. AID PROJECT		
CONTRACT NO.: 83855				

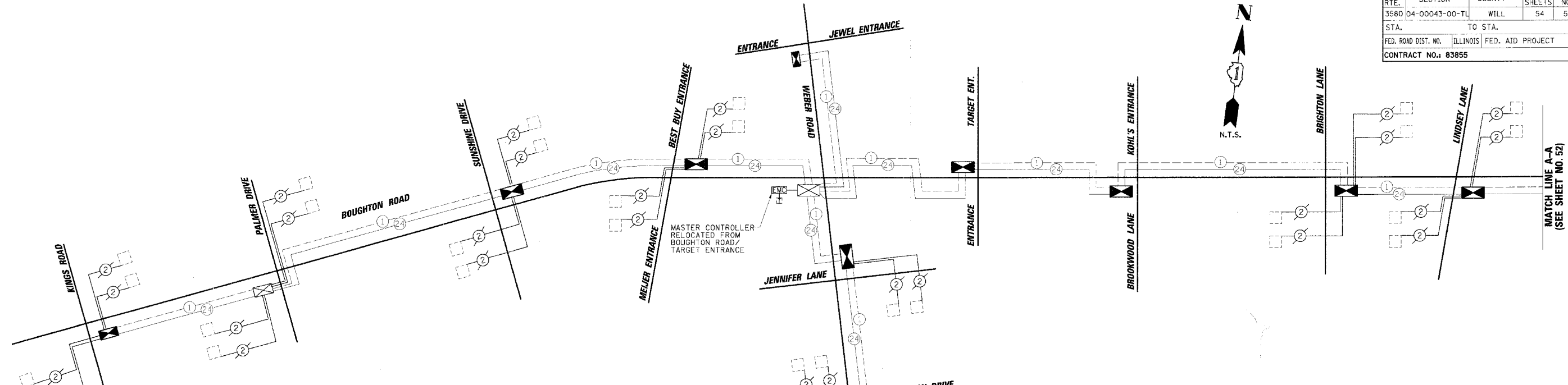

INTERCONNECT SCHEMATIC LEGEND

- EXISTING INTERSECTION CONTROLLER ☒
- PROPOSED INTERSECTION CONTROLLER ☒

- EXISTING MASTER CONTROLLER EMC
- PROPOSED MASTER CONTROLLER MCM
- MASTER MASTER CONTROLLER MMC

- EXISTING INTERSECTION & SAMPLING (SYSTEM) DETECTORS ☐
- PROPOSED INTERSECTION & SAMPLING (SYSTEM) DETECTORS ☐

- EXISTING INTERSECTION LOOP DETECTORS P
- PROPOSED SAMPLING (SYSTEM) DETECTORS P

- EXISTING SAMPLING (SYSTEM) DETECTORS ES
- PROPOSED SAMPLING (SYSTEM) DETECTORS PS

- EXISTING SAMPLING (SYSTEM) DETECTORS, PROPOSED INTERSECTION AND SAMPLING (SYSTEM) DETECTORS. ESP
- EXISTING SAMPLING (SYSTEM) DETECTORS, PROPOSED SAMPLING (SYSTEM) DETECTORS. ESP

- EXISTING PREFORMED INTERSECTION & SAMPLING (SYSTEM) DETECTORS PD
- PROPOSED PREFORMED INTERSECTION & SAMPLING (SYSTEM) DETECTORS PD

- EXISTING SAMPLING (SYSTEM) PREFORMED DETECTORS ESPD
- PROPOSED SAMPLING (SYSTEM) PREFORMED DETECTORS PSPD

- EXISTING FIBER OPTIC CABLE IN CONDUIT, NO. 62.5/125, MML2F SML2F 24
- PROPOSED FIBER OPTIC CABLE IN CONDUIT, NO. 62.5/125, MML2F SML2F 24

- EXISTING INTERCONNECT CABLE - NO. 62.5/125 12F FIBER OPTIC CABLE 12
- PROPOSED INTERCONNECT CABLE - NO. 62.5/125 12F FIBER OPTIC CABLE 12

- EXISTING INTERCONNECT CABLE - NO. 18 3 PAIR TWISTED, SHIELDED 6
- PROPOSED INTERCONNECT CABLE - NO. 18 3 PAIR TWISTED, SHIELDED 6

- EXISTING LOOP DETECTOR CABLE 2/C TWISTED, SHIELDED 2
- PROPOSED LOOP DETECTOR CABLE 2/C TWISTED, SHIELDED 2

- EXISTING ELECTRIC CABLE, 1/C (AS SPECIFIED) 1
- PROPOSED ELECTRIC CABLE, 1/C (AS SPECIFIED) 1

- EXISTING TELEPHONE CONNECTION T
- PROPOSED TELEPHONE CONNECTION T

MATCH LINE B-B (SEE SHEET NO. 54)

SYSTEM BREAK LINE - ALL SIGNALS NORTH OF THIS LINE SHALL BE COORDINATED WITH THE MASTER CONTROLLER AT BOUGHTON ROAD AND WEBER ROAD.

REVISIONS	
NAME	DATE

ILLINOIS DEPARTMENT OF TRANSPORTATION
INTERCONNECT SCHEMATIC
 BOUGHTON ROAD
 BOLINGBROOK, ILLINOIS
 SCALE: N.T.S.
 DATE: 4/7/2006
 DRAWN BY: FCP/FPB
 DESIGNED BY: MKW
 CHECKED BY: MJT

PROFILE SURVEYED BY: DATE: _____
 GRADES CHECKED BY: DATE: _____
 STRUCTURE NOTATION CHECKED BY: DATE: _____
 PLAN NO. _____ DATE: _____
 NOTE BOOK NO. _____
 NO. _____
 FILE NAME: _____
CHRISTOPHER B. BURKE ENGINEERING LTD.
 115 West Ogden Road, Suite 600
 Bolingbrook, IL 60440
 (847) 822-0500