

INDEX OF SHEETS

- 1 = COVER SHEET
- 2 = GENERAL NOTES, SCHEDULES, AND TYPICAL SECTION
- 3 = PLAN AND PROFILE
- 4 = GENERAL PLAN AND ELEVATION
- 5 = EAST AND WEST ABUTMENT DETAILS
- 6 = DECK BEAM DETAILS
- 7 = STEEL BRIDGE RAIL, TYPE SM
- 8 = PILE DETAILS
- 9 = CROSS SECTIONS

NAME AND ADDRESS OF UTILITIES	TYPE
COMED 123 Energy Avenue Rockford, IL 61109 Attn: Public Improvements (815) 490-2320	ELECTRIC
NICOR GAS 1844 W. Ferry Road Naperville, IL 60563 Attn: Scott Stogsdill (630) 983-8676 X2362	GAS
VERIZON 112 W. Elm Street Sycamore, IL 60178 Attn: Mike Brodzik (815) 895-1532	TELEPHONE
SBC 2404 8th Avenue Rockford, IL 61108 Attn: Steven Jones (815) 394-7270	TELEPHONE
MediaCom 2506 1/2 N. Bloomington Streator, IL 61365 Attn: Dale Peters (815) 672-5071	CABLE

**STATE OF ILLINOIS  
DEPARTMENT OF TRANSPORTATION  
PLANS FOR  
PROPOSED LOCAL AGENCY IMPROVEMENT  
FEDERAL-AID BRRP PROJECT**

SUMMARY OF QUANTITIES  
CONSTRUCTION TYPE CODE: X080-2A

CODE NO.	ITEM	UNIT	QUANTITY
20200100	EARTH EXCAVATION	CU YD	154
20300100	CHANNEL EXCAVATION	CU YD	89
20700220	POROUS GRANULAR EMBANKMENT	CU YD	115
25001000	SEEDING CLASS 2, SPECIAL	ACRE	0.3
25100630	EROSION CONTROL BLANKET	SQ YD	248
35101400	AGGREGATE BASE COURSE, TYPE B	TON	232.8
40200800	AGGREGATE SURFACE COURSE, TYPE B	TON	167.0
50100100	REMOVAL OF EXISTING STRUCTURES	EACH	1
50200100	STRUCTURE EXCAVATION	CU YD	120
50300225	CONCRETE STRUCTURES	CU YD	16.8
50400305	PRECAST PRESTRESSED CONCRETE DECK BEAMS-17"	SO FT	929
50500405	FURNISHING & ERECTING STRUCTURAL STEEL	POUND	5003
50700305	HARDWARE	POUND	2540
50800105	REINFORCEMENT BARS	POUND	4320
50901005	STEEL RAILING, TYPE SM	FOOT	66.3
51201000	FURNISHING METAL PILE SHELLS, 12"	FOOT	266
51202600	DRIVING & FILLING SHELLS	FOOT	266
51203700	TEST PILE - METAL SHELLS	EACH	1
55121800	PERMANENT STEEL SHEET PILING	SO FT	2896
51500100	NAME PLATES	EACH	1
54213870	STEEL END SECTIONS, 15"	EACH	2
54200220	PIPE CULVERTS, CLASS D, TYPE I 15"	FOOT	32
67100100	MOBILIZATION	L SUM	1
70103700	TRAFFIC CONTROL COMPLETE	L SUM	1

\* SEE SPECIAL PROVISIONS  
▲ REVISED 6-5-06

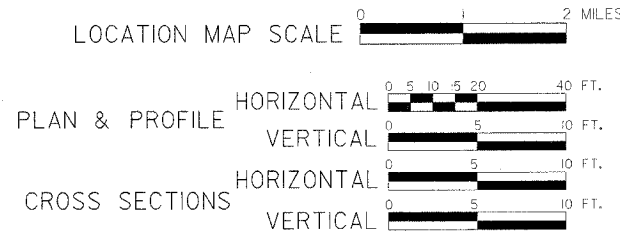

**BRIDGE REPLACEMENT &  
REHABILITATION PROGRAM**

**T.R. 59  
SECTION 01-22113-00-BR / OGLE COUNTY  
SECTION 01-09115-00-BR / WINNEBAGO COUNTY  
PROJECT BROS-141(62)  
JOB NO. C-92-069-06  
CONTRACT NO. 85386  
2006**

STANDARDS

- 000001-04 STANDARD SYMBOLS, ABBREVIATIONS, & PATTERNS
- 280001-02 TEMPORARY EROSION CONTROL SYSTEMS
- 515001-02 NAME PLATE FOR BRIDGES
- 542401 METAL END SECTION FOR PIPE CULVERT
- 702001-06 TRAFFIC CONTROL DEVICES
- BLR-21-6 TYPICAL APPLICATION OF TRAFFIC CONTROL DEVICES FOR CONSTRUCTION ON RURAL LOCAL HIGHWAYS
- BLR-22-4 TYPICAL APPLICATION OF TRAFFIC CONTROL DEVICES FOR CONSTRUCTION ON RURAL LOCAL HIGHWAYS

ATTENTION CONTRACTORS

THE ILLINOIS DEPARTMENT OF TRANSPORTATION BUREAU OF MATERIALS AND PHYSICAL RESEARCH, "PROJECT PROCEDURES GUIDE" IS APPLICABLE TO THIS PROJECT.

HIGHWAY CLASSIFICATION: LOCAL ROAD  
DESIGN SPEED: 30 mph  
ADT = <100 (2006) 1% TRUCKS  
3 R GUIDELINES



NET LENGTH 300 FT. = 0.057 MILES

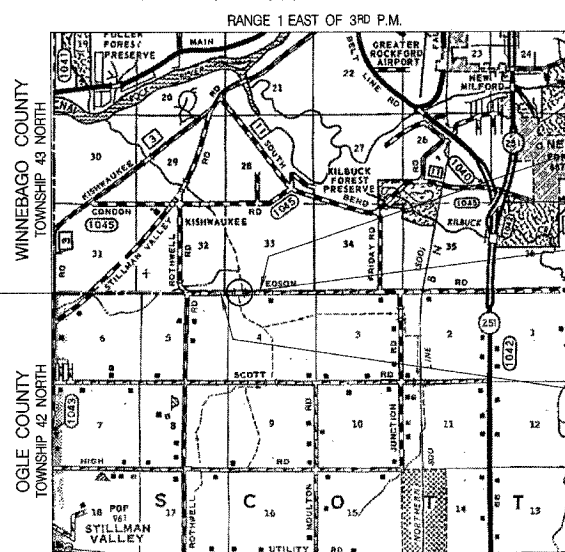

LOCATION MAP

SECTION ENDS AT STA. 11+50

PROPOSED STRUCTURE (S.N. 071-3327)  
A SINGLE SPAN (1 @ 32'-0") 17" PRECAST, PRESTRESSED CONCRETE DECK BEAM STRUCTURE ON CLOSED STEEL SHEET PILE ABUTMENTS @ STA. 10+00, SKEWED 0°.

SECTION BEGINS AT STA. 8+50



Brian K. Convent  
DATE: MARCH 7/2006  
EXPIRES 11/30/06

APPROVED: *[Signature]* 20.06  
LOCAL AGENCY OFFICIAL

APPROVED: *[Signature]* 20.06  
LOCAL AGENCY OFFICIAL

PASSED: *[Signature]* 4-18 20.06  
DISTRICT ENGINEER OF LOCAL ROADS & STREETS

APPROVED: *[Signature]* 4-18 20.06  
FOR BIDDING DISTRICT ENGINEER

STATE OF ILLINOIS  
DEPARTMENT OF TRANSPORTATION

PREPARED BY  
**WILLET  
HOFMANN &  
ASSOCIATES, INC.**  
CONSULTING ENGINEERS  
Land Surveying - Transportation - Structural  
Environmental - Architecture  
809 East Second Street  
Dixon, Illinois 61021  
Phone: 815-284-3381