

ROUTE NO.	SECTION	COUNTY	TOTAL SHEETS	SHEET NO.
343 & 1362	01-00025-04-RS	LIVINGSTON	12	11

PROJECT NO. SR-343(108)

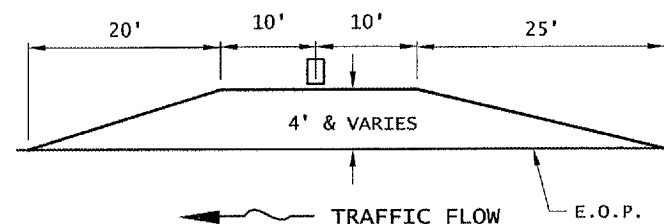

MAILBOX TURNOUT DETAIL (PLACED DURING MAINLINE PAVING)

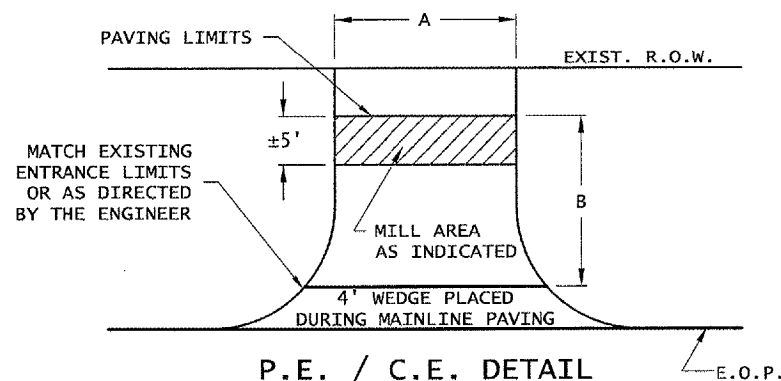

P.E. / C.E. DETAIL
FOR QUANTITIES SEE CHART BELOW

NOT PLOTTED TO SCALE

CURVE 1 (NORTH)
 $\Delta = 0^{\circ}04'56''$
 $R = 5729.65'$
 $T = 246.83'$
 $L = 493.33'$
 $e = 3.0\%$ (Exist = 2.6%)
 S.E. RUN = 88'
 P.C. = 630+14.17
 P.T. = 635+07.50

CURVE 3 (NORTH)
 $\Delta = 8^{\circ}00'00''$
 $R = 3,997.48'$
 $T = 279.54'$
 $L = 558.14'$
 $e = 3.0\%$ (Exist = 3%)
 S.E. RUN = 88'
 P.C. Sta 955+26.00
 P.T. Sta 961+00.42

CURVE 2 (SOUTH)
 $\Delta = 0^{\circ}04'46''$
 $R = 5729.65'$
 $T = 238.47'$
 $L = 476.67'$
 $e = 3.0\%$ (Exist = 2.1%)
 S.E. RUN = 88'
 P.C. = 637+26.03
 P.T. = 642+02.70

CURVE 4 (SOUTH)
 $\Delta = 8^{\circ}14'00''$
 $R = 3,997.48'$
 $T = 287.70'$
 $L = 574.42'$
 $e = 3.0\%$ (Exist = 3%)
 S.E. RUN = 88'
 P.C. Sta 955+26.00
 P.T. Sta 961+00.42

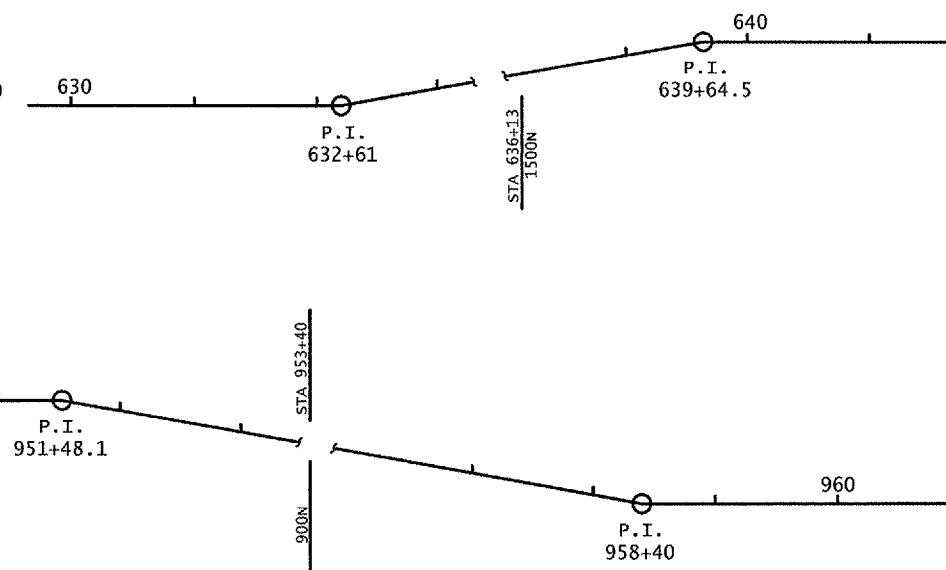

CHATSWORTH RD. / CH 3 - ENTRANCE QUANTITIES										CHATSWORTH RD. / CH 3 - ENTRANCE QUANTITIES (CONT.)											
TYPE	STATION	A(Ft.)	B(Ft.)	AREA (S.Y.)	MILLING (S.Y.)	BIT. MAT. PRIME(MC-30)	BIT. MAT. PRIME(RC-70)	BINDER COURSE	SURFACE COURSE	INCID. BIT.	TYPE	STATION	A(Ft.)	B(Ft.)	AREA (S.Y.)	MILLING (S.Y.)	BIT. MAT. PRIME(MC-30)	BIT. MAT. PRIME(RC-70)	BINDER COURSE	SURFACE COURSE	INCID. BIT.
MBTO	609+70(R)	50	7	27		10		4	3		PE	964+72(R)	18	14	28		10		2	1	5
PE	609+80(R)	18	14	28		10		2	1	5	CE	964+89(R)	25	14	39		14		2	1	7
MBTO	632+61(R)	60	4	18		6		3	1		MBTO & PE	965+91(R)	65	14	28		10		4	1	5
PE	632+93(L)	18	14	28		10		2	1	5	PE	967+70(L)	35	14	54		19		3	1	10
PE	634+39(R)	18	14	28		10		2	1	5	PE	971+61(L)	18	14	28		10		2	1	5
MBTO	642+82(R)	70	4	20		7		3	1		MBTO	974+06(R)	70	4	20		7		3	1	
PE	643+49(L)	18	14	28		10		2	1	5	PE	978+38(R)	18	14	28		10		2	1	5
MBTO & PE	650+94(R)	65	14	28		10		4	1	5	CE	979+40(L)	60	14	42		15		4	1	8
PE	694+58(R)	18	14	28		10		2	1	5	PE	980+34(R)	18	14	28		10		2	1	5
PE	712+02(L)	18	14	28		10		2	1	5	MBTO	980+88(R)	45	4	14		5		3	1	
MBTO	712+14(R)	70	4	20		7		3	1		CHARLOTTE RD. / CH 9 - ENTRANCE QUANTITIES										
MBTO	718+79(R)	65	4	19		7		3	1		MBTO	13+44(R)	60	4	18		6		3	1	
PE	718+79(R)	18	14	28		10		2	1	5	PE	13+44(R)	18	14	28	10		1	2	1	5
PE	720+81(R)	18	14	28		10		2	1	5	PE	13+82(L)	18	14	28		10		2	1	5
MBTO & PE	787+84(R)	65	14	28		10		4	1	5	PE	14+86(R)	18	14	28	10		1	2	1	5
MBTO	800+07(R)	65	4	19		7		3	1		PE	15+93(L)	35	14	54		19		3	1	10
PE	800+59(L)	18	14	28		10		2	1	5	MBTO	16+65(R)	60	4	18		6		3	1	
CE	801+47(L)	25	14	39		14		2	1	7	CE	16+65(R)	25	14	39		14		2	1	7
MBTO	843+42(R)	65	4	19		7		3	1		CE	17+66(L)	25	15	42		15		2	1	8
PE	843+60(L)	18	14	28		10		2	1	5	CE	17+72(R)	25	16	44		15		2	1	8
CE	844+34(L)	25	14	39		14		2	1	7	CE	23+23(R)	93	4	41		14		6	3	
MBTO & PE	864+43(R)	65	14	28		10		4	1	5	CE	25+91(R)	60	4	27		9		4	2	
CE	871+66(L)	25	14	39		14		2	1	7	CE	25+91(L)	60	4	27		9		4	2	
MBTO	872+71(R)	65	4	19		7		3	1		CE	27+87(L)	105	20	233	58		12	7	4	39
PE	872+74(L)	18	14	28		10		2	1	5	CE	28+18(R)	343	4	152		53		21	13	
PE	901+21(L)	18	14	28		10		2	1	5	CE	28+95(L)	112	4	50		18		7	4	
PE	902+96(L)	18	14	28		10		2	1	5	MBTO	30+66(R)	60	4	18		6		3	1	
CE	925+49(R)	25	14	39		14		2	1	7	PE	30+66(R)	74	14	115		40		5	1	20
PE	926+11(L)	18	14	28		10		2	1	5	PE	31+49(L)	18	14	28	10		1	2	1	5
CE	963+06(R)	210	4	93		33		14	1	16	MBTO	32+23(R)	60	4	18		6		3	1	
MBTO	964+72(R)	75	4	21		7		3	1		PE	32+23(R)	18	14	28		10		2	1	5
PE	964+72(R)	18	14	28		10		2	1	5	PE	33+22(R)	18	14	28		10		2	1	5
											PE	34+82(R)	18	14	28		10		2	1	5
TOTAL FOR BOTH SECTIONS																98	714	15	208	88	311

Z:\COWork\ROAD Projects\00025RS4-ChatsRd-North\Planning\Plans.dwg, 3/30/2006 12:40:53 PM