

F.A.P. RTE.	SECTION	COUNTY	TOTAL SHEETS	SHEET NO.
669	11W-3,RS-8,*	TAZEWELL	442	153
STA. 309+50		TO STA. 315+00		
FED. ROAD DIST. NO.		ILLINOIS FED. AID PROJECT		

* 11BR-1, 11BR-2

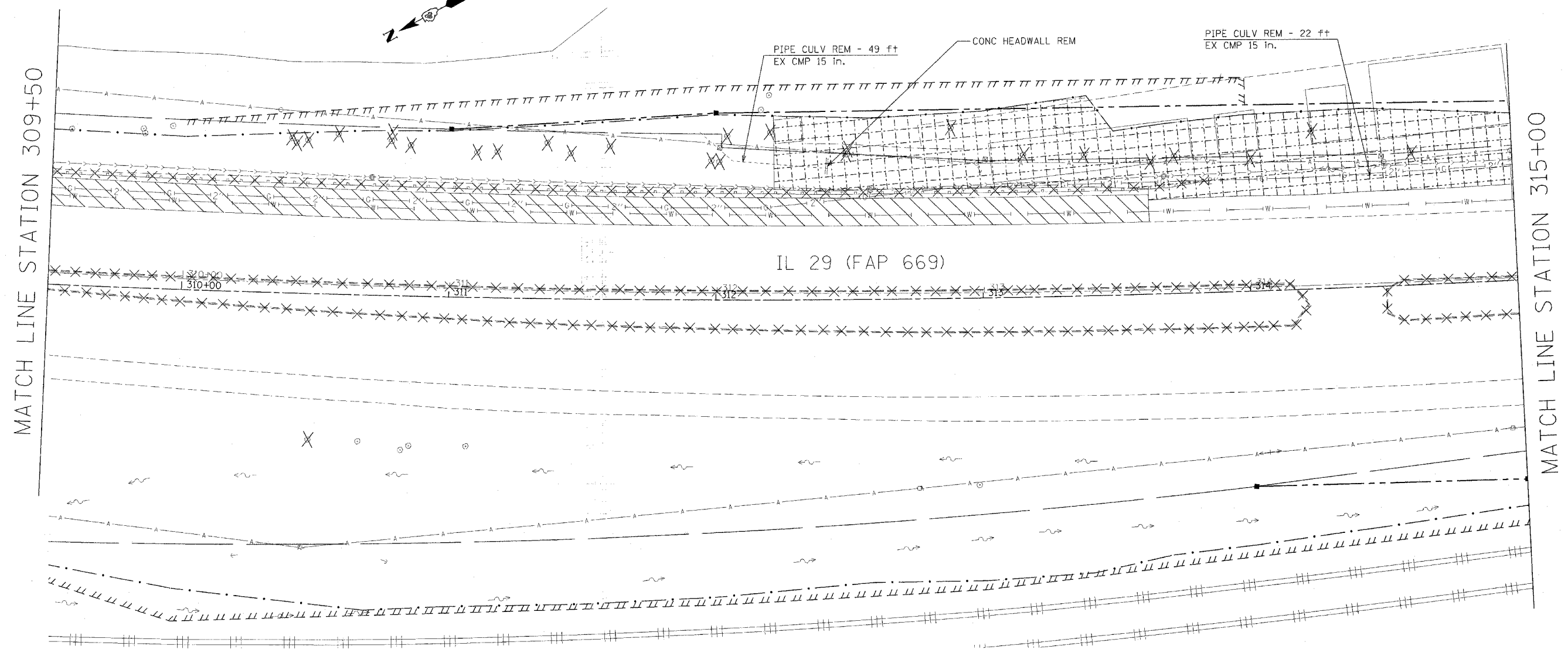

MATCH LINE STATION 309+50

MATCH LINE STATION 315+00

IL 29 (FAP 669)

LEGEND FOR REMOVAL ITEMS

- | | | | | | |
|--|--------------------------------|--|----------------------|--|-------------------------------|
| | PAVEMENT REMOVAL | | CCC & G REMOVAL | | BIT SURF REM BUTT JOINT (SPL) |
| | PAVEMENT REMOVAL (SPECIAL) | | GUARDRAIL REMOVAL | | BIT SURF REM - BUTT JOINT |
| | SHOULDER REMOVAL | | BUILDING REMOVAL | | |
| | DRIVEWAY PAVEMENT REMOVAL | | SPECIAL EXCAVATION | | |
| | MEDIAN REMOVAL | | TREE REMOVAL | | |
| | MEDIAN REMOVAL (PARTIAL DEPTH) | | TREE REMOVAL (ACRE) | | |
| | | | REVTMENT MAT REMOVAL | | |

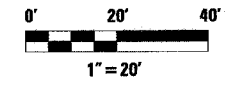

REVISIONS	
NAME	DATE

ILLINOIS DEPARTMENT OF TRANSPORTATION

REMOVAL PLANS

SCALE: VERT. HORIZ. DATE

DRAWN BY CHECKED BY

NOTE: BIT SURF REM 2" FROM STA 258+00 TO STA 267+83 AND STA 277+39.82 TO 286+05 IN SOUTH BOUND LANES ONLY AND BIT SURF REM 1-1/2" ELSEWHERE ON IL 29 MAINLINE.