

F.A.P. RTE.	SECTION	COUNTY	TOTAL SHEETS	SHEET NO.
669	11W-3,RS-8,*	TAZEWELL	442	156
STA. 326+00		TO STA.331+50		
FED. ROAD DIST. NO.	ILLINOIS	FED. AID PROJECT		

\* 11BR-1, 11BR-2

MATCH LINE STATION 326+00

MATCH LINE STATION 331+50

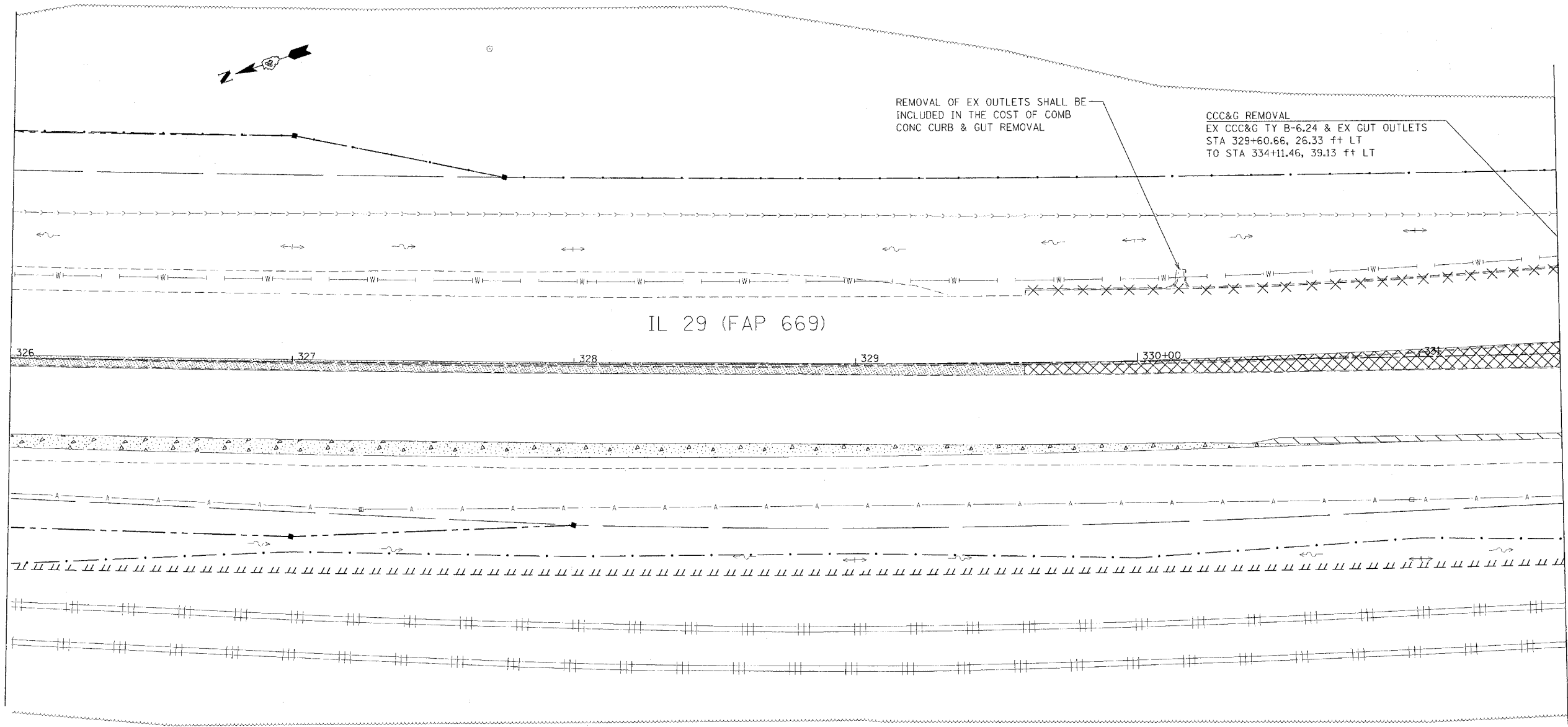

LEGEND FOR REMOVAL ITEMS

- |                                |                       |                               |
|--------------------------------|-----------------------|-------------------------------|
| PAVEMENT REMOVAL               | CCC & G REMOVAL       | BIT SURF REM BUTT JOINT (SPL) |
| PAVEMENT REMOVAL (SPECIAL)     | GUARDRAIL REMOVAL     | BIT SURF REM - BUTT JOINT     |
| SHOULDER REMOVAL               | BUILDING REMOVAL      |                               |
| DRIVEWAY PAVEMENT REMOVAL      | SPECIAL EXCAVATION    |                               |
| MEDIAN REMOVAL                 | TREE REMOVAL          |                               |
| MEDIAN REMOVAL (PARTIAL DEPTH) | TREE REMOVAL (ACRE)   |                               |
|                                | REVETMENT MAT REMOVAL |                               |

NOTE: BIT SURF REM 2" FROM STA 258+00 TO STA 267+83 AND STA 277+39.82 TO 286+05 IN SOUTH BOUND LANES ONLY AND BIT SURF REM 1-1/2" ELSEWHERE ON IL 29 MAINLINE.

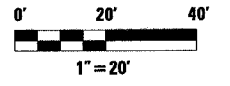

REVISIONS	
NAME	DATE

ILLINOIS DEPARTMENT OF TRANSPORTATION

## REMOVAL PLANS

SCALE: VERT. \_\_\_\_\_  
HORIZ. \_\_\_\_\_

DATE \_\_\_\_\_

DRAWN BY \_\_\_\_\_  
CHECKED BY \_\_\_\_\_

PLOT DATE = 4/18/2006  
 FILE NAME = c:\projects\11w-3\phase-11\28p\rdpl.dgn  
 PLOT SCALE = 2000000 / 1"  
 USER NAME = anshuz