

F.A.P. RTE.	SECTION	COUNTY	TOTAL SHEETS	SHEET NO.
669	11W-3,RS-8,*	TAZEWELL	442	219
STA. 298+00		TO STA. 304+00		
FED. ROAD DIST. NO.		ILLINOIS FED. AID PROJECT		

• 11BR-1, 11BR-2



MATCH LINE STATION 298+00

MATCH LINE STATION 304+00

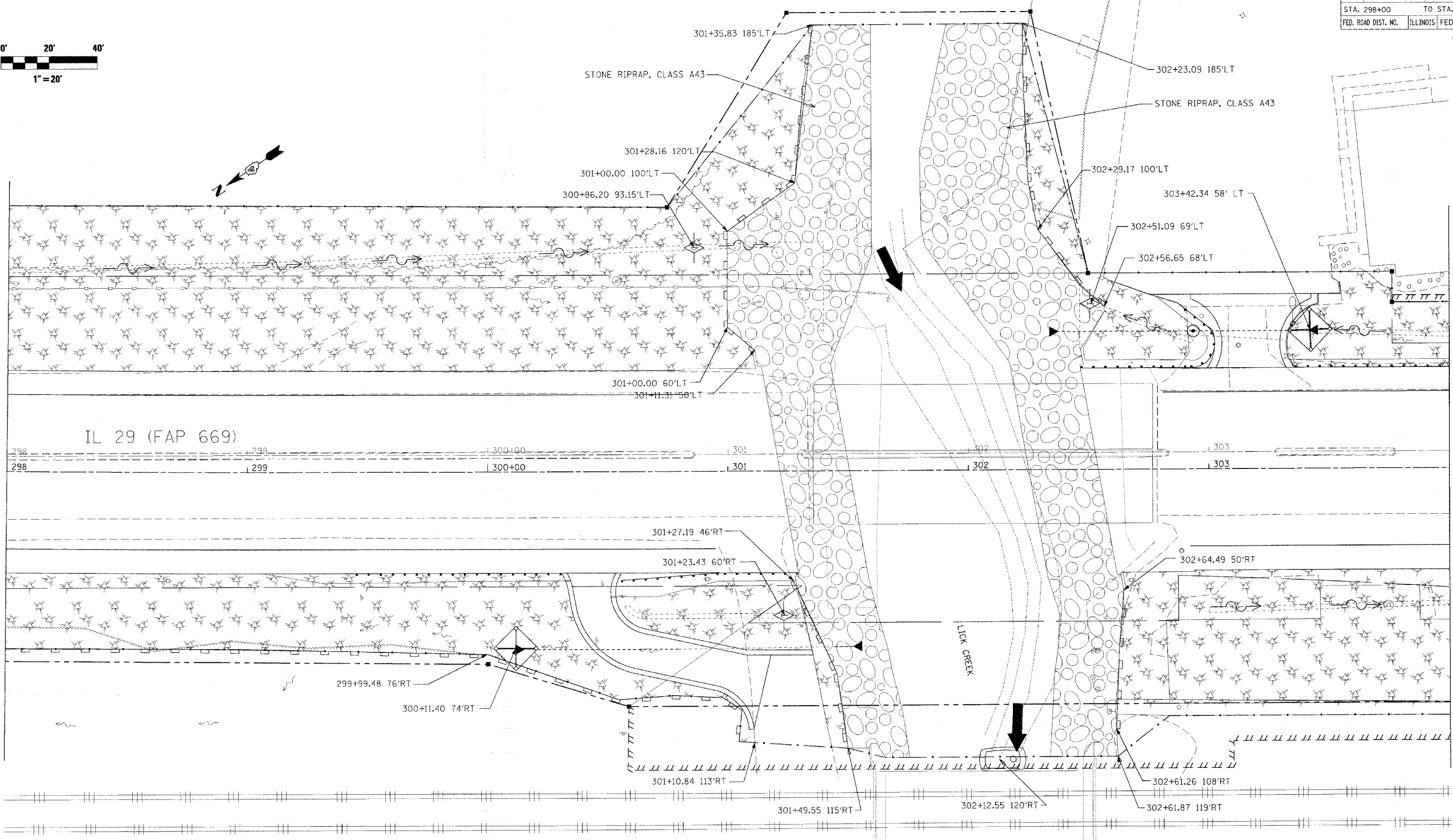

General Notes

- ALL PERMANENT EROSION CONTROL MEASURES SHALL BE CONSTRUCTED AS SOON AS PRACTICAL.
- TEMPORARY SEEDING SHALL BE PLACED WHEN THE GROUND HAS BEEN DISTURBED AND PLACEMENT OF PERMANENT SEEDING IS NOT PRACTICAL OR AS DIRECTED BY THE ENGINEER.
- PLACE SEEDING, CLASS 2A IN AREAS USING MULCH, METHOD 2 AND EROSION CONTROL BLANKET.
- CONTACT THE DISTRICT 4 LANDSCAPE ARCHITECT AT (309) 671-4484 FOR TREE PLANTING LOCATIONS AT LEAST 2 WEEKS PRIOR TO PLANTING TREES.

LEGEND

	SEDIMENT BASIN		PERIMETER EROSION BARRIER		STONE RIPRAP, CLASS SPECIFIED
	INLET AND PIPE PROTECTION		TEMPORARY DITCH CHECK		FABRIC FORMED REVETMENT MAT
	EROSION CONTROL BLANKET		LIMITS OF CONSTRUCTION		MULCH, METHOD 2
			SODDING		

REVISIONS	
NAME	DATE

ILLINOIS DEPARTMENT OF TRANSPORTATION

EROSION CONTROL & LANDSCAPING PLANS

SCALE: VERT. _____
HORIZ. _____
DATE _____

DRAWN BY _____
CHECKED BY _____

PLOT DATE = 4/18/2006
 FILE NAME = 299+00-304+00-erod.dwg
 PLOT SCALE = 20x36/20 / IN.
 USER NAME = shouphz