

F.A.P. R.T.E.	SECTION	COUNTY	TOTAL SHEETS	SHEET NO.
669	11W-3RS-8*	TAZEWELL	442	246

* 11BR-1, 11BR-2

DATE	BY	CHKD.	APPD.	SHEET NO.
2.21.54	JL BR	Tazewell	16	5

3 SHEETS

STATE OF ILLINOIS
DEPARTMENT OF PUBLIC WORKS & BUILDINGS
DIVISION OF HIGHWAYS

BM # 28 A Chiseled 5 W Bridge
Abutment R.C. Slab 27x15 Elev. 461.89
Existing Structure R.C. Slab One span 20' skew 30°
30' Rail to Rail Rdwy. Concr. Abutment on Piles.
The Bridge Contractor shall remove Existing Structure
after 2' Lanes of New Bridge are open to traffic.

FOR INFORMATION ONLY

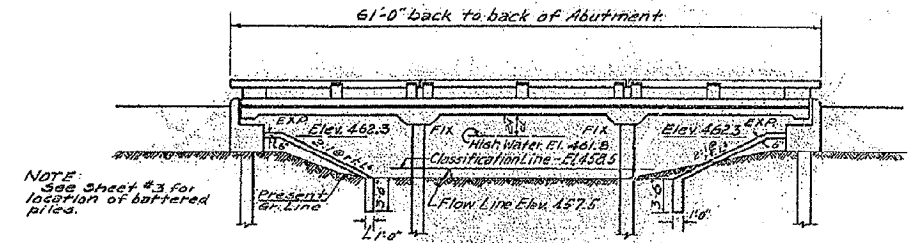

ELEVATION
Scale 1/8" = 1'-0"

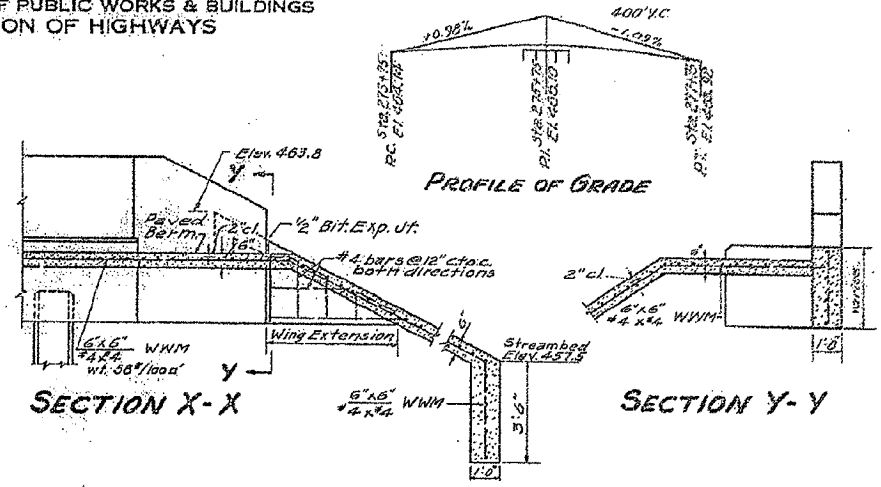

SECTION X-X

SECTION Y-Y

GENERAL NOTES
Class X concrete shall be used throughout except in handrails.
Handrail concrete shall be used in handrails.
The concrete floor shall be finished in accordance with the applicable provisions of Article 51.10 (a) of the Standard Specifications.
Slope wall shall be reinforced with welded wire fabric 6"x6" mesh, #4 wires, weighing 58 lbs/100 sq. ft.
Layout of slope walls may be varied to suit ground conditions in the field, as directed by the Engineer.
All rollers, bearing plates, lead plates, and anchor bolts shall be fabricated and set in accordance with Article 51.4 of the Standard Specifications and are included for payment as Structural Steel. Expansion guards shall be fabricated and erected in accordance with Article 51.2 (d) of the Standard Specifications.
Except as otherwise provided, all structural steel shall receive one shop coat of red lead paint and two field coats of aluminum paint, see Article 57.1 to 57.5 inclusive of the Standard Specifications.
All paint shall be furnished and applied by the contractor.
The Contractor shall drive two test piles (in permanent locations) as directed by the Engineer before casting remainder of piles.
Boring Data are shown on the drawings only as a guide to bidders in estimating soil conditions which may be encountered in the work.
Material to backfill abutments shall be obtained from Channel Excavation within the limits of the R.O.W.

DETAILS OF WING EXTENSION AND PAVED BERM

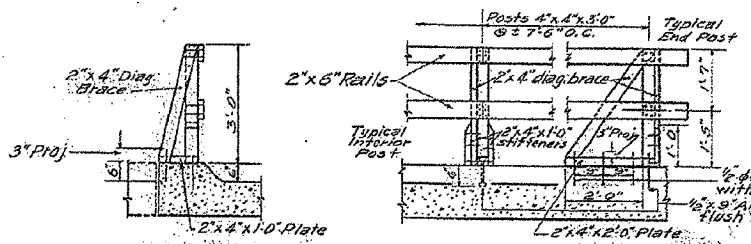

DETAILS OF TEMPORARY WOOD RAIL AT MEDIAN CURB

Note: When temporary rail is removed, all projecting bolts to be turned off flush with top of median curb.

BORING NO. 1 BORING NO. 2 BORING NO. 3
Sta. 275+93 on Centerline Sta. 276+14 on Centerline Sta. 275+43 - 6' Left of Centerline

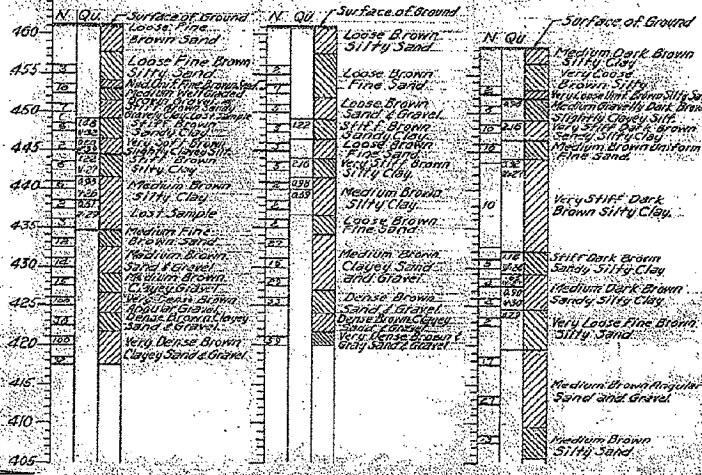

STATION 275 + 75
BUILT 1950 BY
STATE OF ILLINOIS
S.B.I. RT. 24 SEC. 11BR
PROJECT F-251 (5)
LOADING H20-S16

NAME PLATE DETAIL

see Standard 2113

TOTAL BILL OF MATERIAL

ITEM	SUPER SUB	TOTAL
Class X Concrete	Cu.Yds. 167.5	66.9 234.4
Handrail Concrete	Cu.Yds. 3.3	3.3
Reinforcement Bars	Lbs. 38090.889	146900
Structural Steel	Lbs. 9120	9120
Name Plate	Each 1	1
Prec. Concr. Piles	Lin.Ft. 1260	1260
Test Piles	Each 2	2
Slope Wall	Sq.Yds. 435	435
Removal of Exst. Structures	Each 1	1
Channel Excavation	Cu.Yds. 102	102
Class X Prec. for Structures	Cu.Yds. 100	100
Class B Prec. for Structures	Cu.Yds. 74	74
Temporary Timber Rail	Lin.Ft. 61	61

Note: Slope walls, paved berms, toe walls and wing extensions shall be measured as Slope Walls and shall be paid for at the Contract Unit Price per Sq. Yd. of Slope Walls which shall include the indicated reinforcement for these items.
Note: Class A Excavation is measured from the Classification line at Elev. 450.5 up to an average ground elevation of 461.0.

GENERAL PLAN & ELEVATION

SBI RT. 24 SECTION 11BR
STA. 275 + 75
TAZEWELL COUNTY

Loading - H20-S16-44

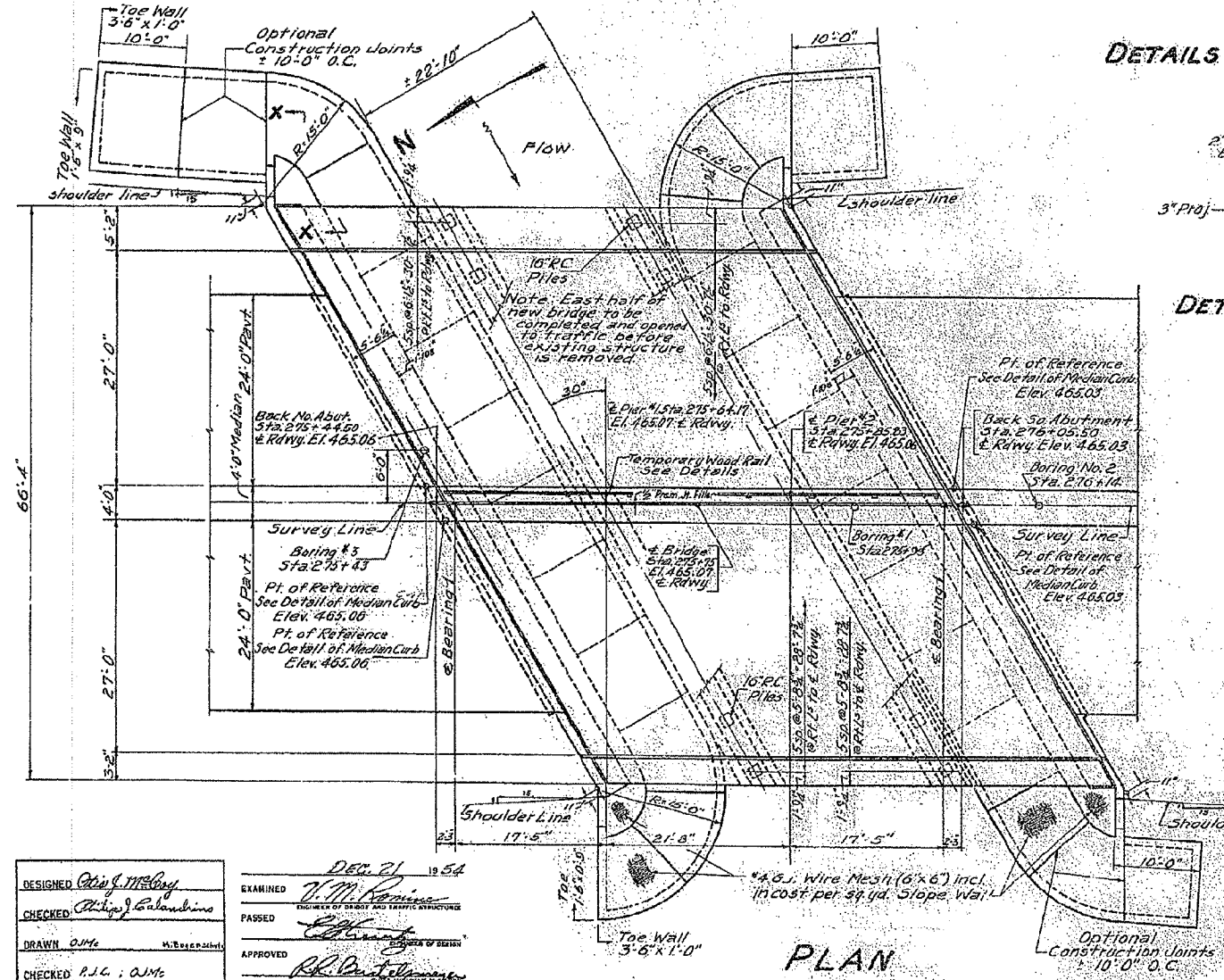

PLAN

DESIGNED: *W. J. McElroy*
CHECKED: *W. J. McElroy*
DRAWN: *C. M. C.*
CHECKED: *P. J. C. / J. M. C.*

EXAMINED: *W. J. McElroy*
PASSED: *W. J. McElroy*
APPROVED: *W. J. McElroy*

DATE: Dec. 21, 1954

Revised: 1-9-54, with addition of 2' from J. McElroy added on PLAN