

STATE OF ILLINOIS  
DEPARTMENT OF TRANSPORTATION

ROUTE NO. F.A.P. 669	SECTION 11BR-2	COUNTY TAZEWELL	DISTRICT 442	SHEET NO. 259	SHEET NO. 4 14 SHEETS
FED. ROAD DIST. NO. 7		ILLINOIS FED. AID PROJECT			

Contract #88804

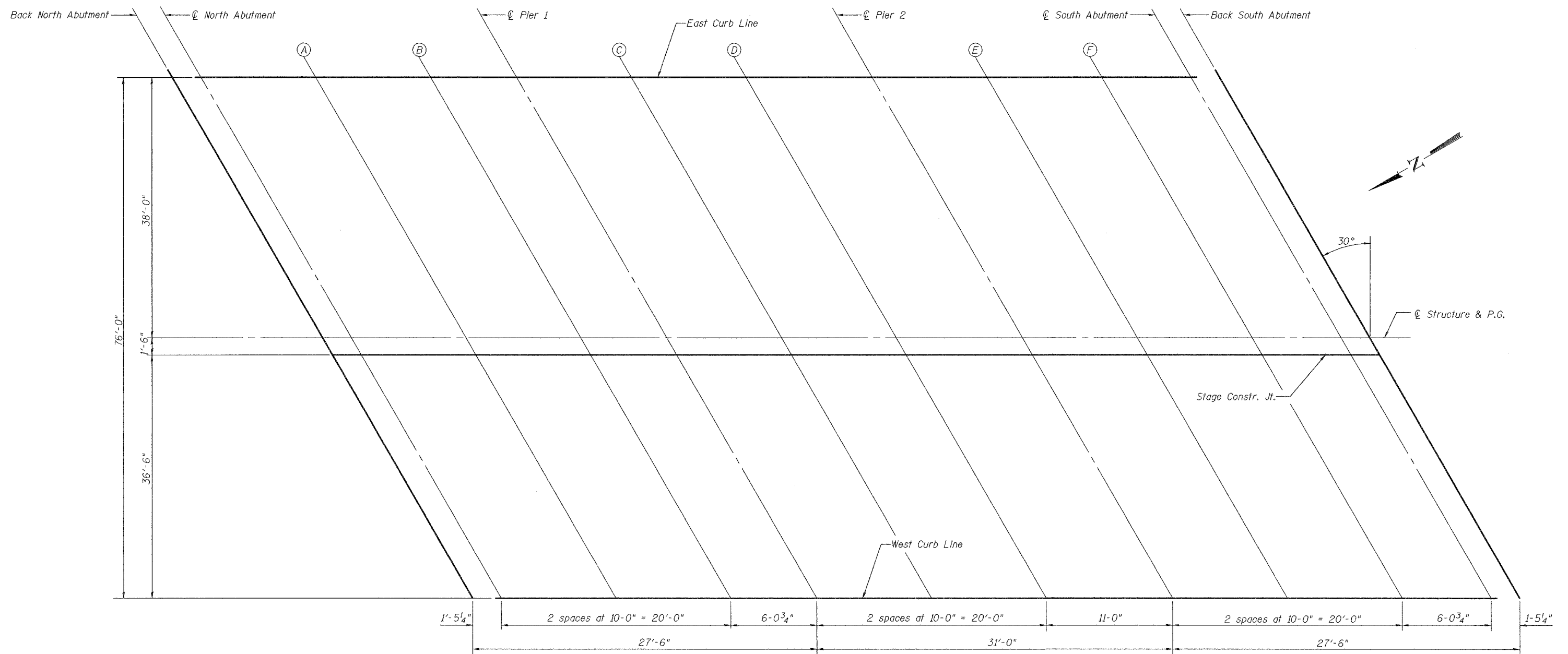

PLAN

DESIGNED Philip E. Copperrnoll  
CHECKED Ray Ahanchi  
DRAWN Amber M. Seiber  
CHECKED PEC/GRA

EXAMINED Thomas J. Demagalki  
PASSED Ralph E. Anderson  
MAY 5 2006  
ENGINEER OF BRIDGE DESIGN  
ENGINEER OF BRIDGES AND STRUCTURES

TOP OF SLAB ELEVATIONS  
F.A.P. ROUTE 669-SEC. 11BR-2  
TAZEWELL COUNTY  
STATION 275+77.36  
STRUCTURE NO. 090-0174