

COUNTY	ROUTE	CONTRACT	SHEET
KNOX	CH-39	89375	3 OF 7

Project#-BR-0S-095(122)

BM#1- ELEV. 100.0'
SPIKE IN TELE. POLE
STA. 6+06 LT.
1"=50'

Leon Tice
E 1/2 NE1/4 Sec.21
T09NR02E
(pasture)

Leon Tice
SE 1/4 Sec.21
T09NR02E
(pasture)

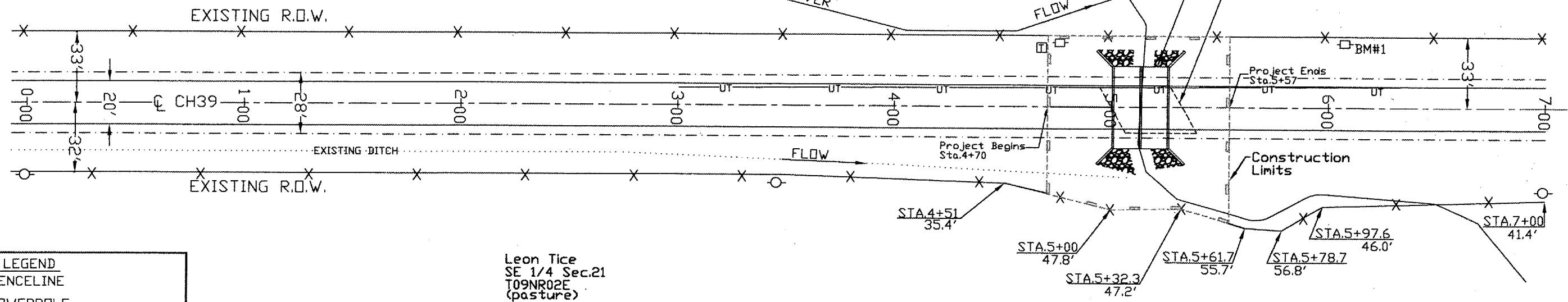

LEGEND

- X FENCELINE
- POWERPOLE
- TELEPHONE PEDISTAL
- TELEPHONE POLE
- UT- UNDERGROUND TELEPHONE
- ▬ EROSION CONTROL BARRIER

UTILITIES

AMERINIP 1-800-755-5000
FRONTIER 1-800-921-8101

*SEEDING/APPROACHES DONE BY KNOX COUNTY
**16L.F OF 24"dia. c.s.p to be installed in south ditch from Sta.4+78 to Sta.4.94 by Knox County

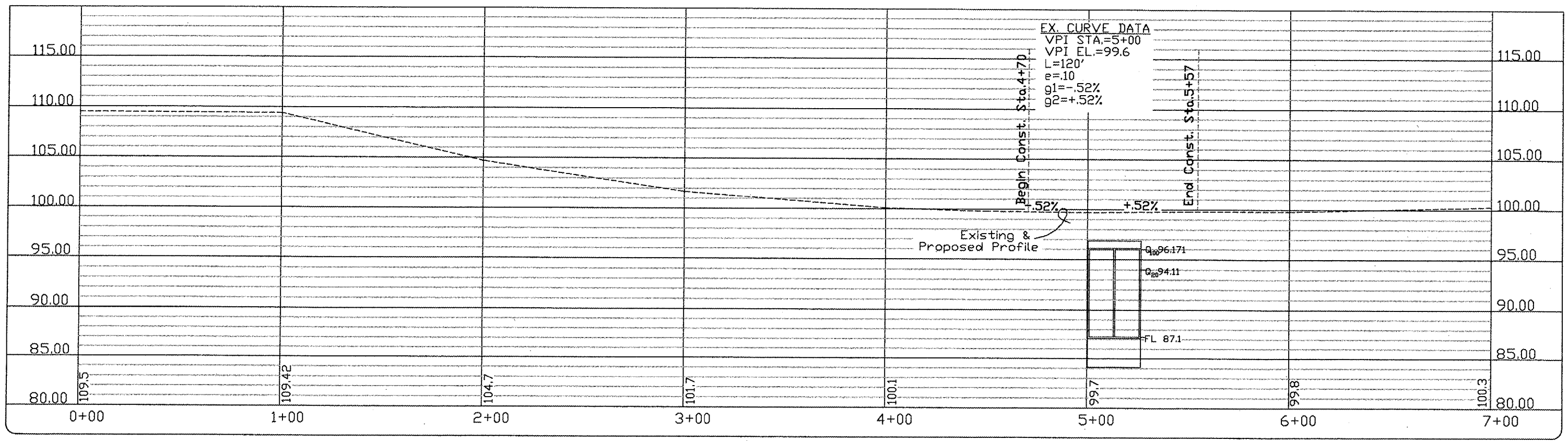

SCALES: 1"=10' VERT.
1"=50' HOR.