

STATE OF ILLINOIS
DEPARTMENT OF TRANSPORTATION
**PLANS FOR
PROPOSED LOCAL AGENCY IMPROVEMENT
STR PROJECT**

ROUTE	SECTION	COUNTY	Total Sheets	Sheet No.
FAS 450	03-00125-00-RS	WARREN	3	1

PROJECT NO. RS-450(109)
CONTRACT NO. 89388

INDEX OF SHEETS

1. COVER SHEET
2. SUMMARY OF QUANTITIES, ENTRANCE, INTERSECTION, AND BUTT JOINT DETAILS
3. TYPICAL CROSS SECTIONS OF ROADWAY

LIST OF STANDARDS (see proposal)

- 701001-01 TYPICAL APPLICATION OF TRAFFIC CONTROL DEVICES
- 701006-02
- 701011-01
- 701201-02
- 701301-02
- 701306-01
- 701311-02
- 702001-06
- 780001-01 TYPICAL PAVEMENT MARKINGS
- BLR 23-1 TRAFFIC BARRIER TERMINAL, TYPE I
- BLR 24-1 MAIL BOX TURNOUT FOR LOCAL ROADS

DESIGN CRITERIA

- MIN. ROW 60'
- MAX. GRADE
- MIN. S.D.
- DESIGN SPEED 50 M.P.H.
- CURRENT A.D.T. 1000 (2000)
- FUNCTIONAL CLASSIFICATION: MAJOR COLLECTOR 3R GUIDELINES

**QC/QA BITUMINOUS
SUPERPAVE PROJECT**

JOB NO. C-94-025-06
CONTRACT NO. 89388

J.U.L.I.E. 1-800-892-0123

F.A.S. ROUTE 450 SECTION 03-00125-00-RS
PROJECT RS-450(109)

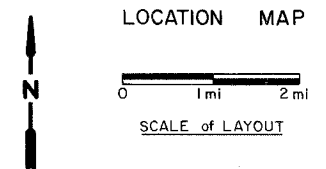
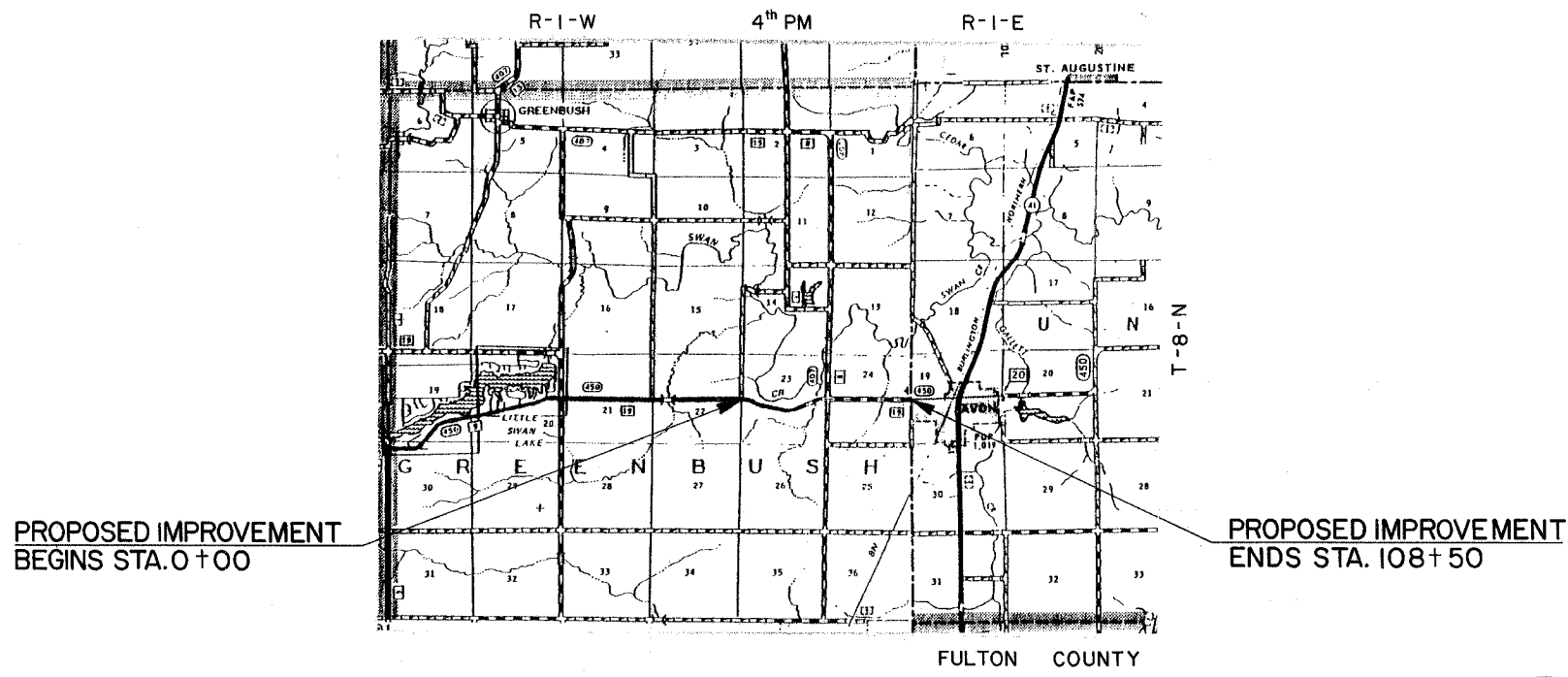
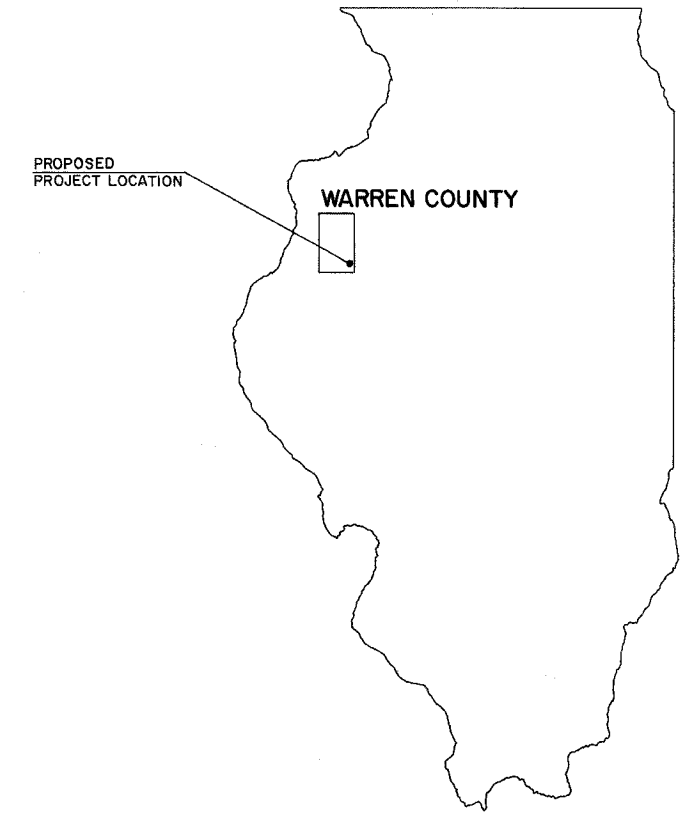

TOTAL and NET LENGTH of IMPROVEMENT: 10,850 Feet = 2.055 Miles



LICENSE EXPIRES 11/07/16
DATE

THESE PLANS WERE PREPARED BY ME OR A FULL TIME MEMBER OF MY STAFF WORKING UNDER MY PERSONAL SUPERVISION.

Jimmy B. Justus 4/17/06
JIMMY B. JUSTUS, P.E. 062-040197 DATE
COUNTY ENGINEER

APPROVED	<u>April 17</u>	20 <u>06</u>
	<i>Jim Justice</i> COUNTY ENGINEER	
APPROVED		20
	ROAD COMMISSIONER	
PASSED	<u>April 20</u>	20 <u>06</u>
	<i>Therese Laballe</i> DISTRICT FOUR ENGINEER OF LOCAL ROADS & STREETS	
Releasing For Bid Based on Limited Review	<u>April 21</u>	20 <u>06</u>
	<i>John E. Lane</i> DEPUTY DIRECTOR OF HIGHWAYS, REGION THREE ENGINEER	
	STATE OF ILLINOIS DEPARTMENT OF TRANSPORTATION	

SUMMARY OF QUANTITIES

CONSTRUCTION CODE: 1000

ROUTE	SECTION	COUNTY	Total Sheets	Sheet No.
FAS 450	03-00125-00-RS	WARREN	3	2
PROJECT NO. RS - 450(109)				

CONTRACT NO. 89388

ENTRANCE DETAIL

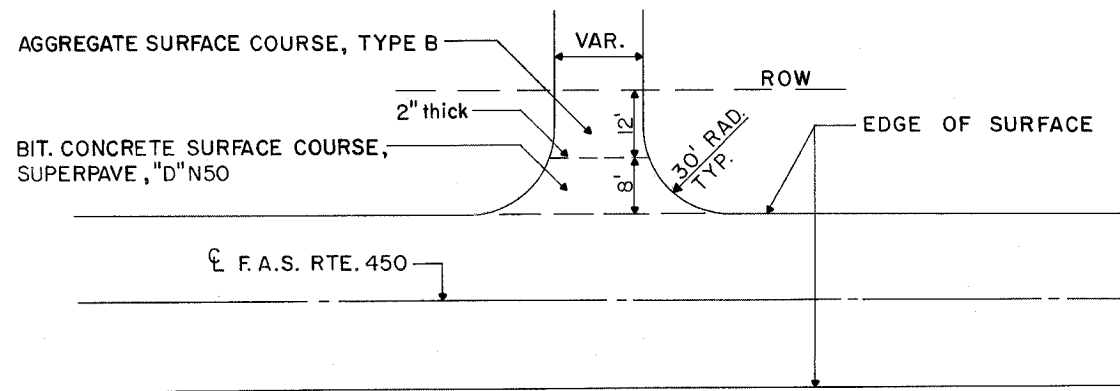

18 ENTRANCES AT 5 TONS = 90 TONS AGG. SURF. CSE., TY. B
 18 ENTRANCES AT 5 TONS = 90 TONS SUPERPAVE, "D" N50
 4 MAILBOX TURNOUTS AT 3 TONS = 12 TONS SUPERPAVE, "D" N50

PAVEMENT DESIGN DATA

PCC PAVEMENT SECTION

S.D.T. (2014) 1083 v.p.d. 15 Yr D.P.
 T.F. 0.500
 SN 2.87
 IBV 2.0
 (P.V. 95%, S.U. 3.5%, M.U. 1.5%)

BITUMINOUS SECTION

S.D.T. (2014) 1083 v.p.d. 15 Yr D.P.
 T.F. 0.080
 SN 3.15
 IBV 2.0
 (P.V. 95%, S.U. 3.5%, M.U. 1.5%)

CODE NO.	ITEM	UNIT	QUANT.
40200800	AGGREGATE SURFACE COURSE, TYPE B	TON	90.0
40600100	BITUMINOUS MATERIALS (PRIME COAT)	GALS.	2,148.0
40600300	AGGREGATE (PRIME COAT)	TON	79.0
48101200	AGGREGATE SHOULDERS, TYPE B	TON	912.0
63000005*	STEEL PLATE BEAM GUARDRAIL, TYPE B	FOOT	2,812.5
63200710	STEEL PLATE BEAM GUARDRAIL REMOVAL, TYPE A	FOOT	1,900.0
70101700	TRAFFIC CONTROL AND PROTECTION	L. SUM	1.0
70300100	SHORT-TERM PAVEMENT MARKING	FOOT	2,713.0
70301000	WORK ZONE PAVEMENT MARKING REMOVAL	SQ. FT.	905.0
78008210*	POLYUREA PAVEMENT MARKING, TYPE 1 - LINE 4"	FOOT	37,841.0
LR631020*	TRAFFIC BARRIER TERMINAL, TYPE 1	EACH	10.0
X4066424	BITUMINOUS CONCRETE SURFACE COURSE, SUPERPAVE, MIX "D", N50	TON	2,971.0
X4066765	LEVELING BINDER (MACHINE METHOD), SUPERPAVE, N50	TON	2,005.0
X4080020	INCIDENTAL BITUMINOUS SURFACING, SUPERPAVE, N50	TON	142.0
XX000405	BUTT JOINTS, SPECIAL	SQ. YD.	294.0
67100100	MOBILIZATION	L. SUM	1.0

Rate of application for Prime Coat

On Existing Pavement: 0.05 Gal/Sq. Yd.
 On Cold Milled Surface: 0.10 gals./sq. yd.
 On New Binder: 0.03 Gal/Sq. Yd.

Rate of application for Aggregate (Prime Coat)

On Existing Pavement: 4 lbs./sq. yd.
 On Cold Milled Surface: 4 lbs./sq. yd.
 On New Binder: 2 lbs./sq. yd.

BITUMINOUS MIXTURE REQUIREMENTS

Mixture Use(s)	Surface Course	Leveling Binder
AC/PG	64-22	64-22
RAP%	15%	15%
Design Air Voids	4.2% @ N = 50	4.2% @ N = 50
Mixture Composition	IL 9.5	IL 9.5
Friction Aggregate	Mixture "D"	N/A

Steel Plate Beam Guardrail Stations

Left	to	Right	Total Feet
19+06.25	to	23+43.75	437.5
42+91.5	to	51+66.5	875.0
45+17	to	53+04.5	787.5
85+81	to	89+93.5	412.5
85+41	to	88+41	300.0
TOTAL LENGTH			2812.5

Traffic Barrier Terminal, Type 1 Stations

Left	18+81.25	to	19+06.25
Left	23+43.75	to	23+68.75
Right	42+66.5	to	42+91.5
Right	51+66.5	to	51+91.5
Left	44+92	to	45+17
Left	53+04.5	to	53+29.5
Left	85+56	to	85+81
Left	89+93.5	to	90+18.5
Right	85+16	to	85+41
Right	88+41	to	88+66

POLYUREA PAVEMENT MARKING BREAKDOWN

4" Yellow - Centerline	16,436 Feet
4" White - Edge Stripe	21,405 Feet
TOTAL	37,841 Feet

* SPECIALTY ITEMS

BUTT JOINT DETAIL

Stations
 0 + 00
 108 + 50

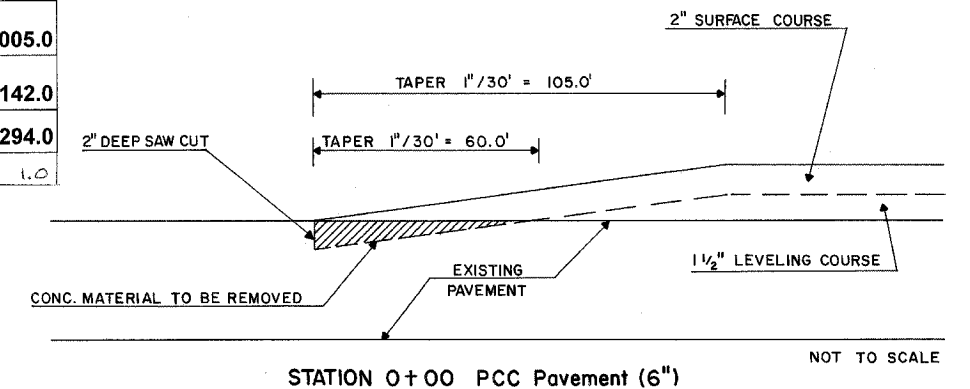

INTERSECTION DETAIL

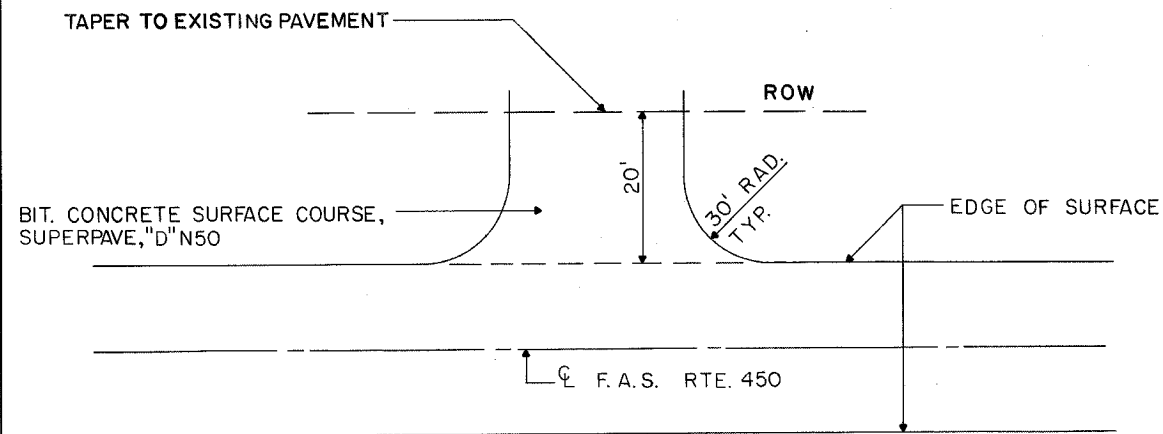

4 INTERSECTIONS AT 10 TONS
 TOTAL = 40 TONS

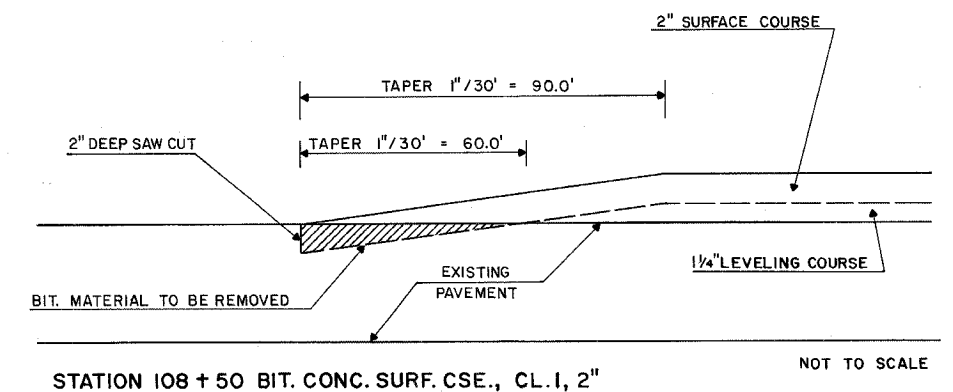

ROUTE	SECTION	COUNTY	Total Sheets	Sheet No
FAS 450	03-00125-00-RS	WARREN	3	3

PROJECT NO. RS - 450(109)

CONTRACT NO. 89388

TYPICAL CROSS SECTION - EXISTING PCC PAVEMENT SECTION
STA. 0+00 to STA. 42+24

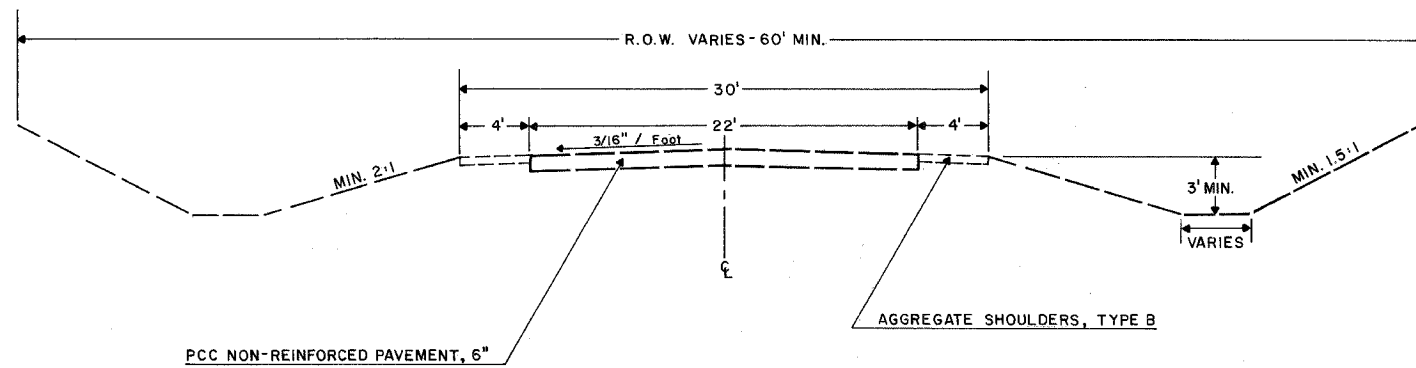

TYPICAL CROSS SECTION - EXISTING BITUMINOUS SECTION
STA. 42+24 to STA. 108+50

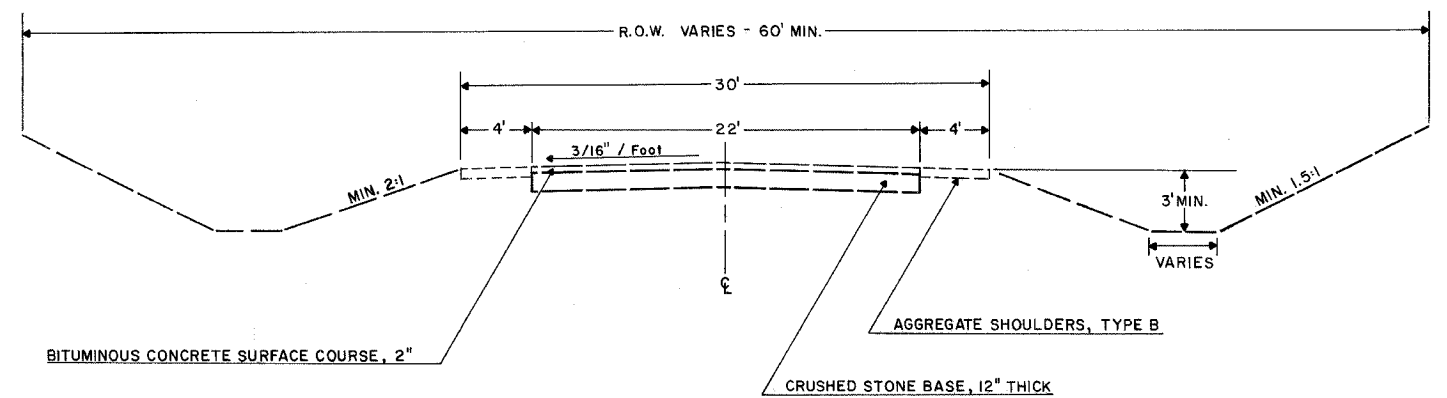

PROPOSED TYPICAL CROSS SECTION
STA. 0+00 to STA. 42+24

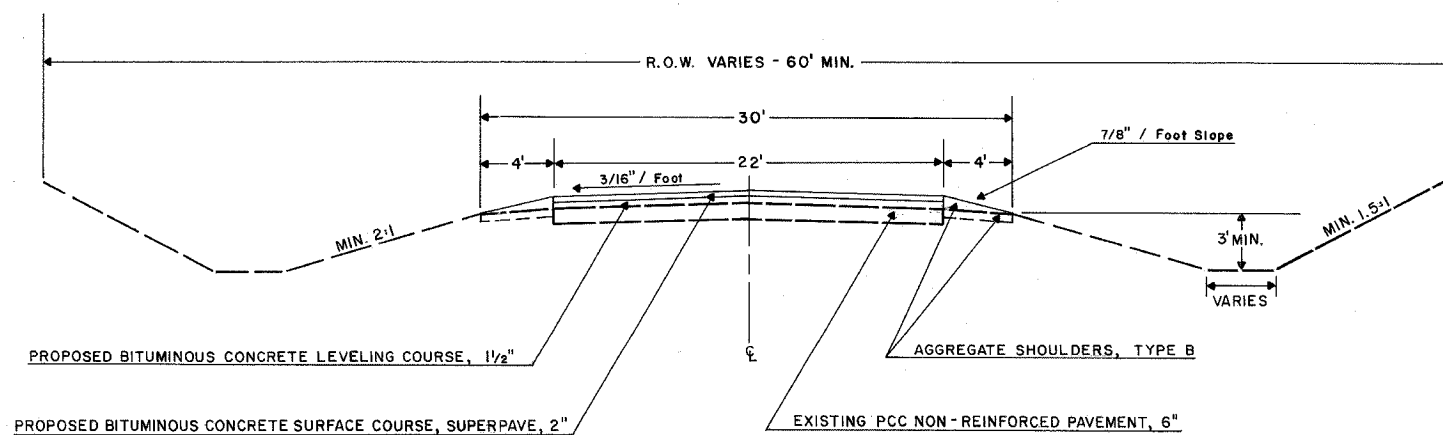

PROPOSED TYPICAL CROSS SECTION
STA. 42+24 to STA. 108+50

