

F.A. RTE.	SECTION	COUNTY	TOTAL SHEETS	SHEET NO.
2360	04-00058-08-FP	WOODFORD	8	1

INDEX OF SHEETS

SHEET NO.	DESCRIPTION
1	COVER SHEET
2	GENERAL NOTES & TYPICAL SECTIONS
3	SCHEDULE OF QUANTITIES
4-7	PLAN SHEETS
8	DETAIL SHEETS

IDOT HIGHWAY STANDARDS

000001-04	STANDARD SYMBOLS, ABBREVIATIONS AND PATTERNS
630001-06	STEEL PLATE BEAM GUARDRAIL
635006-02	REFLECTOR AND TERMINAL MARKER PLACEMENT
701101-01	OFF-RD OPERATIONS, MULTILANE, 15' TO 24" FROM PAVEMENT EDGE
701301-02	LANE CLOSURE, 2L, 2W, SHORT TIME OPERATIONS
701306-01	LANE CLOSURE, 2L, 2W, SLOW MOVING OPERATIONS DAY ONLY, FOR SPEEDS >= 45 MPH
702001-06	TRAFFIC CONTROL DEVICES
BLR 24-1	MAILBOX TURNOUT FOR LOCAL ROADS

SUMMARY OF QUANTITIES

ITEM #	DESCRIPTION	UNIT	QUANTITY
40200800	AGGREGATE SURFACE COURSE, TYPE B	TON	580
40600100	BITUMINOUS MATERIALS (PRIME COAT)	GALLON	475
40600300	AGGREGATE (PRIME COAT)	TON	10
40600980	BITUMINOUS SURFACE REMOVAL - BUTT JOINT	50 YD	170
48101200	AGGREGATE SHOULDERS, TYPE B	TON	6,145
63301000	REMOVE AND RE-ERECT STEEL PLATE BEAM GUARD RAIL	FOOT	8,100
63301990	REMOVE AND RE-ERECT TRAFFIC BARRIER TERMINAL, TY 1	EACH	46
67100100	MOBILIZATION	L SUM	1
70300100	SHORT-TERM PAVEMENT MARKING	FOOT	1,960
78100100	RAISED REFLECTIVE PAVEMENT MARKER	EACH	250
X4066514	POLYMERIZED BITUMINOUS CONCRETE SURFACE COURSE, SUPERPAVE, MIX C, N50	TON	3,470
X4066765	LEVELING BINDER (MACHINE METHOD), SUPERPAVE N50	TON	5,550
XX004949	INCIDENTAL BITUMINOUS SURFACING, SUPERPAVE	TON	530
X4066514	BITUMINOUS CONCRETE BINDER COURSE, SUPERPAVE, IL-12.0, N50	TON	4,160

STATE OF ILLINOIS
DEPARTMENT OF TRANSPORTATION
DIVISION OF HIGHWAYS

**PLANS FOR PROPOSED
LOCAL AGENCY IMPROVEMENT
FEDERAL-AID SECONDARY PROJECT**

STU PROGRAM
F.A.S. ROUTE 2360 (SANTA FE TRAIL)
COUNTY HIGHWAY #25

PROJECT NO. **5093(124)**
JOB NO. C-94-026-06
SECTION 04-00058-08-FP
WOODFORD COUNTY

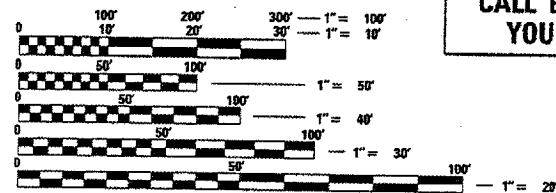
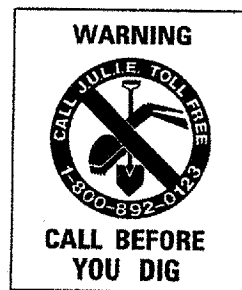
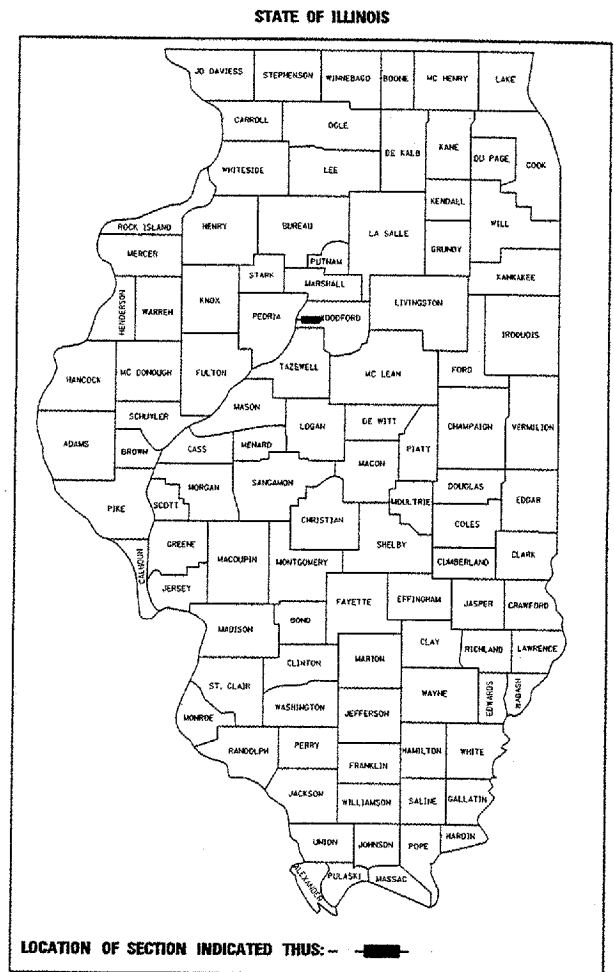

FULL SIZE PLANS HAVE BEEN PREPARED USING STANDARD ENGINEERING SCALES. REDUCED SIZED PLANS WILL NOT CONFORM TO STANDARD SCALES. IN MAKING MEASUREMENTS ON REDUCED PLANS, THE ABOVE SCALES MAY BE USED.

J.U.L.I.E.
JOINT UTILITY LOCATION INFORMATION FOR EXCAVATION
1-800-892-0123

CONTRACT NO. 89389

IMPROVEMENT BEGINS
STA 233+00

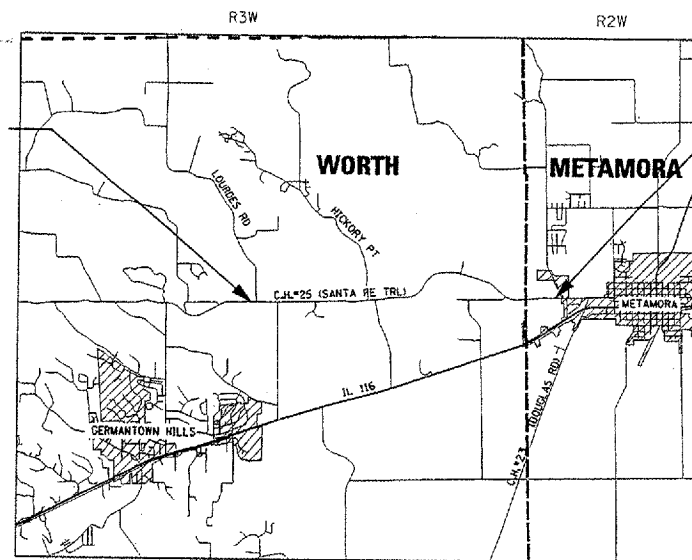

IMPROVEMENT ENDS
STA 428+40

DESIGN INFORMATION:

LOCAL ROADS FUNCTIONAL CLASS:
MAJOR COLLECTOR
2016 ADT = 1770 (7% TRUCKS)
DESIGN SPEED: 40 MPH
DESIGN GUIDELINES: URBAN
VARIANCES GRANTED: NONE
COMMITMENTS: NONE

UTILITIES

(TO BE DETERMINED)

IMPROVEMENT CONSISTS OF THE CONSTRUCTION OF BITUMINOUS CONCRETE BINDER AND SURFACE COURSE OVER AN EXISTING OIL & CHIP ROADWAY, INCLUDING PROPOSED AGGREGATE SHOULDERS AND REMOVAL AND RE-ERECTION OF GUARDRAIL AND TERMINALS.

GROSS AND NET LENGTH OF PROJECT = 19,500 FT. (3.7 MI)

PLANS DEVELOPED IN ACCORDANCE WITH
THE IDOT LOCAL ROADS MANUAL (APRIL 2005)

THESE PLANS HAVE BEEN PREPARED BY OR UNDER THE DIRECTION OF:

DATE: 4/18/06
SIGNED: Dennis D. Bachman
LICENSE EXPIRES: NOVEMBER 30, 2007

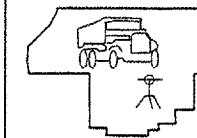
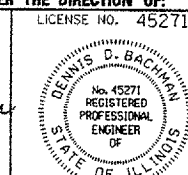

**WOODFORD COUNTY
HIGHWAY DEPARTMENT**
DENNIS BACHMAN, P.E., COUNTY ENGINEER
301 S. Main St., P.O. Box 467
Roanoke, IL 61561-0467
TEL: 309-923-2891
FAX: 309-923-7928

APPROVED: 4/18/06
Dennis D. Bachman
COUNTY ENGINEER

PASSED: 4-20-06
David Laballe
DISTRICT FOUR ENGINEER OF
LOCAL ROADS & STREETS

Releasing For
Bid Based on
Limited Review: Amy W
DEPUTY DIRECTOR OF HIGHWAYS,
REGION THREE ENGINEER

STATE OF ILLINOIS
DEPARTMENT OF TRANSPORTATION

PRINTED BY THE AUTHORITY OF THE STATE OF ILLINOIS