

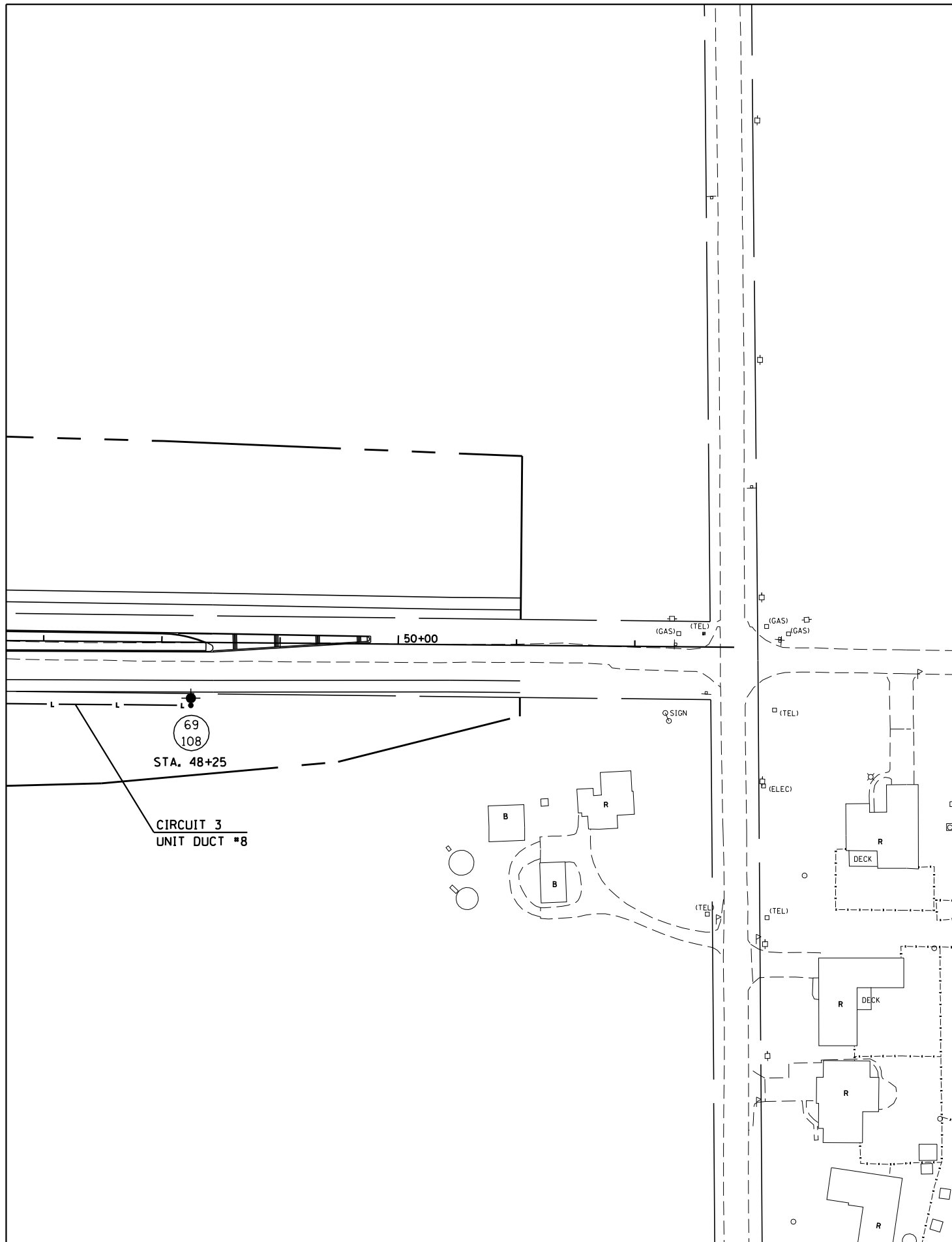

F.A.I. RTE.	SECTION	COUNTY	TOTAL SHEETS	SHEET NO.
57	10-32HB-3K,K	CHAMPAIGN	352	87

CONTRACT NO. 90758

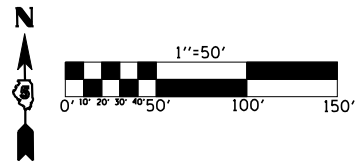

 LIGHT POLE, STEEL, 45' MH
 LUMINAIRE, 250 WATT
 8' METAL FOUNDATION

 LIGHT POLE, STEEL, 45' MH - TWIN
 2 LUMINAIRES, 250 WATT
 8' METAL FOUNDATION

NOTE: THE FINAL LOCATION OF ALL LIGHT POLE FOUNDATIONS AND WIRING SHALL BE DETERMINED BY THE ENGINEER IN THE FIELD.

ILLINOIS DEPARTMENT OF TRANSPORTATION

LIGHTING PLANS