

F.A.I. RTE.	SECTION	COUNTY	TOTAL SHEETS	SHEET NO.
57	10-32HB-3,K	CHAMPAIGN	352	310
STA. 9+00.00		TO STA. 10+00.00		
FED. ROAD DIST. NO.		ILLINOIS FED. AID PROJECT		

RAMP B

BY	DATE

FINAL SURVEY	SURVEYED	DATE

NO.	NOTE BOOK	PLOTTED	AREAS CHECKED

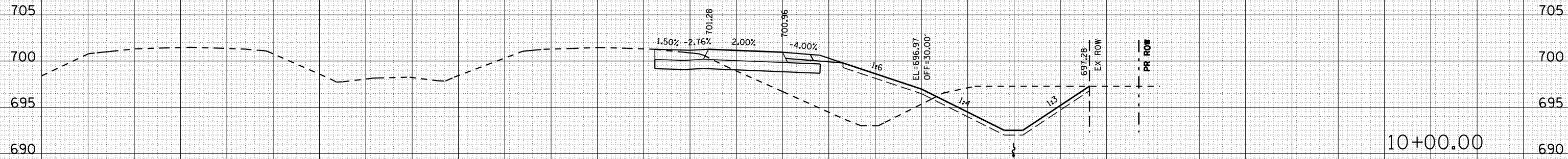

TSC=0.0
 C=109.5
 F=156.0
 TSF=26.6

BY	DATE

ORIGINAL SURVEY	SURVEYED	DATE

NO.	NOTE BOOK	PLOTTED	AREAS CHECKED

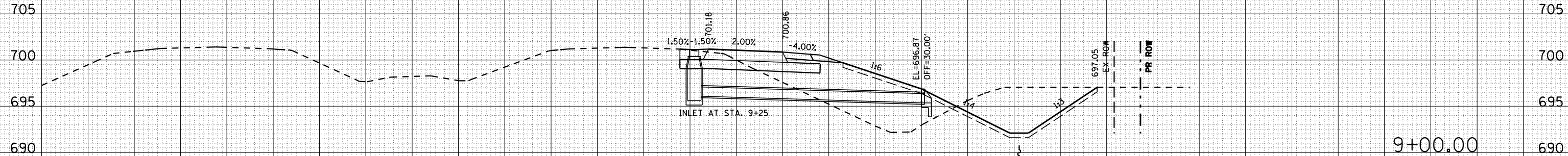

TSC=0.0
 C=103.1
 F=153.1
 TSF=27.4