

ROUTE NO.	SECTION	COUNTY	TOTAL SHEETS	SHEET NO.
F.A.S. 1425	99-00103-00-FP	HANCOCK	11	1
F.H.W.A. REG. NO. 4	ILLINOIS	PROJ. NO.		

**STATE OF ILLINOIS
DEPARTMENT OF TRANSPORTATION
DIVISION OF HIGHWAYS**

PLANS FOR PROPOSED SURFACE TRANSPORTATION/RURAL PROGRAM

**F.A.S. ROUTE 1425/C.H. 26
SECTION 99-00103-00-FP
HANCOCK COUNTY
PROJECT NO. SR-1425 (103)
JOB NO. C-96-227-03**

INDEX OF SHEETS

SHEET NO.	TITLE
1.	COVER SHEET
2.	SUMMARY OF QUANTITIES/TYPICAL SECTION/GENERAL NOTES
3.	INTERSECTION, ENTRANCE & MAILBOX TURNOUT DETAILS
4. - 6.	PLAN & PROFILE
7. - 11.	ROADWAY CROSS SECTIONS

SCALES

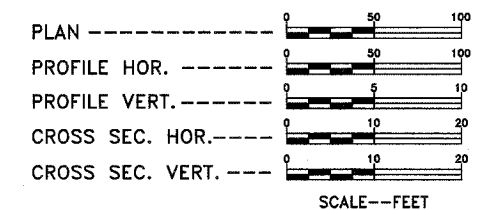

LIST OF STANDARDS

- 280001-02
- 601001
- 601101
- 630001-06
- 701201-02
- 702001-06
- BLR 21-6
- BLR 22-4
- BLR 23-1

UTILITIES

NAME	ADDRESS
NICOR GAS	(630) 896-1000
W.I.E.C.	(217) 357-3125
FRONTIER COMMUNICATIONS	(217) 854-3126
MCLEOD USA	(217) 876-7194
DALLAS RURAL WATER DIST.	(309) 337-3718

TOLL FREE JOINT UTILITY LOCATING
INFORMATION FOR EXCAVATORS (J.U.L.I.E.)
TELEPHONE NUMBER 1-800-892-0123

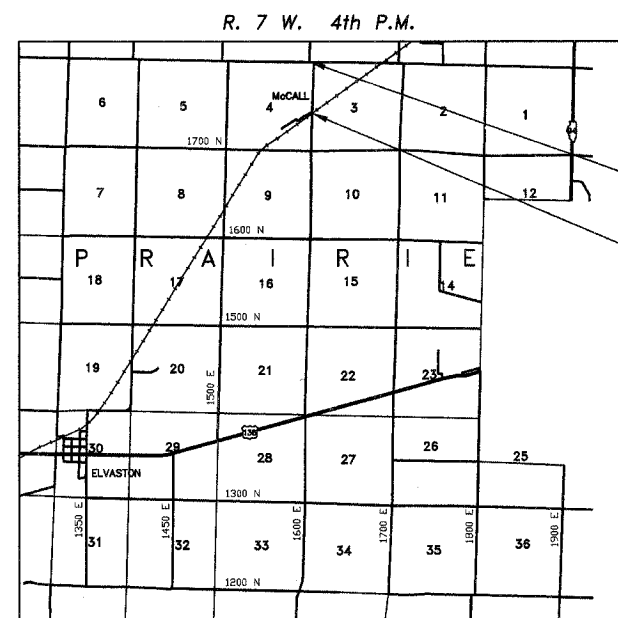

IMPROVEMENT ENDS
STA. 217+30.80

IMPROVEMENT BEGINS
STA. 136+50.00

SECTION 99-00103-00-FP CONSISTS OF A FOUR AND ONE-HALF INCH BY 24 FOOT WIDE BITUMINOUS CONCRETE BINDER COURSE AND AN INCH AND ONE-HALF BY 22 FOOT WIDE BITUMINOUS CONCRETE SURFACE COURSE ON A PROPOSED AGGREGATE BASE COURSE TYPE A.

LOCATION MAP

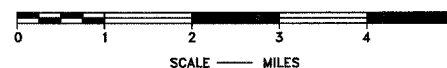

NET LENGTH OF SECTION = 3080.80 FEET = 0.583 MILES

RURAL COLLECTOR
ADT = <400
DESIGN SPEED: 40 MPH

THESE PLANS WERE PREPARED BY ME OR BY A FULL-TIME MEMBER OF MY STAFF WORKING UNDER MY PERSONAL SUPERVISION.

Paul E. Sly
PAUL E. SLY
COUNTY ENGINEER
ILLINOIS PROFESSIONAL NO. 082-043309
EXPIRES 11/30/2007

APPROVED 2/10 *Paul E. Sly* 2006
COUNTY ENGINEER

PASSED MARCH 1 2006
Jim Mc...
DISTRICT SIX ENGINEER OF LOCAL ROADS & STREETS

PASSED MARCH 1 2006
W.R. Jones
DISTRICT SIX ENGINEER OF CONSTRUCTION

RELEASING FOR BID BASED ON LIMITED REVIEW MARCH 1 2006
Christine M Reed
DEPUTY DIRECTOR OF HIGHWAYS/ REGION FOUR ENGINEER

STATE OF ILLINOIS
DEPARTMENT OF TRANSPORTATION