

LIST OF QUANTITIES

QUANTITY	UNIT	ITEM
36	SQ. FT.	SIGN PANEL - TYPE 1
1	EACH	SERVICE INSTALLATION, SPECIAL
449	FOOT	CONDUIT IN TRENCH, 1-1/2" DIA., PVC
6	FOOT	CONDUIT IN TRENCH, 2" DIA., PVC
4	FOOT	CONDUIT IN TRENCH, 2-1/2" DIA., PVC
37	FOOT	CONDUIT IN TRENCH, 3" DIA., PVC
16	FOOT	CONDUIT IN TRENCH, 4" DIA., PVC
345	FOOT	CONDUIT AUGERED, 1-1/2" DIA., PVC
36	FOOT	CONDUIT AUGERED, 2" DIA., PVC
25	FOOT	CONDUIT AUGERED, 2-1/2" DIA., PVC
114	FOOT	CONDUIT AUGERED, 3" DIA., PVC
76	FOOT	CONDUIT AUGERED, 4" DIA., PVC
3	EACH	JUNCTION BOX (SPECIAL)
4	EACH	CONCRETE HANDHOLE
1	EACH	CONCRETE DOUBLE HANDHOLE
512	FOOT	TRENCH AND BACKFILL FOR ELECTRIC WORK
2	EACH	LUMINAIRE, SODIUM VAPOR, HORIZONTAL MOUNT, PHOTO-CELL CONTROL, 250WATT
1	EACH	FULL-ACTUATED CONTROLLER, AND TYPE IV CABINET
1	EACH	FIBER OPTIC TRANSCIVER
398	FOOT	ELECTRIC CABLE IN CONDUIT, SIGNAL NO. 12, 3C
529	FOOT	ELECTRIC CABLE IN CONDUIT, SIGNAL NO. 14, 3C
335	FOOT	ELECTRIC CABLE IN CONDUIT, SIGNAL NO. 14, 5C
714	FOOT	ELECTRIC CABLE IN CONDUIT, SIGNAL NO. 14, 7C
324	FOOT	ELECTRIC CABLE IN CONDUIT, SIGNAL NO. 14, 9C
405	FOOT	ELECTRIC CABLE IN CONDUIT, SIGNAL NO. 14, 12C
689	FOOT	ELECTRIC CABLE IN CONDUIT, LEAD IN, NO. 18, 6 PAIR
64	FOOT	ELECTRIC CABLE IN CONDUIT, SERVICE, NO. 6 2C
3402	FOOT	ELECTRIC CABLE IN CONDUIT, GROUND, NO. 6 1C (GREEN)
2	EACH	TRAFFIC SIGNAL POST, ALUMINUM, 14 FT
2	EACH	TRAFFIC SIGNAL POST, ALUMINUM, 16 FT
1	EACH	STEEL COMBINATION, MAST ARM ASSEMBLY AND POLE, 32FT
1	EACH	STEEL COMBINATION, MAST ARM ASSEMBLY AND POLE, 26FT
1	EACH	STEEL, MAST ARM ASSEMBLY AND POLE, 32 FT
1	EACH	STEEL, MAST ARM ASSEMBLY AND POLE, 26 FT
12	FOOT	CONCRETE FOUNDATION, TYPE A
3	FOOT	CONCRETE FOUNDATION, TYPE D
47	FOOT	CONCRETE FOUNDATION, TYPE E, 30 INCH DIA. (2-10' DEPTH, 2-13'6" DEPTH)
15	EACH	TRAFFIC SIGNAL BACKPLATE, LOUVERED
8	EACH	PEDESTRIAN PUSH-BUTTON
1	EACH	VIDEO VEHICLE DETECTION SYSTEM
4	EACH	CAMERA MOUNTING ASSEMBLY
914	FOOT	FIBER OPTIC CABLE IN CONDUIT, 62.5/125 6F
4	EACH	SIGNAL HEAD, POLYCARBONATE, LED, 1-FACE 3-SECTION, BRACKET MOUNTED
6	EACH	SIGNAL HEAD, POLYCARBONATE, LED, 1-FACE 3-SECTION, MAST ARM MOUNTED
4	EACH	SIGNAL HEAD, POLYCARBONATE, LED, 2-FACE 3-SECTION, BRACKET MOUNTED
6	EACH	PEDESTRIAN SIGNAL HEAD, POLYCARBONATE, LED, 1-FACE, BRACKET MOUNTED, COUNTDOWN TIMER
1	EACH	PEDESTRIAN SIGNAL HEAD, POLYCARBONATE, LED, 2-FACE, BRACKET MOUNTED, COUNTDOWN TIMER
1	EACH	DRILL EXISTING HANDHOLE

LEGEND

PROPOSED	EXISTING	DISCRPTION
	-	DOUBLE HANDHOLE
	-	HANDHOLE
	-	CONTROLLER AND TYPE IV CABINET
	-	STEEL MAST ARM ASSEMBLY AND POLE
	-	SIGNAL HEAD
	-	SIGNAL HEAD WITH BACKPLATE
	-	PEDESTRIAN SIGNAL HEAD - COUNT DOWN
	-	CONDUIT
	-	LUMINAIRE
	-	JUNCTION BOX, SPECIAL
	-	UTILITY POLE

ROUTE NO.	SEC.	COUNTY	TOTAL SHEETS	SHEET NO.
7989	*	SANGAMON	7	4
STA.		TO STA.		
		ILLINOIS PROJECT		

* 04-00441-00-TL

92419

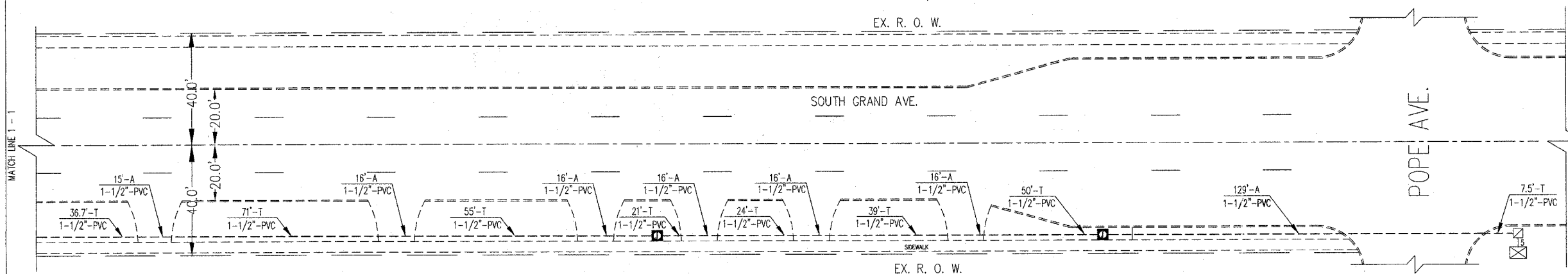
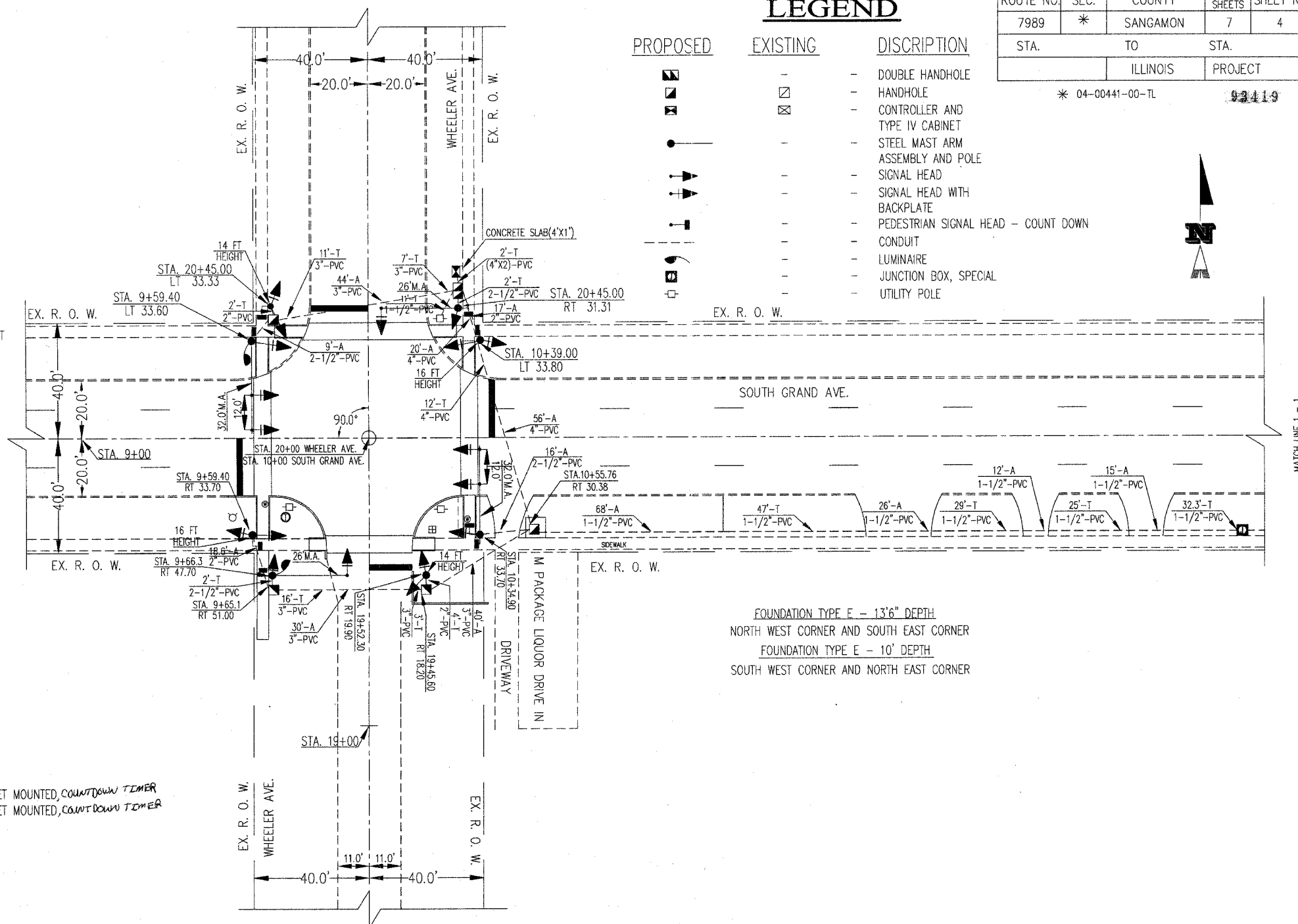

TRAFFIC SIGNAL PLAN
SOUTH GRAND AVE. AND WHEELER AVE.
CITY OF SPRINGFIELD, ILLINOIS
OFFICE OF PUBLIC WORKS
TRAFFIC ENGINEERING

DESIGNED BY:	SCALE: 1:20	SHEET 4
DRAWN BY:		OF
CHECKED BY:	DATE:	7 OF SHEETS
PROTOTYPE/LEGEND DWG		