

F.A.I. RTE.	SECTION	COUNTY	TOTAL SHEETS	SHEET NO.
70	(25-3,4)RS-2	EFFINGHAM	25	1

D-97-011-03

STATE OF ILLINOIS  
DEPARTMENT OF TRANSPORTATION  
DIVISION OF HIGHWAYS

**PROPOSED  
HIGHWAY PLANS**

FAI ROUTE 70 (I-70)  
SECTION (25-3,4)RS-2  
PROJECT: IM-070-3(115)096  
EFFINGHAM COUNTY  
INTERSTATE RESURFACING  
C-97-023-03

FOR INDEX OF SHEETS, SEE SHEET NO. 2

**STATION EQUATIONS**

STA. 2092 + 89.56 (BK) = STA. 2090 + 08.88 (AH) EB  
STA. 2090 + 06.84 (BK) = STA. 2090 + 08.88 (AH) WB

**BRIDGE OMISSIONS**

STA. 2001 + 58.87 TO STA. 2005 + 81.12  
STA. 2103 + 44 TO STA. 2121 + 44  
STA. 5028 + 25.67 TO STA. 5030 + 75.54 (RAMP C)

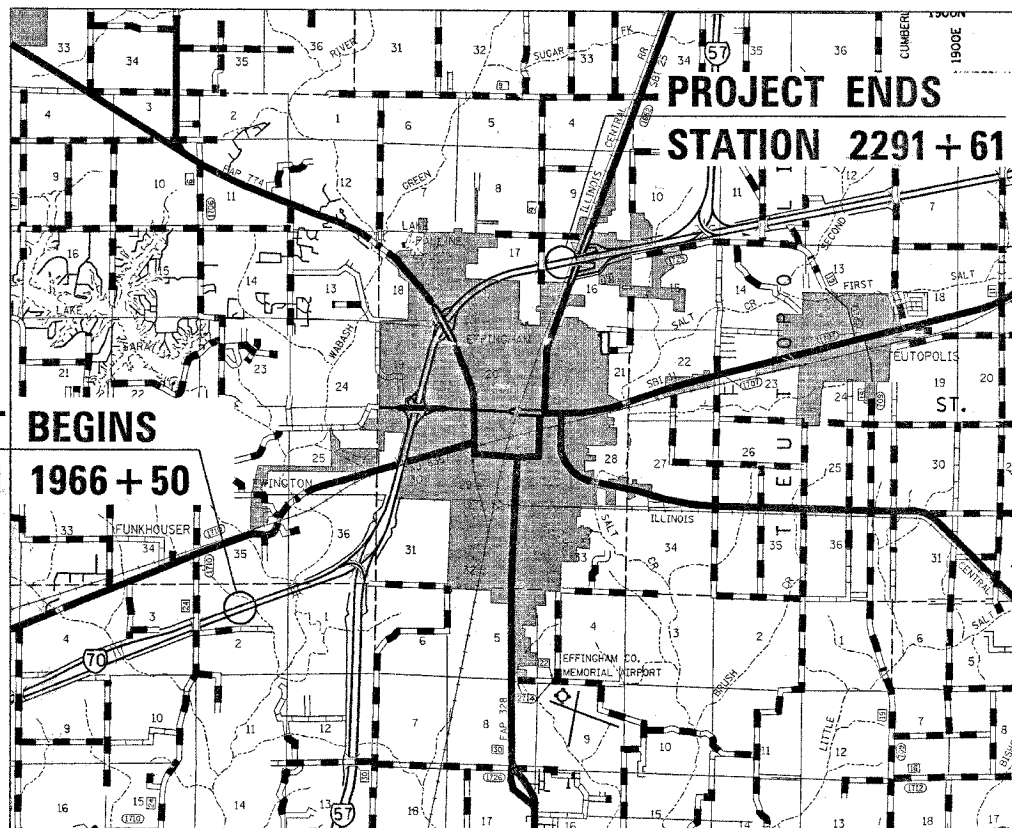
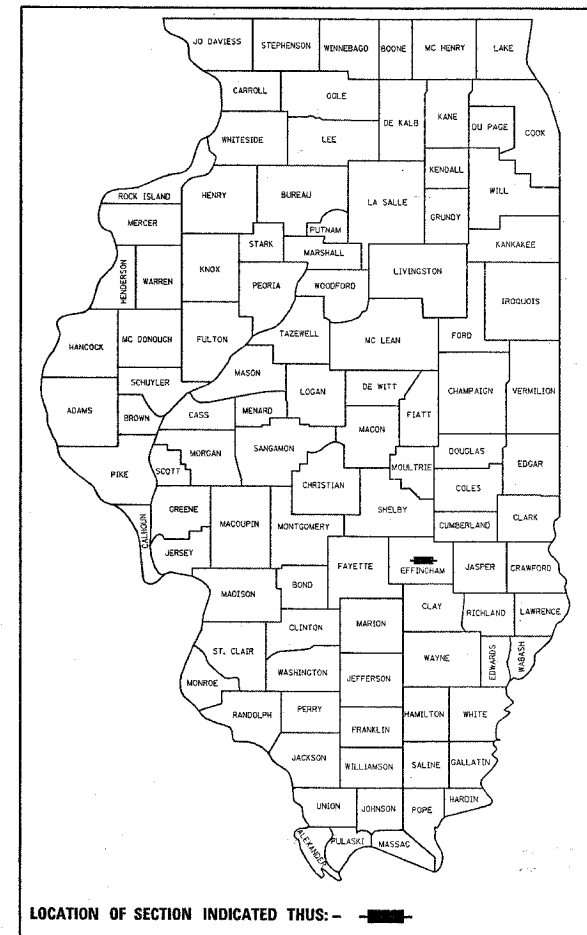

LOCATION MAP

SCALE: 1" = 1 MILE

GROSS PROJECT LENGTH: 32,511.00 FEET = 6.157 MILES  
NET PROJECT LENGTH: 30,036.84 FEET = 5.689 MILES

ADT (2005) = 37,900

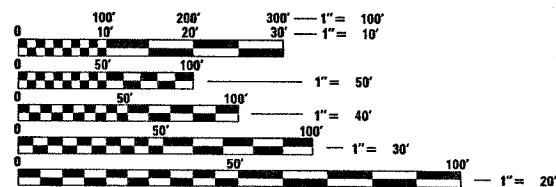

FULL SIZE PLANS HAVE BEEN PREPARED USING STANDARD ENGINEERING SCALES. REDUCED SIZED PLANS WILL NOT CONFORM TO STANDARD SCALES. IN MAKING MEASUREMENTS ON REDUCED PLANS, THE ABOVE SCALES MAY BE USED.

J.U.L.I.E.  
JOINT UTILITY LOCATION INFORMATION FOR EXCAVATION  
1-800-892-0123

CONTRACT NO. 94976

TOWNSHIP: JACKSON, SUMMIT & DOUGLAS

PROJECT ENGINEER: MARK DAUCO JERTY  
SQUAD LEADER: JOYCE HEMMEN  
DESIGNER: EVAN RUSSELL  
TELEPHONE: (217) 342-3951 EXT. 313

STATE OF ILLINOIS  
DEPARTMENT OF TRANSPORTATION  
DIVISION OF HIGHWAYS

SUBMITTED 3-30 20 06  
*Christine M. Reed*  
DEPUTY DIRECTOR OF HIGHWAYS, REGION ENGINEER

May 12, 20 06  
*Mike Hine*  
ENGINEER OF DESIGN AND ENVIRONMENT

May 12, 20 06  
*Milton R. Seo*  
DIRECTOR OF HIGHWAYS, CHIEF ENGINEER

PRINTED BY THE AUTHORITY  
OF THE STATE OF ILLINOIS

F.A.I. RTE.	SECTION	COUNTY	TOTAL SHEETS	SHEET NO.
70	(25-3,4)RS-2	EFFINGHAM	25	2
STA.		TO STA.		
FED. ROAD DIST. NO.	ILLINOIS	FED. AID PROJECT		

## INDEX OF SHEETS

SHEET NO.	ITEM
1	COVER SHEET
2	INDEX OF SHEETS AND LIST OF STANDARDS
3	GENERAL NOTES
4	SUMMARY OF QUANTITIES
5	TYPICAL SECTION
6	PAVING SCHEDULE AND GUARDRAIL SCHEDULE
7	PAVEMENT MARKING SCHEDULE
8-19	PLAN SHEETS
20-25	TRAFFIC CONTROL PLANS

## LIST OF STANDARDS IN THE PLANS

THE FOLLOWING STANDARDS ARE A PART OF THESE PLANS AND ARE INCLUDED AFTER SHEET NO. 25:

STD. NO.	DESCRIPTION
000001-04	STANDARD SYMBOLS, ABBREVIATIONS, AND PATTERNS
001001	AREAS OF REINFORCEMENT BARS
001006	DECIMAL OF AN INCH AND A FOOT
442101-05	CLASS B PATCHES
630001-06	STEEL PLATE BEAM GUARDRAIL
630101-06	GUARDRAIL MOUNTED ON EXISTING CULVERTS
635011-01	REFLECTOR MARKER AND MOUNTING DETAILS
701101-01	OFF-RD OPERATIONS, MULTILANE, 15' TO 24" FROM PAVEMENT EDGE
701106-01	OFF-RD OPERATIONS, MULTILANE, MORE THAN 15' AWAY
701400-02	APPROACH TO LANE CLOSURE, FREEWAY/EXPRESSWAY
701401-03	LANE CLOSURE, FREEWAY/EXPRESSWAY
701406-04	LANE CLOSURE, FREEWAY/EXPRESSWAY, DAY OPERATIONS ONLY
701411-03	LANE CLOSURE, MULTILANE, AT ENTRANCE OR EXIT RAMP, FOR SPEEDS >=45 MPH
701421-01	LANE CLOSURE, MULTILANE, DAY OPERATIONS ONLY, FOR SPEEDS >=45 MPH TO 55 MPH
701422-01	LANE CLOSURE, MULTILANE, FOR SPEEDS >=45 MPH TO 55 MPH
701426-02	LANE CLOSURE, MULTILANE, INTERMITTENT OR MOVING OPER., FOR SPEEDS >=45 MPH
702001-06	TRAFFIC CONTROL DEVICES
780001-01	TYPICAL PAVEMENT MARKINGS
781001-02	TYPICAL APPLICATIONS RAISED REFLECTIVE PAVEMENT MARKERS
886001	DETECTOR LOOP INSTALLATIONS
886006	TYPICAL LAYOUTS FOR DETECTION LOOPS

PLOT DATE = 3/30/2006  
 PLOT SCALE = #SCALE  
 USER NAME = #district

REVISIONS		ILLINOIS DEPARTMENT OF TRANSPORTATION
NAME	DATE	
		INDEX OF SHEETS STANDARDS IN THE PLANS
SCALE:	VERT. HORIZ.	DRAWN BY CHECKED BY
DATE		

F.A.I. RTE.	SECTION	COUNTY	TOTAL SHEETS	SHEET NO.
70	(25-3,4)RS-2	EFFINGHAM	25	3
STA.		TO STA.		
FED. ROAD DIST. NO.		ILLINOIS	FED. AID PROJECT	

### GENERAL NOTES

THE WORK INCLUDED IN THIS SECTION CONSISTS OF REHABILITATING APPROXIMATELY 5.7 MILES OF INTERSTATE 70 AND THE MERGING RAMPS OF INTERSTATE 57. THE PROJECT BEGINS 2 MILES WEST OF EFFINGHAM AND ENDS AT THE U.S. 45 OVERHEAD STRUCTURE. THE SCOPE OF WORK WILL INCLUDE PATCHING, 2" MILLING, 2" BITUMINOUS SURFACE, WIDENING THE MAINLINE SURFACE PAVEMENT TO ALIEVIATE REFLECTIVE CRACKING BETWEEN THE EDGE OF PAVEMENT AND BITUMINOUS SHOULDER, REPLACING ANY DAMAGED GUARDRAIL, STRIPING, AND NEW RAISED REFLECTIVE PAVEMENT MARKERS.

THE CONTRACTOR WILL BE REQUIRED TO USE EITHER SS-1HP OR RC-70 AS THE BITUMINOUS MATERIALS PRIME COAT.

THE CONTRACTOR SHALL PROVIDE INTERNET ACCESS TO THE BITUMINOUS PLANT QUALITY CONTROL LAB SO THAT BITUMINOUS PLANT REPORTS CAN BE E-MAILED TO THE DISTRICT HEADQUARTERS. THIS WORK SHALL BE INCLUDED IN THE COST OF ALL BITUMINOUS ITEMS.

BITUMINOUS SURFACE COURSE SHALL NOT BE PLACED WHENT THE AIR TEMPERATURE IS BELOW 40 DEGREES FARENHEIT.

PREFORMED PLASTIC PAVEMENT MARKINGS, TYPE B SHALL BE APPLIED ON THE CENTERLINE IN ACCORDANCE WITH THE REQUIREMENTS OF TYPE A AS SPECIFIED IN ARTICLE 780.07(c) OF THE STANDARD SPECIFICATIONS FOR ROAD AND BRIDGE CONSTRUCTION.

EDGE OF PAVEMENT LINES WILL CONSIST OF POLYUREA PAVEMENT MARKING TYPE II - LINE 4".

EDGE LINE STRIPING WILL BE PUT BACK IN TO ACCOMODATE A 12' LANE WIDTH THROUGHOUT THE JOB.

THE RESIDENT ENGINEER SHALL BE THE SOLE JUDGE CONCERNING THE CURING TIME FOR THE VARIOUS BITUMINOUS LIFTS.

THE FOLLOWING POLYMERIZED BITUMINOUS CONCRETE SURFACE COURSE, SUPERPAVE, MIXTURE E, N 105 MIXTURE REQUIREMENTS ARE APPLICABLE TO THIS PROJECT:

MIXTURE USE:	SURFACE COURSE
PG GRADE:	SBS PG 70-22
RAP%:	0%
DESIGN AIR VOIDS:	4.0% @ NDESIGN = 105
MIXTURE COMPOSITION:	IL-9.5
FRICTION AGGREGATE:	MIXTURE E

THE EXISTING PAVEMENT SHALL BE PATCHED IN ACCORDANCE WITH SECTION 442 OF THE STANDARD SPECIFICATIONS FOR ROAD AND BRIDGE CONSTRUCTION. THE QUANTITIES OF PATCHING ARE ESTIMATES ONLY AND THE FINAL QUANTITIES AND PATCH LOCATIONS SHALL BE DETERMINED BY THE ENGINEER. CALCIUM CHLORIDE ACCELERATOR WILL BE ALLOWED FOR PAVEMENT PATCHING: (SEE SPECIAL PROVISION)

THE FOLLOWING RATES OF APPLICATION HAVE BEEN USED IN CALCULATING PLAN QUANTITIES:

BITUMINOUS MATERIALS (PRIME COAT)	0.10 GAL/SQ YD
AGGREGATE (PRIME COAT)	4.00 LBS/SQ YD
BITUMINOUS CONCRETE	112 LBS/SQ YD/INCH

REVISIONS		ILLINOIS DEPARTMENT OF TRANSPORTATION
NAME	DATE	
		GENERAL NOTES

SCALE: VERT. \_\_\_\_\_  
 DATE: \_\_\_\_\_  
 HORIZ. \_\_\_\_\_  
 DRAWN BY \_\_\_\_\_  
 CHECKED BY \_\_\_\_\_

CONTRACT NO. 94976				
F.A.I. RTE.	SECTION	COUNTY	TOTAL SHEETS	SHEET NO.
70	(25-3,4)RS-2	EFFINGHAM	25	4
STA.		TO STA.		
FED. ROAD DIST. NO.		ILLINOIS FED. AID PROJECT		

SUMMARY OF QUANTITIES			TOTAL QUANTITIES	CONSTRUCTION TYPE CODE 1000 90% FED. 10% STATE
CODE NO	ITEM	UNIT		
40600100	BITUMINOUS MATERIALS (PRIME COAT)	GALLON	19153	19153
40600895	CONSTRUCTING TEST STRIP	EACH	1	1
44000007	BITUMINOUS SURFACE REMOVAL 2"	SQ YD	191531	191531
44201043	CLASS B PATCHES, TYPE II, 16 INCH	SQ YD	275	275
44213200	SAW CUTS	FOOT	1588	1588
* 63000000	STEEL PLATE BEAM GUARD RAIL, TYPE A	FOOT	325	325
* 63100085	TRAFFIC BARRIER TERMINAL, TYPE 6	EACH	1	1
63200310	GUARDRAIL REMOVAL	FOOT	325	325
67000500	ENGINEER'S FIELD OFFICE, TYPE B	CAL MO	2	2
67100100	MOBILIZATION	L SUM	1	1
70300100	SHORT-TERM PAVEMENT MARKING	FOOT	2816	2816
70300220	TEMPORARY PAVEMENT MARKING - LINE 4"	FOOT	134620	134620
70300240	TEMPORARY PAVEMENT MARKING - LINE 6"	FOOT	17640	17640
70301000	WORK ZONE PAVEMENT MARKING REMOVAL	SQ FT	3258	3258
78003130	PREFORMED PLASTIC PAVEMENT MARKING, TYPE B - LINE 6"	FOOT	17640	17640
* 78005110	<b>EPOXY</b> PAVEMENT MARKING- LINE 4"	FOOT	134620	134620
* 78100100	RAISED REFLECTIVE PAVEMENT MARKER	EACH	1765	1765
* 88600100	DETECTOR LOOP, TYPE I	FOOT	184	184
X0322729	MATERIAL TRANSFER DEVICE	TON	21451	21451
X4066540	POLYMERIZED BITUMINOUS CONCRETE SURFACE COURSE, SUPERPAVE, MIX "E", N105	TON	21451	21451
X7010805	TRAFFIC CONTROL AND PROTECTION, STANDARD 701401 (SPECIAL)	L SUM	1	1
X7011420	TRAFFIC CONTROL AND PROTECTION, STANDARD 701411	L SUM	1	1
X7015000	CHANGEABLE MESSAGE SIGN	CAL MO	18	18
Z0017100	DOWEL BARS	EACH	680	680
Ⓢ Z0076600	TRAINEES	HOUR	1000	1000

Ⓢ Y080  
\* SPECIALTY ITEMS

PLOT DATE = 5/20/2006  
FILE NAME = 025001.DWG  
PLOT SCALE = 1/8"=1'-0"  
USER NAME = dmp101

REVISIONS		ILLINOIS DEPARTMENT OF TRANSPORTATION
NAME	DATE	
		SUMMARY OF QUANTITIES

SCALE: VERT. DATE  
HORIZ. DRAWN BY  
CHECKED BY

F.A.T. RTE.	SECTION	COUNTY	TOTAL SHEETS	SHEET NO.
70	(25-3,4)RS-2	EFFINGHAM	25	5
STA.		TO STA.		
FED. ROAD DIST. NO.		ILLINOIS FED. AID PROJECT		

# TYPICAL CROSS SECTION

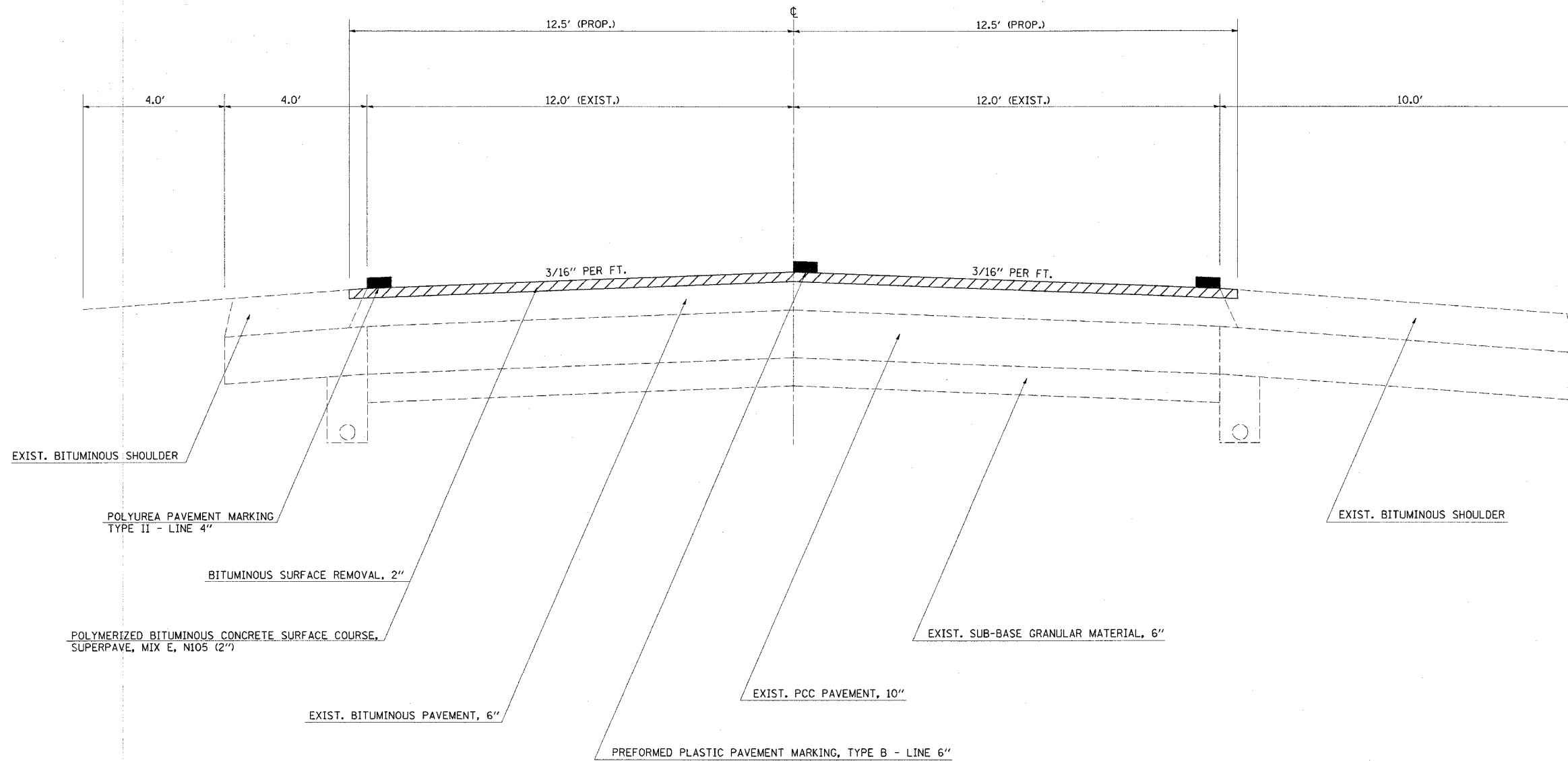

PLOT DATE = 5/20/2006  
 FILE NAME = #FILE#  
 USER NAME = #USER#  
 USER NAME = #USER#

REVISIONS	
NAME	DATE

ILLINOIS DEPARTMENT OF TRANSPORTATION

TYPICAL CROSS SECTION

SCALE: VERT.    DRAWN BY  
 HORIZ.        CHECKED BY  
 DATE

F.A.I. RTE.	SECTION	COUNTY	TOTAL SHEETS	SHEET NO.
70	(25-3,4)RS-2	EFFINGHAM	25	6
STA.		TO STA.		
FED. ROAD DIST. NO.		ILLINOIS FED. AID PROJECT		

### RESURFACING SCHEDULE

STATION TO STATION	LENGTH	EXISTING PAVEMENT WIDTH	AREA	BITUMINOUS MATERIALS (PRIME COAT)		BITUMINOUS SURFACE REMOVAL 2"	MATERIAL TRANSFER DEVICE
				GALLON	TON		
WESTBOUND							
1966+50 TO 2001+58.87	3508.87	25	9747	975	1092	9747	1092
BRIDGE OMISSION 2001+58.87 TO 2005+81.12							
2005+81.12 TO 2022+89.84	1708.72	25	4746	475	532	4746	532
PC STATION							
2022+89.84 TO 2090+06.84	6717.00	25	18658	1866	2090	18658	2090
STATION EQUATION: 2090+06.84 BK							
2090+08.88 AH							
2090+08.88 TO 2103+44	1335.12	25	3709	371	415	3709	415
RT 40 BRIDGE OMISSION 2103+44 TO 2121+44							
2121+44 TO 2291+61	17017.00	25	47269	4727	5294	47269	5294
TOTAL WESTBOUND	30286.71		84130	8413	9423	84130	9423
EASTBOUND							
1966+50 TO 2001+58.87	3508.87	25	9747	975	1092	9747	1092
BRIDGE OMISSION 2001+58.87 TO 2005+81.12							
2005+81.12 TO 2022+95.11	1713.99	25	4761	476	533	4761	533
PC STATION							
2022+95.11 TO 2092+89.56	6994.45	25	19429	1943	2176	19429	2176
STATION EQUATION 2092+89.56 BK							
2090+08.88 AH							
2090+08.88 TO 2103+44	1335.12	25	3709	371	415	3709	415
RT 40 BRIDGE OMISSION 2103+44 TO 2121+44							
2121+44 TO 2291+61	17017.00	25	47269	4727	5294	47269	5294
TOTAL EASTBOUND	30569.43		84915	8492	9510	84915	9510
I-57 SOUTHBOUND RAMP "C"							
5015+00 TO 5028+25.67	1325.67	25	3682	368	412	3682	412
BRIDGE OMISSION 5028+25.67 TO 5030+75.54							
5030+75.54 TO 5039+14.62	839.08	25	2331	233	261	2331	261
STATION CHANGE 5039+14.62 BK TO 2052+33.38 AH							
2052+33.38 TO 2059+81.38	748.00	25	2078	208	233	2078	233
TAPER STARTS 25' - 0'							
2059+81.38 TO 2067+43.38	762.00	12.5	1058	106	119	1058	119
TOTAL SOUTHBOUND RAMP	3674.75		9149	915	1025	9149	1025
I-57 NORTHBOUND RAMP "D"							
5015+43.5 TO 5043+99.6	2856.10	25	7934	793	889	7934	889
STATION CHANGE 5043+99.6 BK TO 2062+19.41 AH							
2062+19.41 TO 2069+04.41	685.00	25	1903	190	213	1903	213
*TAPER GOES FROM 25' TO 1.34' = 13.17' AVERAGE							
*2069+04.41 TO 2092+89.56	2385.15	13.17	3490	349	391	3490	391
STATION EQUATION 2092+89.56 BK TO 2090+08.88 AH							
**TAPER GOES FROM 1.34' TO 0' = 0.67' AVERAGE							
**2090+08.88 TO 2091+43.73	134.85	0.67	10	1	10	10	1
TOTAL NORTHBOUND RAMP			13337	1334	1494	13337	1494
PROJECT TOTAL =	64530.89		191531	19153	21451	191531	21451

### GUARDRAIL SCHEDULE

STEEL PLATE BEAM GUARDRAIL, TYPE A	
STATION	LIN. FT.
EASTBOUND	
2000+50 RT.	37.5
2289+54.32 RT.	62.5
2290+47.32 RT.	37.5
WESTBOUND	
2006+00 LT.	37.5
2051+03 LT.	37.5
2052+47 LT.	25.0
2056+84 LT.	25.0
2070+04 LT.	25.0
2201+68 LT.	37.5
TOTAL = 325.0	
TRAFFIC BARRIER TERMINAL, TYPE 6	
2005+82 LT.	1.0 EACH
TOTAL = 1.0 EACH	

PLOT DATE = 3/30/2006  
 PLOT SCALE = AS SHOWN  
 USER NAME = dlvrlot

REVISIONS	
NAME	DATE

ILLINOIS DEPARTMENT OF TRANSPORTATION  
**RESURFACING SCHEDULE**  
 &  
**GUARDRAIL SCHEDULE**  
 SCALE: VERT. DATE  
 HORIZ. DATE  
 DRAWN BY  
 CHECKED BY

F.A.I. RTE.	SECTION	COUNTY	TOTAL SHEETS	SHEET NO.
70	(25-3,4)RS-2	EFFINGHAM	25	7
STA.		TO STA.		
FED. ROAD DIST. NO.		ILLINOIS	FED. AID PROJECT	

### PAVEMENT MARKING SCHEDULE

STA. TO STA.	LIN FT	POLYUREA PAVEMENT MARKING - LINE 4" (YELLOW) FT	POLYUREA PAVEMENT MARKING - LINE 4" (WHITE) FT	PREFORMED PLASTIC PAVEMENT MARKING, TYPE B LINE - 6" FT	TEMPORARY PAVEMENT MARKING - LINE 4" (WHITE) FT	TEMPORARY PAVEMENT MARKING - LINE 4" (YELLOW) FT	TEMPORARY PAVEMENT MARKING - LINE 6" (WHITE) FT	SHORT-TERM PAVEMENT MARKING (SHOULDER DIAGONAL MARKS) FT	RAISED REFLECTIVE PAVEMENT MARKERS EACH
<b>WESTBOUND</b>									
1966+50 TO 2001+58.87	3508.87	3509	3509	880	3509	3509	880	140	88
BRIDGE OMISSION									
2005+81.12 TO 2022+89.84	1708.72	1709	1709	430	1709	1709	430	68	43
PC STATION									
••2022+89.84 TO 2090+06.84	6717.00	6717	6717	1680	6717	6717	1680	268	168
STATION EQUATION: 2090+06.84 BK									
2090+08.88 AH									
2090+08.88 TO 2103+44	1335.12	1335	1335	330	1335	1335	330	52	33
RT 40 BRIDGE OMISSION									
2121+44 TO 2291+61	17017.00	17017	17017	4250	17017	17017	4250	680	425
TOTAL WESTBOUND		30287	29525	7570	29525	30287	7570	1208	757
••NOTE: 2059+81.38 RT TO 2067+43.38 RT (NO EOP STRIPING)									
<b>EASTBOUND</b>									
1966+50 TO 2001+58.87	3508.87	3509	3509	880	3509	3509	880	140	88
BRIDGE OMISSION									
2005+81.12 TO 2022+95.11	1713.99	1714	1714	430	1714	1714	430	68	43
PC STATION									
••2022+95.11 TO 2092+89.56	6994.45	6994	6994	1750	6994	6994	1750	280	175
STATION EQUATION 2092+89.56 BK									
2090+08.88 AH									
••2090+08.88 TO 2103+44	1335.12	1335	1335	330	1335	1335	330	52	33
RT 40 BRIDGE OMISSION									
2121+44 TO 2291+61	17017.00	17017	17017	4250	17017	17017	4250	680	425
TOTAL EASTBOUND		30569	28049	7640	28049	30569	7640	1220	764
••NOTE: 2069+04.41 RT TO 2091+43.73 RT (NO EOP STRIPING)									
<b>I-57 SOUTHBOUND RAMP "C"</b>									
5015+00 TO 5028+25.67	1325.67	1326	1326	330	1326	1326	330	52	33
BRIDGE OMISSION									
5030+75.54 TO 5039+14.62	839.08	839	839	210	839	839	210	32	21
STATION CHANGE									
2052+33.38 TO 2059+81.38	748	0	1496	190	1496	0	190	28	19
TAPER STARTS 25' - 0'									
••2059+81.38 TO 2067+43.38	762	0	762	190	762	0	190	32	19
TOTAL SOUTHBOUND RAMP		2165	4423	920	4423	2165	920	144	92
••NO EOP STRIPING ON THE LEFT SIDE OF THE RAMP (762') WHERE I-57 & I-70 MERGE									
<b>I-57 NORTHBOUND RAMP "D"</b>									
5015+43.5 TO 5043+99.6	2856.10	2856	2856	710	2856	2856	710	116	71
STATION CHANGE									
2062+19.41 TO 2069+04.41	685	0	1370	170	1370	0	170	28	17
TAPER STARTS 25' - 0'									
••2069+04.41 TO 2092+89.56	2385.15	0	2385	600	2385	0	600	96	60
STATION EQUATION 2092+89.56 BK									
2090+08.88 AH									
••2090+08.88 TO 2091+43.73	134.85	0	135	30	135	0	30	4	3
TOTAL NORTHBOUND RAMP		2856	6746	1510	6746	2856	1510	244	152
•• NO EOP STRIPING ON THE LEFT SIDE OF NORTHBOUND RAMP (2520') FROM 2069+04.41 TO 2091+43.73 WHERE I-57 & I-70 MERGE									
<b>PROJECT TOTAL =</b>		65877	68743	17640	68743	65877	17640	2816	1764

PLOT DATE = 3/30/2006  
 FILE NAME = #FILEL9  
 PLOT SCALE = #SCALE9  
 USER NAME = dmsprct

REVISIONS	
NAME	DATE

ILLINOIS DEPARTMENT OF TRANSPORTATION

**PAVEMENT MARKING SCHEDULE**

SCALE: VERT.      DRAWN BY  
 HORIZ.              CHECKED BY  
 DATE

CONTRACT NO. 94976

F.A.I. RTE.	SECTION	COUNTY	TOTAL SHEETS	SHEET NO.
70	(25-3,4)RS-2	EFFINGHAM	25	8
STA. 1966+50		TO STA.1996+00		
FED. ROAD DIST. NO.		ILLINOIS FED. AID PROJECT		



PROJECT BEGINS:  
STA. 1966+50

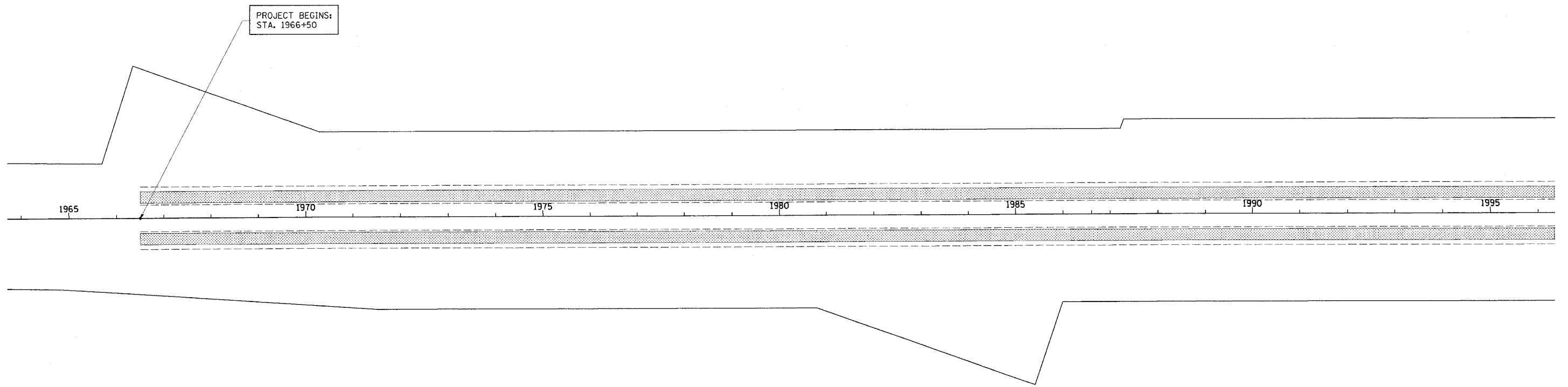

PLOT DATE = 3/30/2006  
FILE NAME = #FILEL#  
PLOT SCALE = #SCALE#  
USER NAME = davisjct

REVISIONS	
NAME	DATE

ILLINOIS DEPARTMENT OF TRANSPORTATION

STA. 1966+50  
TO  
STA. 1996+00

SCALE: VERT. \_\_\_\_\_  
HORIZ. \_\_\_\_\_

DATE \_\_\_\_\_ DRAWN BY \_\_\_\_\_  
CHECKED BY \_\_\_\_\_



F.A.I. RTE.	SECTION	COUNTY	TOTAL SHEETS	SHEET NO.
70	(25-3,4)RS-2	EFFINGHAM	25	9
STA. 1996+00		TO STA. 2028+00		
FED. ROAD DIST. NO.		ILLINOIS FED. AID PROJECT		

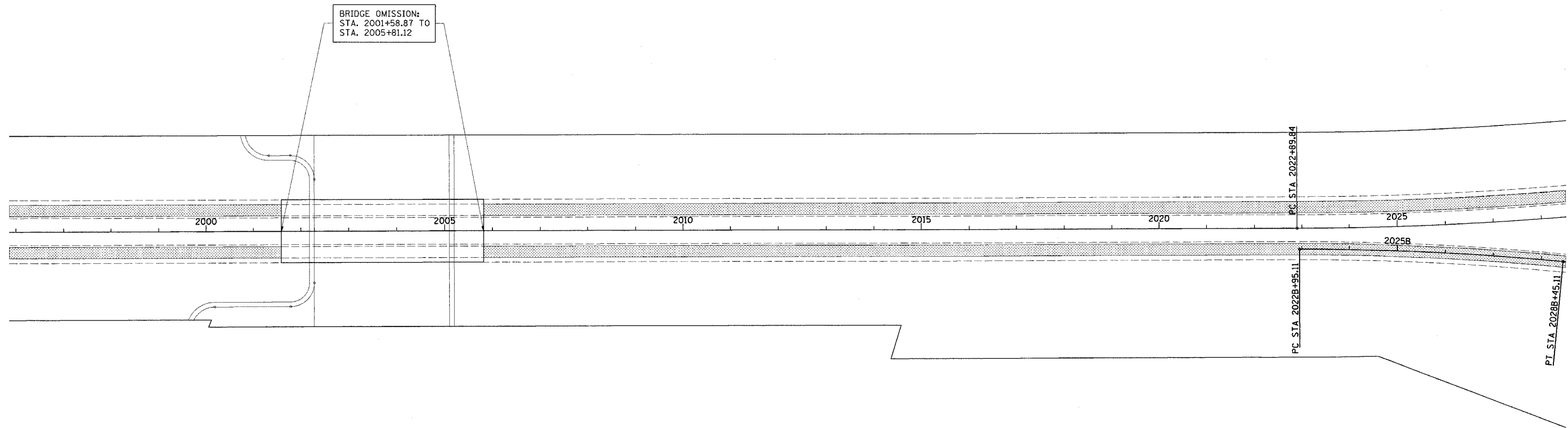

BRIDGE OMISSION:  
STA. 2001+58.87 TO  
STA. 2005+81.12

REVISIONS	
NAME	DATE

ILLINOIS DEPARTMENT OF TRANSPORTATION

STA. 1996+00  
TO  
STA. 2028+00

SCALE: VERT. \_\_\_\_\_  
HORIZ. \_\_\_\_\_

DATE \_\_\_\_\_ DRAWN BY \_\_\_\_\_  
CHECKED BY \_\_\_\_\_

PLOT DATE = 3/29/2006  
PLOT NAME = 25-3,4RS-2  
PLOT SCALE = 1"=50'  
USER NAME = darclet

F.A.I. RTE.	SECTION	COUNTY	TOTAL SHEETS	SHEET NO.
70	(25-3,4)RS-2	EFFINGHAM	25	10
STA. 5015+00		TO STA. 5025+00		
FED. ROAD DIST. NO.		ILLINOIS	FED. AID PROJECT	

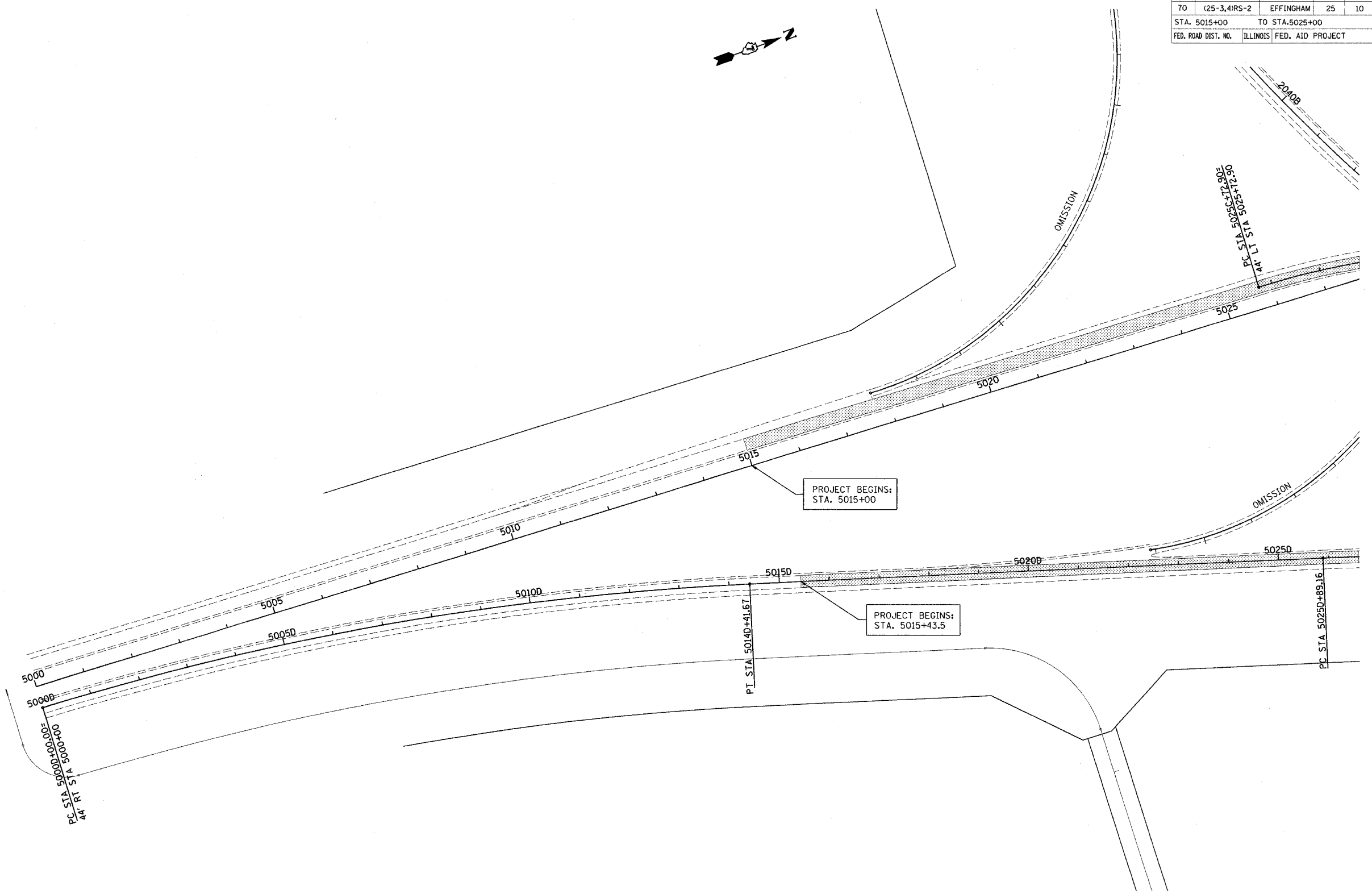

PLOT DATE = 3/20/2006  
 FILE NAME = #FILEL#  
 PLOT SCALE = #SCALE#  
 USER NAME = #USER#

REVISIONS	
NAME	DATE

ILLINOIS DEPARTMENT OF TRANSPORTATION  
 I-57 RAMP  
 STA. 5015+00  
 TO  
 STA. 5025+00

SCALE: VERT. \_\_\_\_\_  
 HORIZ. \_\_\_\_\_  
 DATE \_\_\_\_\_

DRAWN BY \_\_\_\_\_  
 CHECKED BY \_\_\_\_\_

F.A.I. RTE.	SECTION	COUNTY	TOTAL SHEETS	SHEET NO.
70	(25-3,4)RS-2	EFFINGHAM	25	11
STA. 5025+00		TO STA. 2060+00		
FED. ROAD DIST. NO.		ILLINOIS FED. AID PROJECT		



PLOT DATE = 3/28/2006  
 FILE NAME = #FILE#  
 PLOT SCALE = #SCALE#  
 USER NAME = #USER#

REVISIONS	
NAME	DATE

ILLINOIS DEPARTMENT OF TRANSPORTATION  
 I-57 RAMP  
 STA. 5025+00  
 TO  
 I-70 MAINLINE  
 STA. 2060+00

SCALE: VERT. \_\_\_\_\_  
 HORIZ. \_\_\_\_\_

DATE \_\_\_\_\_ DRAWN BY \_\_\_\_\_  
 CHECKED BY \_\_\_\_\_

F.A.I. RTE.	SECTION	COUNTY	TOTAL SHEETS	SHEET NO.
70	(25-3,4)RS-2	EFFINGHAM	25	12
STA. 2060+00		TO STA. 2091+00		
FED. ROAD DIST. NO.		ILLINOIS FED. AID PROJECT		

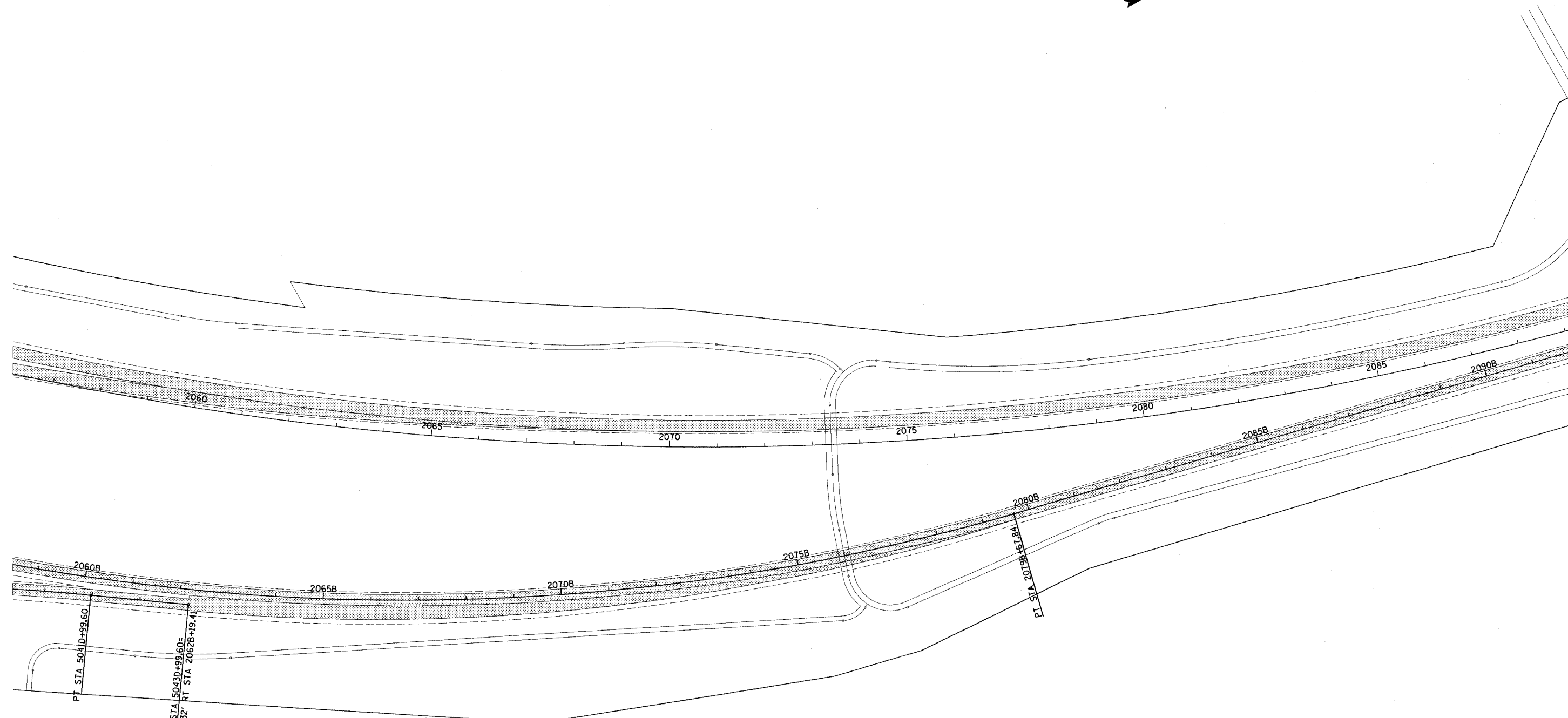
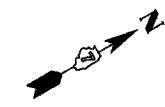

PLOT DATE = 3/30/2006  
 PLOT SCALE = 1"=40'  
 USER NAME = dtrout

REVISIONS	
NAME	DATE

ILLINOIS DEPARTMENT OF TRANSPORTATION  
 STA. 2060+00  
 TO  
 STA. 2091+00 (EB)  
 STA. 2089+00 (WB)

SCALE: VERT. \_\_\_\_\_  
 HORIZ. \_\_\_\_\_

DATE \_\_\_\_\_ DRAWN BY \_\_\_\_\_  
 CHECKED BY \_\_\_\_\_

F.A.I. RTE.	SECTION	COUNTY	TOTAL SHEETS	SHEET NO.
70	(25-3,4)RS-2	EFFINGHAM	25	13
STA. 2091+00		TO STA. 2121+00		
FED. ROAD DIST. NO.	ILLINOIS	FED. AID PROJECT		

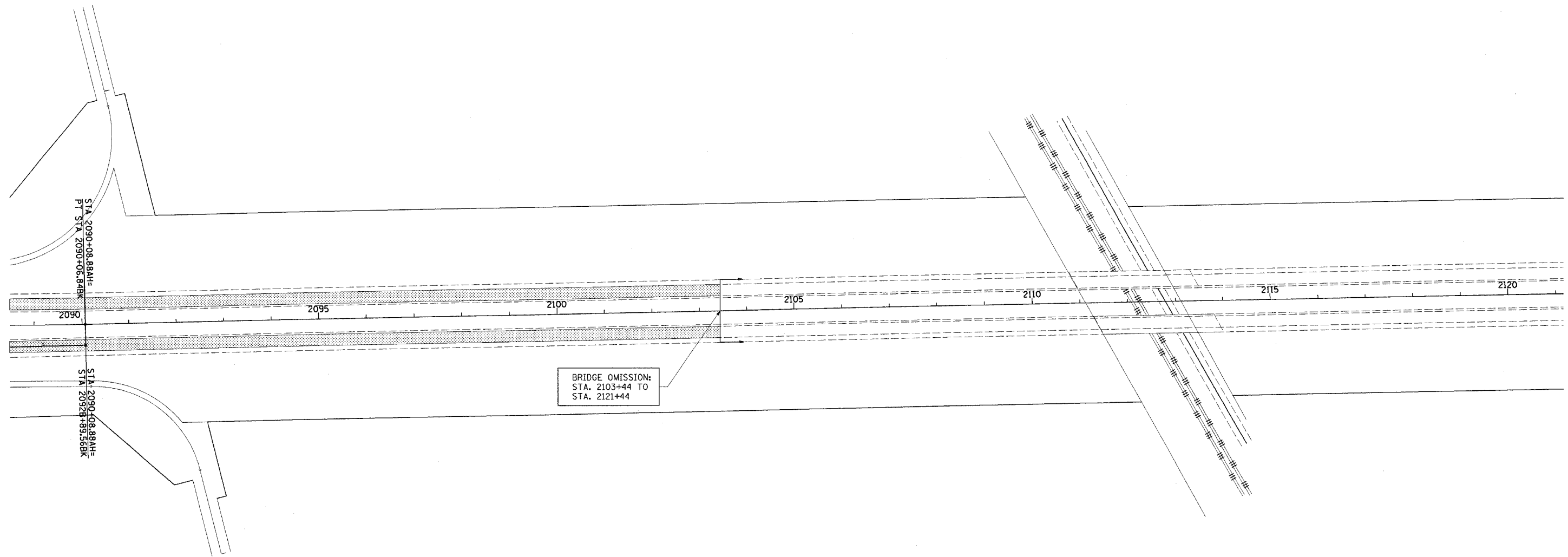

BRIDGE OMISSION:  
STA. 2103+44 TO  
STA. 2121+44

PLOT DATE = 3/28/2006  
FILE NAME = #FILE#  
PLOT SCALE = #SCALE#  
USER NAME = #USER#

REVISIONS	
NAME	DATE

ILLINOIS DEPARTMENT OF TRANSPORTATION  
STA. 2091+00 (EB)  
STA. 2089+00 (WB)  
TO  
STA. 2121+00

SCALE: VERT. \_\_\_\_\_  
HORIZ. \_\_\_\_\_

DATE \_\_\_\_\_ DRAWN BY \_\_\_\_\_  
CHECKED BY \_\_\_\_\_

CONTRACT NO. 94976

F.A.I. RTE.	SECTION	COUNTY	TOTAL SHEETS	SHEET NO.
70	(25-3,4)RS-2	EFFINGHAM	25	14
STA. 2121+00		TO STA. 2153+00		
FED. ROAD DIST. NO.		ILLINOIS FED. AID PROJECT		

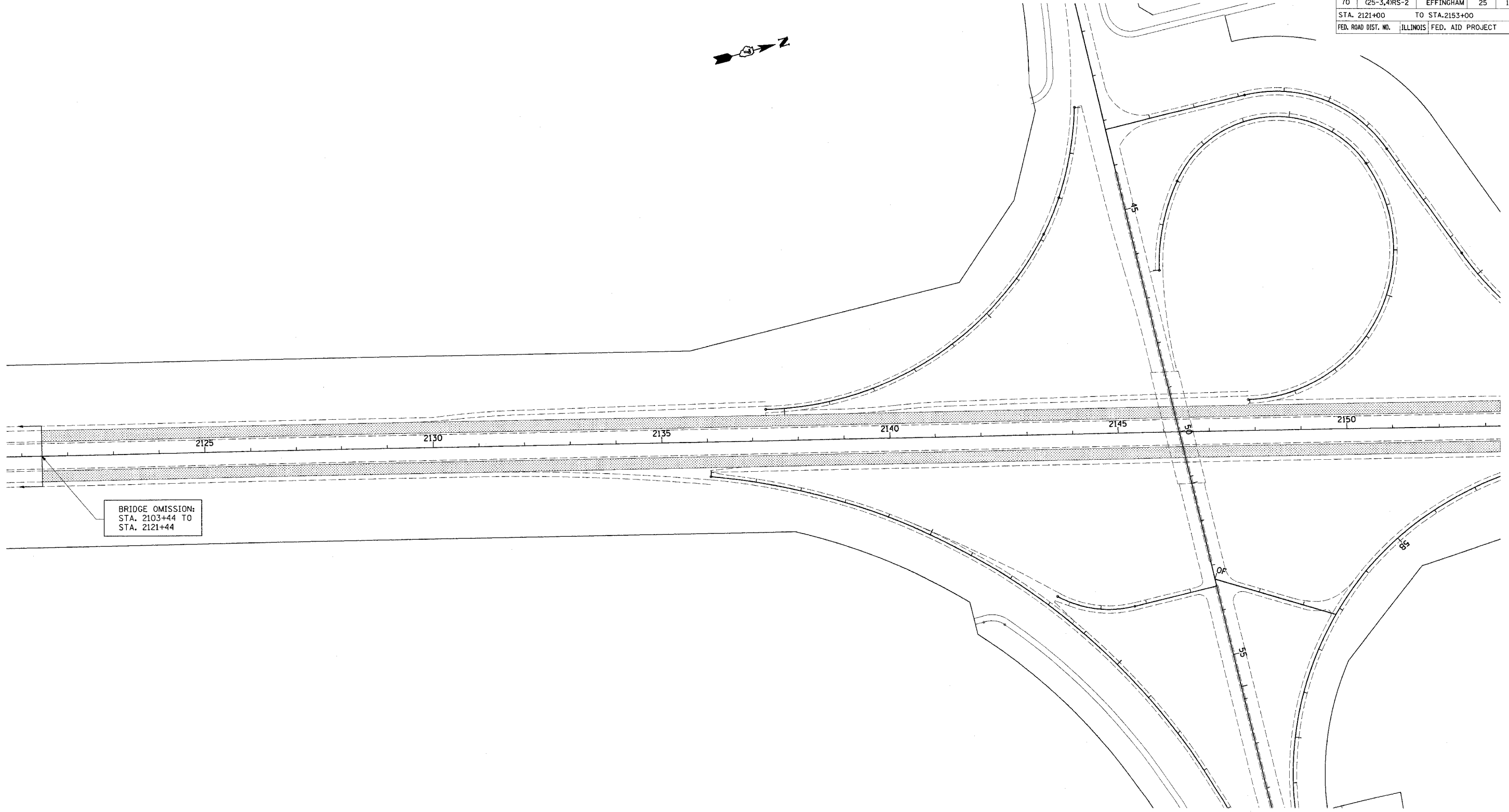

BRIDGE OMISSION:  
STA. 2103+44 TO  
STA. 2121+44

PLOT DATE = 9/20/2006  
 FILE NAME = #FILE#  
 PLOT SCALE = #SCALE#  
 USER NAME = #USER#

REVISIONS	
NAME	DATE

ILLINOIS DEPARTMENT OF TRANSPORTATION

STA. 2121+00  
TO  
STA. 2153+00

SCALE: VERT. \_\_\_\_\_  
HORIZ. \_\_\_\_\_

DATE \_\_\_\_\_ DRAWN BY \_\_\_\_\_  
CHECKED BY \_\_\_\_\_

CONTRACT NO. 94976

F.A.I. RTE.	SECTION	COUNTY	TOTAL SHEETS	SHEET NO.
70	(25-3,4)RS-2	EFFINGHAM	25	15
STA. 2153+00		TO STA. 2185+00		
FED. ROAD DIST. NO.		ILLINOIS FED. AID PROJECT		

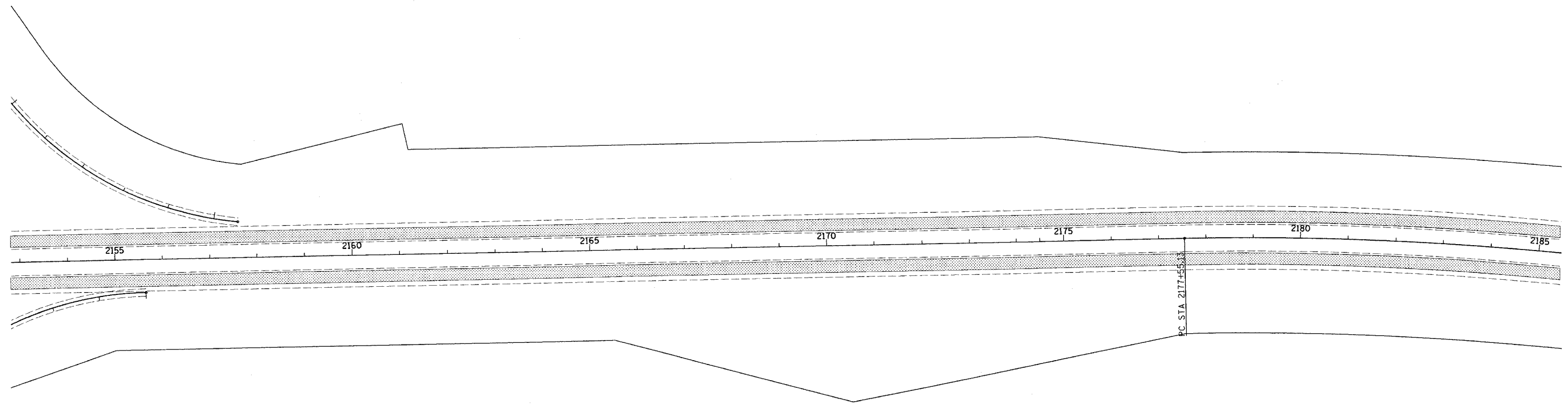

PLOT DATE = 3/30/2006  
 FILE NAME = #FILE#  
 PLOT SCALE = #SCALE#  
 USER NAME = gsbriet

REVISIONS	
NAME	DATE

ILLINOIS DEPARTMENT OF TRANSPORTATION

STA. 2153+00  
 TO  
 STA. 2185+00

SCALE: VERT. \_\_\_\_\_  
 HORIZ. \_\_\_\_\_

DATE \_\_\_\_\_ DRAWN BY \_\_\_\_\_  
 CHECKED BY \_\_\_\_\_

CONTRACT NO. 94976

F.A.I. RTE.	SECTION	COUNTY	TOTAL SHEETS	SHEET NO.
70	(25-3,4)RS-2	EFFINGHAM	25	16
STA. 2185+00		TO STA. 2217+00		
FED. ROAD DIST. NO.	ILLINOIS	FED. AID PROJECT		

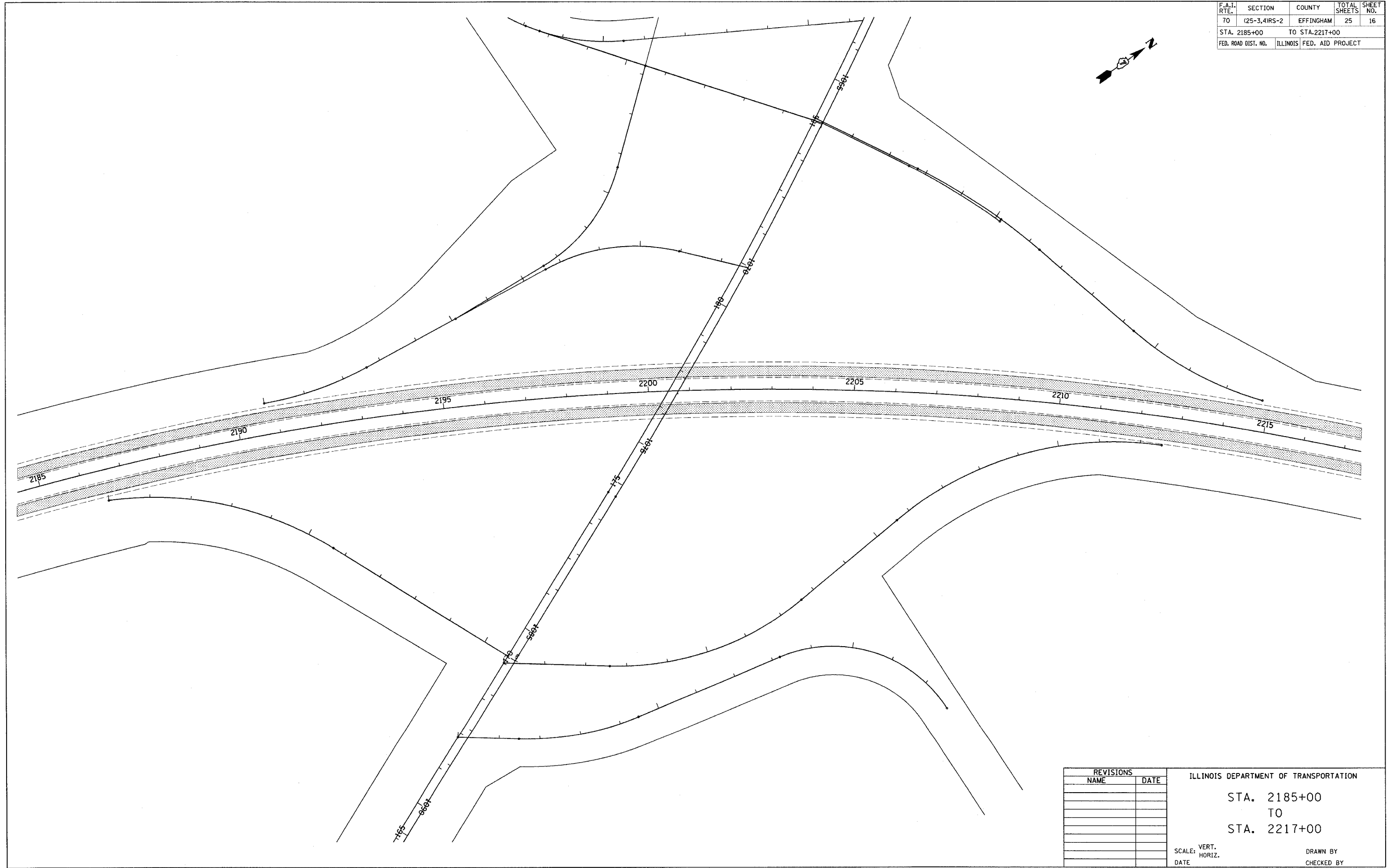
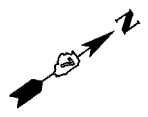

PLOT DATE = 3/28/2006  
 FILE NAME = FILEL9  
 PLOT SCALE = SCALE9  
 USER NAME = alvprict

REVISIONS	
NAME	DATE

ILLINOIS DEPARTMENT OF TRANSPORTATION

STA. 2185+00  
 TO  
 STA. 2217+00

SCALE: VERT.  
 DATE:      HORIZ.

DRAWN BY  
 CHECKED BY



CONTRACT NO. 94976

F.A.I. RTE.	SECTION	COUNTY	TOTAL SHEETS	SHEET NO.
TO	(25-3,4)RS-2	EFFINGHAM	25	17
STA. 2217+00		TO STA. 2249+00		
FED. ROAD DIST. NO.	ILLINOIS	FED. AID PROJECT		

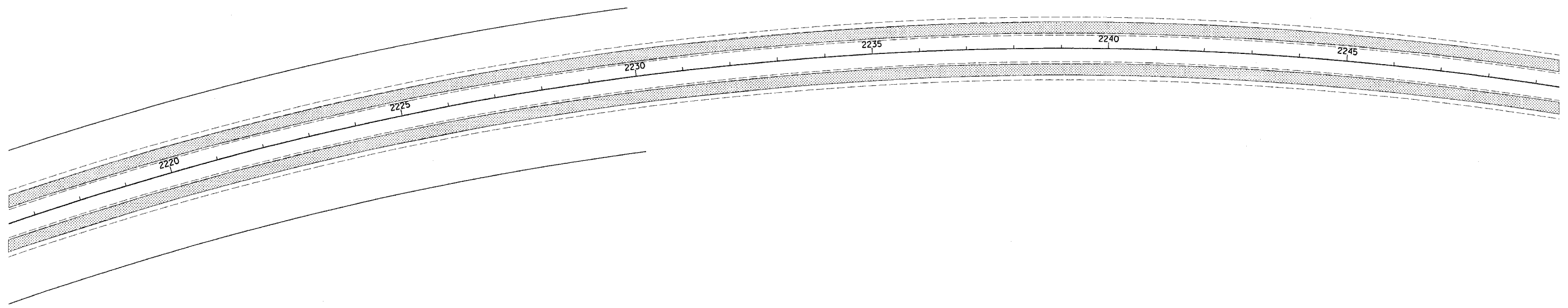

PLOT DATE = 3/20/2006  
 FILE NAME = #FILE#  
 PLOT SCALE = #SCALE#  
 USER NAME = #USER#

REVISIONS	
NAME	DATE

ILLINOIS DEPARTMENT OF TRANSPORTATION

STA. 2217+00  
 TO  
 STA. 2249+00

SCALE: VERT.  
 DATE:      HORIZ.

DRAWN BY  
 CHECKED BY

F.A.I. RTE.	SECTION	COUNTY	TOTAL SHEETS	SHEET NO.
TO	(25-3,4)RS-2	EFFINGHAM	25	18
STA. 2249+00		TO STA. 2281+00		
FED. ROAD DIST. NO.	ILLINOIS	FED. AID PROJECT		



SEE STANDARDS 886001 & 886006 FOR DETECTOR LOOP DETAILS

**NOTE:**  
EXISTING LOOPS AND SENSORS TO BE REMOVED WITH MILLING. PROPOSED LOOPS SHALL BE INSTALLED IN APPROXIMATE LOCATION OF EXISTING LOOPS.

DETECTOR LOOP, TYPE 1 (6' x 8')  
4 TURNS IN A CLOCKWISE DIRECTION

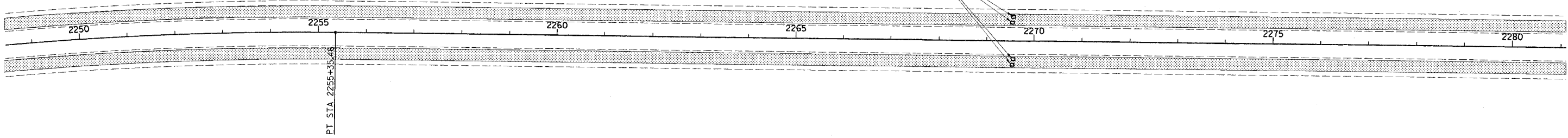

PLOT DATE = 3/20/2006  
FILE NAME = #FILE#  
PLOT SCALE = #SCALE#  
USER NAME = #USER#

REVISIONS	
NAME	DATE

ILLINOIS DEPARTMENT OF TRANSPORTATION

STA. 2249+00  
TO  
STA. 2281+00

SCALE: VERT. \_\_\_\_\_  
HORIZ. \_\_\_\_\_

DATE \_\_\_\_\_ DRAWN BY \_\_\_\_\_  
CHECKED BY \_\_\_\_\_

F.A.I. RTE.	SECTION	COUNTY	TOTAL SHEETS	SHEET NO.
70	(25-3,4)RS-2	EFFINGHAM	25	19
STA. 2281+00		TO STA. 2291+61		
FED. ROAD DIST. NO.		ILLINOIS FED. AID PROJECT		

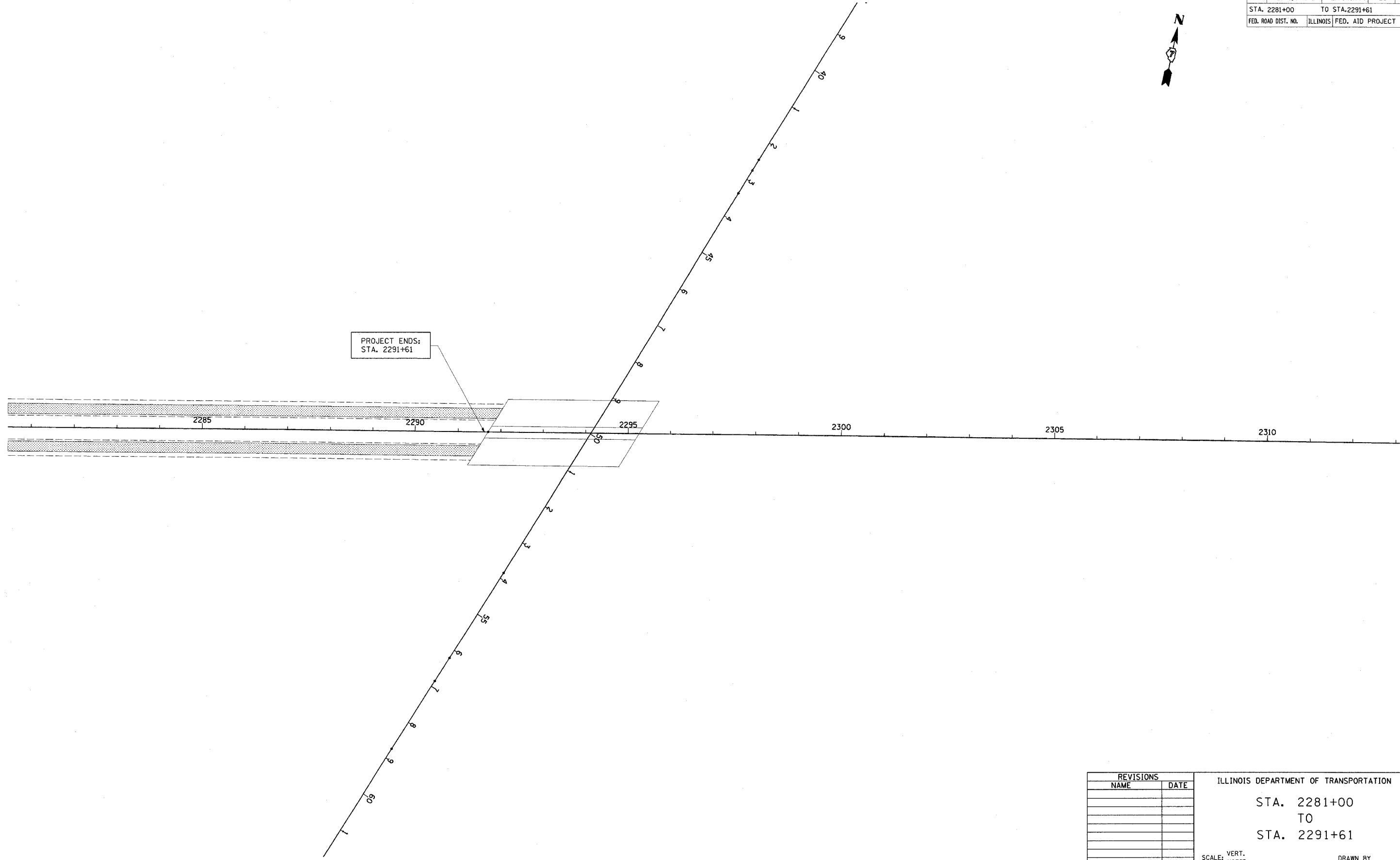

PROJECT ENDS:  
STA. 2291+61

PLOT DATE = 3/30/2006  
 FILE NAME = #FILE#  
 PLOT SCALE = #SCALE#  
 USER NAME = dlsprst

REVISIONS	
NAME	DATE

ILLINOIS DEPARTMENT OF TRANSPORTATION

STA. 2281+00  
 TO  
 STA. 2291+61

SCALE: VERT.  
 HORIZ.  
 DATE

DRAWN BY  
 CHECKED BY

F.A.I. RTE.	SECTION	COUNTY	TOTAL SHEETS	SHEET NO.
70	(25-3,4)RS-2	EFFINGHAM	25	20
STA. 2121+00		TO STA. 2153+00		
FED. ROAD DIST. NO.		ILLINOIS FED. AID PROJECT		

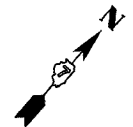

LEGEND

	TRAFFIC CONTROL DEVICES
	WORK AREA
	DIRECTION OF TRAFFIC

NOTE:  
LOCATIONS OF CHANGEABLE MESSAGE SIGNS  
TO BE DETERMINED BY ENGINEER.

PLOT DATE = 3/28/2006  
FILE NAME = #FILE#  
PLOT SCALE = #SCALE#  
USER NAME = #USER#

REVISIONS	
NAME	DATE

ILLINOIS DEPARTMENT OF TRANSPORTATION  
STAGE 1 TRAFFIC CONTROL  
SOUTH TRI-LEVEL  
I-57/I-70 NB/EB

SCALE: VERT. \_\_\_\_\_  
HORIZ. \_\_\_\_\_  
DATE \_\_\_\_\_ DRAWN BY \_\_\_\_\_  
CHECKED BY \_\_\_\_\_

F.A.I. RTE.	SECTION	COUNTY	TOTAL SHEETS	SHEET NO.
70	(25-3,4)RS-2	EFFINGHAM	25	21
STA. 2121+00		TO STA. 2153+00		
FED. ROAD DIST. NO.	ILLINOIS	FED. AID PROJECT		

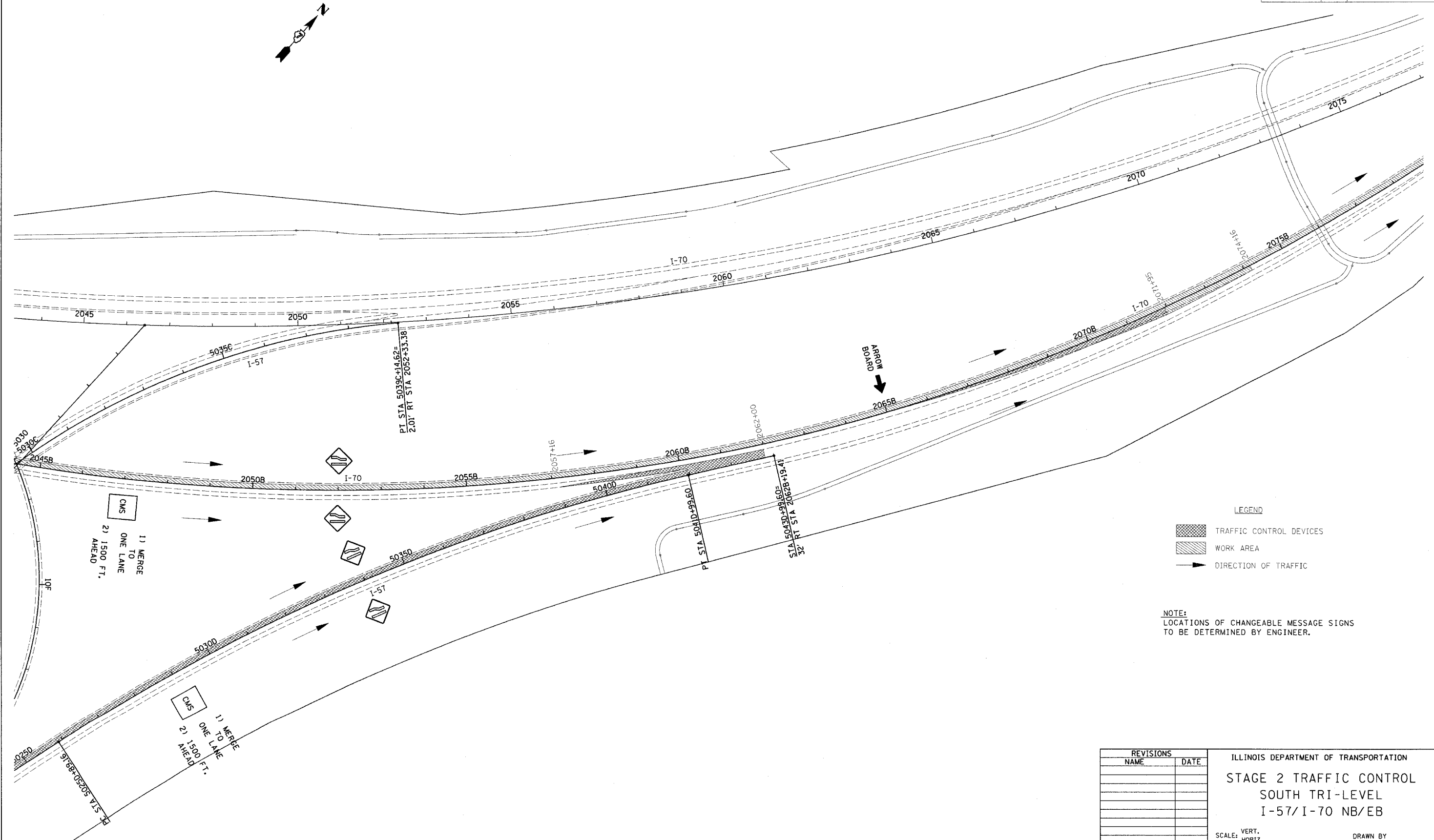

LEGEND

	TRAFFIC CONTROL DEVICES
	WORK AREA
	DIRECTION OF TRAFFIC

NOTE:  
LOCATIONS OF CHANGEABLE MESSAGE SIGNS  
TO BE DETERMINED BY ENGINEER.

PLOT DATE = 3/20/2006  
FILE NAME = #FILE#  
PLOT SCALE = #SCALE#  
USER NAME = district

REVISIONS	
NAME	DATE

ILLINOIS DEPARTMENT OF TRANSPORTATION  
STAGE 2 TRAFFIC CONTROL  
SOUTH TRI-LEVEL  
I-57/I-70 NB/EB

SCALE: VERT. \_\_\_\_\_  
          HORIZ. \_\_\_\_\_  
DATE \_\_\_\_\_

DRAWN BY \_\_\_\_\_  
CHECKED BY \_\_\_\_\_

F.A.I. RTE.	SECTION	COUNTY	TOTAL SHEETS	SHEET NO.
70	(25-3,4)RS-2	EFFINGHAM	25	22
STA. 2121+00		TO STA. 2153+00		
FED. ROAD DIST. NO.		ILLINOIS FED. AID PROJECT		

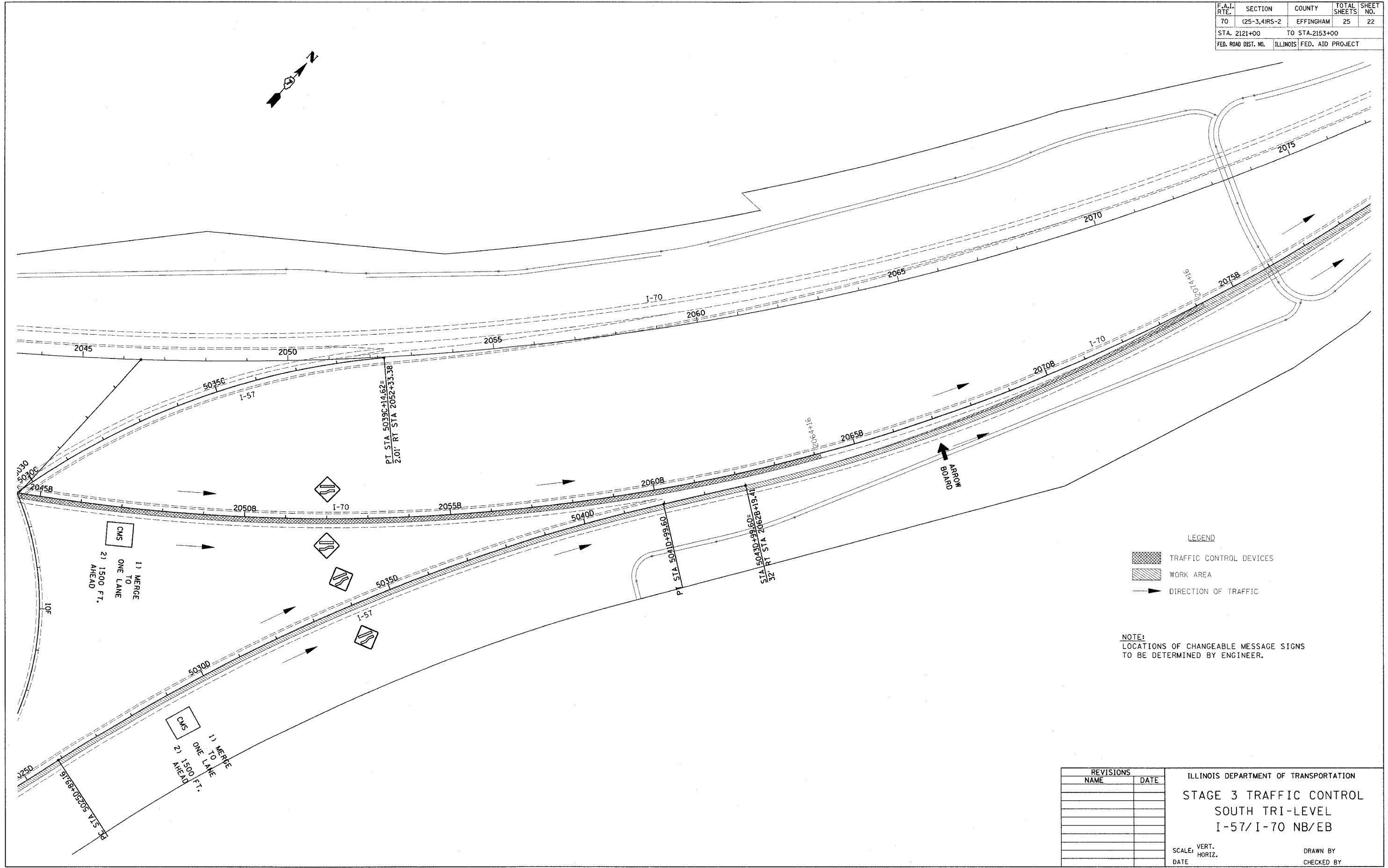

**LEGEND**

- TRAFFIC CONTROL DEVICES
- WORK AREA
- DIRECTION OF TRAFFIC

**NOTE:**  
LOCATIONS OF CHANGEABLE MESSAGE SIGNS TO BE DETERMINED BY ENGINEER.

PLOT DATE = 3/28/2006  
 FILE NAME = #FILE#  
 SCALE = #SCALE#  
 USER NAME = #USER#

REVISIONS	
NAME	DATE

ILLINOIS DEPARTMENT OF TRANSPORTATION  
**STAGE 3 TRAFFIC CONTROL**  
**SOUTH TRI-LEVEL**  
**I-57/I-70 NB/EB**

SCALE: VERT. \_\_\_\_\_  
 HORIZ. \_\_\_\_\_  
 DATE \_\_\_\_\_

DRAWN BY \_\_\_\_\_  
 CHECKED BY \_\_\_\_\_

F.A.I. RTE.	SECTION	COUNTY	TOTAL SHEETS	SHEET NO.
70	125-3,4RS-2	EFFINGHAM	25	23
STA. 2121+00		TO STA. 2153+00		
FED. ROAD DIST. NO.		ILLINOIS	FED. AID PROJECT	

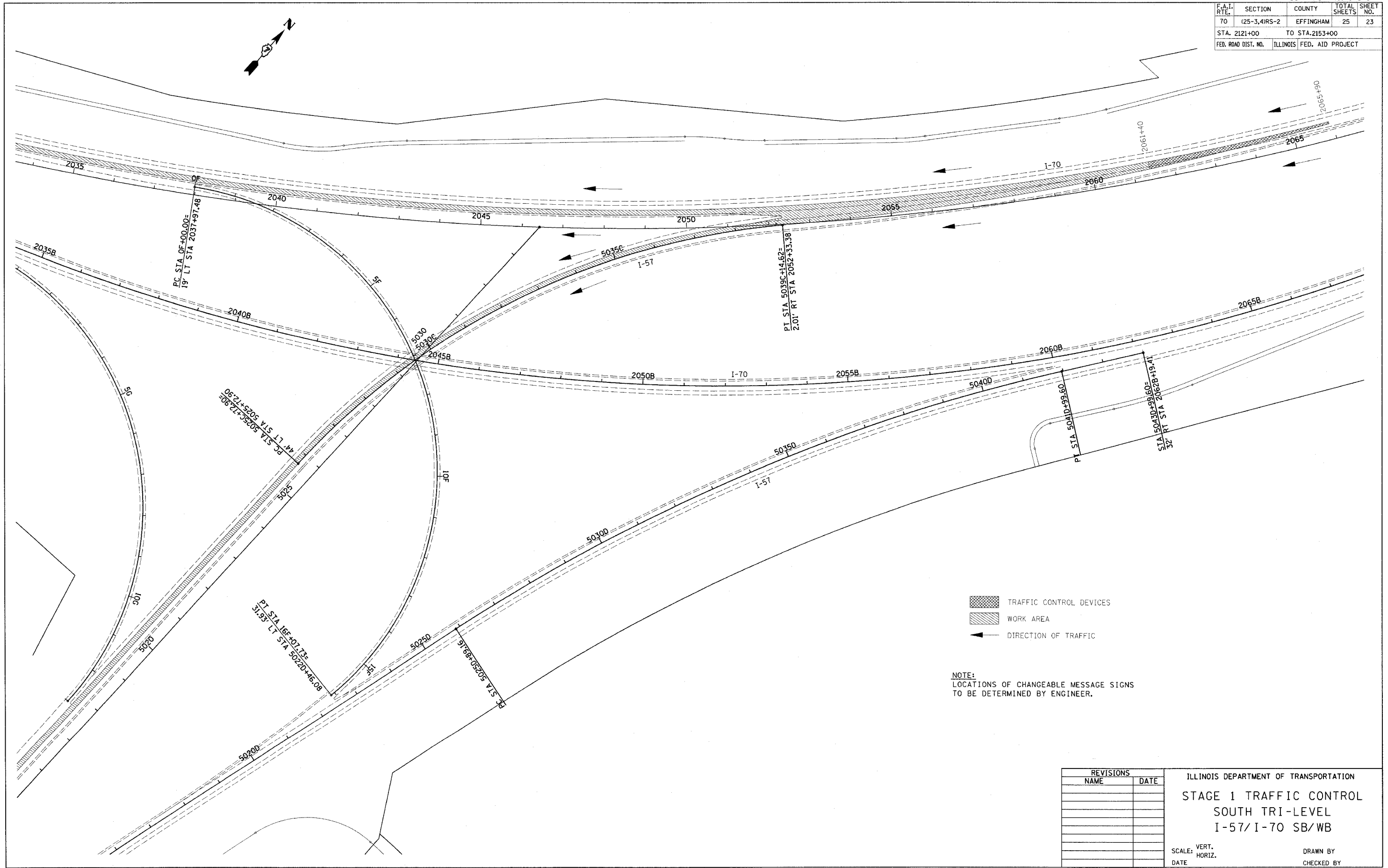

- TRAFFIC CONTROL DEVICES
- WORK AREA
- DIRECTION OF TRAFFIC

NOTE:  
LOCATIONS OF CHANGEABLE MESSAGE SIGNS  
TO BE DETERMINED BY ENGINEER.

PLOT DATE = 3/30/2006  
FILE NAME = #FILE#  
PLOT SCALE = #SCALE#  
USER NAME = #USER#

REVISIONS	
NAME	DATE

ILLINOIS DEPARTMENT OF TRANSPORTATION  
STAGE 1 TRAFFIC CONTROL  
SOUTH TRI-LEVEL  
I-57/I-70 SB/WB

SCALE: VERT.      DRAWN BY  
          HORIZ.      CHECKED BY  
DATE

F.A.I. RTE.	SECTION	COUNTY	TOTAL SHEETS	SHEET NO.
70	(25-3,4)RS-2	EFFINGHAM	25	24
STA. 2121+00		TO STA. 2153+00		
FED. ROAD DIST. NO.		ILLINOIS FED. AID PROJECT		

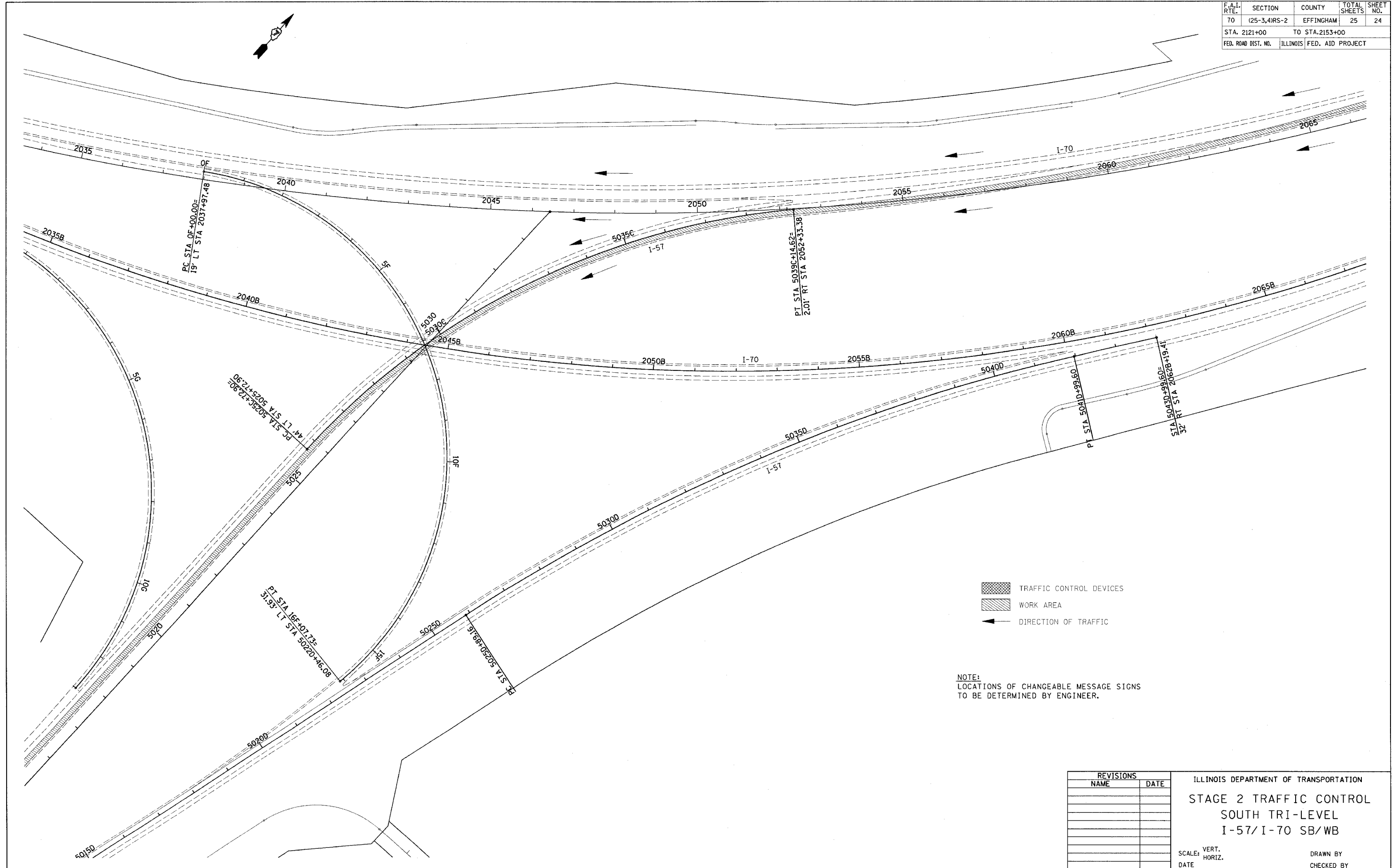

- TRAFFIC CONTROL DEVICES
- WORK AREA
- DIRECTION OF TRAFFIC

NOTE:  
LOCATIONS OF CHANGEABLE MESSAGE SIGNS  
TO BE DETERMINED BY ENGINEER.

PLOT DATE = 3/30/2006  
FILE NAME = #FILE#  
PLOT SCALE = #SCALE#  
USER NAME = davisrct

REVISIONS	
NAME	DATE

ILLINOIS DEPARTMENT OF TRANSPORTATION  
**STAGE 2 TRAFFIC CONTROL**  
**SOUTH TRI-LEVEL**  
**I-57/I-70 SB/WB**

SCALE: VERT. \_\_\_\_\_  
 HORIZ. \_\_\_\_\_  
 DATE \_\_\_\_\_

DRAWN BY \_\_\_\_\_  
 CHECKED BY \_\_\_\_\_



F.A.I. RTE.	SECTION	COUNTY	TOTAL SHEETS	SHEET NO.
70	(25-3,4)RS-2	EFFINGHAM	25	25
STA. 2121+00		TO STA. 2153+00		
FED. ROAD DIST. NO.		ILLINOIS FED. AID PROJECT		

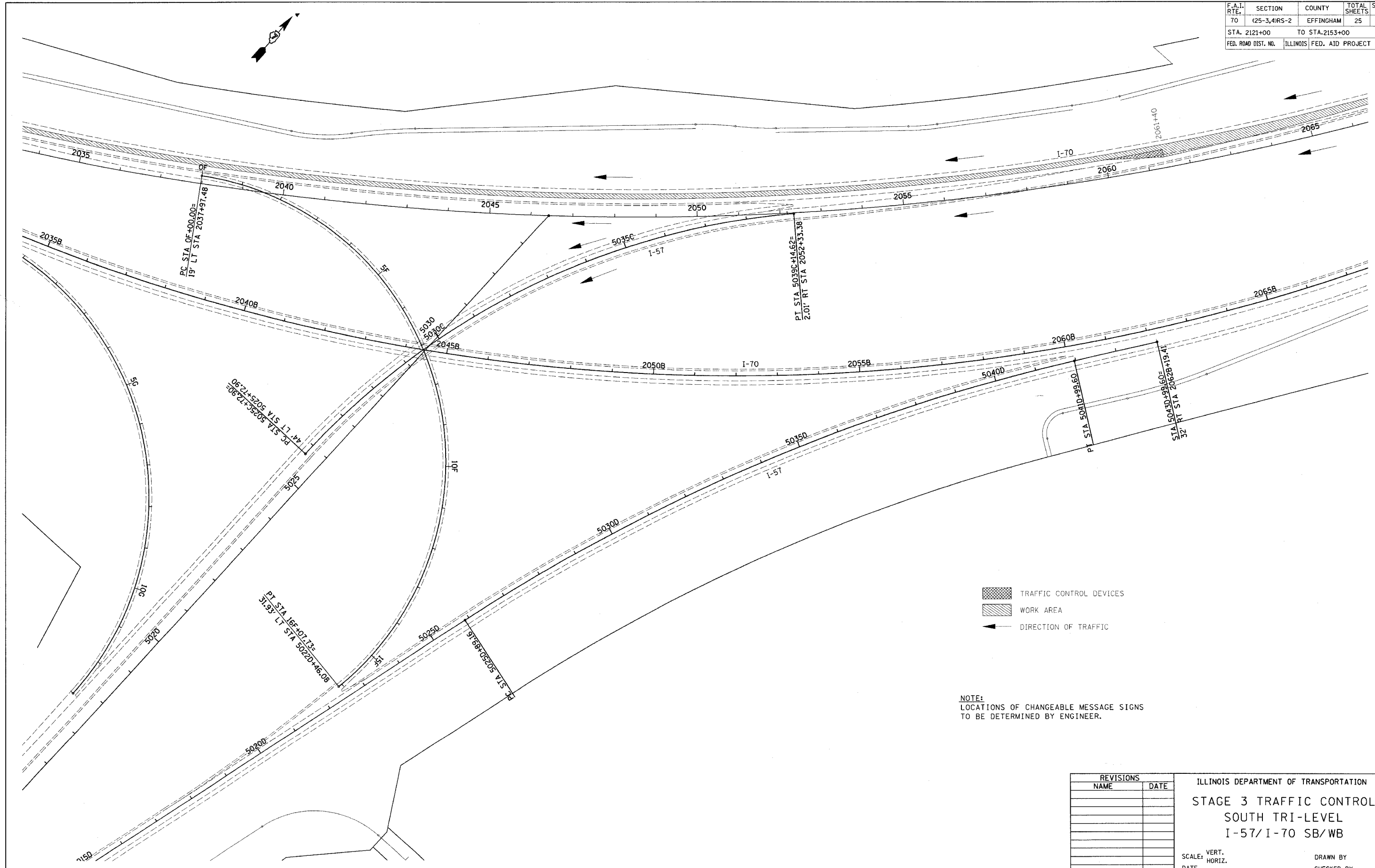

REVISIONS	
NAME	DATE

ILLINOIS DEPARTMENT OF TRANSPORTATION  
 STAGE 3 TRAFFIC CONTROL  
 SOUTH TRI-LEVEL  
 I-57/I-70 SB/WB

SCALE: VERT. \_\_\_\_\_  
 HORIZ. \_\_\_\_\_

DATE \_\_\_\_\_ DRAWN BY \_\_\_\_\_  
 CHECKED BY \_\_\_\_\_