

ROUTE NO.	SECTION	COUNTY	TOTAL SHEETS	SHEET NO.
T.R. 331A	99-04127-00-BR	CLAY	11	4
ROAD DIST.	ILLINOIS	HARTER		

CONTRACT NO. 95454

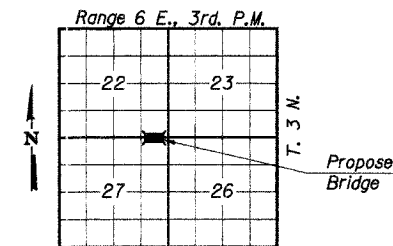

LOCATION PLAN

GENERAL NOTES

Reinforcement bars shall conform to the requirements of AASHTO M-31 or M-322, Grade 60.

The Contractor shall drive one steel test pile in a permanent location at each abutment as directed by the Engineer, before ordering the remainder of piles.

Layout of slope protection system may be varied in the field to suit ground conditions as directed by the Engineer.

See Proposal for Boring Data.

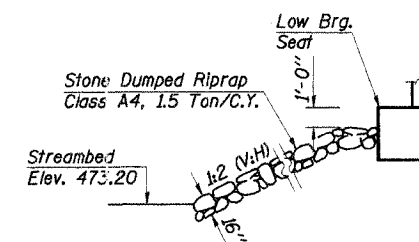

STONE RIPRAP DETAIL

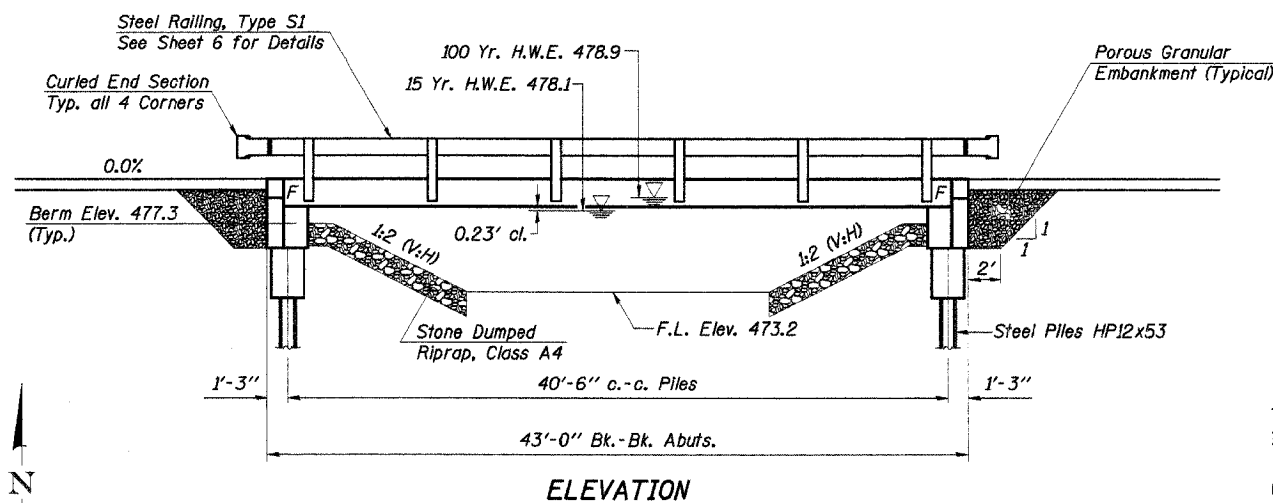

ELEVATION

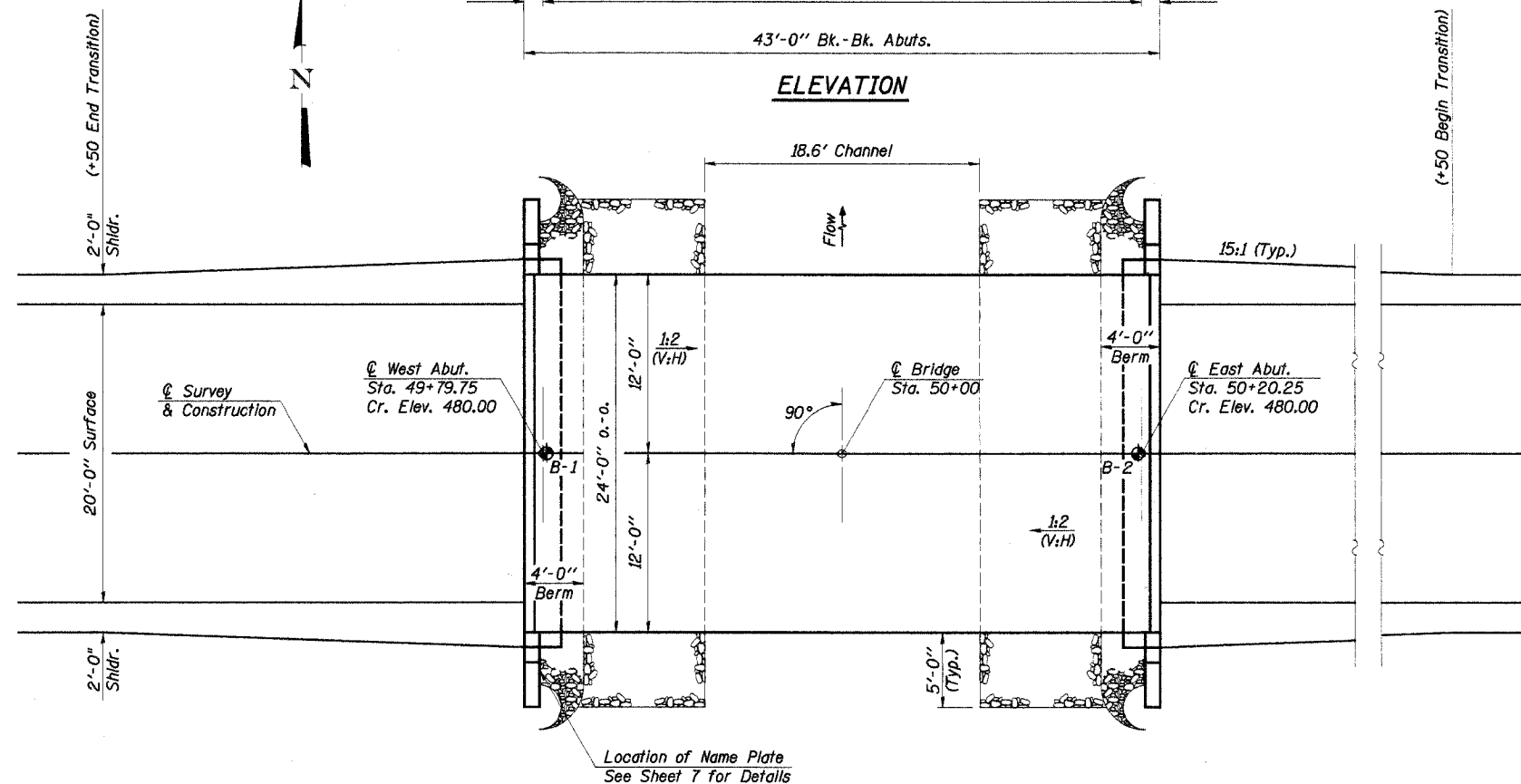

PLAN

ELM CREEK
BUILT 200_ BY
CLAY COUNTY
SEC. 99-04127-00-BR
F.A. PROJ. BROS-25(43)
STR. NO. 013-3227
LOADING HS20

LETTERING FOR NAME PLATE

See Std. 515001

TOTAL BILL OF MATERIAL

ITEM	UNIT	SUPER	SUB	TOTAL
Precast Prestressed Concrete Deck Beams (17" Depth)	Sq. Ft.	1,000		1,000
Concrete Structures	Cu. Yd.		16.8	16.8
Reinforcement Bars	Pound		2,640	2,640
Steel Railing, Type S1	Foot	85		85
Name Plates	Each		1	1
Steel Piles HP12x53	Foot		96	96
Test Pile Steel HP12x53	Each		2	2
Stone Dumped Riprap, Class A4	Ton		56	56
Concrete Encasement	Cu. Yd.		2.8	2.8
Porous Granular Embankment	Ton		46	46

WATERWAY INFORMATION

Drainage Area	120 Sq. Mi.
Existing Opening (15 Yr.)	71 Sq. Ft.
Required Opening (15 Yr.)	142 Sq. Ft.
Proposed Opening (15 Yr.)	142 Sq. Ft.
Design Discharge (15 Yr.)	475 C.F.S.
Created Head (15 Yr.)	0.2 Ft.
100 Year Discharge	773 C.F.S.
100 Yr. Created Head	0.5 Ft.

DESIGN STRESSES

$f_c = 5,000$ p.s.i. (Prestressed Beams)
 $f_{ci} = 4,000$ p.s.i. (Prestressed Beams)
 $f_c = 1,400$ p.s.i. (Concrete)
 $f_s = 270,000$ p.s.i. (Prestressed Strands)
 $f_{si} = 201,960$ p.s.i. (Prestressed Strands)
 $f_s = 24,000$ p.s.i. (Reinf. Bars -- Field Units)
 $f_y = 60,000$ p.s.i. (Reinf. Bars -- Field Units)
 $n = 9$ (Concrete)
 LOADING HS20-44
 Design Specifications: 2002 AASHTO
 25#/Sq. Ft. Included in dead load for
 future wearing surface.

"I certify that to the best of my knowledge, information and belief, this bridge design is structurally adequate for the design loading shown on the plans. The design is an economical one for the style of structure and complies with requirements of the current 'AASHTO Standard Specifications for Highway Bridges'."

Fred J. Stone, Jr. (9-21-06)
 ILLINOIS STRUCTURAL NO. 2934 (Expires 11/30/06)



DESIGNED	F.J.S.
CHECKED	S.F.M.
DRAWN	S.A.P.
CHECKED	S.F.M.

GENERAL PLAN & ELEVATION

SECTION 99-04127-00-BR
 HARTER ROAD DISTRICT
 CLAY COUNTY
 STATION 50+00

4440 ASH GROVE
 SPRINGFIELD, IL 62711
 (217) 793-8600
 oasino@ineightbb.com

OZYURT AND STONE, INC.
 CONSULTING ENGINEERS

JOB NO.: 0502
 FILE: 0502GPE.DGN
 DATE: 03/20/06