

ROUTE	SECTION	COUNTY	TOTAL SHEETS	SHEET NO.
F.A.S. 801	03-00110-00-BR	RICHLAND	13	3
CONTRACT NO. 95456		ILLINOIS	PROJECT BRS-801(228)	

SCALES:
 1" = 20' HOR
 1" = 5' VER

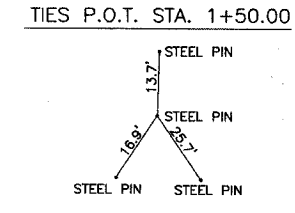

SECTION 03-00110-00-BR BEGINS STA. 1+35.00

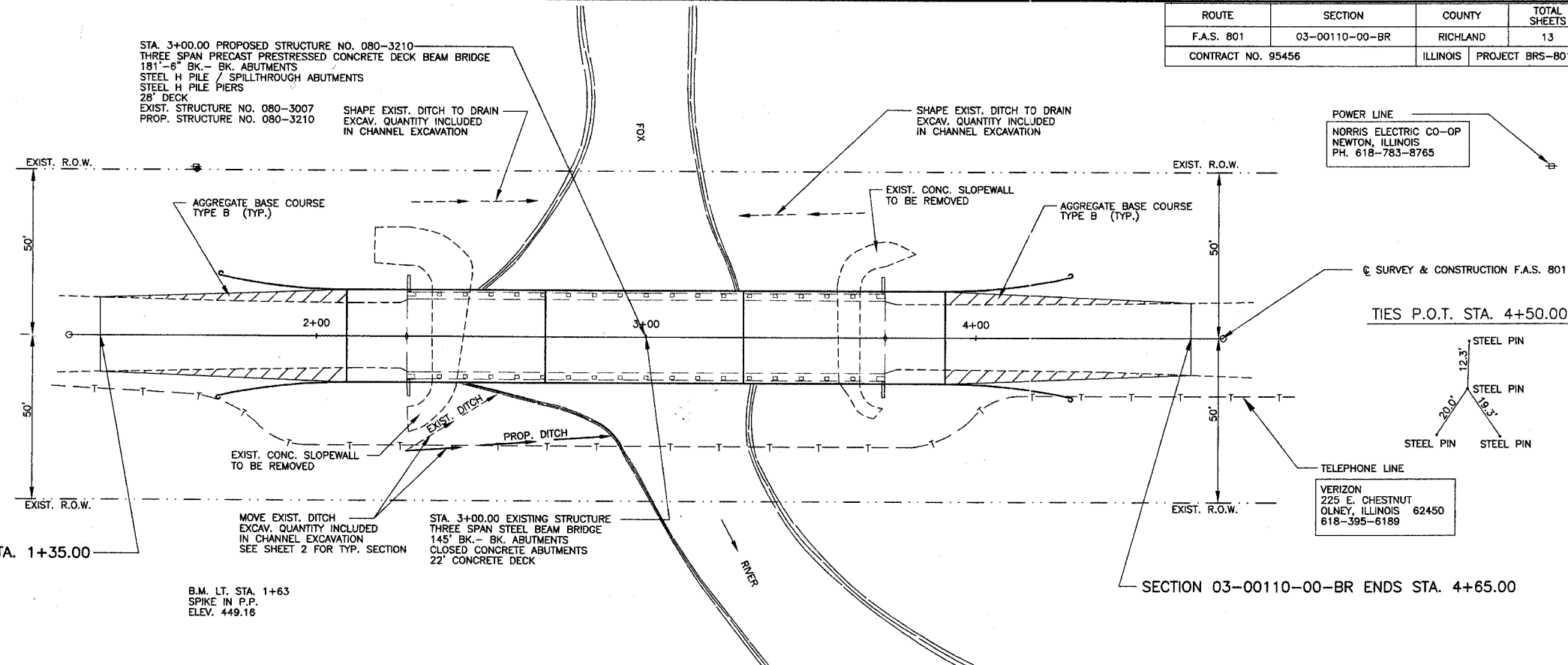

POWER LINE
 NORRIS ELECTRIC CO-OP
 NEWTON, ILLINOIS
 PH. 618-783-8765

☉ SURVEY & CONSTRUCTION F.A.S. 801

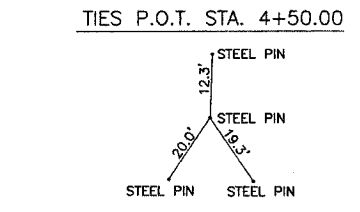

TELEPHONE LINE
 VERIZON
 225 E. CHESTNUT
 OLNEY, ILLINOIS 62450
 618-395-6189

SECTION 03-00110-00-BR ENDS STA. 4+65.00

B.M. LT. STA. 1+63
 SPIKE IN P.P.
 ELEV. 449.16

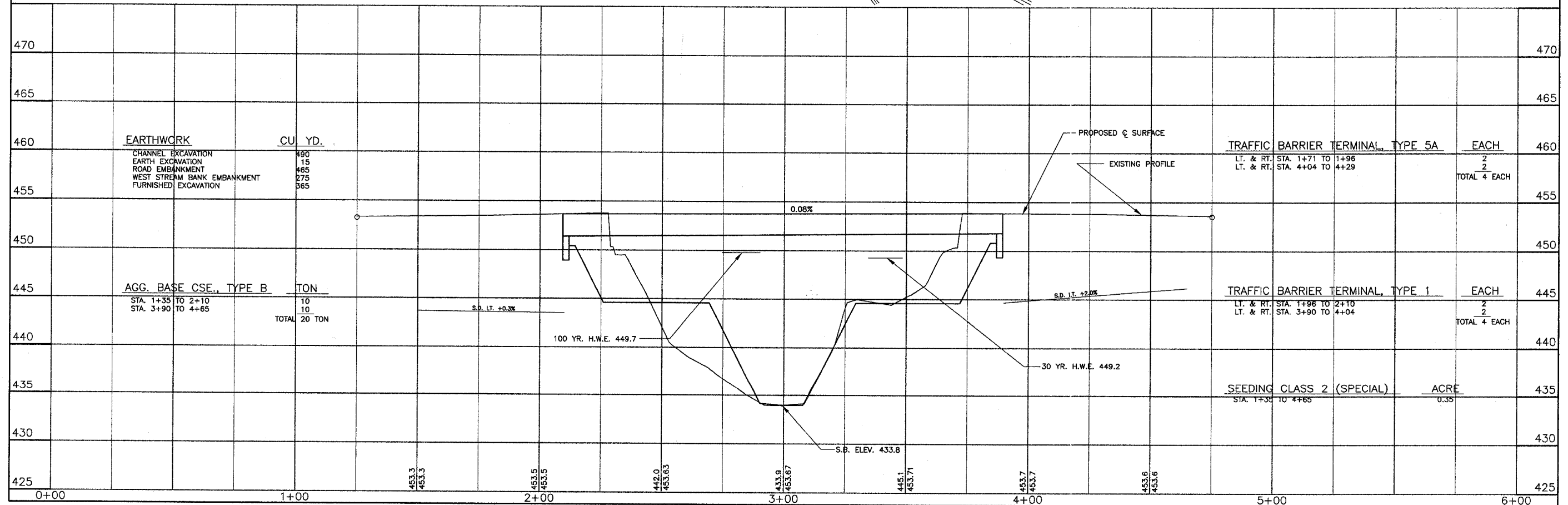

EARTHWORK	CU. YD.
CHANNEL EXCAVATION	490
EARTH EXCAVATION	15
ROAD EMBANKMENT	465
WEST STREAM BANK EMBANKMENT	275
FURNISHED EXCAVATION	365

AGG. BASE CSE., TYPE B	TON
STA. 1+35 TO 2+10	10
STA. 3+90 TO 4+65	10
TOTAL	20 TON

TRAFFIC BARRIER TERMINAL, TYPE 5A	EACH
LT. & RT. STA. 1+71 TO 1+96	2
LT. & RT. STA. 4+04 TO 4+29	2
TOTAL	4 EACH

TRAFFIC BARRIER TERMINAL, TYPE 1	EACH
LT. & RT. STA. 1+96 TO 2+10	2
LT. & RT. STA. 3+90 TO 4+04	2
TOTAL	4 EACH

SEEDING CLASS 2 (SPECIAL)	ACRE
STA. 1+35 TO 4+65	0.35