

STATE OF ILLINOIS
DEPARTMENT OF TRANSPORTATION
DIVISION OF HIGHWAYS
PLANS FOR PROPOSED
FEDERAL-AID B.R.R.P. PROGRAM
CRAWFORD COUNTY
SECTION 05-04118-00-BR
LICKING ROAD DISTRICT
STRUCTURE NO. 017-3425
PROJECT NO. BROS-033(45)
JOB NO. C-97-056-06
TR 86

INDEX OF SHEETS

- 1 COVER SHEET
- 2 PLAN & PROFILE
- 3-10 BRIDGE PLANS

STANDARDS: 280001-02 - TEMPORARY EROSION CONTROL SYSTEMS
702001-06 - TRAFFIC CONTROL DEVICES
BLR 21-6 - TRAFFIC CONTROL
BLR 22-4 - TRAFFIC CONTROL

SCALES

PLAN 1 INCH = 50 FEET
PROFILE HORZ. 1 INCH = 50 FEET
PROFILE VERT. 1 INCH = 10 FEET

SUMMARY OF QUANTITIES			X080-2A
QUANTITY	UNIT	ITEM	CODE NO.
163	CU YD	CHANNEL EXCAVATION	20300100
110	TON	STONE DUMPED RIPRAP, CLASS A4	28100807
1	EACH	REMOVAL OF EXISTING STRUCTURES	50100100
36.2	CU YD	CONCRETE STRUCTURES	50300225
2100	SQ FT	PRECAST PRESTRESSED CONCRETE DECK BEAMS (17" DEPTH)	50400305
4260	POUND	REINFORCEMENT BARS	50800105
150	FOOT	STEEL RAILING, TYPE S1	50900205
540	FOOT	FURNISHING STEEL PILES HP 10X42	51201400
540	FOOT	DRIVING STEEL PILES	51202700
2	BACH	TEST PILE STEEL HP 10X42	51203400
10.9	CU YD	CONCRETE ENCASEMENT	51204315
1	EACH	NAME PLATES	51500100
1	L SUM	MOBILIZATION	67100100
1	L SUM	TRAFFIC CONTROL AND PROTECTION	70101700

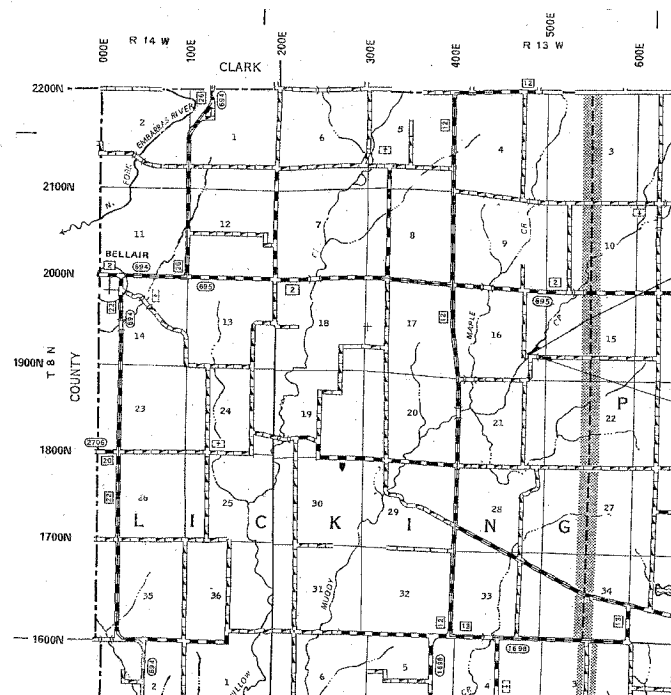

SECTION 05-04118-00-BR
BEGINS STA. 4+98.75

STA. 5+37-STANDARD BRIDGE DESIGN
PROPOSED PRECAST PRESTRESSED CONC.
DECK BEAM BRIDGE, 3 SPANS @ 25' EACH
28' RDWY, SKEW=0°
PROPOSED STR. NO. 017-3425
EXISTING STR. NO. 017-3416

SECTION 05-04118-00-BR
ENDS STA. 5+75.25

FUNCTIONAL CLASS: RURAL LOCAL ROAD
ADT = 50
DESIGN SPEED = 30 MPH

LOCATION MAP

APPROXIMATE SCALE: 1 INCH = 1 MILE
NET LENGTH = 76.50 FT. = 0.014 MILES

TOLL FREE JOINT UTILITY LOCATING
INFORMATION FOR EXCAVATORS (J.U.L.I.E.)
TELEPHONE NO. 1-800-892-0123

CONTRACT NO. 95466

PROFESSIONAL DESIGN FIRM #184-000832

Michael
ILLINOIS REGISTERED PROFESSIONAL ENGINEER # 31350
LICENSE EXPIRES DECEMBER 30, 2007
2/21/2006

APPROVED February 23, 2006

Justin R. Hill
LOCAL AGENCY REPRESENTATIVE

PASSED 3/22, 2006

Maureen E. Keel
DISTRICT SEVEN ENGINEER
OF LOCAL ROADS & STREETS

RELEASING FOR BID BASED ON LIMITED REVIEW

3/22, 2006

Christina M. Reed
DEPUTY DIRECTOR OF HIGHWAYS
REGION FOUR ENGINEER
STATE OF ILLINOIS
DEPARTMENT OF TRANSPORTATION