

SIGN LEGEND

1		R11-3 WITH 2 AMBER FLASHING LIGHTS. (3 REQ'D)	
2		R11-3 WITH 2 AMBER FLASHING LIGHTS. (1 REQ'D)	(12)
3		W20-2, 48" x 48" WITH AMBER FLASHING LIGHT AND FLAG. (3 REQ'D)	(13)
4		W20-3, 48" x 48" WITH AMBER FLASHING LIGHT AND FLAG. (2 REQ'D)	(14)
6		W20-3, 48" x 48" WITH AMBER FLASHING LIGHT AND FLAG. (2 REQ'D)	(15)
7		M3-2 24"x12" (11 REQ'D)	(16)
8		M3-4 24"x12" (8 REQ'D)	(17)
9		M4-8 24"x12" (17 REQ'D)	(18)
10		M1-I100 24"x12" (22 REQ'D)	(19)
(12)		M6-1 21"x15" (3 REQ'D)	(20)
(13)		M6-3 21"x15" (9 REQ'D)	(21)
(14)		M5-1 R 21"x15" (1 REQ'D)	(22)
(15)		M6-1 21"x15" (4 REQ'D)	
(16)		M4-8A 24"x48" (2 REQ'D)	
(17)		R11-2 48"x30" (4 REQ'D)	
(18)		R11-3 60"x30" (1 REQ'D)	
(19)		R11-4 60"x30" (2 REQ'D)	
(21)		M4-10R 48"x18" (2 REQ'D)	
(22)		TYPE I:1 BARRICADES WITH TWO FLASHING LIGHTS EACH. (6 REQ'D) STD 702001-06	

LEGEND

- DETOUR ROUTE
- ROAD OPEN TO LOCAL TRAFFIC ONLY
- 48" x 48" CONSTRUCTION SIGN, WITH AMBER FLASHING LIGHT AND ORANGE WARNING FLAG (OPTIONAL) NUMBER DENOTES SIGN TYPE
- M4-9 SERIES DETOUR SIGN WITH DIRECTION AND ROAD NAME PLATES NUMBER DENOTES TYPE
- OTHER DETOUR SIGNS, NUMBER DENOTES TYPE

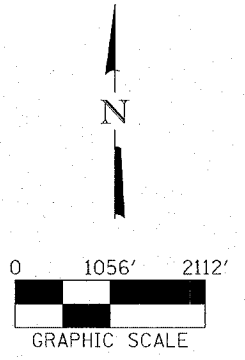
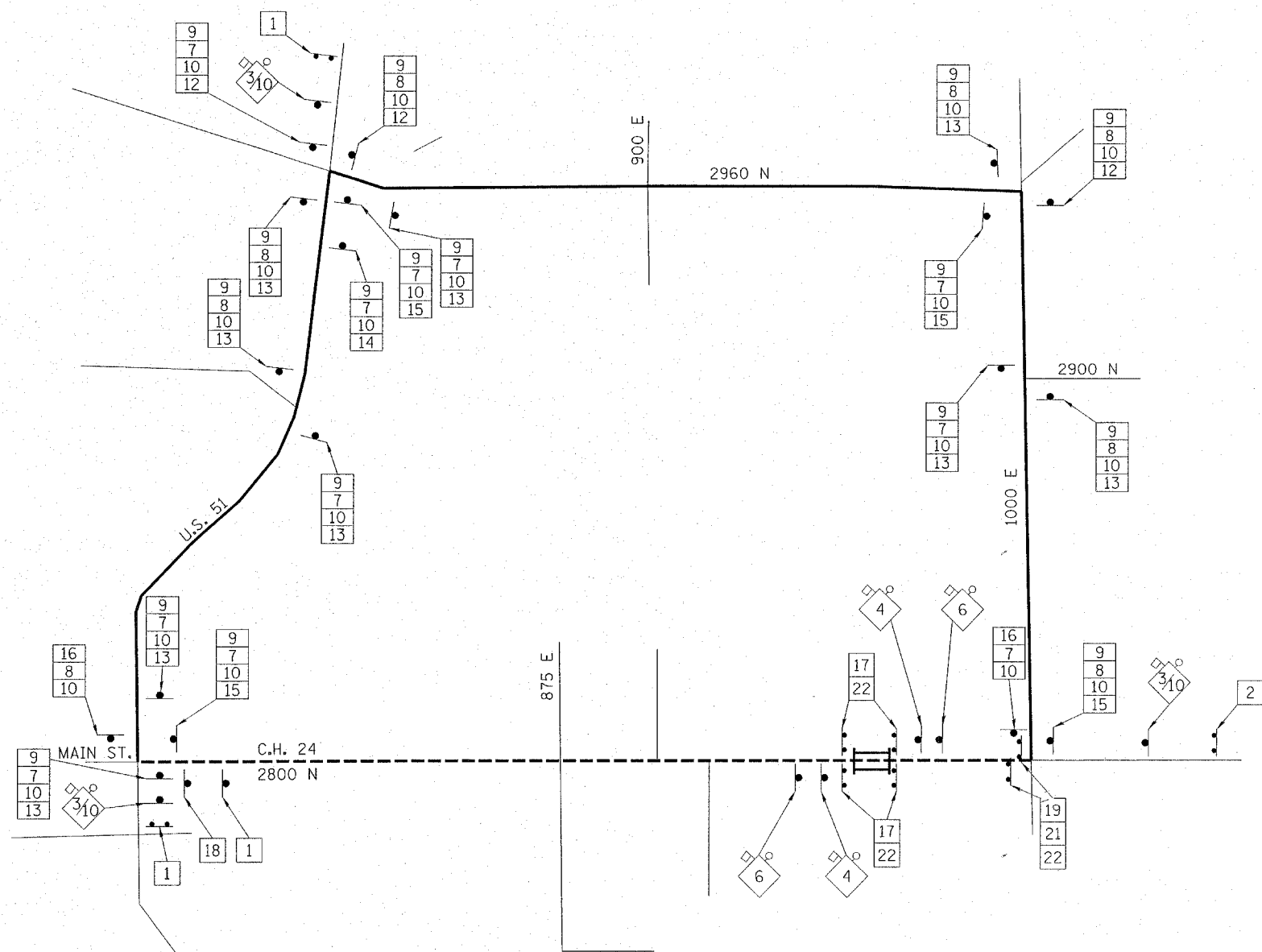

HLR
 Rice, Berry and Associates
 A Division of Hampton,
 Lenzini and Renwick, Inc.
 Civil & Structural Engineers
 3085 Stevenson Drive
 Suite 201
 Springfield, Illinois 62703
 217-546-3400
 P.O. Box 1036
 DuQuoin, Illinois 62832
 618-790-4637
 Account Number 12-34-0002-1
 Date: 03/09/06
 DESIGNED: L.F.S. CHECKED: S.W.M. DRAWN: D.T.M.

DETOUR PLAN
 SECTION 02-00104-00-BR
 F.A.S. 712 / C.H. 24
 FAYETTE COUNTY