

ROUTE NO.	SECTION	COUNTY	TOTAL SHEETS	SHEET NO.
S.B.L. F.A.	05-0007-03-07	EFFINGHAM	54	18
FED. ROAD DIST. NO. 7	ILLINOIS	FED. AID PROJECT-		

CONTRACT #95473

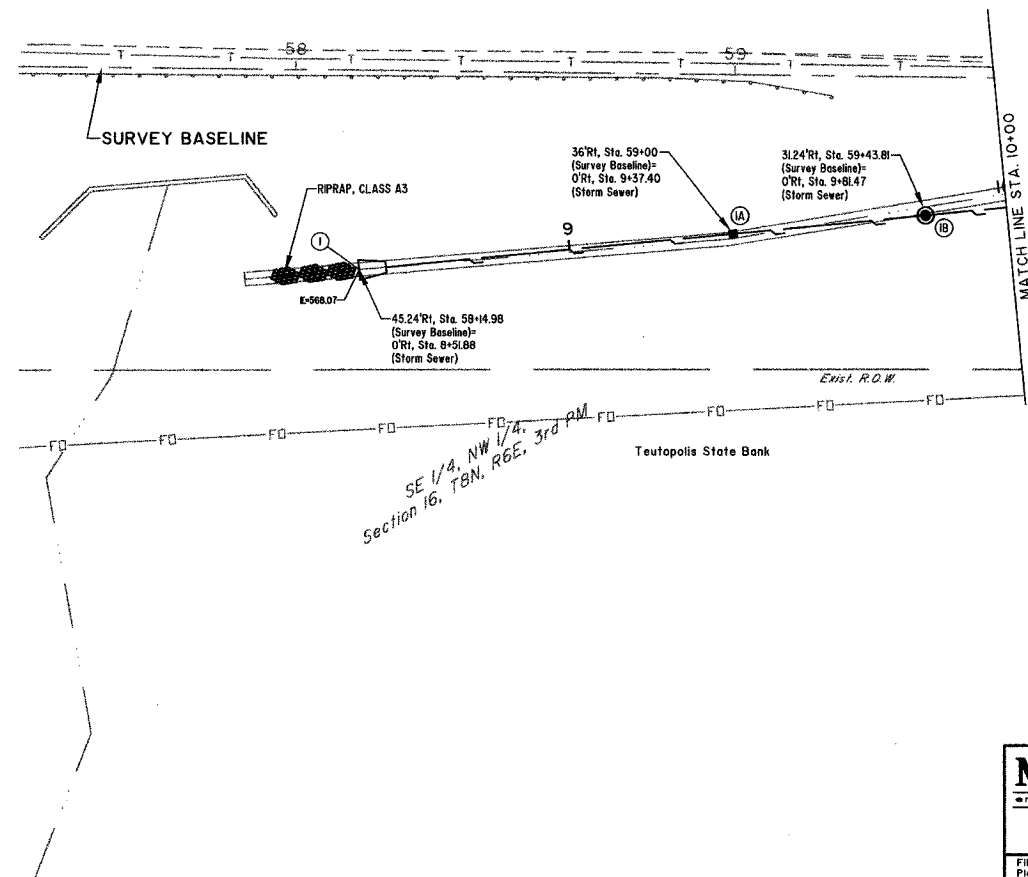

SCALES:  
 1" = 20' HOR  
 1" = 5' VER

REVISED: March 15, 2006

**BM #7**  
 CAP BOLT AT POINT OF "OPEN" ARROW ON FIRE HYDRANT, WEST SIDE OF DRIVEWAY TO WILLENBORG'S HOUSE.  
 25'RI, Sta. 63+36.50, ELEV.=604.33

**MILANO & GRUNLOH ENGINEERS, LLC**  
 14 WEST WASHINGTON  
 P.O. BOX 897  
 EFFINGHAM, ILLINOIS 62401  
 Phone: (217) 342-7282  
 (800) 617-5714  
 Fax #: (217) 342-3433  
 Web Address: www.mgengineers.com  
 Design Firm #: 04-00308  
 File name: S:\DWG\05\05000\dwg\Section 3.dwg  
 Plot date: 03/23/06 at 12:00

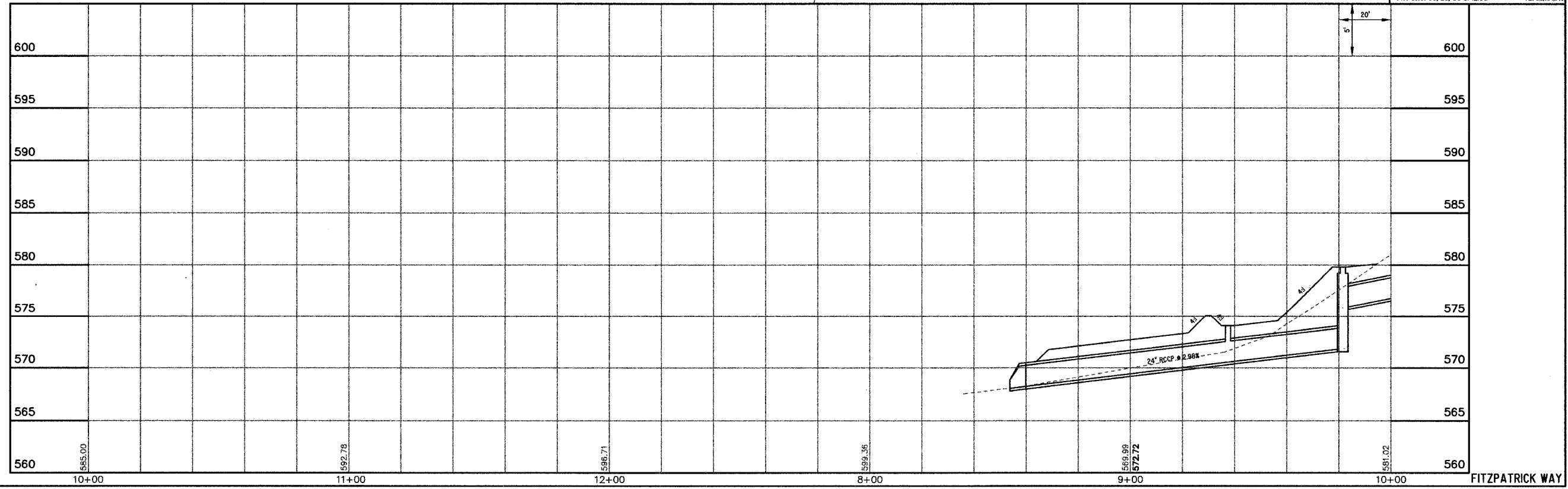

FITZPATRICK WAY