

F.A.U. RTE.	SECTION	COUNTY	TOTAL SHEETS	SHEET NO.
8361	05-00083-08-SF	EFFINGHAM	40	12
STA. 800+00.00		TO STA. 807+88.52		
FED. ROAD DIST. NO. 7 ILLINOIS FED. AID PROJECT				

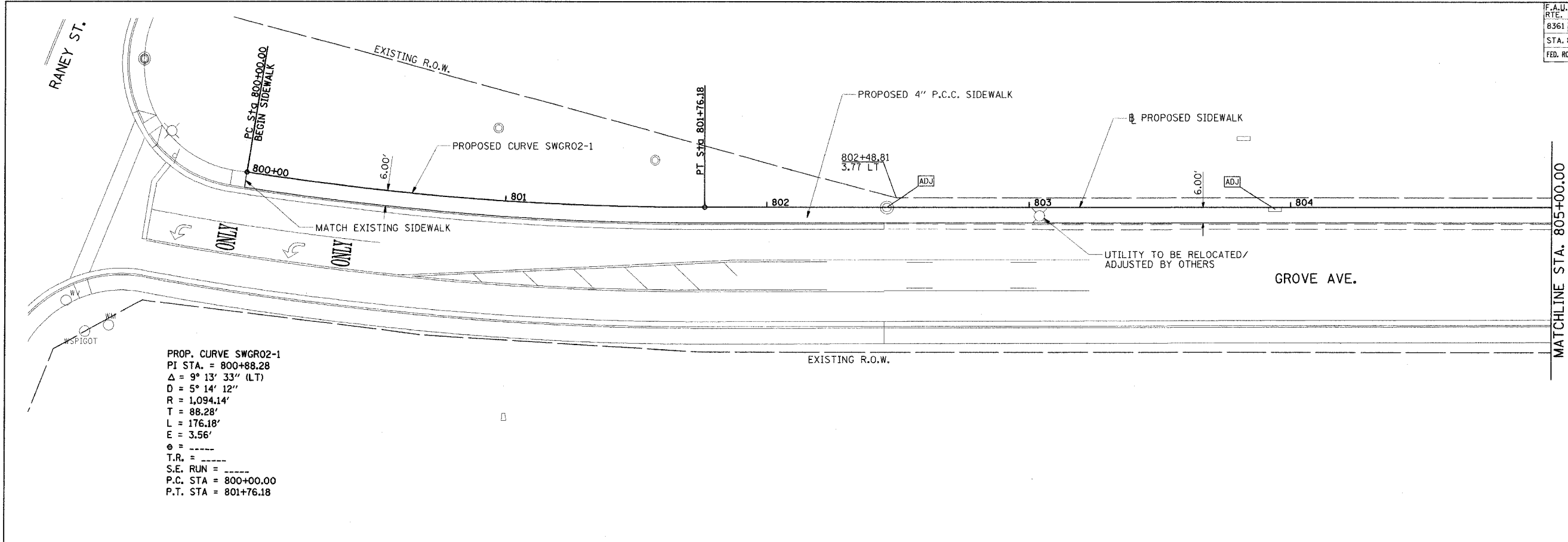

PROP. CURVE SWGR02-1
 PI STA. = 800+88.28
 $\Delta = 9^\circ 13' 33''$ (LT)
 $D = 5^\circ 14' 12''$
 $R = 1,094.14'$
 $T = 88.28'$
 $L = 176.18'$
 $E = 3.56'$
 $\theta = \text{-----}$
 $T.R. = \text{-----}$
 $S.E. RUN = \text{-----}$
 P.C. STA = 800+00.00
 P.T. STA = 801+76.18

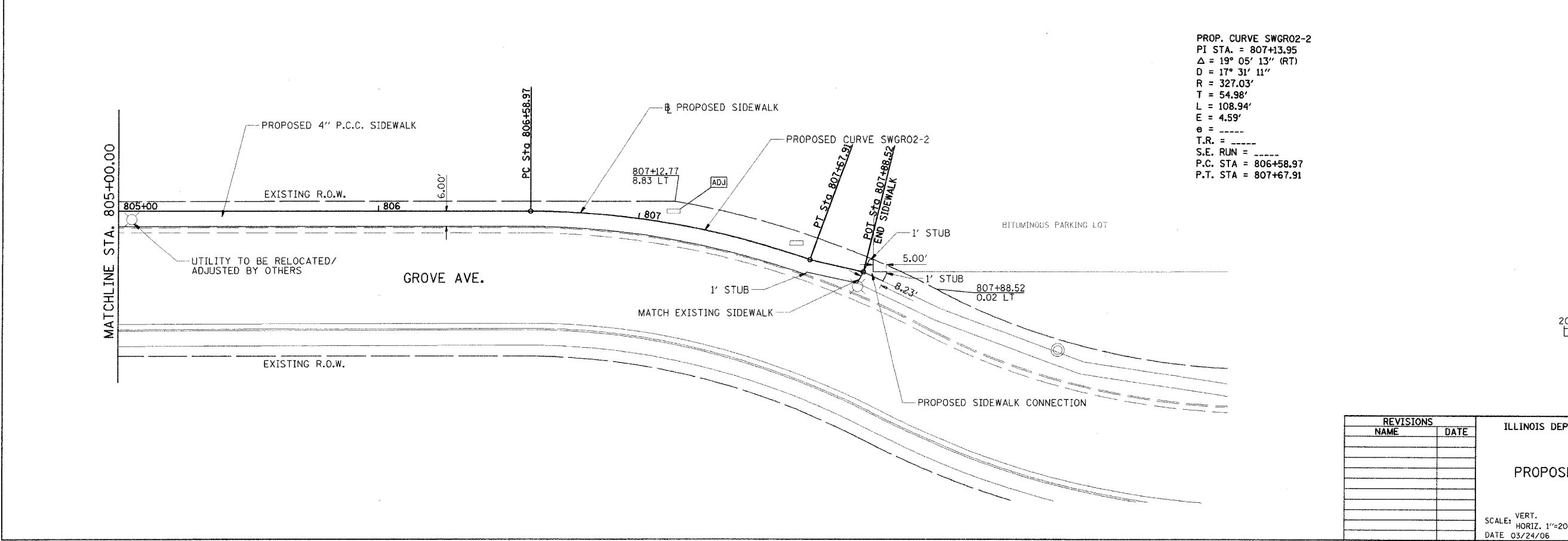

PROP. CURVE SWGR02-2
 PI STA. = 807+13.95
 $\Delta = 19^\circ 05' 13''$ (RT)
 $D = 17^\circ 31' 11''$
 $R = 327.03'$
 $T = 54.98'$
 $L = 108.94'$
 $E = 4.59'$
 $\theta = \text{-----}$
 $T.R. = \text{-----}$
 $S.E. RUN = \text{-----}$
 P.C. STA = 806+58.97
 P.T. STA = 807+67.91



Hanson Professional Services Inc.
 1525 South Sixth Street
 Springfield, Illinois 62703-2886
 Offices Nationwide

PLT DATE = 03/24/06 08:37 AM
 FILE NAME = H:\8361\05-00083-08-SF\Road\Sheet\011-SHG.dgn
 PLOT SCALE = 20/80000 / IN.
 USER NAME = jao

REVISIONS	
NAME	DATE

ILLINOIS DEPARTMENT OF TRANSPORTATION

**PROPOSED SIDEWALK PLAN
 GROVE AVE.**

SCALE: VERT. 1"=20'
 HORIZ. 1"=20'
 DATE 03/24/06

DRAWN BY JAP
 CHECKED BY JTB