



☑ CORPORATE OFFICE

4940 OLD COLLINSVILLE RD.
SWANSEA, ILLINOIS 62226
TEL (618) 624-4488
FAX (618) 624-6688
corp@twm-inc.com

☐ WATERLOO OFFICE

113 SOUTH MAIN STREET
WATERLOO, ILLINOIS 62298
TEL (618) 939-5050
FAX (618) 939-3938
waterloo@twm-inc.com

☐ ST. LOUIS OFFICE

1001 CRAIG ROAD, SUITE 260
ST. LOUIS, MISSOURI 63146
TEL (314) 236-5052
FAX (314) 872-2194
stlouis@twm-inc.com

PROFESSIONAL REGISTRATIONS LICENSE NO.

ILLINOIS PROFESSIONAL DESIGN FIRM 184-00120
PROFESSIONAL ENGINEERING CORP. 62-005370
PROFESSIONAL STRUCTURAL ENGR. CORP. 81-005202
ILLINOIS PROF. LAND SURVEYING CORP. 048-000029

MISSOURI PROFESSIONAL ENGR. CORP. NC 000528
MISSOURI LAND SURVEYING CORP. NC 000346

SEAL

Revised Date:
Signature Date:

STATEMENT OF RESPONSIBILITY

I hereby certify that the document herein to be authorized by my seal is restricted to this sheet, and I hereby disclaim any responsibility for all other drawings, specifications, estimates, reports or other documents or instruments relating to or intended to be utilized for any other part of the architectural, engineering or survey project.

ROADWAY PLAN AND PROFILE

**SEIBERT RD RECONSTRUCTION
PHASE I
VILLAGE OF SHILOH
ST. CLAIR COUNTY, ILLINOIS**

REV	DATE	DESCRIPTION
△	/ /	
△	/ /	

DRAWN BY:	SHEET 12 OF 40 SHEETS
DESIGNED BY:	
CHECKED BY:	
APPROVED BY:	
PROJECT NUMBER:	
<input type="checkbox"/> ISSUED FOR REVIEW	<input type="checkbox"/> ISSUED FOR BIDDING
<input type="checkbox"/> ISSUED FOR CONSTR.	<input type="checkbox"/> RECORD DRAWING

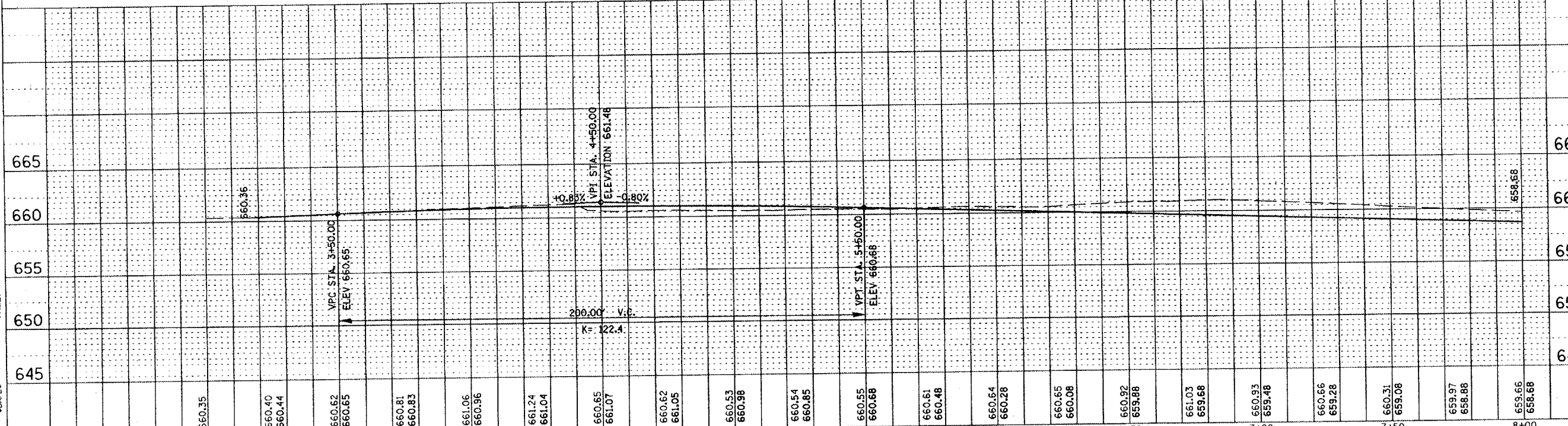
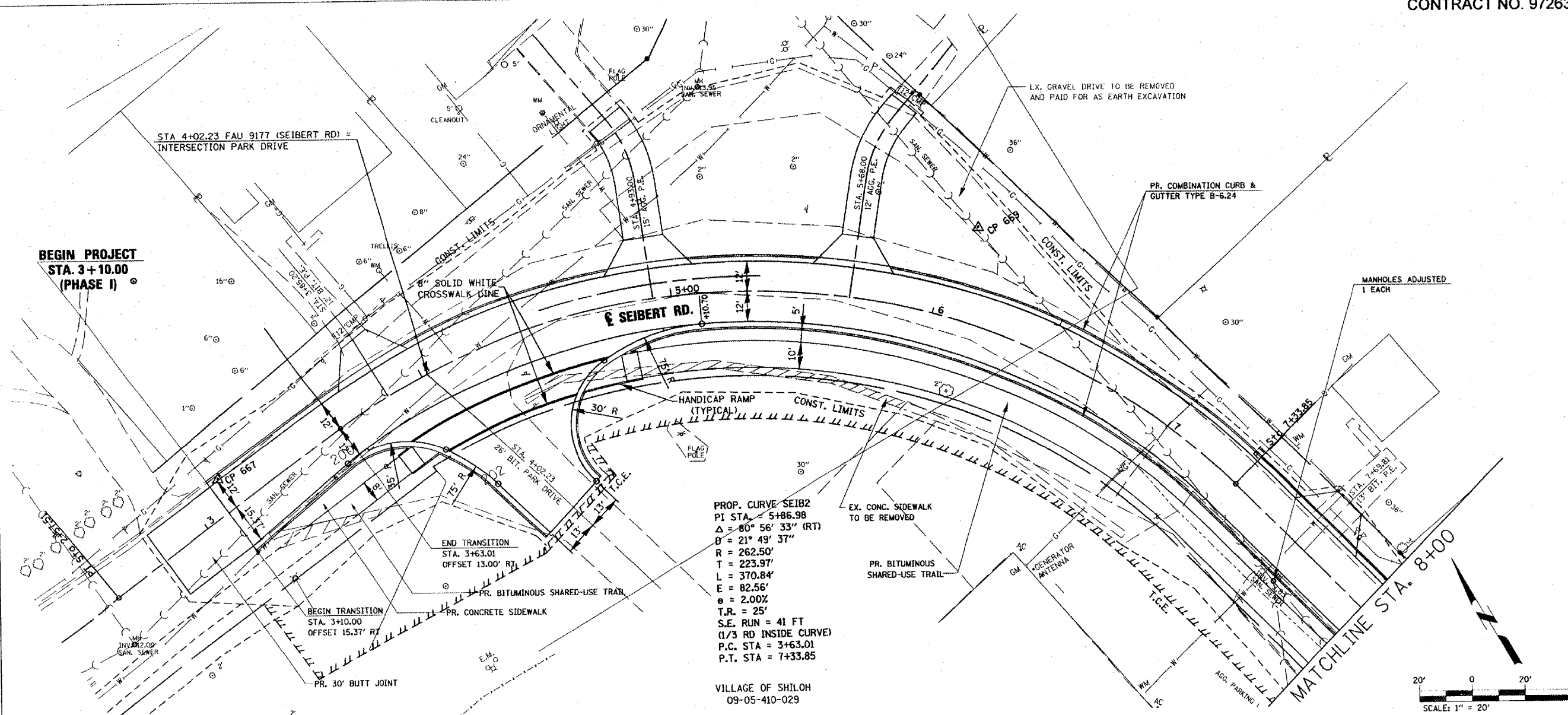

PLAN

DATE	
BY	
CHECKED	
NO.	

PROFILE

DATE	
BY	
CHECKED	
NO.	

FILES

DATE	
BY	
CHECKED	
NO.	