

ROUTE NO.	SECTION	COUNTY	TOTAL SHEETS	SHEET NO.
FAU 9319 C.H. 2 EXT	04-00042 -01-WR	MONROE	24	23

FEDERAL AID PROJECT
CONTRACT 97275

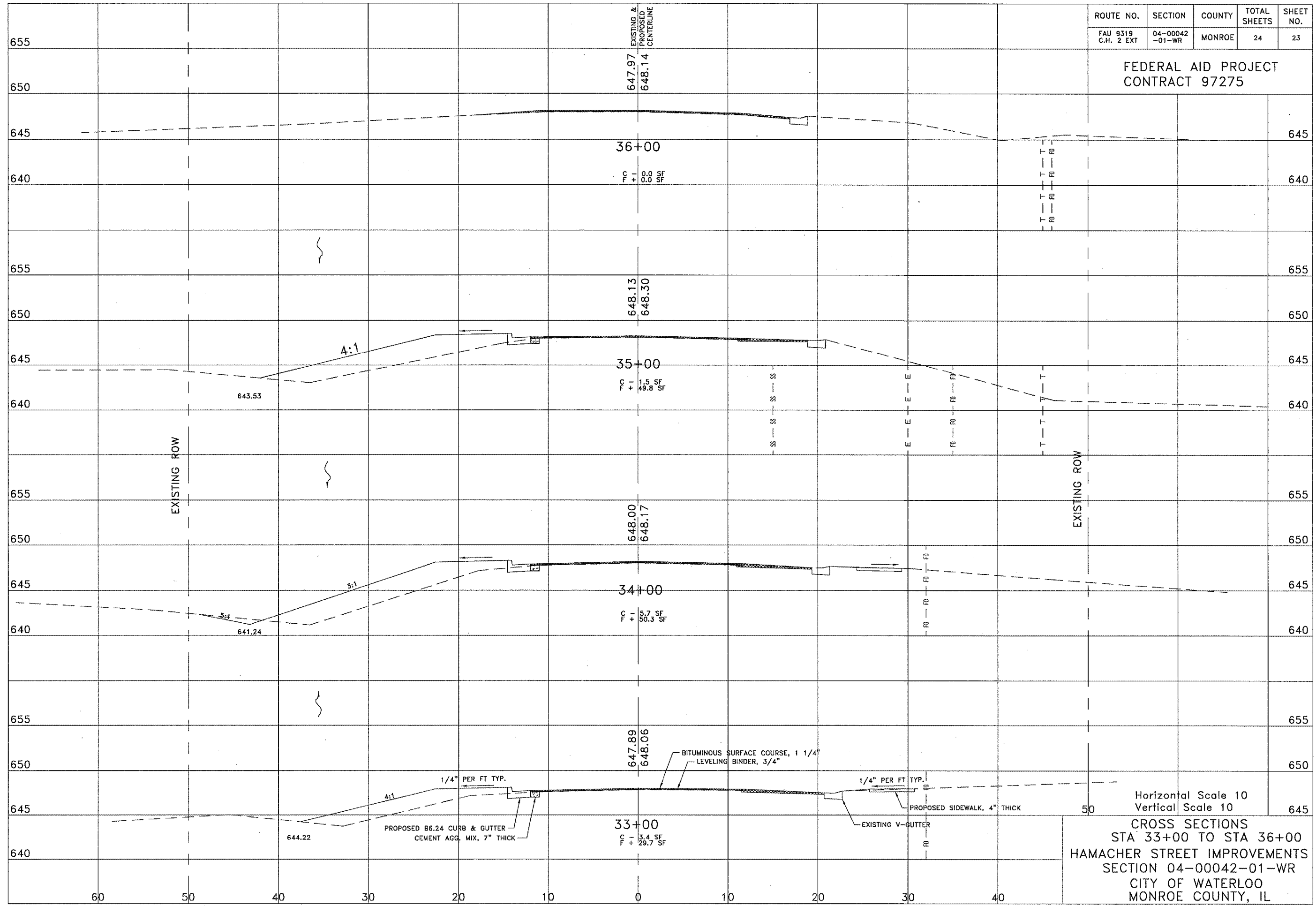

Horizontal Scale 10
Vertical Scale 10

CROSS SECTIONS
STA 33+00 TO STA 36+00
HAMACHER STREET IMPROVEMENTS
SECTION 04-00042-01-WR
CITY OF WATERLOO
MONROE COUNTY, IL