

F.A.I. RTE.	SECTION	COUNTY	TOTAL SHEETS	SHEET NO.
57	*	WILLIAMSON	60	35
STA. _____ TO STA. _____		ILLINOIS FED. AID PROJECT		
* EX1-(4,4-1,5,6,6-2) R-1				

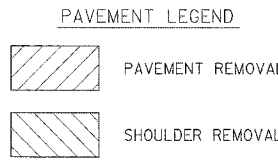
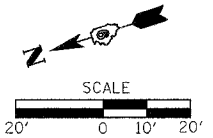

PAVEMENT REMOVAL BEGINS  
STATION 361+50  
(SEE DETAIL SHEET 56)

PAVEMENT REMOVAL ENDS  
STATION 365+30  
(SEE DETAIL SHEET 56)

PLAN	DATE
NO.	
BY	
CHECKED	
DATE	

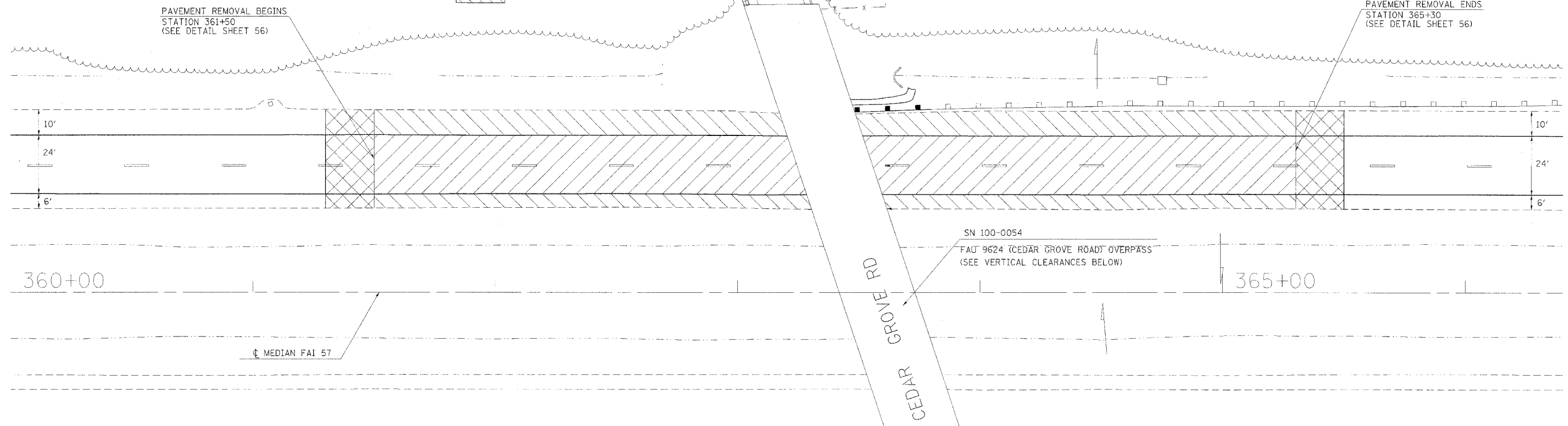

**VERTICAL CLEARANCES FOR CEDAR GROVE OVERPASS**

STATION	EXISTING LOW STEEL ELEVATION	EXISTING CENTERLINE PAVEMENT ELEVATION	PROPOSED CENTERLINE PAVEMENT ELEVATION	PROPOSED VERTICAL CLEARANCE FEET
363+26.82 NB	512.48	496.37	496.42	16.06
363+53.33 NB	512.51	496.29	496.29	16.22

PROFILE	DATE
NO.	
BY	
CHECKED	
DATE	

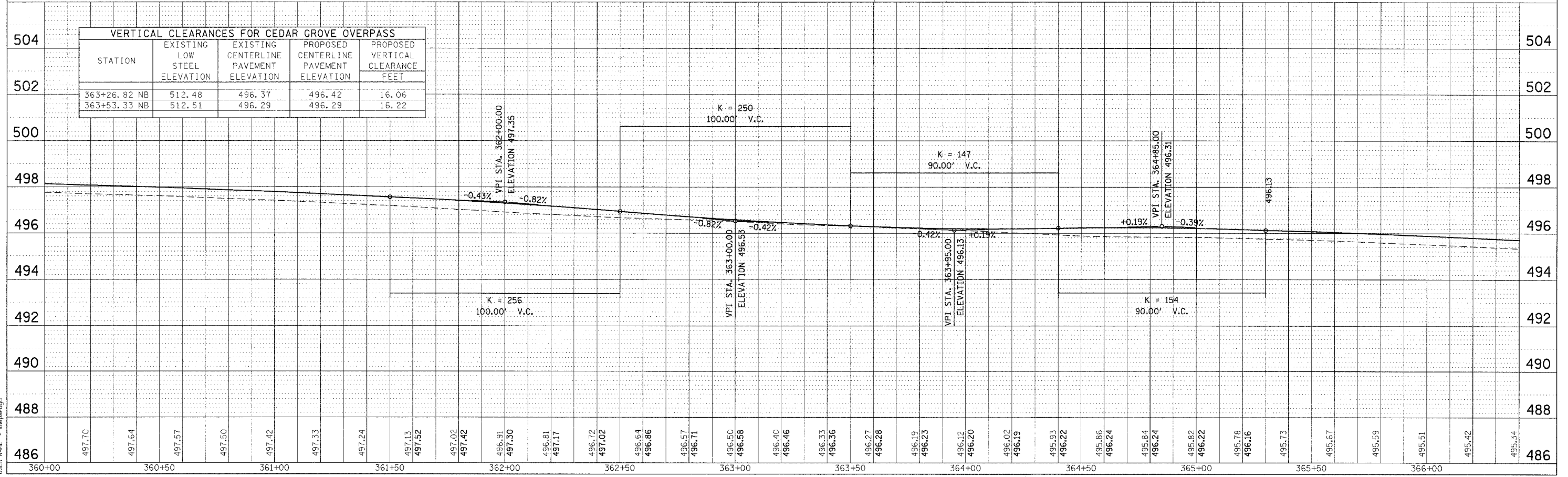

PLOT DATE = 3/30/2006  
 PLOT SCALE = 24.0000 IN.  
 USER NAME = sheparcggd