

district
3/23/2006
c:\projects\94909d\05203pa.d

CONTRACT NO. 98980

F.A.P. RTE.	SECTION	COUNTY	TOTAL SHEETS	SHEET NO.
853	9RS-4	HAMILTON	12	1

STATE OF ILLINOIS
DEPARTMENT OF TRANSPORTATION
DIVISION OF HIGHWAYS

**PROPOSED
HIGHWAY PLANS**

FAP ROUTE 853 (IL 14)

SECTION 9RS-4

PROJECT : F-0853(010)

**BITUMINOUS RESURFACING
HAMILTON COUNTY**

C-99-047-06

FOR INDEX OF SHEETS, SEE SHEET NO. 2

STATION EQUATIONS

STA 188+99.9 BK = STA 189+00.1 AH
STA 206+06.7 BK = STA 206+02.3 AH
STA 222+94.1 BK = STA 223+80.9 AH
STA 256+11.2 BK = STA 256+52.8 AH

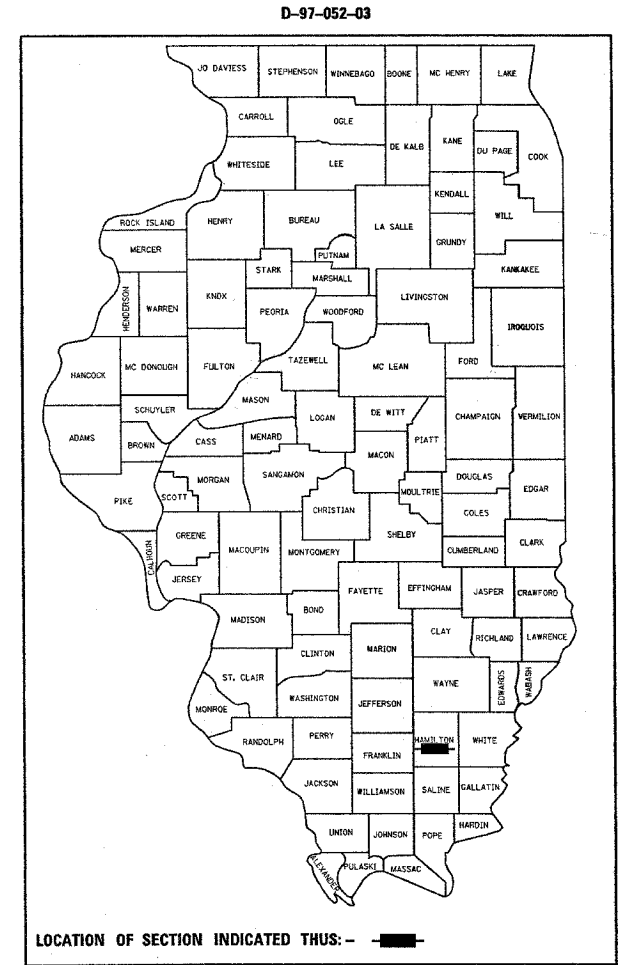

LOCATION OF SECTION INDICATED THUS: - ■ -

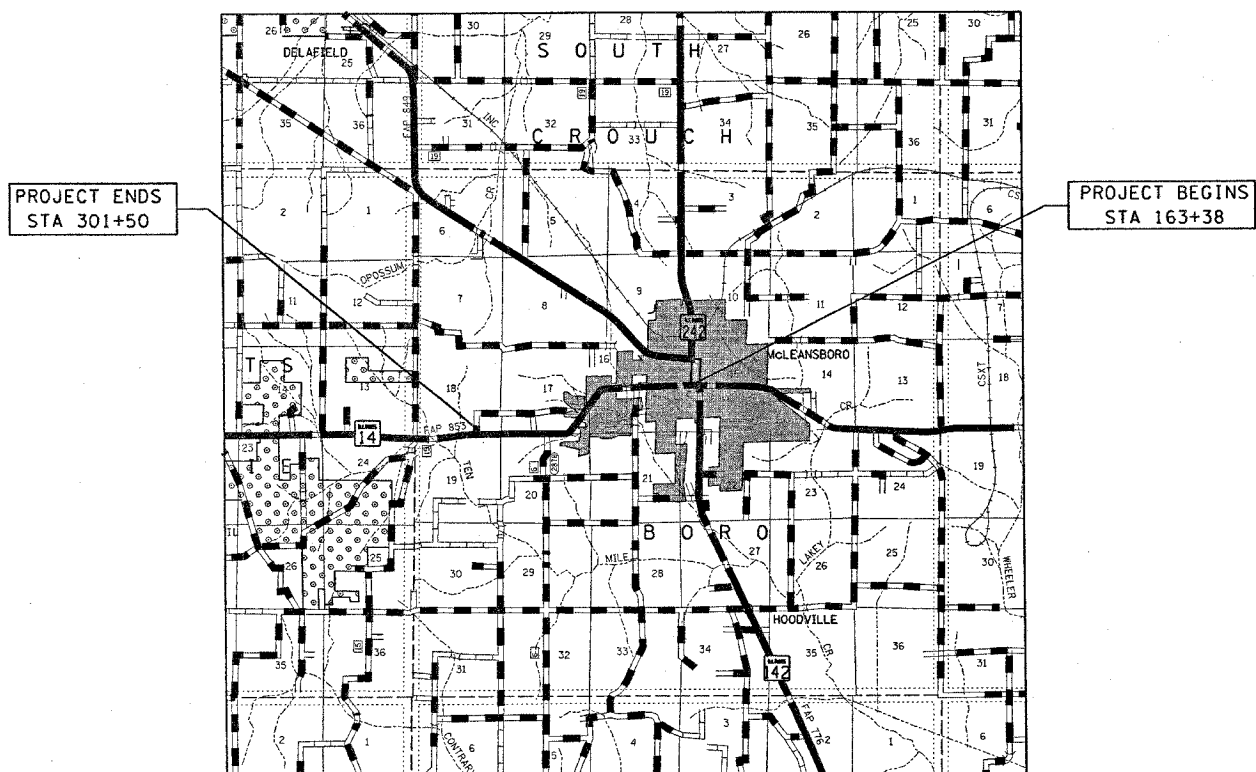

GROSS LENGTH = 13687.8 FEET = 2.59 MILES
NET LENGTH = 13687.8 FEET = 2.59 MILES

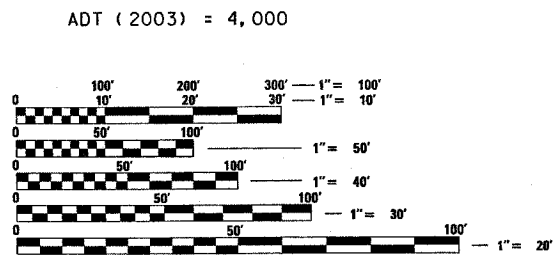

FULL SIZE PLANS HAVE BEEN PREPARED USING STANDARD ENGINEERING SCALES. REDUCED SIZED PLANS WILL NOT CONFORM TO STANDARD SCALES. IN MAKING MEASUREMENTS ON REDUCED PLANS, THE ABOVE SCALES MAY BE USED.

J.U.L.I.E.
JOINT UTILITY LOCATION INFORMATION FOR EXCAVATION
1-800-892-0123

STATE OF ILLINOIS
DEPARTMENT OF TRANSPORTATION
DIVISION OF HIGHWAYS

SUBMITTED March 24, 2006
Chris M. Reed
DEPUTY DIRECTOR OF HIGHWAYS, REGION ENGINEER

May 12, 2006
Mike Hone
ENGINEER OF DESIGN AND ENVIRONMENT

May 12, 2006
Milton R. See
DIRECTOR OF HIGHWAYS, CHIEF ENGINEER

**PRINTED BY THE AUTHORITY
OF THE STATE OF ILLINOIS**

CONTRACT NO. 98980 TOWNSHIP : MC LEANSBORO

PROJECT ENGINEER : MARK DAUGHERTY
SQUAD LEADER : KRISTI SANDSCHAFER
DESIGNER : ED TOCKSTEIN
TELEPHONE : 217/342-3951 EX 313

district
 3/23/2006
 c:\projects\94909d\05203pa.d

CONTRACT NO. 98980

F.A.P. RTE.	SECTION	COUNTY	TOTAL SHEETS	SHEET NO.
853	9RS-4	HAMILTON	12	2
STA.		TO STA.		
FED. ROAD DIST. NO.		ILLINOIS	FED. AID PROJECT	

GENERAL NOTES

THIS PROJECT IS LOCATED ON ILLINOIS ROUTE 14 IN HAMILTON COUNTY, BEGINNING AT WASHINGTON STREET IN MCLEANSBORO AND EXTENDING APPROXIMATELY 2.6 MILES IN A SOUTH-WESTERLY DIRECTION. THE WORK INCLUDED IN THIS SECTION CONSISTS OF PAVEMENT PATCHING, MILLING, RESURFACING, AND OTHER WORK NECESSARY TO COMPLETE THIS SECTION.

THE CONTRACTOR SHALL PROVIDE INTERNET ACCESS TO THE BITUMINOUS PLANT QUALITY CONTROL LAB SO THAT BITUMINOUS PLANT REPORTS CAN BE E-MAILED TO THE DISTRICT HEADQUARTERS. THIS WORK WILL NOT BE PAID FOR SEPARATELY BUT SHALL BE INCLUDED IN THE UNIT PRICES FOR OTHER ITEMS IN THE CONTRACT.

BITUMINOUS MATERIALS (PRIME COAT) SHALL BE EITHER RC-70 OR SS-1HP.

THE COST OF REMOVAL OF THE TEMPORARY RAMP SHALL BE INCLUDED IN THE UNIT PRICE FOR TEMPORARY RAMP.

SHORT TERM PAVEMENT MARKING ON THE MILLED SURFACE SHALL BE PAINT. ALL OTHER SHORT TERM PAVEMENT MARKINGS SHALL BE TAPE.

THE ACTUAL LOCATIONS OF PAVEMENT PATCHES SHALL BE DETERMINED BY THE RESIDENT ENGINEER.

THE MATERIAL USED FOR AGGREGATE SHOULDERS, TYPE B SHALL BE CRUSHED STONE, CRUSHED CONCRETE OR RAP.

THE MATERIAL USED FOR AGGREGATE SURFACE COURSE, TYPE B SHALL BE CRUSHED STONE OR CRUSHED CONCRETE.

THE TOTAL QUANTITY OF PAINT PAVEMENT MARKING - LINE 4" CONSISTS OF 11,333 FEET OF YELLOW AND 22,130 FEET OF WHITE.

THE TOTAL QUANTITY OF THERMOPLASTIC PAVEMENT MARKING - LINE 4" CONSISTS OF 587 FEET OF YELLOW AND 3,041 FEET OF WHITE.

THE TOTAL QUANTITY OF THERMOPLASTIC PAVEMENT MARKING - LINE 24" CONSISTS OF 40 FEET OF WHITE.

THE TOTAL QUANTITY OF RAISED REFLECTIVE PAVEMENT MARKERS CONSISTS OF 172 TWO-WAY AMBER MARKERS.

THE FOLLOWING MIXTURE REQUIREMENTS ARE APPLICABLE FOR THIS PROJECT:

MIXTURE USE(S):	LEVELING BINDER	SURFACE COURSE
AC/PG:	PG 64-22	PG 64-22
RAP%: (MAX)	10%	10%
DESIGN AIR VOIDS:	4.0% @ NDESIGN = 90	4.0% @ NDESIGN = 90
MIXTURE COMPOSITION:	IL-9.5 OR IL-12.5	IL-9.5 OR IL-12.5
(GRADATION)		
FRICITION AGGREGATE:	MIXTURE C	MIXTURE C
MIXTURE USE(S):	PAVEMENT PATCHING	INCIDENTAL BITUMINOUS SURFACING
AC/PG:	PG 64-22	PG 64-22
RAP%: (MAX)	10%	10%
DESIGN AIR VOIDS:	3.0% @ NDESIGN = 90	4.0% @ NDESIGN = 90
MIXTURE COMPOSITION:	IL-19.0	IL-9.5 OR IL-12.5
(GRADATION)		
FRICITION AGGREGATE:	N/A	MIXTURE C

THE FOLLOWING RATES OF APPLICATION HAVE BEEN USED IN THE CALCULATING PLAN QUANTITIES:

AGGREGATE SURFACE COURSE	2.05 TONS/CU YD
AGGREGATE SHOULDERS	2.05 TONS/CU YD
BITUMINOUS MATERIALS (PRIME COAT)	0.10 GAL/SQ YD
AGGREGATE (PRIME COAT)	4 LBS/SQ YD
BITUMINOUS CONCRETE	112 LBS/SQ YD/INCH

INDEX OF SHEETS

SHEET NO	TITLE
1	COVER SHEET
2	GENERAL NOTES, INDEX OF SHEETS, LIST OF STANDARDS
3	SUMMARY OF QUANTITIES
4	TYPICAL SECTIONS
5	MILLING DETAILS
6	PAVING SCHEDULE
7	ENTRANCE SCHEDULE
8-10	PLAN SHEETS
11-12	PAVEMENT MARKING DETAILS

THE FOLLOWING STANDARDS ARE A PART OF THESE PLANS AND ARE INCLUDED FOLLOWING SHEET NUMBER 12:

000001-04	STANDARD SYMBOLS, ABBREVIATIONS AND PATTERNS
001006	DECIMAL OF AN INCH AND OF A FOOT
406201	MAILBOX TURNOUT
442201-01	CLASS C AND D PATCHES
701006-02	OFF-ROAD OPERATIONS, 2L, 2W, 4.5 M (15') TO 600 MM (24") FROM PAVEMENT EDGE
701011-01	OFF-ROAD MOVING OPERATIONS, 2L, 2W, DAY ONLY
701301-02	LANE CLOSURE, 2L, 2W, SHORT TIME OPERATIONS
701306-01	LANE CLOSURE, 2L, 2W, SLOW MOVING OPERATIONS DAY ONLY, FOR SPEEDS >= 45 MPH
701311-02	LANE CLOSURE, 2L, 2W, MOVING OPERATIONS-DAY ONLY
701336-04	LANE CLOSURE, 2L, 2W, WORK AREAS IN SERIES, FOR SPEEDS > 45 MPH
701501-03	URBAN LANE CLOSURE, 2L, 2W, UNDIVIDED
702001-06	TRAFFIC CONTROL DEVICES
780001-01	TYPICAL PAVEMENT MARKINGS
781001-02	TYPICAL APPLICATIONS RAISED REFLECTIVE PAVEMENT MARKERS

PLOT DATE = 3/23/2006
 PLOT SCALE = KSCALE
 USER NAME = dbw1010

REVISIONS		ILLINOIS DEPARTMENT OF TRANSPORTATION
NAME	DATE	
		GENERAL NOTES & INDEX OF SHEETS
SCALE:	VERT. DATE	HORIZ.
		DRAWN BY
		CHECKED BY

district
3/23/2006
c:\projects\94909d\05203pa.d

CONTRACT NO. 98980				
F.A.P. RTE.	SECTION	COUNTY	TOTAL SHEETS	SHEET NO.
853	9RS-4	HAMILTON	12	3
STA.		TO STA.		
FED. ROAD DIST. NO.	ILLINOIS	FED. AID PROJECT		

SUMMARY OF QUANTITIES			CONSTRUCTION TYPE CODE			
CODE NO	ITEM	UNIT	TOTAL QUANTITIES	1000 80% FED. 20% STATE		
40200800	AGGREGATE SURFACE COURSE, TYPE B	TON	87	87		
40600100	BITUMINOUS MATERIALS (PRIME COAT)	GALLON	3790	3790		
40600300	AGGREGATE (PRIME COAT)	TON	76	76		
40600895	CONSTRUCTING TEST STRIP	EACH	1	1		
40600980	BITUMINOUS SURFACE REMOVAL - BUTT JOINT	SQ YD	125	125		
40600990	TEMPORARY RAMP	SQ YD	82	82		
44000030	BITUMINOUS SURFACE REMOVAL (VARIABLE DEPTH)	SQ YD	32230	32230		
44200168	PAVEMENT PATCHING, TYPE II, 14 INCH	SQ YD	67	67		
44200172	PAVEMENT PATCHING, TYPE III, 14 INCH	SQ YD	20	20		
44200174	PAVEMENT PATCHING, TYPE IV, 14 INCH	SQ YD	41	41		
48101200	AGGREGATE SHOULDERS, TYPE B	TON	594	594		
67000500	ENGINEER'S FIELD OFFICE, TYPE B	CAL MO	3	3		
67100100	MOBILIZATION	L SUM	1	1		
70100460	TRAFFIC CONTROL AND PROTECTION, STANDARD 701306	L SUM	1	1		
70100600	TRAFFIC CONTROL AND PROTECTION, STANDARD 701336	L SUM	1	1		
70102620	TRAFFIC CONTROL AND PROTECTION, STANDARD 701501	L SUM	1	1		
70300100	SHORT-TERM PAVEMENT MARKING	FOOT	4107	4107		
70300220	TEMPORARY PAVEMENT MARKING - LINE 4"	FOOT	37091	37091		
70300280	TEMPORARY PAVEMENT MARKING - LINE 24"	FOOT	40	40		
70301000	WORK ZONE PAVEMENT MARKING REMOVAL	SQ FT	457	457		
* 78000200	THERMOPLASTIC PAVEMENT MARKING - LINE 4"	FOOT	3628	3628		
* 78000650	THERMOPLASTIC PAVEMENT MARKING - LINE 24"	FOOT	40	40		
* 78001110	PAINT PAVEMENT MARKING - LINE 4"	FOOT	33463	33463		
* 78100100	RAISED REFLECTIVE PAVEMENT MARKER	EACH	172	172		
X4066418	BITUMINOUS CONCRETE SURFACE COURSE, SUPERPAVE, MIX "C", N90	TON	3184	3184		
X4066775	LEVELING BINDER (MACHINE METHOD), SUPERPAVE N90	TON	1584	1584		
X4409410	BITUMINOUS SURFACE REMOVAL 2 1/4"	SQ YD	5542	5542		
XX005223	INCIDENTAL BITUMINOUS SURFACING, SUPERPAVE, N90	TON	136	136		

* SPECIALTY ITEMS

REVISIONS	
NAME	DATE

ILLINOIS DEPARTMENT OF TRANSPORTATION

SUMMARY OF QUANTITIES

SCALE: VERT. DATE
HORIZ. DRAWN BY
CHECKED BY

PLOT DATE = 3/23/2006
FILE NAME = #FILE#
PLOT SCALE = #SCALE#
USER NAME = #USER#

district
3/23/2006
c:\projects\94909d\05203pa.d

CONTRACT NO. 98980

F.A.P. RTE.	SECTION	COUNTY	TOTAL SHEETS	SHEET NO.
853	9RS-4	HAMILTON	12	4
STA.		TO STA.		
FED. ROAD DIST. NO.		ILLINOIS	FED. AID PROJECT	

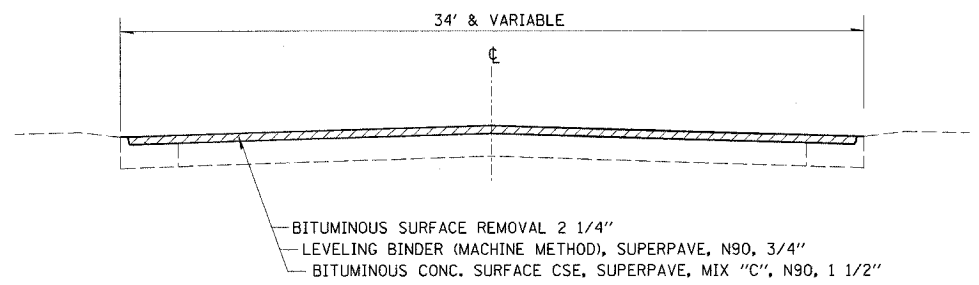

TYPICAL INLAY SECTIONS

STA 163+38 TO STA 166+98
STA 169+71 TO STA 171+46 (23.8' WIDTH)

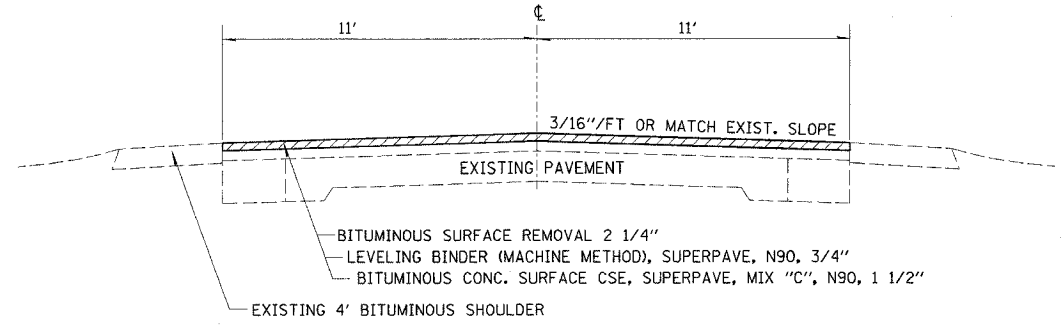

TYPICAL INLAY SECTIONS

STA 176+94 TO STA 180+15

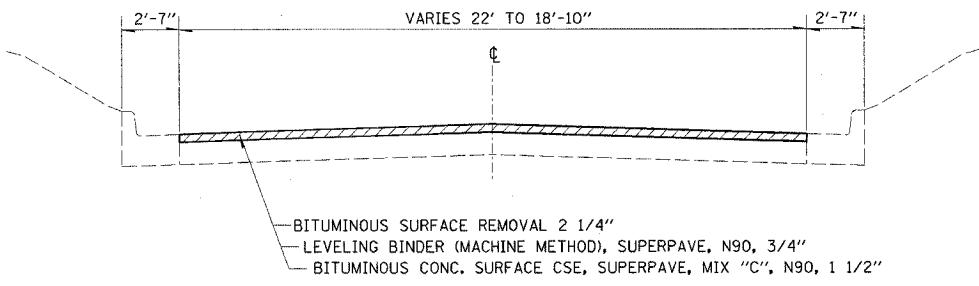

TYPICAL INLAY SECTIONS

STA 166+98 TO STA 169+71

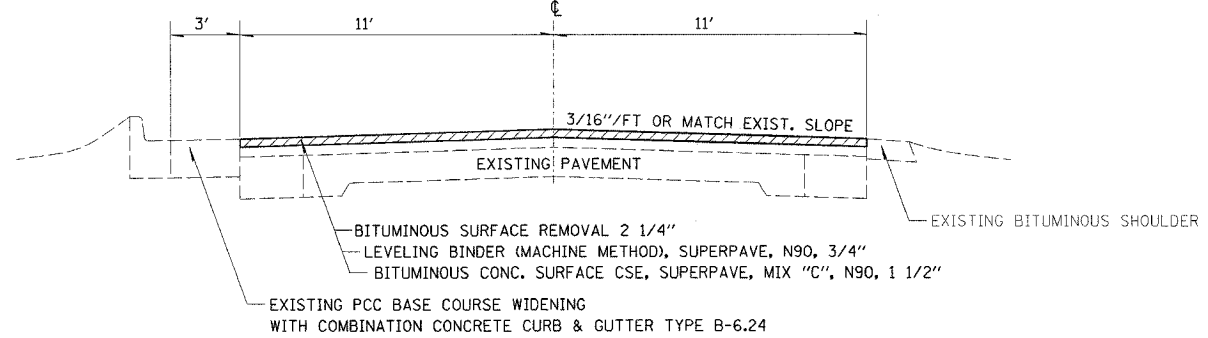

TYPICAL INLAY SECTIONS

STA 180+15 TO STA 183+56

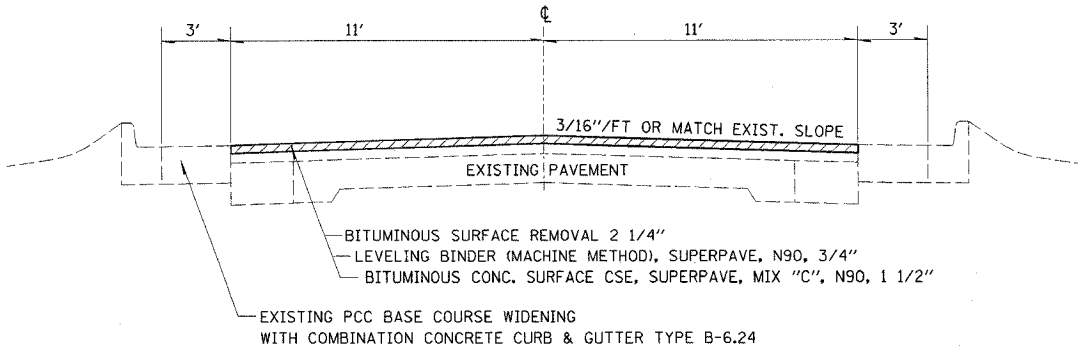

TYPICAL INLAY SECTIONS

STA 171+46 TO STA 176+94

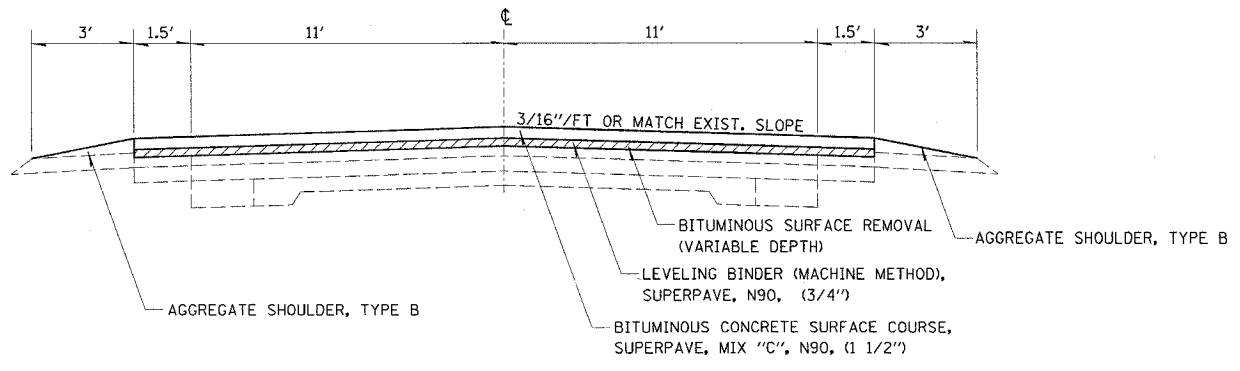

TYPICAL SECTIONS

STA 183+56 TO STA 301+50

PLOT DATE = 3/23/2006
FILE NAME = #FILE#
PLOT SCALE = #SCALE#
USER NAME = #USER#

REVISIONS	
NAME	DATE

ILLINOIS DEPARTMENT OF TRANSPORTATION

TYPICAL SECTIONS

SCALE: VERT.
DATE: HORIZ.

DRAWN BY
CHECKED BY

district
3/23/2006
c:\projects\949099\d05203\p.d

CONTRACT NO. 98980

F.A.P. RTE.	SECTION	COUNTY	TOTAL SHEETS	SHEET NO.
853	9RS-4	HAMILTON	12	5
STA.		TO STA.		
FED. ROAD DIST. NO.		ILLINOIS FED. AID PROJECT		

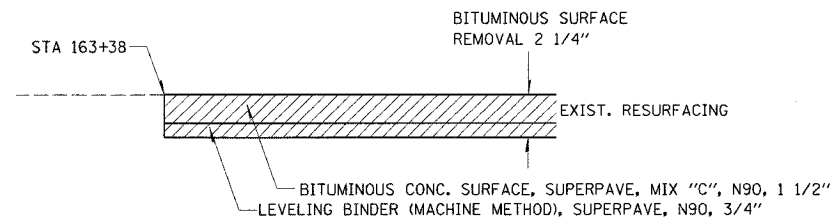

EAST END OF PROJECT

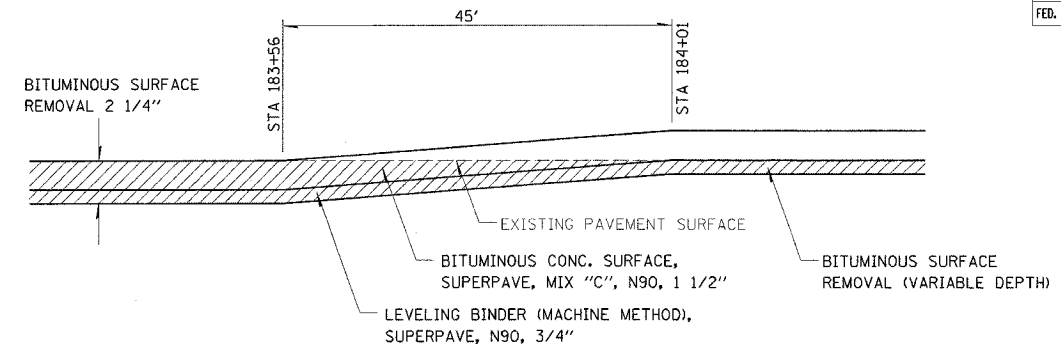

MILLING TRANSITION DETAIL

NOTE: MILLING IS PAID FOR AS BITUMINOUS SURFACE REMOVAL (VARIABLE DEPTH) IN TRANSITION AREAS.

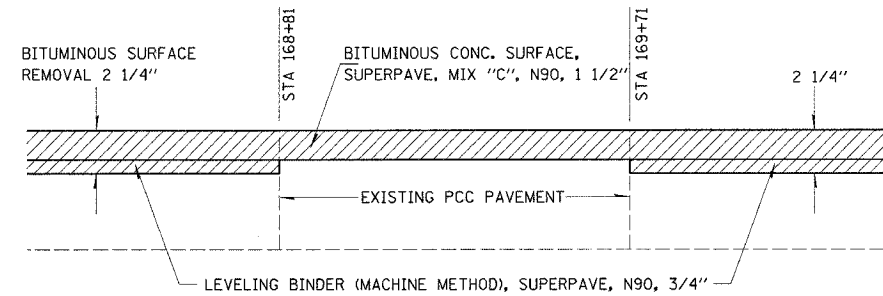

P.C.C. PAVEMENT UNDER R.R. VIADUCT

* MILLING OF 90' PCC PAVEMENT SECTION TO BE PAID FOR AS BIT. SURFACE REMOVAL 2 1/4"

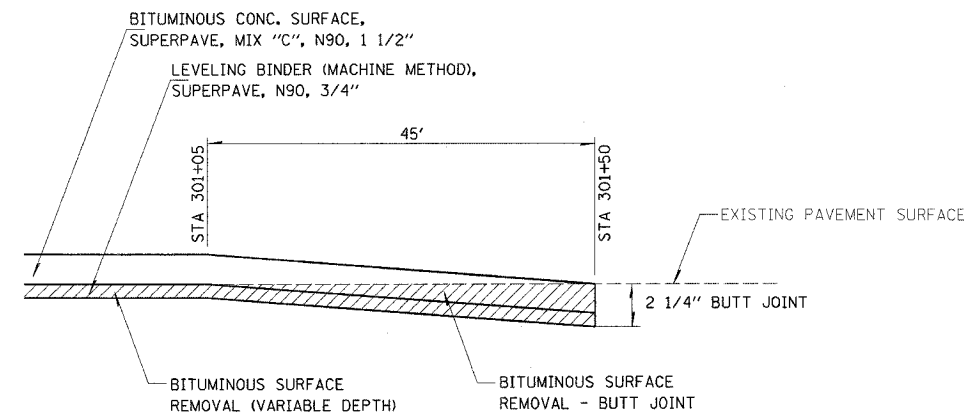

BUTT JOINT WEST END OF PROJECT

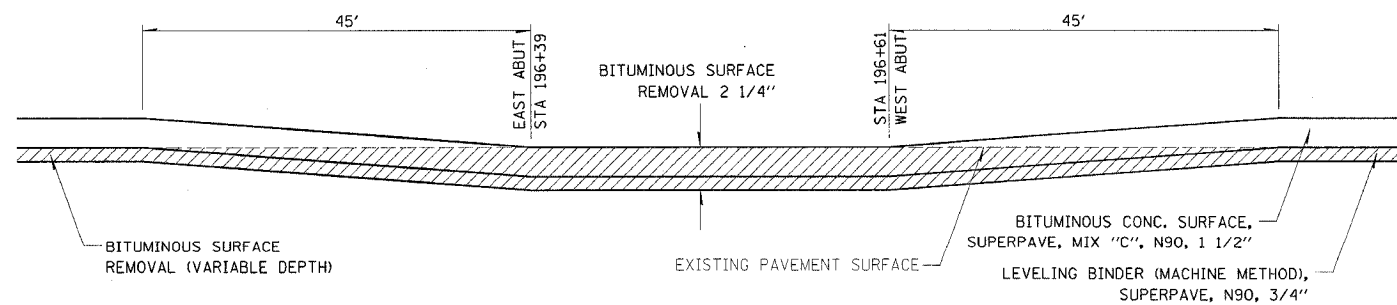
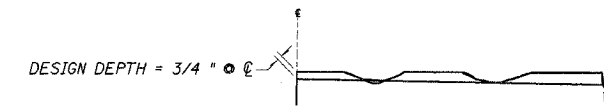

BEAR CREEK BRIDGE

NOTE: MILLING IS PAID FOR AS BITUMINOUS SURFACE REMOVAL (VARIABLE DEPTH) IN TRANSITION AREAS.

NOTES:

- MILLING SHALL BE DONE TO ATTAIN A 3/16" SLOPE IN CROWN SECTIONS
- EXISTING S.E. AND S.E. TRANSITIONS SHALL BE MAINTAINED UNLESS OTHERWISE SHOWN ON THE PLANS.
- MILLING TO THE BOTTOM OF WHEEL RUTS SHALL NOT BE NECESSARY UNLESS REQUIRED TO OBTAIN SLOPE OR THE DESIGN DEPTH AT CENTERLINE.
- THE AVERAGE DEPTH OF MILLING IS ESTIMATED TO BE 3/4" BUT MAY VARY IN ISOLATED LOCATIONS.

BITUMINOUS SURFACE REMOVAL (VARIABLE DEPTH) DETAIL

REVISIONS	
NAME	DATE

ILLINOIS DEPARTMENT OF TRANSPORTATION

MILLING DETAILS SHEET

SCALE: VERT. HORIZ. DATE

DRAWN BY CHECKED BY

PLOT DATE = 3/23/2006
PLOT NAME = 3/23/2006
PLOT SCALE = #SCALE#
USER NAME = district

F.A.P. RTE.	SECTION	COUNTY	TOTAL SHEETS	SHEET NO.
853	9RS-4	HAMILTON	12	6
STA.		TO STA.		
FED. ROAD DIST. NO.		ILLINOIS FED. AID PROJECT		

PAVING SCHEDULE

STATION TO STATION	LENGTH	EXISTING PAVEMENT WIDTH	AREA	BITUMINOUS MATERIALS (PRIME COAT)	AGGREGATE (PRIME COAT)	LEVEL BINDER (MACHINE METHOD), SUPERPAVE N90	BITUMINOUS CONCRETE SURFACE COURSE, SUPERPAVE MIXTURE "C", N90	BITUMINOUS SURFACE REMOVAL - BUTT JOINT	BITUMINOUS SURFACE REMOVAL (VARIABLE DEPTH)	BITUMINOUS SURFACE REMOVAL 2 1/4"	SHORT-TERM PAVEMENT MARKING	TEMPORARY PAVEMENT MARKING - LINE 4"	TEMPORARY PAVEMENT MARKING - LINE 24"	WORK ZONE PAVEMENT MARKING REMOVAL	PAINT PAVEMENT MARKING - LINE 4"	THERMOPLASTIC PAVEMENT MARKING - LINE 4"	THERMOPLASTIC PAVEMENT MARKING - LINE 24"	RAISED REFLECTIVE PAVEMENT MARKER	AGGREGATE SHOULDERS, TYPE B	TEMPORARY RAMP
STA 163+38 TO 164+20	82	30.5	277.9	28	0.6	12	23			278	25	20	16	3		20		1		47
STA 164+20 TO 166+98	278	27	834	83	1.7	35	70			834	83	70		9		70		4		
STA 166+98 TO 168+81	183	20.4	414.8	41	0.8	18	35			415	55	46		6		46		2		
STA 168+81 TO 169+71	90	18.8	188	19	0.4	16	16			188	27	23		3		23		1		
STA 169+71 TO 171+46	175	23.8	462.8	46	0.9	20	39			463	52	394		6		394		2		
STA 171+46 TO 171+75	29	23	74.1	7	0.2	3	6			74	9	65		1		65		0		
STA 171+75 TO 176+94	519	22	1268.7	127	2.5	53	107			1269	156	1168	24	17		1168	24	7		
STA 176+94 TO 180+15	321	30	1070	107	2.1	45	90			1070	96	722		11		722		4		
STA 180+15 TO 183+56	341	23.5	890.4	89	1.8	37	75			890	102	426		11		426		4		
STA 183+56 TO 184+01	45	25	125	13	0.3	5	10		125	13	101		2		101		1	1		
STA 184+01 TO 188+99.90	498.9	25	1385.8	139	2.8	58	116		1386	150	1079		17	486	593		6	20		
STA EQN 188+99.9BK = 189+00.1AH																				
STA 189+00.1 TO 196+50	749.9	25	2083.1	208	4.2	88	175		2053	30	225	1625		25	1625		9	33		
STA 196+50 TO 206+06.7	956.7	25	2657.5	266	5.3	112	223		2627	31	287	2152		32	2152		12	39		
STA EQN 206+06.7BK = 206+02.3AH																				
STA 206+02.3 TO 222+94.1	1691.8	25	4699.4	470	9.4	197	395		4699		508	5768		56	5768		21	57		
STA EQN 222+94.1BK = 223+80.9AH																				
STA 223+80.9 TO 256+11.2	3230.3	25	8973.1	897	18.0	377	754		8973		969	9876		108	9876		41	176		
STA EQN 256+11.2BK = 256+52.8AH																				
STA 256+52.8 TO 301+05	4452.2	25	12367	1237	24.7	519	1039		12367		1336	13376		148	13376		56	265		
STA 301+05 TO 301+50	45	25	125	13	0.3	5	11	125			14	180		2	180		1	3	35	
TOTAL	13687.8			3790	76	1584	3184	125	32230	5542	4107	37091	40	457	33463	3628	40	172	594	82

REVISIONS		ILLINOIS DEPARTMENT OF TRANSPORTATION	
NAME	DATE	<h1>SCHEDULES</h1>	
SCALE:	VERT. DATE	HORIZ.	DRAWN BY
			CHECKED BY

c:\projects\94909d\05203pa.dgn
 teasleyck/4/ DATE
 REBS

CONTRACT NO. 98980

F.A.P. RTE.	SECTION	COUNTY	TOTAL SHEETS	SHEET NO.
853	9RS-4	HAMILTON	12	7
STA.		TO STA.		
FED. ROAD DIST. NO.		ILLINOIS FED. AID PROJECT		

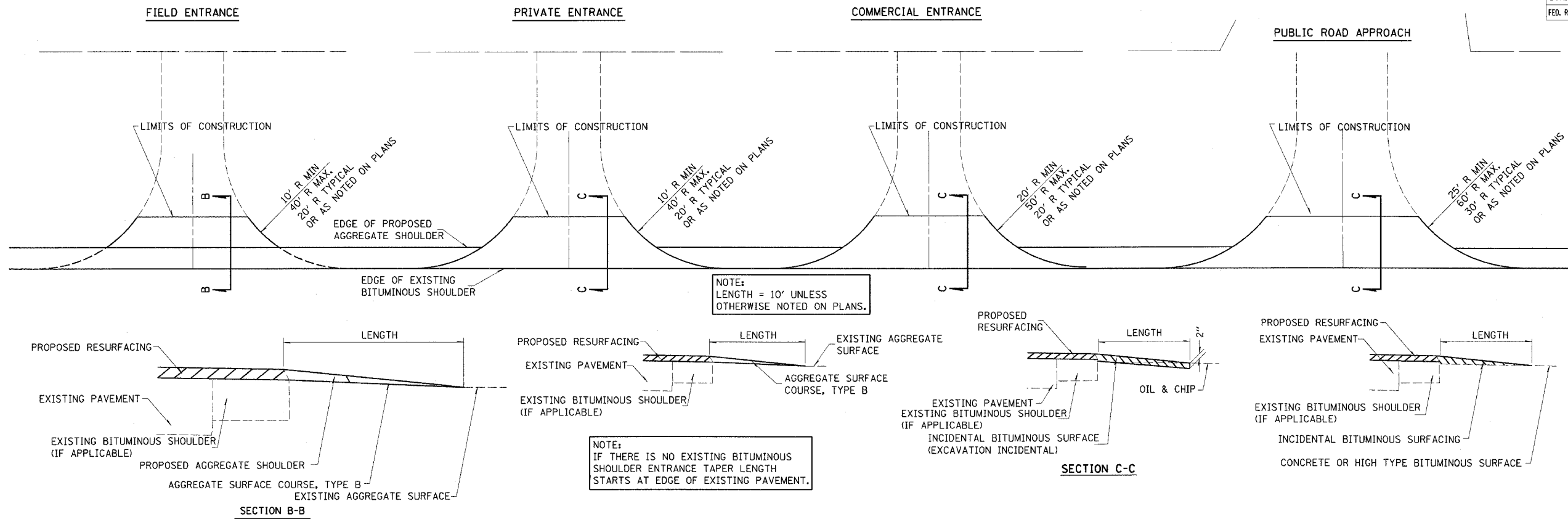

TYPICAL SECTION AT MAILBOX TURNOUT
 NOTE: SEE STANDARD 406201 FOR MAILBOX TURNOUT DETAILS

SIDE	STATION	TYPE	INCIDENTAL BITUMINOUS SURFACING*		AGGREGATE SURFACE COURSE, TYPE B
			TON	TON	
LT	180+30	CE	3.1		
LT	183+15	CE	2.2		
RT	183+76	PE		1.6	
LT	183+89	CE	2.2		
RT	184+40	MBT		4.7	
RT	184+89	PE	2.2		
RT	185+81	MBT		7.5	
RT	186+62	PRA	2.6		
LT	186+62	PE	2.4		
RT	187+89	PE	1.7		
LT	187+89	PE	1.6		
RT	188+69	MBT		2.5	
RT	189+90	PE	1.7		
RT	190+16	PE	1.6		
LT	189+06	PE	1.6		
RT	190+34	MBT		2.5	
RT	191+57	MBT		2.5	
RT	191+76	PE	1.7		
RT	192+66	MBT		2.5	
RT	192+83	PE	2.8		
LT	196+06	PRA	4.1		
LT	197+80	CE	10.6		
RT	199+04	CE	3.1		
RT	201+09	CE	3.0		
RT	201+87	CE	2.7		
RT	203+59	PE		1.3	
RT	205+69	CE	4.0		
RT	209+70	PRA	3.1		
RT	209+82	PE	1.8		
RT	210+35	PE	1.8		
LT	210+35	PE	1.8		
LT	212+06	CE	5.2		
RT	212+32	CE	4.7		
RT	213+15	PRA	2.3		
RT	214+78	CE	6.8		
RT	216+57	PRA	5.7		
LT	218+38	CE	4.5		
RT	219+57	PE	4.2		
LT	220+46	CE	4.2		
RT	220+62	PE	2.4		
RT	220+90	MBT		2.5	
RT	225+75	PRA	7.3		
LT	233+00	PE		1.2	
LT	233+05	MBT		2.5	
LT	234+49	PRA	3.5		
RT	234+68	PRA	3.1		
LT	235+10	PE		1.3	
RT	236+30	MBT		2.5	
RT	236+52	PE		1.4	
LT	236+84	PE		1.1	
RT	238+01	PE		1.4	
LT	239+44	PE		1.2	
RT	239+52	MBT		2.5	
RT	240+40	PE		1.8	
LT	242+26	PE	3.8		
LT	242+68	PE		1.5	
RT	243+05	MBT		2.5	
RT	243+38	PE		1.0	
RT	244+17	PE		2.8	
LT	245+00	PE	4.7		
RT	245+09	MBT		2.5	
LT	246+77	PE		1.5	
LT	247+23	PE		1.3	
LT	250+75	PE		2.9	
RT	250+87	MBT		2.5	
RT	250+98	PE		1.1	
LT	252+85	PE		1.0	
RT	263+50	PE		2.3	
LT	263+55	PRA	4.0		
LT	266+15	PE		0.9	
LT	266+69	PE		1.3	
RT	270+45	PRA	1.6		
LT	276+15	MBT		2.5	
LT	276+20	PE		1.4	
RT	278+09	PE		3.2	
LT	278+22	PE	1.4		
LT	279+00	PE	1.8		
RT	291+05	FE		1.2	
LT	291+24	PE		2.9	
LT	295+32	FE		1.6	
LT	299+50	MBT		2.5	
LT	299+70	PE	1.4		
LT	300+84	PE		2.1	
TOTALS			136	87	

FE - FIELD ENTRANCE PRA - PUBLIC ROAD APPROACH
 PE - PRIVATE ENTRANCE MBT - MAILBOX TURNOUT
 CE - COMMERCIAL ENTRANCE

*BITUMINOUS MATERIALS AND AGGREGATE (PRIME COAT) FOR ENTRANCES AND PUBLIC ROAD APPROACHES SHALL BE CONSIDERED INCIDENTAL TO INCIDENTAL BITUMINOUS SURFACING AS NOTED IN THE SPECIAL PROVISIONS

ISSUED: 08-03-99

PLT DATE = 8/25/2006
 PLOT SCALE = 1"=40'
 USER NAME = dstrut

F.A.P. RTE.	SECTION	COUNTY	TOTAL SHEETS	SHEET NO.
853	9RS-4	HAMILTON	12	8
STA.		TO STA.		
FED. ROAD DIST. NO.		ILLINOIS FED. AID PROJECT		

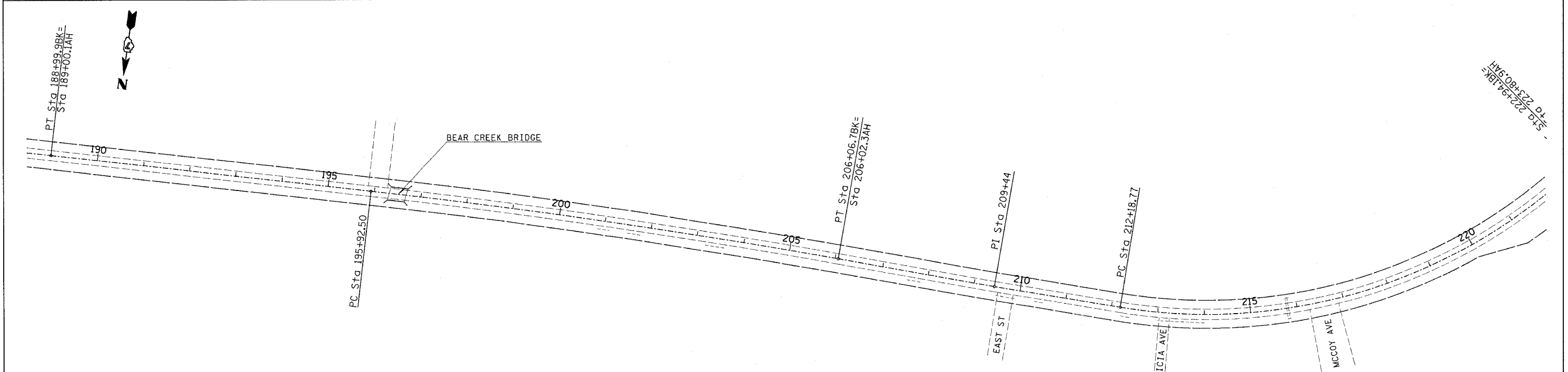
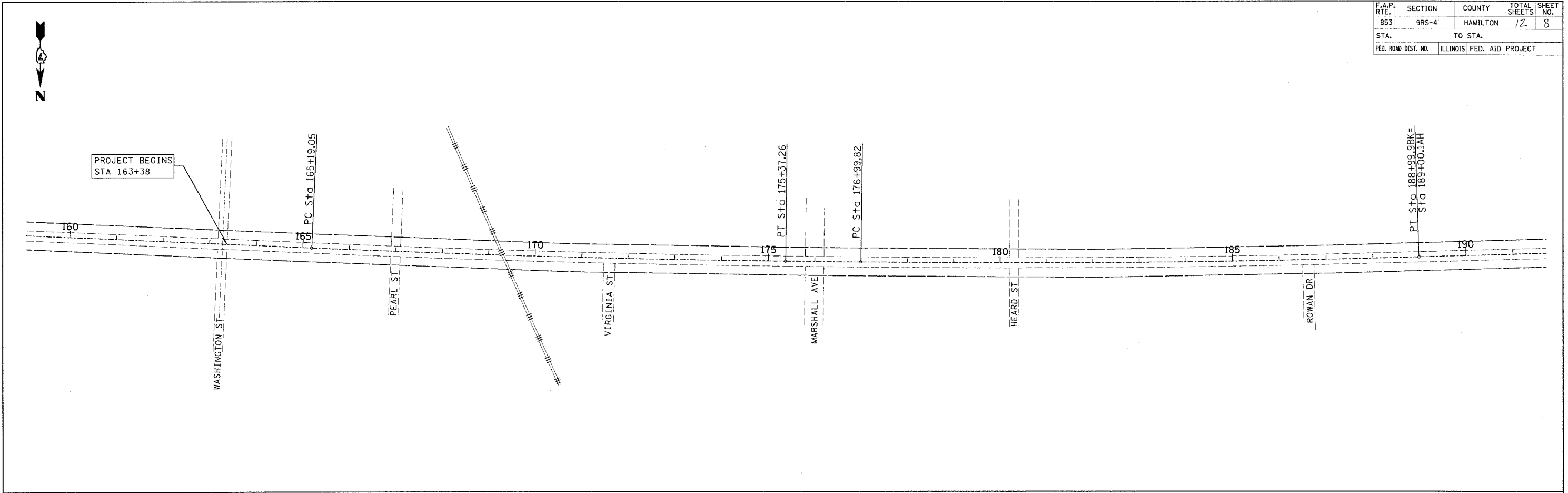

REVISIONS	
NAME	DATE

ILLINOIS DEPARTMENT OF TRANSPORTATION

STA 160+00 TO STA 220+00

SCALE: VERT. _____
HORIZ. _____

DATE _____ DRAWN BY _____
CHECKED BY _____

district
3/23/2006
c:\projects\949099\d05203pa.d

CONTRACT NO. 98980

F.A.P. RTE.	SECTION	COUNTY	TOTAL SHEETS	SHEET NO.
853	9RS-4	HAMILTON	12	9
STA.		TO STA.		
FED. ROAD DIST. NO.		ILLINOIS FED. AID PROJECT		

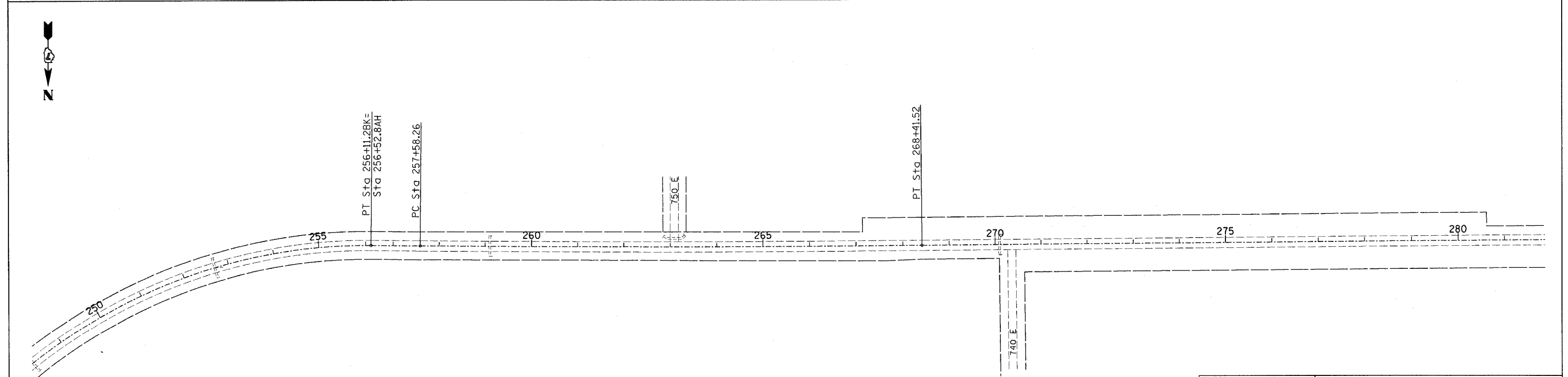
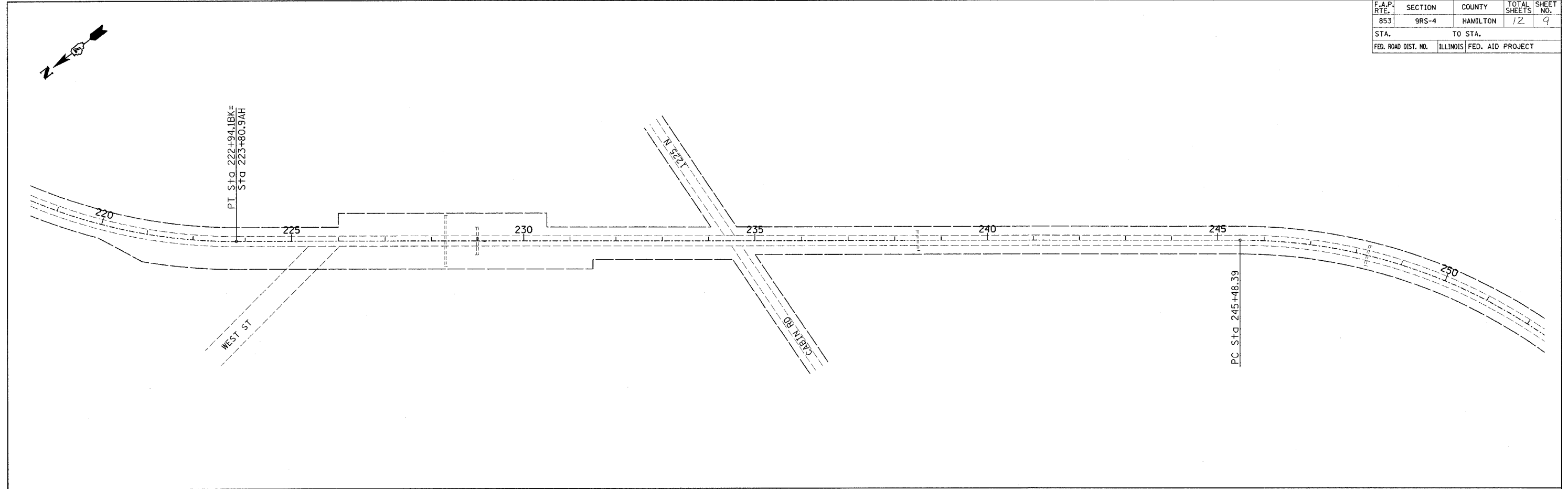

PLOT DATE = 3/23/2006
PLOT SCALE = 48SCALE\$
USER NAME = district

REVISIONS	
NAME	DATE

ILLINOIS DEPARTMENT OF TRANSPORTATION
STA 220+00 TO STA 280+00
SCALE: VERT.
DATE: HORIZ.
DRAWN BY
CHECKED BY

district
3/23/2006
c:\projects\94909d\05203pa.d



CONTRACT NO. 98980				
F.A.P. RTE.	SECTION	COUNTY	TOTAL SHEETS	SHEET NO.
853	9RS-4	HAMILTON	12	10
STA.		TO STA.		
FED. ROAD DIST. NO.	ILLINOIS	FED. AID PROJECT		

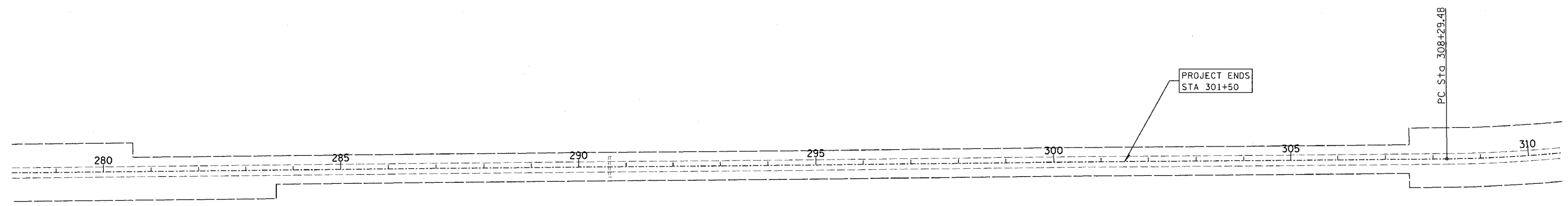

PLOT DATE = 3/23/2006
FILE NAME = #FILE#
PLOT NAME = #PLOT#
USER NAME = #USER#

REVISIONS	
NAME	DATE

ILLINOIS DEPARTMENT OF TRANSPORTATION

STA 280+00 TO STA 310+00

SCALE: VERT. _____
HORIZ. _____

DATE _____

DRAWN BY _____
CHECKED BY _____

district
 3/23/2006
 c:\projects\94909d\05203pa.d
 EPMD

1 2 3 4 5 6 7 8 9
 10 11 12 13 14 15 16 17 18
 19 20 21 22 23 24 25 26 27
 28 29 30 31 32 33 34 35
 36 37 38 39 40 41 42 43 44
 45 46 47 48 49 50 51 52 53 54
 55 56 57 58 59 60 61 62 63

CONTRACT NO. 98980

F.A.P. RTE.	SECTION	COUNTY	TOTAL SHEETS	SHEET NO.
853	9RS-4	HAMILTON	12	11
STA.		TO STA.		
FED. ROAD DIST. NO.		ILLINOIS	FED. AID PROJECT	

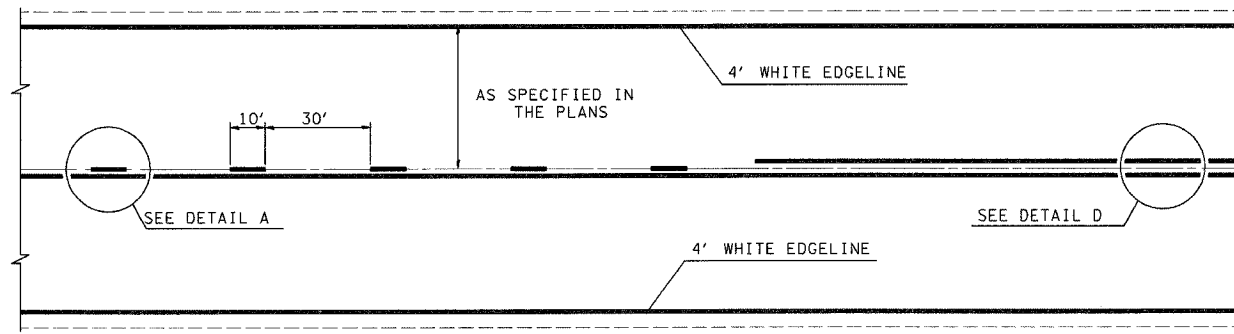

TYPICAL CENTERLINE, NO PASSING ZONE LINE (NPZ) & EDGELINE MARKINGS
 2-LANE PAVEMENT

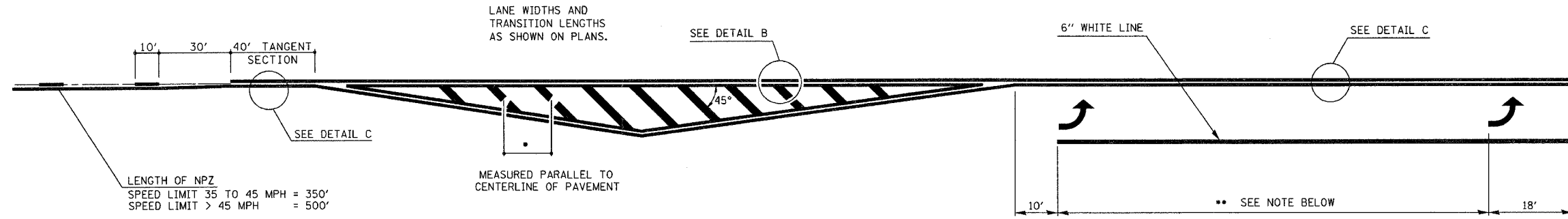

LENGTH OF NPZ
 SPEED LIMIT 35 TO 45 MPH = 350'
 SPEED LIMIT > 45 MPH = 500'

*DIAGONAL SPACING

SPEED LIMIT	< 30 MPH	= 15'
SPEED LIMIT	30 TO 45 MPH	= 20'
SPEED LIMIT	> 45 MPH	= 30'

** PLACE THE FIRST ARROW EVEN WITH THE BEGINNING OF THE TURN BAY.
 PLACE ANOTHER ARROW 18' BACK FROM THE STOP BAR. IF REQUIRED,
 ADD ADDITIONAL ARROWS TO MAINTAIN A MAXIMUM OF 80' SPACING.

- NOTES:
1. OMIT EDGELINE THRU SIDE ROADS.
 2. TAPER RATES, LANE WIDTHS, AND STORAGE LENGTHS AS SHOWN ON THE PLANS.
 3. WHEN MEDIANS ARE PRESENT, PLACE A SINGLE YELLOW STRIPE AROUND ITS PERIMETER.

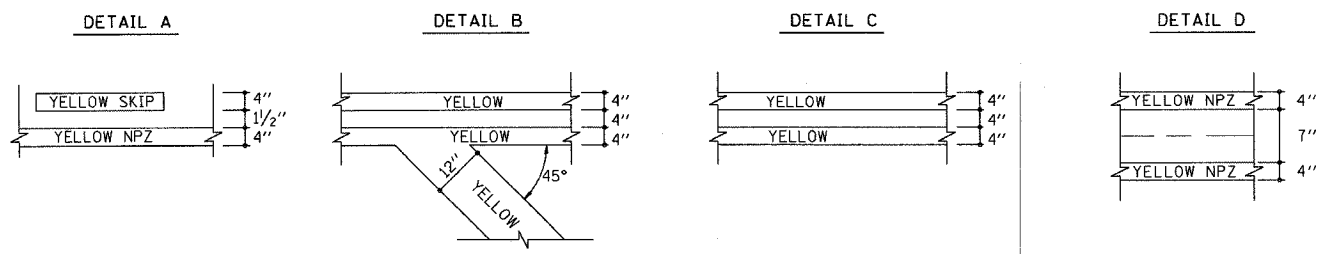

NOT TO SCALE

REVISIONS	
NAME	DATE
MMO	12-99
DRM	08-04

ILLINOIS DEPARTMENT OF TRANSPORTATION
TYPICAL APPLICATION OF PAVEMENT MARKINGS
SHEET 1 OF 2

SCALE: VERT. _____
 HORIZ. _____
 DATE _____
 DRAWN BY _____
 CHECKED BY _____

PLOT DATE = 3/23/2006
 FILE NAME = #FILE#
 USER NAME = #USER#

district
3/23/2006
c:\projects\949099\d05203pa.d
EPMD1

1 2 3 4 5 6 7 8 9
10 11 12 13 14 15 16 17 18
19 20 21 22 23 24 25 26 27
28 29 30 31 32 33 34 35
36 37 38 39 40 41 42 43 44 45
46 47 48 49 50 51 52 53 54
55 56 57 58 59 60 61 62 63

CONTRACT NO. 98980

F.A.P. RTE.	SECTION	COUNTY	TOTAL SHEETS	SHEET NO.
853	9RS-4	HAMILTON	12	12
STA.		TO STA.		
FED. ROAD DIST. NO.	ILLINOIS	FED. AID PROJECT		

** PLACE THE FIRST ARROW EVEN WITH THE BEGINNING OF THE TURN BAY.
PLACE ANOTHER ARROW 18' BACK FROM THE STOP BAR. IF REQUIRED,
ADD ADDITIONAL ARROWS TO MAINTAIN A MAXIMUM OF 80' SPACING.

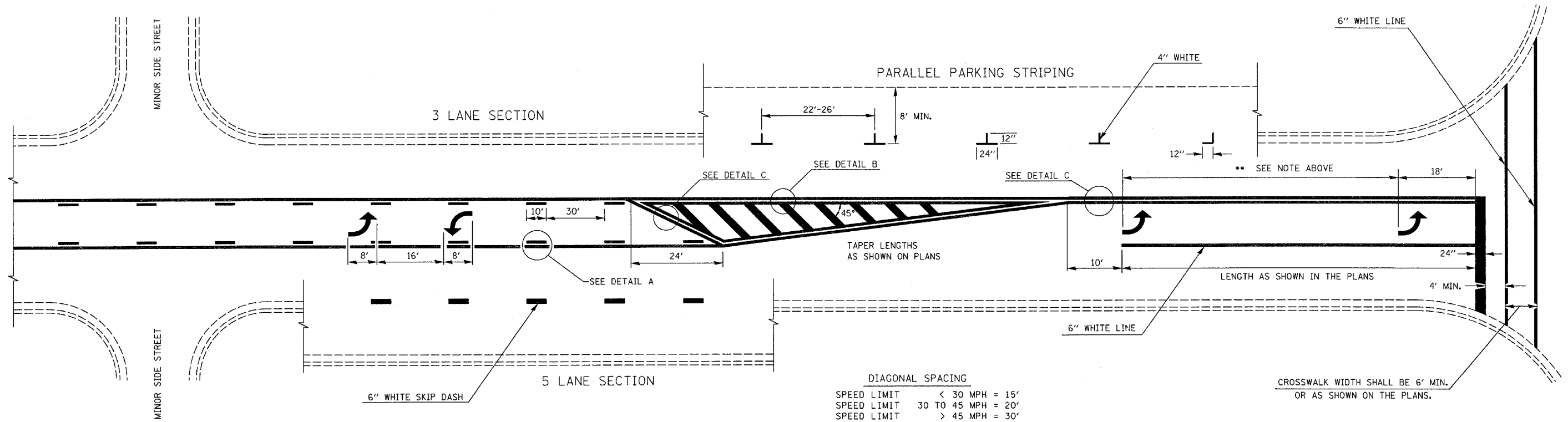

DIAGONAL SPACING

SPEED LIMIT	< 30 MPH	= 15'
SPEED LIMIT	30 TO 45 MPH	= 20'
SPEED LIMIT	> 45 MPH	= 30'

CROSSWALK WIDTH SHALL BE 6' MIN.
OR AS SHOWN ON THE PLANS.

TYPICAL BI-DIRECTIONAL TURN LANE MARKINGS
(SHOWING TRANSITION TO EXCLUSIVE LEFT TURN LANE)

- NOTES:
- NO LESS THAN 2 ARROWS SHALL BE USED.
 - TAPER RATES, LANE WIDTHS, AND STORAGE LENGTHS AS SHOWN ON THE PLANS.
 - AVOID PLACING BI-DIRECTIONAL ARROWS IN INTERSECTIONS.
 - BI-DIRECTIONAL ARROWS SHALL BE SPACED A MAXIMUM OF 250'.

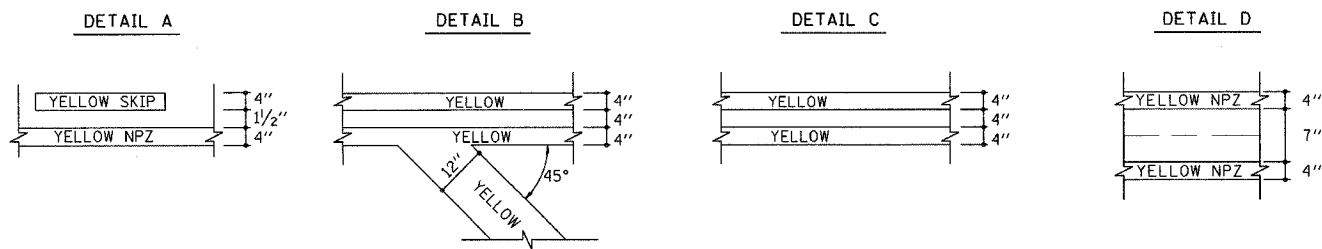

NOT TO SCALE

REVISIONS	
NAME	DATE
MMO	12-99
DRM	08-04

ILLINOIS DEPARTMENT OF TRANSPORTATION
TYPICAL APPLICATION OF PAVEMENT MARKINGS
SHEET 2 OF 2

SCALE: VERT. HORIZ.
DATE
DRAWN BY
CHECKED BY

PLOT DATE = 3/22/2006
PLOT SCALE = 1/8"=1'-0"
USER NAME = district