

C:\SSCI\JOBS\0556 Old Metro Rd\ssci-Old Metro Rd\DRAWING\PLANPROFILE08.dwg, 1/26/2006 1:54:43 PM

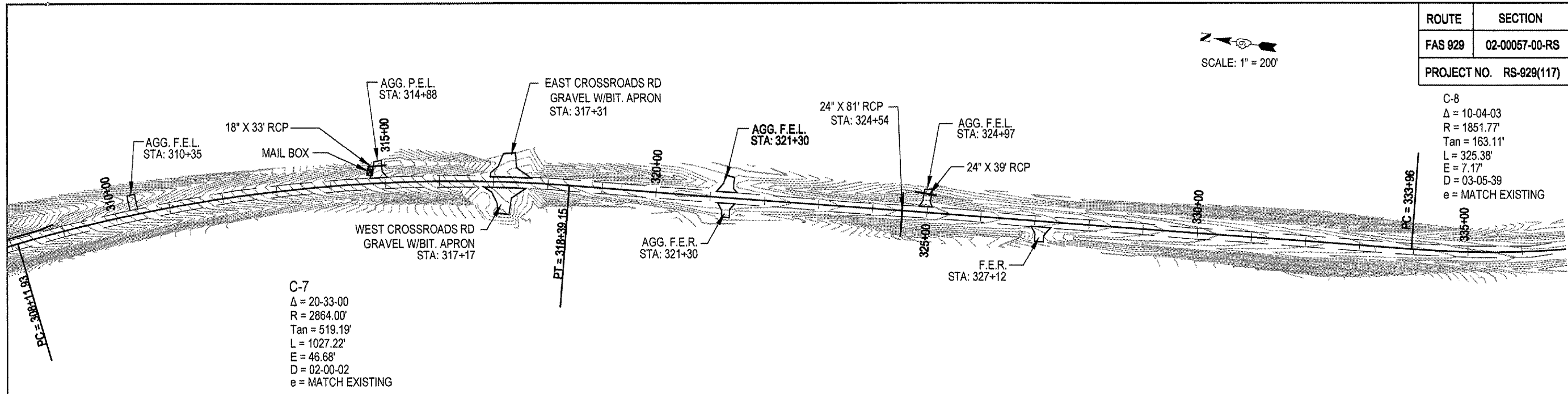

SCALE: 1" = 200'

ROUTE	SECTION	COUNTY	TOTAL SHEETS	SHEET NO.
FAS 929	02-00057-00-RS	JOHNSON	51	11
PROJECT NO. RS-929(117)		CONTRACT NO. 99253		

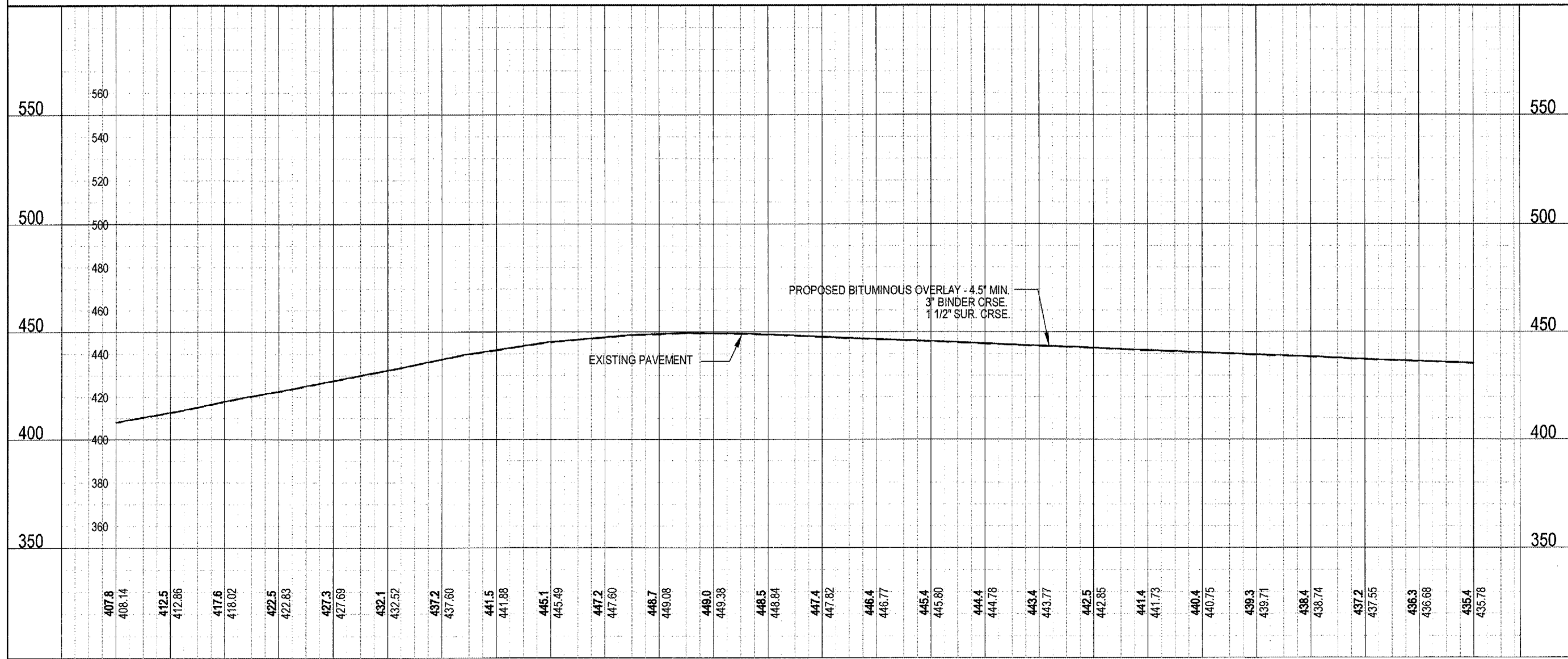

310+00	311+00	312+00	313+00	314+00	315+00	316+00	317+00	318+00	319+00	320+00	321+00	322+00	323+00	324+00	325+00	326+00	327+00	328+00	329+00	330+00	331+00	332+00	333+00	334+00	335+00																										
407.8	408.14	412.5	412.86	417.6	418.02	422.5	422.83	427.3	427.69	432.1	432.52	437.2	437.60	441.5	441.88	445.1	445.49	447.2	447.60	448.7	449.08	449.0	449.38	448.5	448.84	447.4	447.82	446.4	446.77	445.4	445.80	444.4	444.78	443.4	443.77	442.5	442.85	441.4	441.73	440.4	440.75	439.3	439.71	438.4	438.74	437.2	437.55	436.3	436.68	435.4	435.78

SIGNATURE
 11/30/07
 LIC. EXP. DATE

SHAWNEE SURVEY & CONSULTING, INC

PHONE: (616) 658-6065 FAX: (616) 658-9190

P.O. BOX 125
 104 S. FOURTH STREET
 VIENNA, IL 62995

PLSF NO.: 048-000151 PDF NO.: 104-02344

JOHNSON COUNTY HIGHWAY DEPARTMENT

P.O. BOX 247
 VIENNA, IL 62995

OLD METROPOLIS ROAD RESURFACING PROJECT

FAS ROUTE 929, CH5
 SECTION 02-00057-00-RS

FUNDING OR PROJECT NUMBER

DRAWING INFORMATION	
DRAWN BY: DDP	<input checked="" type="checkbox"/> PRELIMINARY
DATE: 1-10-06	<input type="checkbox"/> BID / CONSTRUCTION
CHECKED BY: MLS	<input type="checkbox"/> FINAL / RECORDED
SCALE: 1" = 200'	
JOB NO.: 2002-052	
DRAWING REVISIONS	
REV.	DATE
1	01/23/02
2	08/12/02
3	12/13/04
	1/14/05
SHEET NUMBER	
11	
PLAN/PROFILE SHEET	