

RELOCATED LOCALIZER SITE

AU062 PATH: K:\0428504\DRAW\SHEETS

FILE: localizer-9.DWG  
UPDATE BY: .  
SURVEY BOOK #  
XREF DWG:  
XREF DWG:  
DATE: .

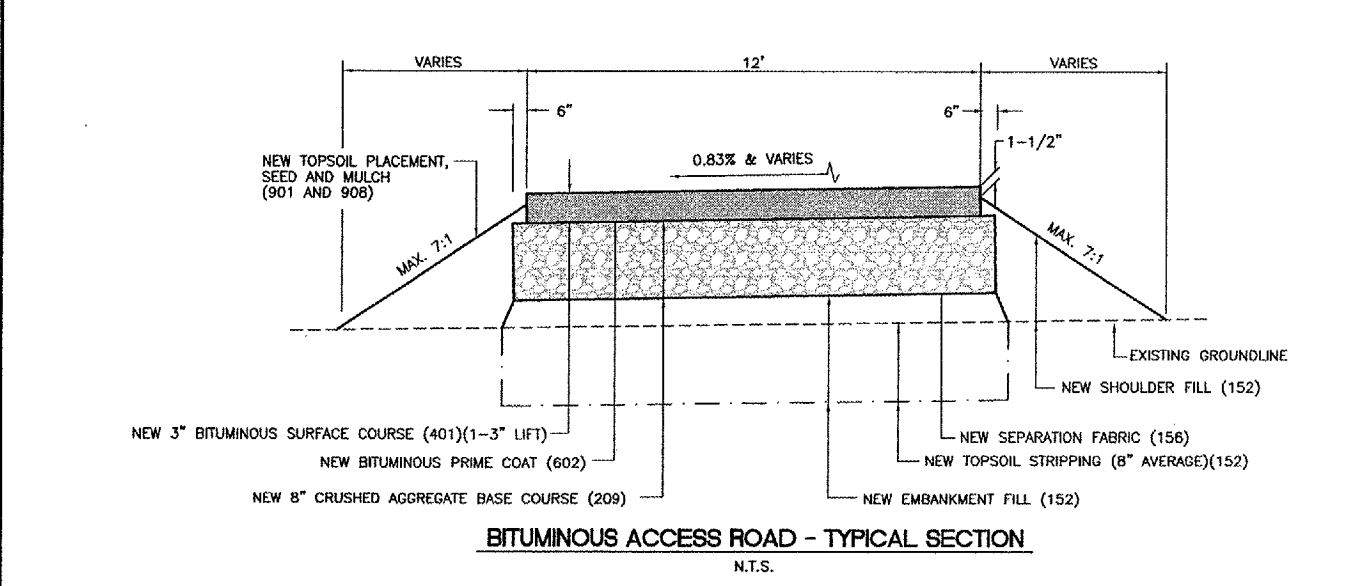
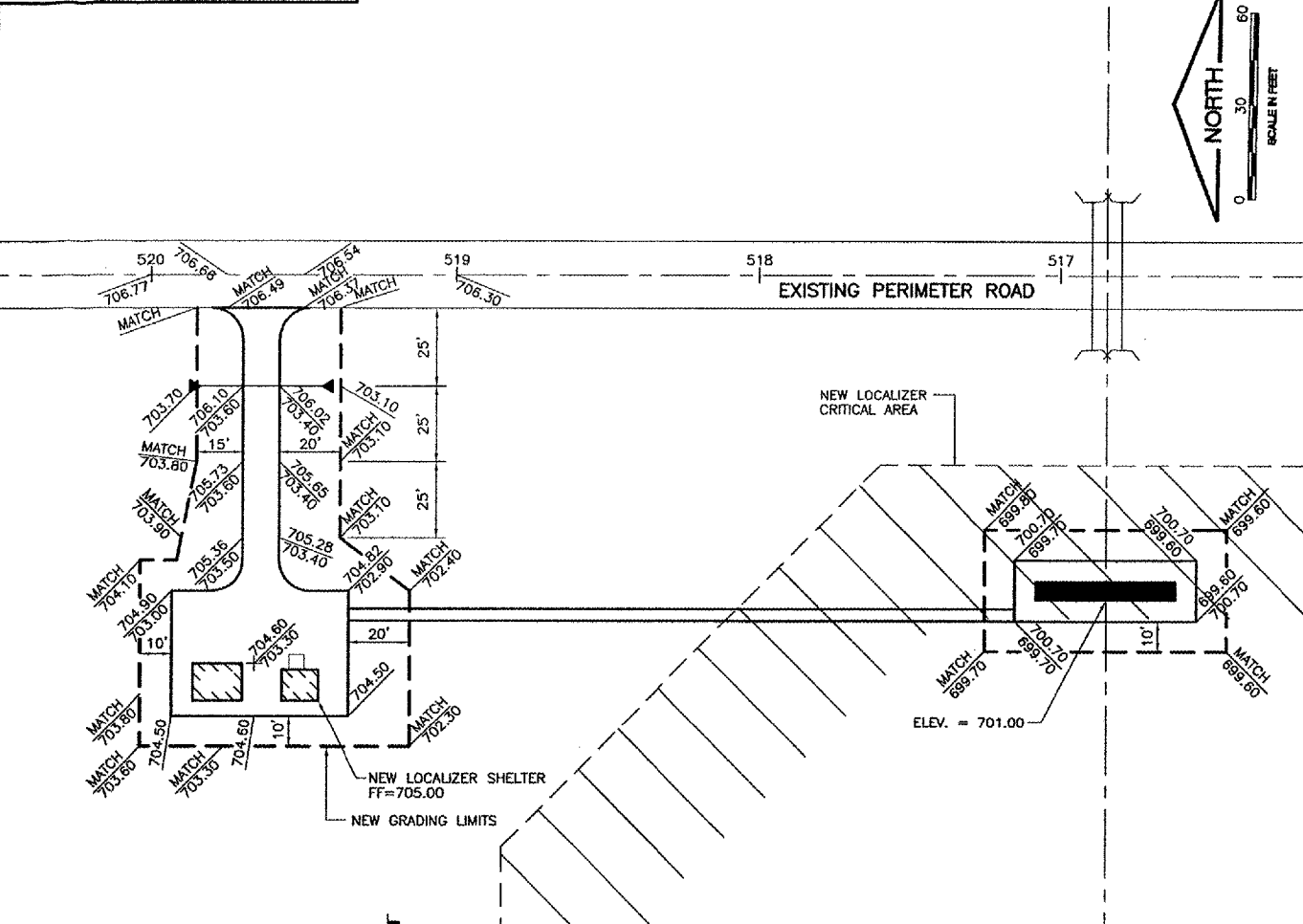

BITUMINOUS ACCESS ROAD - TYPICAL SECTION  
N.T.S.

LEGEND

- NEW GRADING LIMITS
- - - - EXISTING CONTOUR
- 700.70 PROPOSED ELEVATION (700.70)
- 699.70 EXISTING ELEVATION (699.70)

REVISIONS

| NUMBER | BY | DATE |
|--------|----|------|
|        |    |      |
|        |    |      |
|        |    |      |

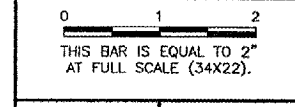

THIS BAR IS EQUAL TO 2" AT FULL SCALE (34X22).

EXISTING LOCALIZER SITE

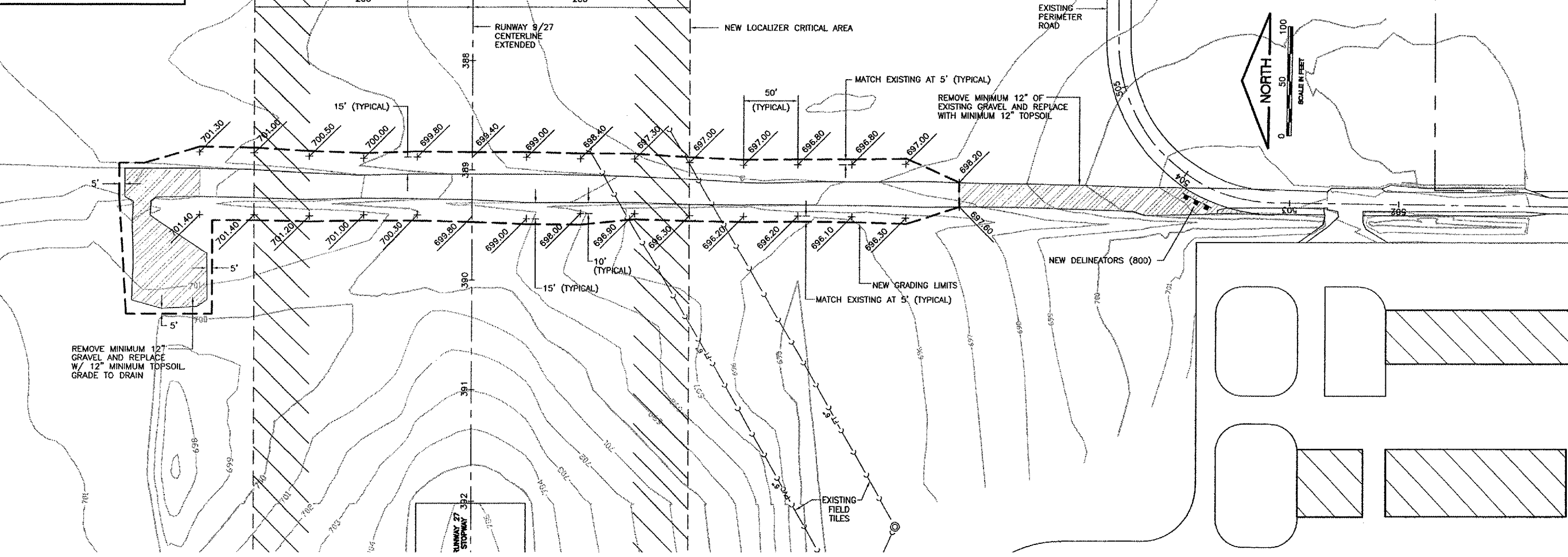

AURORA MUNICIPAL AIRPORT  
AURORA, ILLINOIS  
CONSTRUCT RUNWAY 33 ILS,  
RELOCATE RUNWAY 9 LOCALIZER  
  
RUNWAY 9 LOCALIZER  
GRADING PLAN/TYPICAL SECTION

© Copyright CMT, Inc.

**CMT**  
CRAWFORD MURPHY & TILLY, INC.  
CONSULTING ENGINEERS  
License No. BA-000693

DESIGN BY: CAL  
DRAWN BY: JRO  
CHECKED BY: CAL  
APPROVED BY:  
DATE: 05/12/06  
JOB No: 04285-04  
ILLINOIS PROJECT: ARR-3468  
A.I.P. PROJECT: 3-17-0003-B31  
**FINAL SUBMITTAL**  
SHEET 20 OF 67 SHEETS