

THE LOCATION, SIZE AND TYPE OF MATERIAL OF EXISTING UNDERGROUND UTILITIES INDICATED ON THE PLANS IS NOT REPRESENTED AS BEING ACCURATE, SUFFICIENT OR COMPLETE. IT SHALL BE THE CONTRACTOR'S RESPONSIBILITY TO DETERMINE THE ACTUAL LOCATION OF ALL SUCH FACILITIES, INCLUDING SERVICE CONNECTIONS TO UNDERGROUND UTILITIES. PRIOR TO CONSTRUCTION, THE CONTRACTOR SHALL NOTIFY THE UTILITY COMPANIES OF HIS OPERATIONAL PLANS AND SHALL OBTAIN FROM THE RESPECTIVE UTILITY COMPANIES DETAILED INFORMATION AND ASSISTANCE RELATIVE TO THE LOCATION OF THEIR FACILITIES AND THE WORKING SCHEDULE OF THE COMPANIES FOR REMOVAL OR ADJUSTMENT WHERE REQUIRED. IN THE EVENT AN UNEXPECTED UTILITY INTERFERENCE IS ENCOUNTERED DURING CONSTRUCTION, THE CONTRACTOR SHALL IMMEDIATELY NOTIFY THE UTILITY COMPANY OF JURISDICTION. THE ENGINEER SHALL ALSO BE IMMEDIATELY NOTIFIED. ANY SUCH MAINS AND SERVICES SHALL BE RESTORED TO SERVICE AT ONCE AND PAID FOR BY THE CONTRACTOR AT NO ADDITIONAL COST TO THE CONTRACT.

CALL J.U.L.I.E. FOR UTILITY INFORMATION AT 1-800-892-0123.

- LEGEND**
- EXISTING PAVEMENT
 - EXISTING BUILDINGS
 - PROPOSED IMPROVEMENTS
 - EXISTING ELECTRICAL CABLES
 - EXISTING ELECTRICAL DUCT
 - EXISTING GAS LINE
 - EXISTING WATER LINE
 - EXISTING FENCE
 - EXISTING TELEPHONE LINE
 - EXISTING UNDERDRAIN
 - EXISTING SANITARY SEWER
 - EXISTING ELECTRIC UTILITY LINE
 - EXISTING ELECTRICAL TRANSFORMER
 - EXISTING ELECTRICAL PEDESTAL
 - EXISTING DUCT MARKERS
 - EXISTING CABLE MARKERS
 - EXISTING ROTATING BEACON
 - EXISTING ELECTRICAL HANDHOLE
 - EXISTING STAKE MOUNTED TAXIWAY LIGHT
 - EXISTING BASE MOUNTED TAXIWAY LIGHT
 - EXISTING WIND CONE
 - EXISTING WIND TEE
 - EXISTING INLET

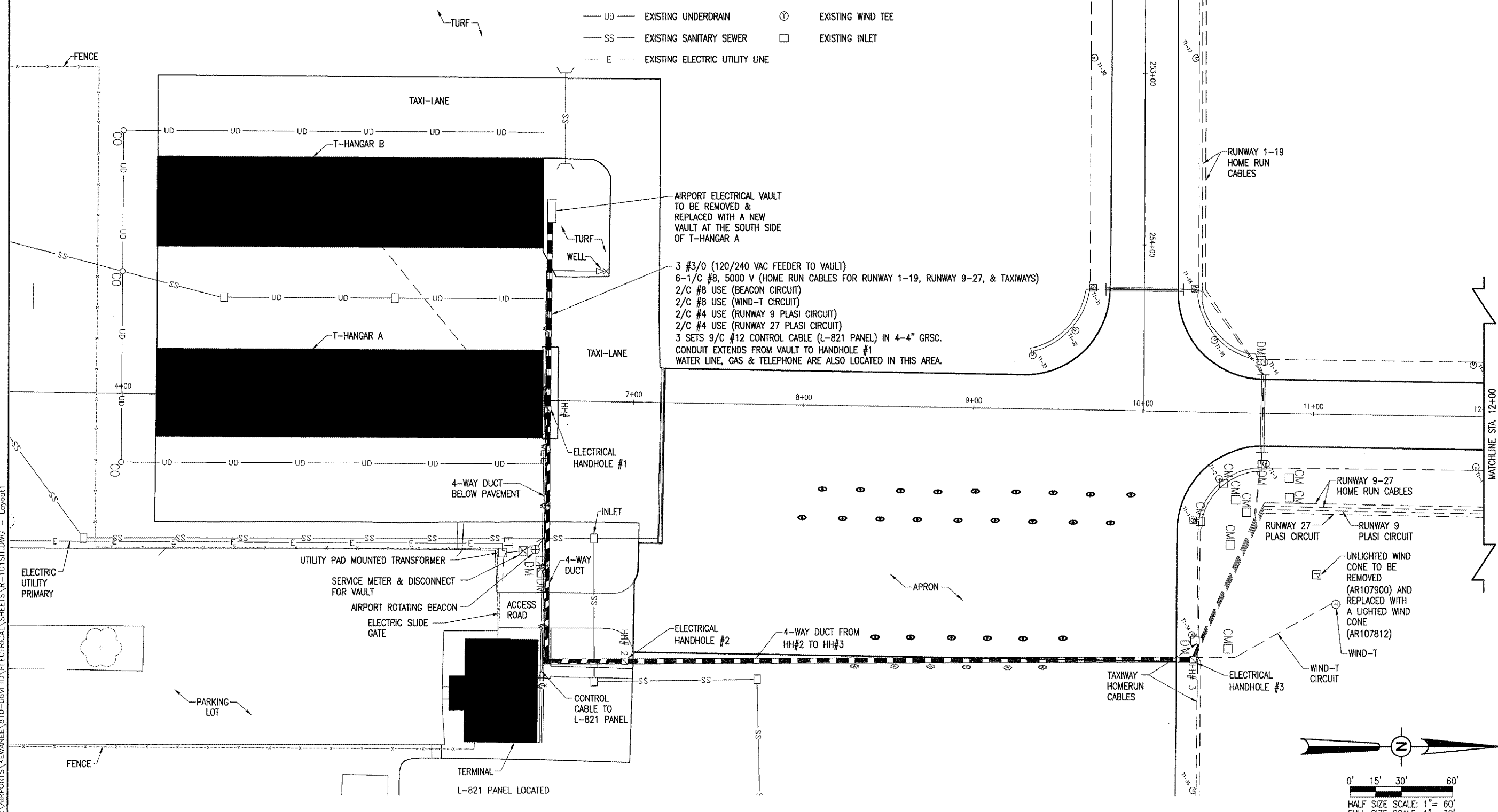

AIRPORT ELECTRICAL VAULT TO BE REMOVED & REPLACED WITH A NEW VAULT AT THE SOUTH SIDE OF T-HANGAR A

3 #3/0 (120/240 VAC FEEDER TO VAULT)
 6-1/C #8, 5000 V (HOME RUN CABLES FOR RUNWAY 1-19, RUNWAY 9-27, & TAXIWAYS)
 2/C #8 USE (BEACON CIRCUIT)
 2/C #8 USE (WIND-T CIRCUIT)
 2/C #4 USE (RUNWAY 9 PLASI CIRCUIT)
 2/C #4 USE (RUNWAY 27 PLASI CIRCUIT)
 3 SETS 9/C #12 CONTROL CABLE (L-821 PANEL) IN 4-4" GRSC.
 CONDUIT EXTENDS FROM VAULT TO HANDHOLE #1
 WATER LINE, GAS & TELEPHONE ARE ALSO LOCATED IN THIS AREA.

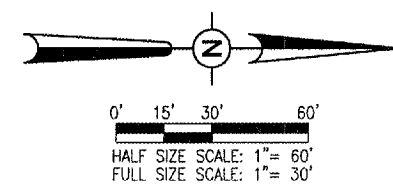

DATE	REVISION	BY

Kewanee Municipal Airport
 Kewanee, Henry County, Illinois
 I.L. PROJ.: EZI-3586 A.I.P. PROJ.: 3-17-0058-B12

U.S. Project No. 810-0641D	DATE 04/28/06
Revision R-10151.DWG	DATE 08/15/05
Scale 1"=30'	DATE 06/15/05
LAYOUT	DATE 01/17/06
DRAWN	DATE 08/15/05
REVIEWED	DATE 01/17/06

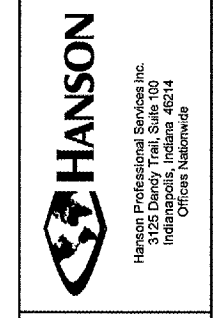

CONSTRUCT VAULT
 EXISTING VAULT
 SITE PLAN