



HANSON PROFESSIONAL SERVICES INC.

815 Commerce Drive, Suite 200
Oak Brook, Illinois 60523
Telephone: 630.990.3800
Fax: 630.990.3801



JOLIET REGIONAL PORT DISTRICT

1 Hangar Road
Romeoville, Illinois 60446
Telephone: 815.838.9497
Fax: 815.838.9524

**CONSTRUCT RUNWAY 2-20
DRAINAGE CULVERTS AND
IMPROVEMENTS**

**AIP PROJECT NO. 3-17-0140-B40
IDA PROJECT NO. LOT-3596**

STORM WATER POLLUTION PREVENTION NOTES

GENERAL

THE CONTRACTOR SHALL IMPLEMENT ALL PROVISIONS OF THE CONTRACT DOCUMENTS TO ASSURE THAT STORM WATER POLLUTION PREVENTION ITEMS ARE CONSTRUCTED AND MAINTAINED IN A TIMELY MANNER. SEDIMENT MUST NOT BE TRANSPORTED OFF THE CONSTRUCTION SITE. PERMANENT DRAINAGE FEATURES AND VEGETATIVE MEASURES SHALL BE PROVIDED AS SOON AS POSSIBLE.

THE MAINTENANCE OF ALL STORM WATER POLLUTION PREVENTION MEASURES IS INCIDENTAL TO THE ASSOCIATED ITEM.

POLLUTION PREVENTION MEASURES

THE CONTRACTOR SHALL BE REQUIRED TO IMPLEMENT AND MAINTAIN STORM WATER POLLUTION PREVENTION PRACTICES AND MEASURES PRIOR TO THE STRIPPING OF EXISTING VEGETATION WHERE EVER POSSIBLE AND AS SOON AS CONSTRUCTION PERMITS IN OTHER AREAS. POLLUTION CONTROL MEASURES SHALL BE IN ACCORDANCE WITH THE CONTRACT DOCUMENTS, INCLUDING THESE CONSTRUCTION PLANS, AND WITH STANDARDS AND SPECIFICATIONS FOR SOIL EROSION AND SEDIMENT CONTROL, ILLINOIS ENVIRONMENTAL PROTECTION AGENCY, CURRENT ISSUE. THE CONTRACTOR SHALL ADJUST HIS OPERATIONS AND IMPLEMENT POLLUTION CONTROL MEASURES SO THAT NO RUNOFF FROM STRIPPED AREAS WILL LEAVE THE CONSTRUCTION SITE OTHER THAN THROUGH SEDIMENT TRAPS OR OTHER SUITABLE CONTROL MEASURES.

POLLUTION CONTROL ITEMS SHALL BE PROVIDED AS NOTED ON THE STORM WATER POLLUTION PREVENTION PLAN AND IN THE STORM WATER POLLUTION PREVENTION DETAILS AND AS DIRECTED BY THE ENGINEER. THE LIMITS OF SUCH MEASURES SHALL BE STAKED BY THE CONTRACTOR PRIOR TO THE COMMENCEMENT OF CONSTRUCTION. SUCH LIMITS MAY BE ADJUSTED BY THE ENGINEER TO ACCOUNT FOR ACTUAL SITE CONDITIONS EXPERIENCED DURING CONSTRUCTION. ADDITIONAL COMPENSATION FOR MEASURES EXCEEDING THE PLAN QUANTITIES WILL BE PAID FOR AT THE CONTRACT UNIT PRICE FOR EACH ITEM.



THE CONTRACTOR IS TO MAINTAIN AND ADJUST, REPAIR OR REPLACE ALL POLLUTION PREVENTION MEASURES AS REQUIRED OR AS DIRECTED BY THE ENGINEER UNTIL PERMANENT VEGETATION HAS BEEN ESTABLISHED. MAINTENANCE OF POLLUTION CONTROL MEASURES IS TO BE PROVIDED AT NO ADDITIONAL COST TO THE CONTRACT.

ADDITIONAL STORMWATER POLLUTION PREVENTION MEASURES ARE EXISTING ON SITE LOCATED AT DRAINAGE FACILITIES AND ALONG THE PROPERTY LINE.

LANDSCAPING NOTES

1. OUTER LIMITS OF TOPSOILING, SEEDING AND MULCHING TO FOLLOW THE LIMITS SHOWN ON THIS SHEET. ADDITIONAL INFORMATION ON THE EARTHWORK LIMITS CAN BE FOUND ON THE CROSS SECTIONS AND STAKING PLAN.
2. ALL UTILITY TRENCHES TO BE SEEDED AND MULCHED OUTSIDE OF PAVEMENT AREAS, COST INCIDENTAL TO ASSOCIATED UTILITY ITEM.
3. AREAS SHOWN TO BE SEEDED WITH CONSERVATION COVER ARE NOT TO BE TOPSOILED OR MULCHED.

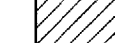
LEGEND

-  CONSERVATION COVER, ITEM AR800937 (34.7 ACRES)
-  PROPOSED SILT FENCE, ITEM AR156510 (3627 L.F.)
-  LIMITS OF CONSERVATION COVER AND SEEDING

No.	Drawing Issue	Description	Date	By

Date
MAY 5, 2006
Sheet Title

**LANDSCAPING AND
STORMWATER POLLUTION
PREVENTION PLAN**

840-05C8046
Project Number
LDH 10/06/05
Layout By Date
LDH 10/06/05
Designed By Date
CRC 05/05/06
Reviewed By Date
LDH
Drawn By Sheet No.

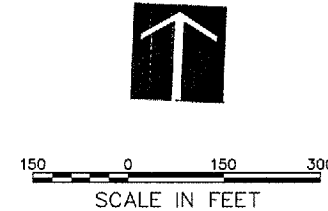
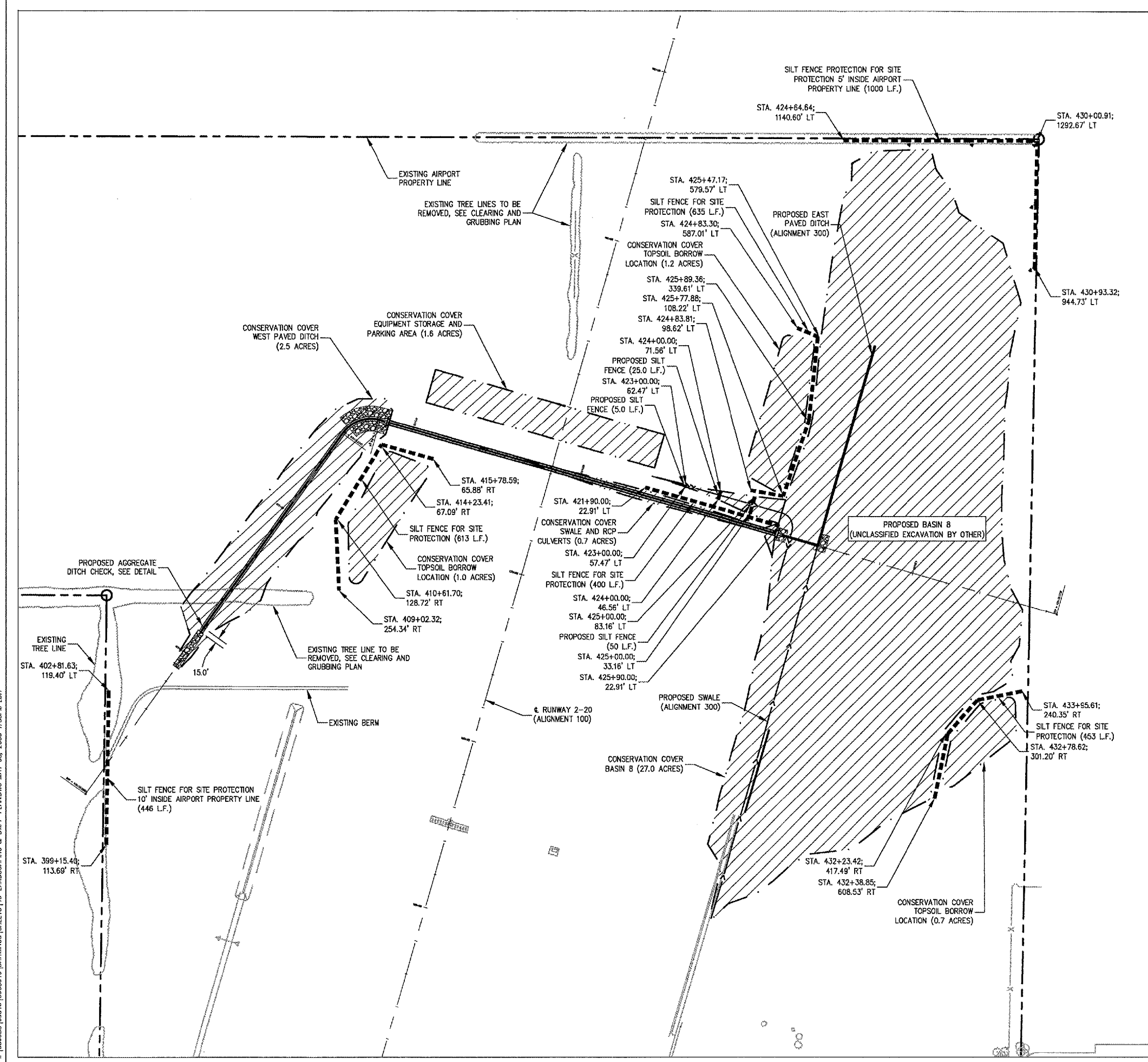

A: [05/05/06] [00840] [02C8046] [04P] [LANDSCAPING & SWPP PLAN] [MAY 05, 2006 1:35PM LDH]