

THE LOCATION OF UNDERGROUND UTILITIES AS INDICATED ON THE PLANS HAS BEEN OBTAINED FROM EXISTING RECORDS. NEITHER THE OWNER NOR THE ENGINEER ASSUMES ANY RESPONSIBILITY WHATSOEVER, IN RESPECT TO THE ACCURACY OR SUFFICIENCY OF THE INFORMATION AND THERE IS NO GUARANTEE, EITHER EXPRESSED OR IMPLIED, THAT THE CONDITIONS ARE REPRESENTATIVE OF THOSE TO BE ENCOUNTERED DURING CONSTRUCTION.

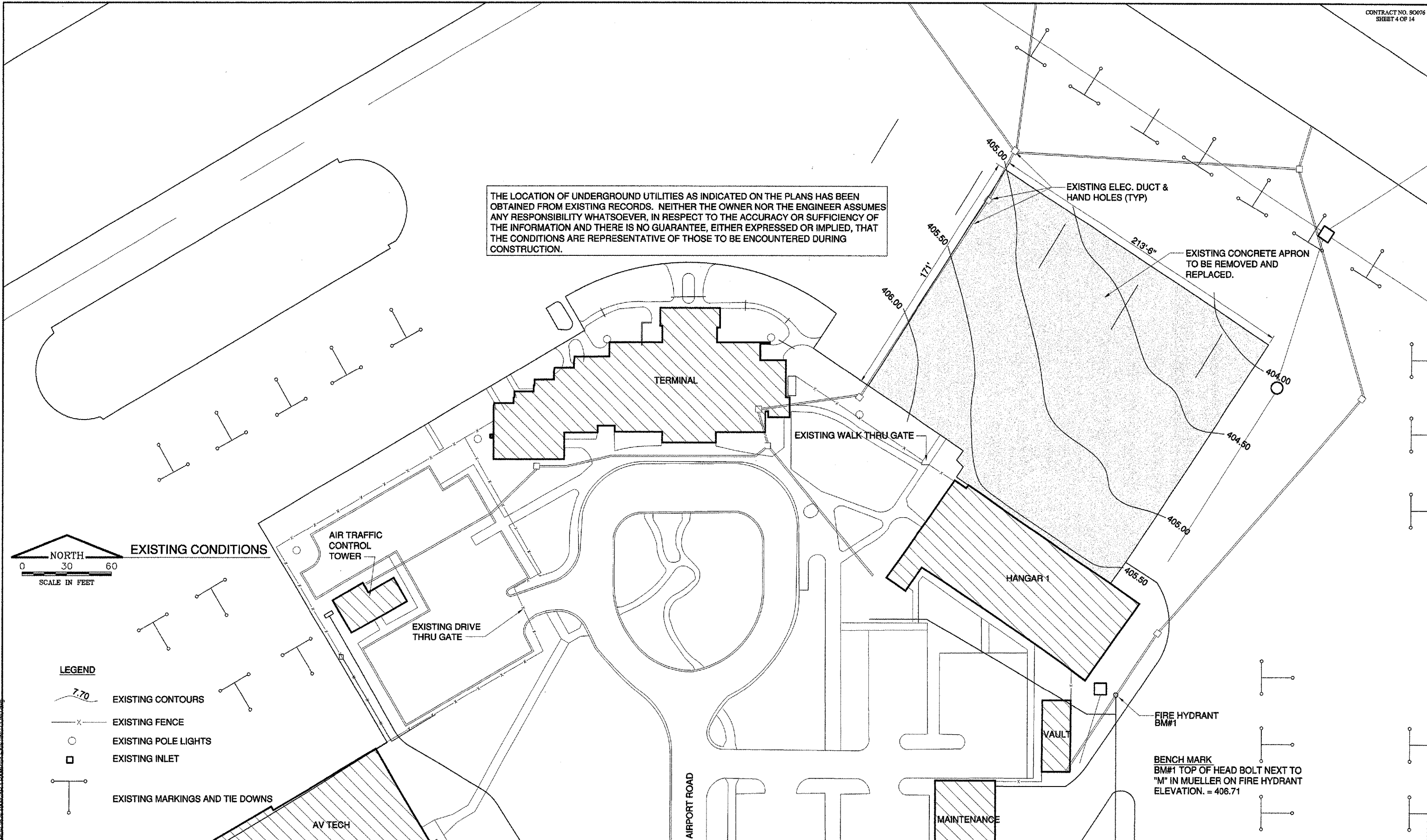

EXISTING CONDITIONS

**LEGEND**

- EXISTING CONTOURS
- EXISTING FENCE
- EXISTING POLE LIGHTS
- EXISTING INLET
- EXISTING MARKINGS AND TIE DOWNS



Illinois Department of Transportation  
Division of Aeronautics



Poirier Associates P.C.  
Engineering and Architectural  
Services Group  
665 N. Airport Road  
Suite 113 Terminal Building  
Murphysboro, Illinois 62966  
Telephone (618)549-5181  
Fax (618)528-5444  
E-mail poirier@netnet.net



**HANGAR 1 RAMP REPLACEMENT  
SOUTHERN ILLINOIS AIRPORT  
MURPHYSBORO / CARBONDALE, ILLINOIS**

DATE: 06 APRIL, 2006  
DRAWN: CWB  
CHECKED: DO  
APPROVED: BCF  
PROJECT NO. PA05036  
IL. PROJ. NO. MDH-3576  
  
REVISIONS:  
© 2006 POIRIER ASSOCIATES P.C.  
ALL RIGHTS RESERVED

EXISTING CONDITIONS  
SHEET NO.  
**4**  
OF 14

AEC 05/2006 - 1:41 PM