

STATE OF ILLINOIS
DEPARTMENT OF TRANSPORTATION

F.A.U. RTE.	SECTION	COUNTY	TOTAL SHEETS	SHEET NO.
1631	0404.1-RS	COOK	27 X 1	
ILLINOIS CONTRACT NO. 62C55				

*27+20=47 TOTAL SHEETS

D-91-362-16

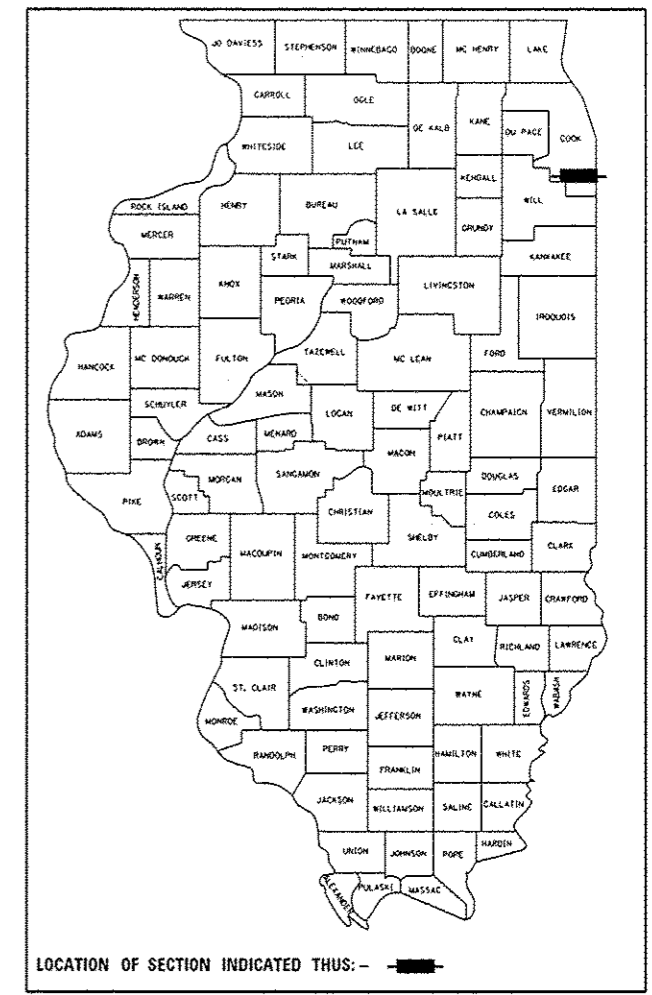

PROPOSED HIGHWAY PLANS

FAU ROUTE 1631 : JOE ORR ROAD
FROM ASHLAND AVENUE TO STATE STREET
SECTION 0404.1-RS
PROJECT STP-1631(003)
RESURFACING, HMA OVERLAY, ADA
PEDESTRIAN RAMP RETROFIT
COOK COUNTY

C-91-362-16
R 14 E

FOR INDEX OF SHEETS, SEE SHEET NO. 2

PROJECT IS LOCATED IN THE
CITY OF CHICAGO HEIGHTS

TRAFFIC DATA:

JOE ORR ROAD:
2014 ADT = 14,800
SPEED LIMIT = 40 MPH

PROJECT START
STA 19+29.90

PROJECT END
STA 126+73.76

T 35 N

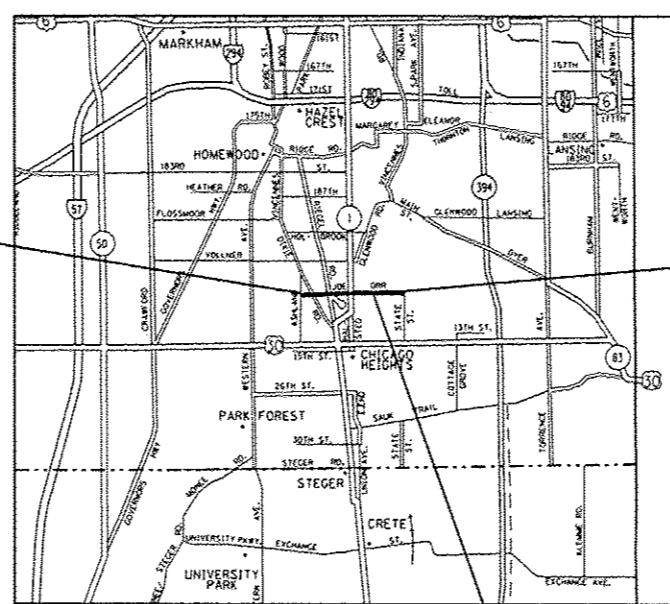

OMISSION:
STA 100+34
STA 101+85

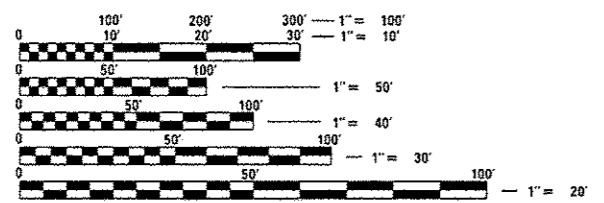

FULL SIZE PLANS HAVE BEEN PREPARED USING STANDARD ENGINEERING SCALES. REDUCED SIZED PLANS WILL NOT CONFORM TO STANDARD SCALES. IN MAKING MEASUREMENTS ON REDUCED PLANS, THE ABOVE SCALES MAY BE USED.

J.U.L.I.E.
JOINT UTILITY LOCATION INFORMATION FOR EXCAVATION
1-800-892-0123
OR 811

PROJECT ENGINEER JENPAI CHANG (847)705-4432
PROJECT MANAGER FAWAD AQUEEL (847)705-4247

GROSS LENGTH = 10,744 FT. = 2.035 MILE
NET LENGTH = 10,593 FT. = 2.006 MILE

CONTRACT NO. 62C55

STATE OF ILLINOIS
DEPARTMENT OF TRANSPORTATION

SUBMITTED *April 3 2017*
Andrew G. [Signature] REGIONAL ENGINEER

May 12 2017
Matthew M. Addis P.E. ENGINEER OF DESIGN AND ENVIRONMENT

May 12 2017
David [Signature] DIRECTOR OF PROGRAM DEVELOPMENT

PRINTED BY THE AUTHORITY
OF THE STATE OF ILLINOIS

REV 6-6-17

SUMMARY OF QUANTITIES			URBAN CONSTRUCTION TYPE CODE				
CODE NO	ITEM	UNIT	TOTAL QUANTITIES	FED 80 ST 20 0005			
20200100	EARTH EXCAVATION	CU YD	63	63			
21101615	TOPSOIL FURNISH AND PLACE, 4"	SO YD	491	491			
25000310	SEEDING, CLASS 4	ACRE	0.4	0.4			
25000400	NITROGEN FERTILIZER NUTRIENT	POUND	6	6			
25000500	PHOSPHORUS FERTILIZER NUTRIENT	POUND	6	6			
25000600	POTASSIUM FERTILIZER NUTRIENT	POUND	6	6			
25100630	EROSION CONTROL BLANKET	SO YD	1694	1694			
25200110	SODDING, SALT TOLERANT	SO YD	491	491			
40600290	BITUMINOUS MATERIALS (TACK COAT)	POUND	52375	52375			
40600400	MIXTURE FOR CRACKS, JOINTS, AND FLANGEWAYS	TON	116	116			
40600827	POLYMERIZED LEVELING BINDER (MACHINE METHOD), 1L-4, 75, N50	TON	3201	3201			
40600982	HOT-MIX ASPHALT SURFACE REMOVAL - BUTT JOINT	SO YD	561	561			
40600985	PORTLAND CEMENT CONCRETE SURFACE REMOVAL - BUTT JOINT	SO YD	809	809			

SUMMARY OF QUANTITIES			URBAN CONSTRUCTION TYPE CODE				
CODE NO	ITEM	UNIT	TOTAL QUANTITIES	FED 80 ST 20 0005			
40603565	POLYMERIZED HOT-MIX ASPHALT SURFACE COURSE, MIX "E", N70	TON	7604	7604			
42001300	PROTECTIVE COAT	SO YD	1186	1186			
42400200	PORTLAND CEMENT CONCRETE SIDEWALK 5 INCH	SO FT	5600	5600			
42400800	DETECTABLE WARNINGS	SO FT	550	550			
44000159	HOT-MIX ASPHALT SURFACE REMOVAL, 2 1/2"	SO YD	44961	44961			
44000600	SIDEWALK REMOVAL	SO FT	5050	5050			
44003510	MEDIAN REMOVAL PARTIAL DEPTH	SO FT	15900	15900			
44201765	CLASS D PATCHES, TYPE II, 10 INCH	SO YD	900	900			
44201769	CLASS D PATCHES, TYPE III, 10 INCH	SO YD	400	400			
44201771	CLASS D PATCHES, TYPE IV, 10 INCH	SO YD	1600	1600			
60258200	MANHOLES TO BE RECONSTRUCTED WITH NEW TYPE 1 FRAME, CLOSED LID	EACH	1	1			
60300305	FRAMES AND LIDS TO BE ADJUSTED	EACH	42	42			
60406000	FRAMES AND LIDS, TYPE 1, OPEN LID	EACH	1	1			
60406100	FRAMES AND LIDS, TYPE 1, CLOSED LID	EACH	4	4			* SPECIALTY ITEM

FILE NAME :	USER NAME :	DESIGNED :	REVISED :	STATE OF ILLINOIS DEPARTMENT OF TRANSPORTATION		JOE ORR RD FROM ASHLAND AVE TO STATE ST SUMMARY OF QUANTITIES		F.A.U. RTE.	SECTION	COUNTY	TOTAL SHEETS	SHEET NO.	
		CHECKED :	REVISED :					1631	0404.1-RS	COOK	27	3	
		DATE :	REVISED :					CONTRACT NO. 62C55		FED. ROAD DIST. NO. 1 [ILLINOIS] FED. AID PROJECT			
								SCALE:	SHEET NO. OF SHEETS	STA. TO STA.			

REV 6-6-17

SUMMARY OF QUANTITIES			URBAN CONSTRUCTION TYPE CODE				
CODE NO	ITEM	UNIT	TOTAL QUANTITIES	FED 80 ST 20 0005			
* 66900200	NON-SPECIAL WASTE DISPOSAL	CU YD	63	63			
* 66900450	SPECIAL WASTE PLANS AND REPORTS	LSUM	1	1			
* 66900530	SOIL DISPOSAL ANALYSIS	EACH	2	2			
67000400	ENGINEER'S FIELD OFFICE, TYPE A	CAL MO	6	6			
67100100	MOBILIZATION	LSUM	1	1			
70102625	TRAFFIC CONTROL AND PROTECTION, STANDARD 701606	LSUM	1	1			
70102632	TRAFFIC CONTROL AND PROTECTION, STANDARD 701602	LSUM	1	1			
70102634	TRAFFIC CONTROL AND PROTECTION, STANDARD 701611	LSUM	1	1			
70102635	TRAFFIC CONTROL AND PROTECTION, STANDARD 701701	LSUM	1	1			
70102640	TRAFFIC CONTROL AND PROTECTION, STANDARD 701801	LSUM	1	1			
70300100	SHORT TERM PAVEMENT MARKING	FOOT	12417	12417			
70300150	SHORT TERM PAVEMENT MARKING REMOVAL	SO FT	2213	2213			
70300210	TEMPORARY PAVEMENT MARKING LETTERS AND SYMBOLS	SO FT	661	661			

SUMMARY OF QUANTITIES			URBAN CONSTRUCTION TYPE CODE				
CODE NO	ITEM	UNIT	TOTAL QUANTITIES	FED 80 ST 20 0005			
70300220	TEMPORARY PAVEMENT MARKING - LINE 4"	FOOT	27029	27029			
70300240	TEMPORARY PAVEMENT MARKING - LINE 6"	FOOT	2951	2951			
70300250	TEMPORARY PAVEMENT MARKING - LINE 8"	FOOT	480	480			
70300260	TEMPORARY PAVEMENT MARKING - LINE 12"	FOOT	1669	1669			
70300280	TEMPORARY PAVEMENT MARKING - LINE 24"	FOOT	1115	1115			
70300520	PAVEMENT MARKING TAPE, TYPE 111 4"	FOOT	6209	6209			
* 78000100	THERMOPLASTIC PAVEMENT MARKING - LETTERS AND SYMBOLS	SO FT	661	661			
* 78000200	THERMOPLASTIC PAVEMENT MARKING - LINE 4"	FOOT	27029	27029			
* 78000400	THERMOPLASTIC PAVEMENT MARKING - LINE 6"	FOOT	2951	2951			
* 78000500	THERMOPLASTIC PAVEMENT MARKING - LINE 8"	FOOT	480	480			
* 78000600	THERMOPLASTIC PAVEMENT MARKING - LINE 12"	FOOT	1669	1669			
* 78000650	THERMOPLASTIC PAVEMENT MARKING - LINE 24"	FOOT	1115	1115			
* 78100100	RAISED REFLECTIVE PAVEMENT MARKER	EACH	950	950			* SPECIALTY ITEM

FILE NAME: P:\NS\084EB\DH\EG\Illinois\PH\DOT\Documents\1007	USER NAME: tedcorm	DESIGNED: -	REVISED: -	STATE OF ILLINOIS DEPARTMENT OF TRANSPORTATION	JOE ORR RD FROM ASHLAND AVE TO STATE ST SUMMARY OF QUANTITIES	F.A.U. RTE. 1631	SECTION 0404J-RS	COUNTY COOK	TOTAL SHEETS 27	SHEET NO. 4
PLDT SCALE: 1000000' = 1"	CHECKED: -	REVISED: -	SCALE:			SHEET NO. OF SHEETS STA. TO STA.	FED. ROAD DIST. NO. 1 ILLINOIS FED. AID PROJECT	CONTRACT NO. 62C55		
PLDT DATE: 4/6/2007	DATE: -	REVISED: -								

REV 6-6-17

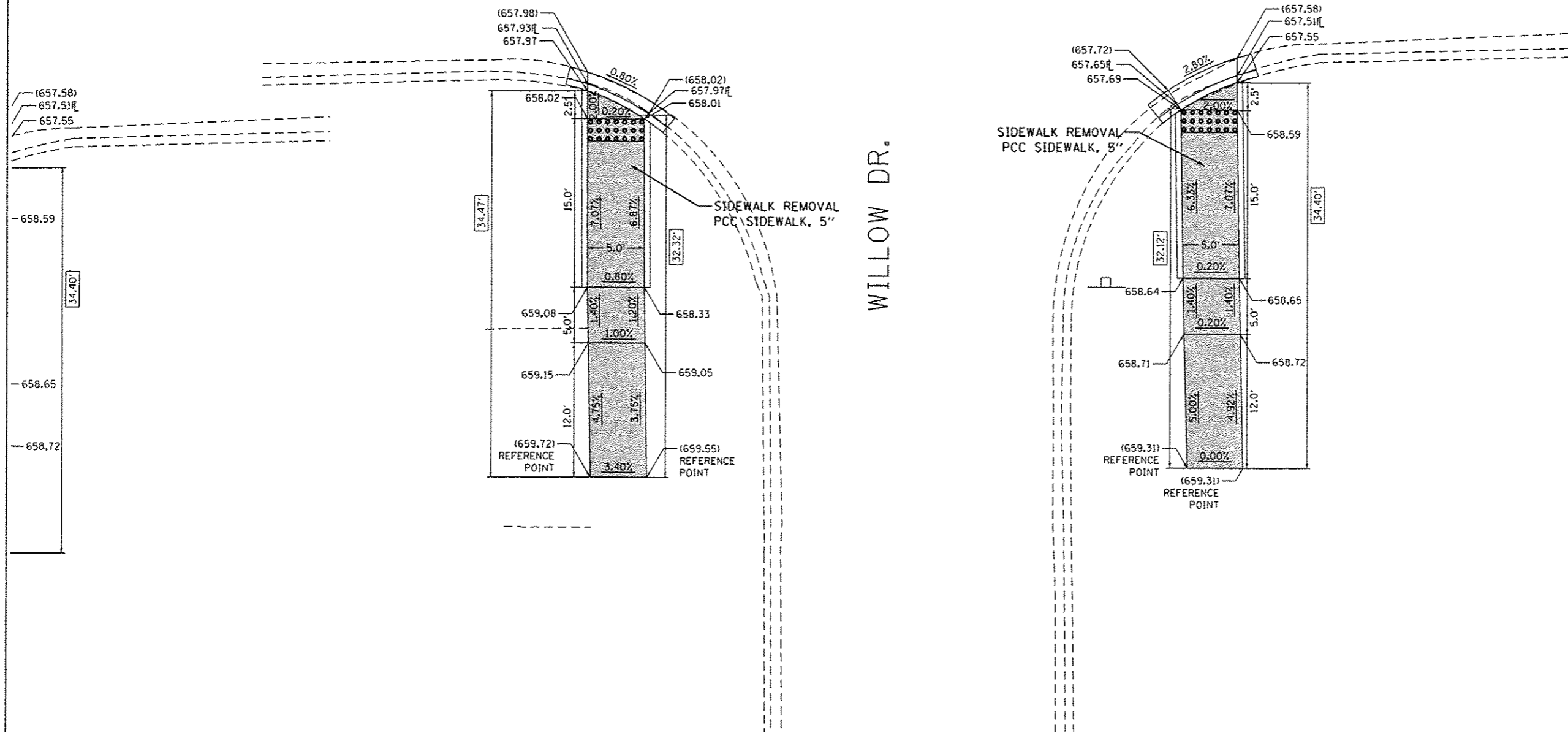

REFERENCE BENCH MARK ELEV 665.12
 BENCHMARK : CUT SQUARE
 LOCATION : NE CORNER OF TRAFFIC CONT. FOUNDATION AT NW QUAD OF INTERSECITON

LEGEND	
xx.xx'	EXISTING LENGTH
=====	PROPOSED SIDE CURB
()	EXISTING ELEVATION/SLOPE
	PROPOSED SIDEWALK
	DETECTABLE WARNINGS
	SIDEWALK REMOVAL REPLACE W/TOPSOIL & SOD

FILE NAME :	USER NAME : jedezmorm	DESIGNED -	REVISED -	STATE OF ILLINOIS DEPARTMENT OF TRANSPORTATION	ADA RAMP DETAILS (JOE ORR RD AND WILLOW DR) JOE ORR RD (ASHLAND AVE TO STATE ST)	F.A.U. RTE.:	SECTION	COUNTY	TOTAL SHEETS	SHEET NO.	
pm\110046810\ITEG\Illinois.gov\WIDOT\Documents\1001 Offices\District 1\Projects\0132\DWG\1001\Design\10136216\ehd-details.dwg	PLLOT SCALE : 10.0000' / in.	CHECKED -	REVISED -			1631	0404.1-R5	COOK	27	17C	
Default	PLLOT DATE : 5/26/2017	DATE -	REVISED -			SCALE: 1"=5'		SHEET OF SHEETS		STA. TO STA.	
						CONTRACT NO. 62C55					

Sheet Added 6-6-17

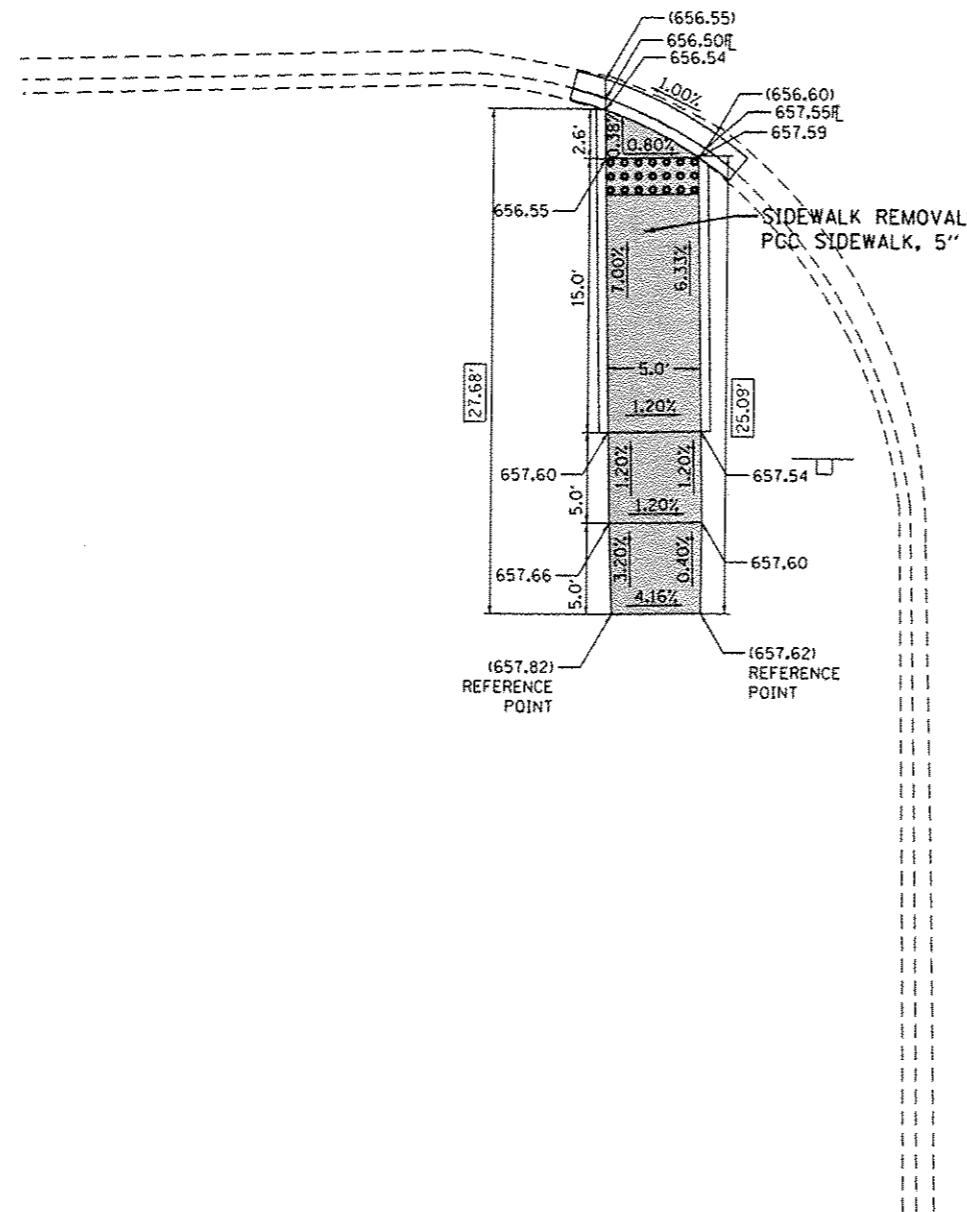

DE ANGELIS CT.

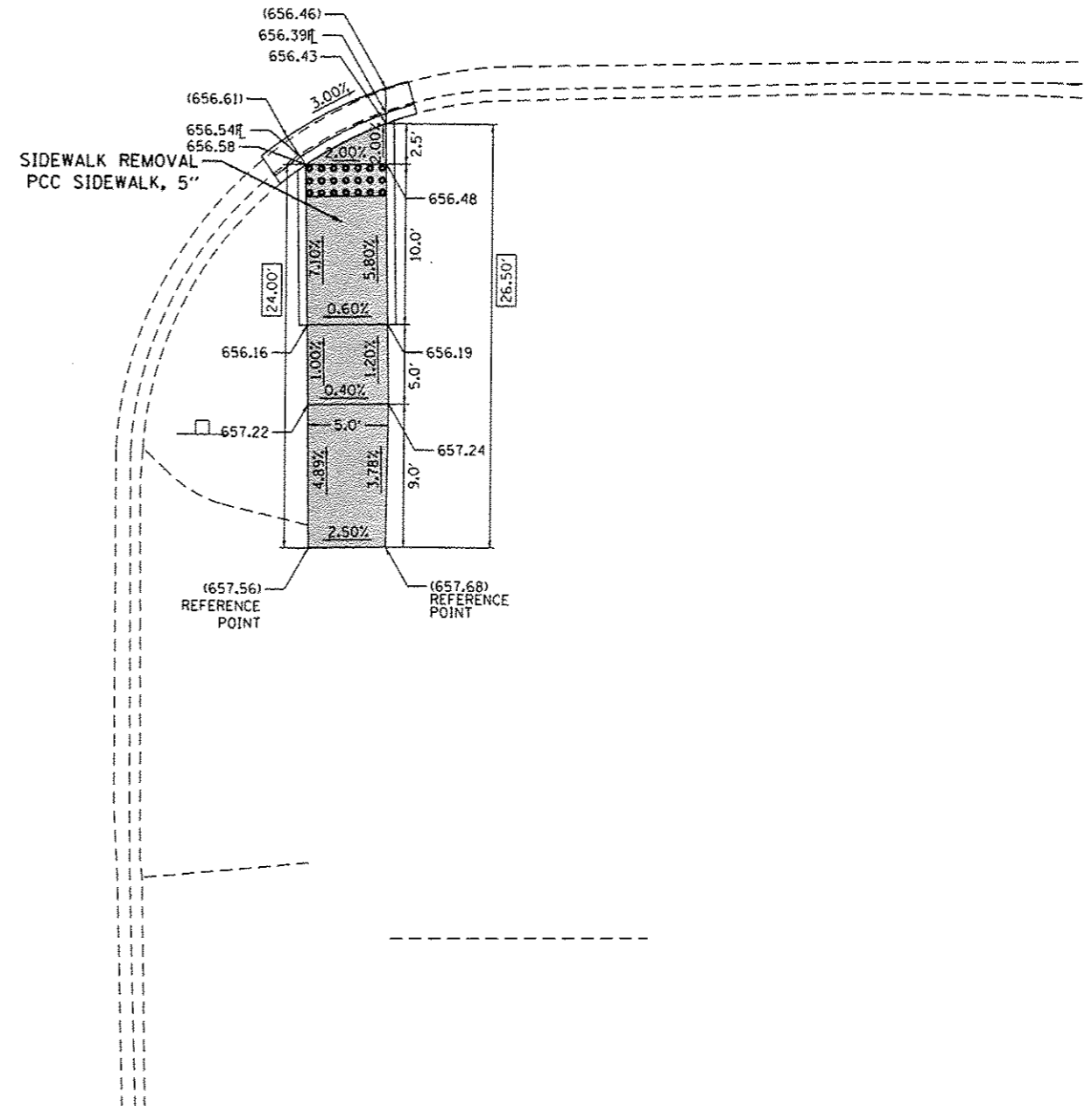

REFERENCE BENCH MARK ELEV 665.12

BENCHMARK : CUT SQUARE

LOCATION : NE CORNER OF TRAFFIC CONT. FOUNDATION AT NW QUAD OF INTERSECITON

LEGEND



EXISTING LENGTH



PROPOSED SIDE CURB



EXISTING ELEVATION/SLOPE



PROPOSED SIDEWALK



DETECTABLE WARNINGS



SIDEWALK REMOVAL
REPLACE W/TOPSOIL & SOD

FILE NAME *	USER NAME = jsoezmarm	DESIGNED -	REVISED -
Documents\IBDD\Office\District 1\Projects\DJ38216\Design\0138216-shi-details.dgn			REVISED -
Default	PLOT SCALE = 10.0000' / in.	CHECKED -	REVISED -
	PLOT DATE = 5/26/2017	DATE -	REVISED -

STATE OF ILLINOIS
DEPARTMENT OF TRANSPORTATION

ADA RAMP DETAILS (JOE ORR RD AND DE ANGELIS CT)
JOE ORR RD (ASHLAND AVE TO STATE ST)

F.A.U. RTE.	SECTION	COUNTY	TOTAL SHEETS	SHEET NO.
1631	0404,1-RS	COOK	27	170
CONTRACT NO. 62C55				
[ILLINOIS] FED. AID PROJECT				

SCALE: 1"=5' SHEET OF SHEETS STA. TO STA.

Sheet Added 6-6-17

JOE ORR RD

AUTOZONE ENT

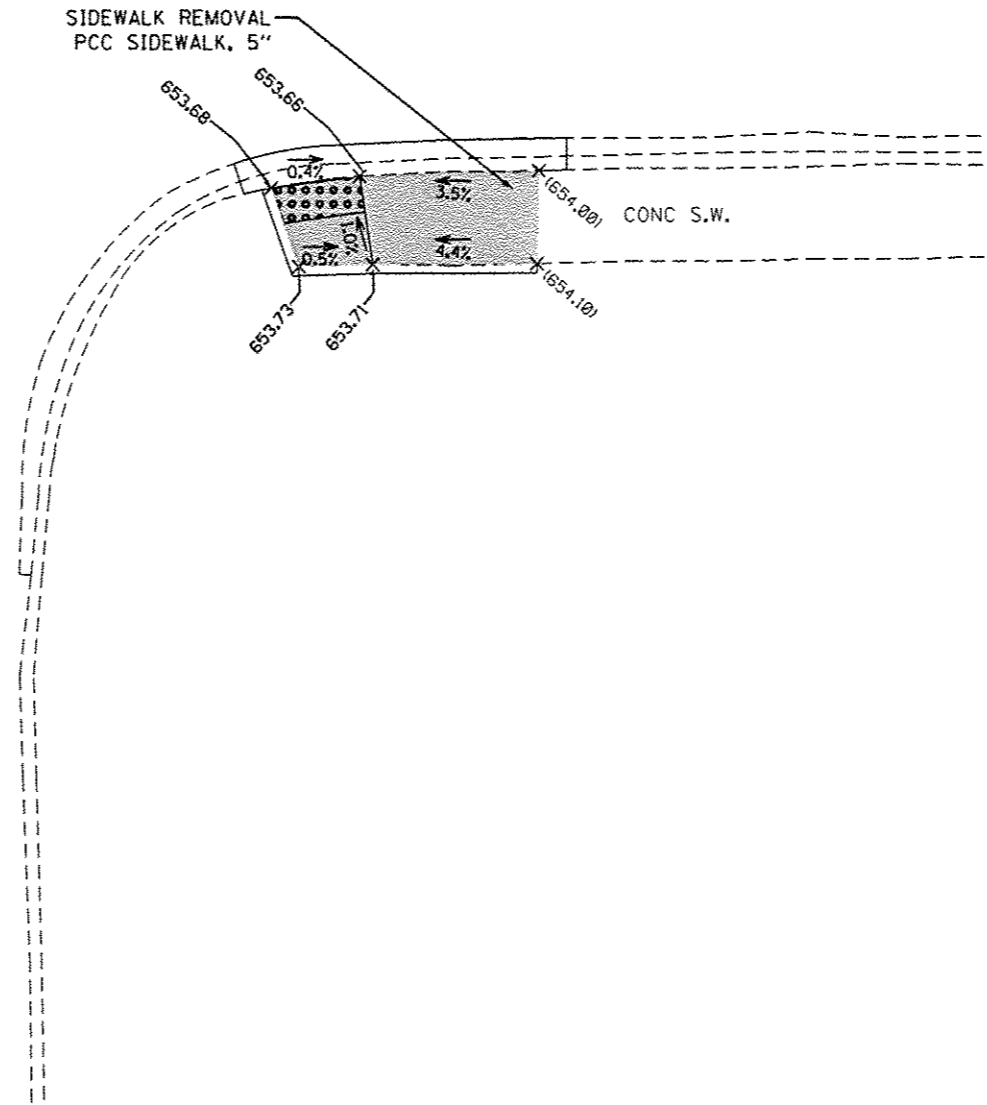

REFERENCE BENCH MARK ELEV 656.44

BENCHMARK : CUT X

LOCATION : N'LY FLANGE BOLD OF FH IN SW CORNER OF JOE ORR RD AND AUTOZONE ENTRANCE

LEGEND

xx.xx'

EXISTING LENGTH

=====

PROPOSED SIDE CURB

()

EXISTING ELEVATION/SLOPE



PROPOSED SIDEWALK



DETECTABLE WARNINGS



SIDEWALK REMOVAL
REPLACE W/TOPSOIL & SOD

FILE NAME *	USER NAME * ledzmoem	DESIGNED -	REVISED -
pw\N\004EBID\INTEG\Illinois.gov\PIDOT\Documents\DOT Offices\District 1\Projects\01302\BROW\Brow\Design\0130216\ahs-details.dgn			
Default		CHECKED -	REVISED -
	PLOT SCALE * 10.0000' / in.	DATE -	REVISED -
	PLOT DATE * 5/26/2017		

STATE OF ILLINOIS
DEPARTMENT OF TRANSPORTATION

ADA RAMP DETAILS (JOE ORR RD AND BUS SHELTER)
JOE ORR RD (ASHLAND AVE TO STATE ST)

F.A.U. RTE.	SECTION	COUNTY	TOTAL SHEETS	SHEET NO.
1631	0404.1-RS	COOK	27	17E
ILLINOIS FED. AID PROJECT			CONTRACT NO. 62C55	

SCALE: 1"=5' SHEET OF SHEETS STA. TO STA.

Sheet Added 6-6-17

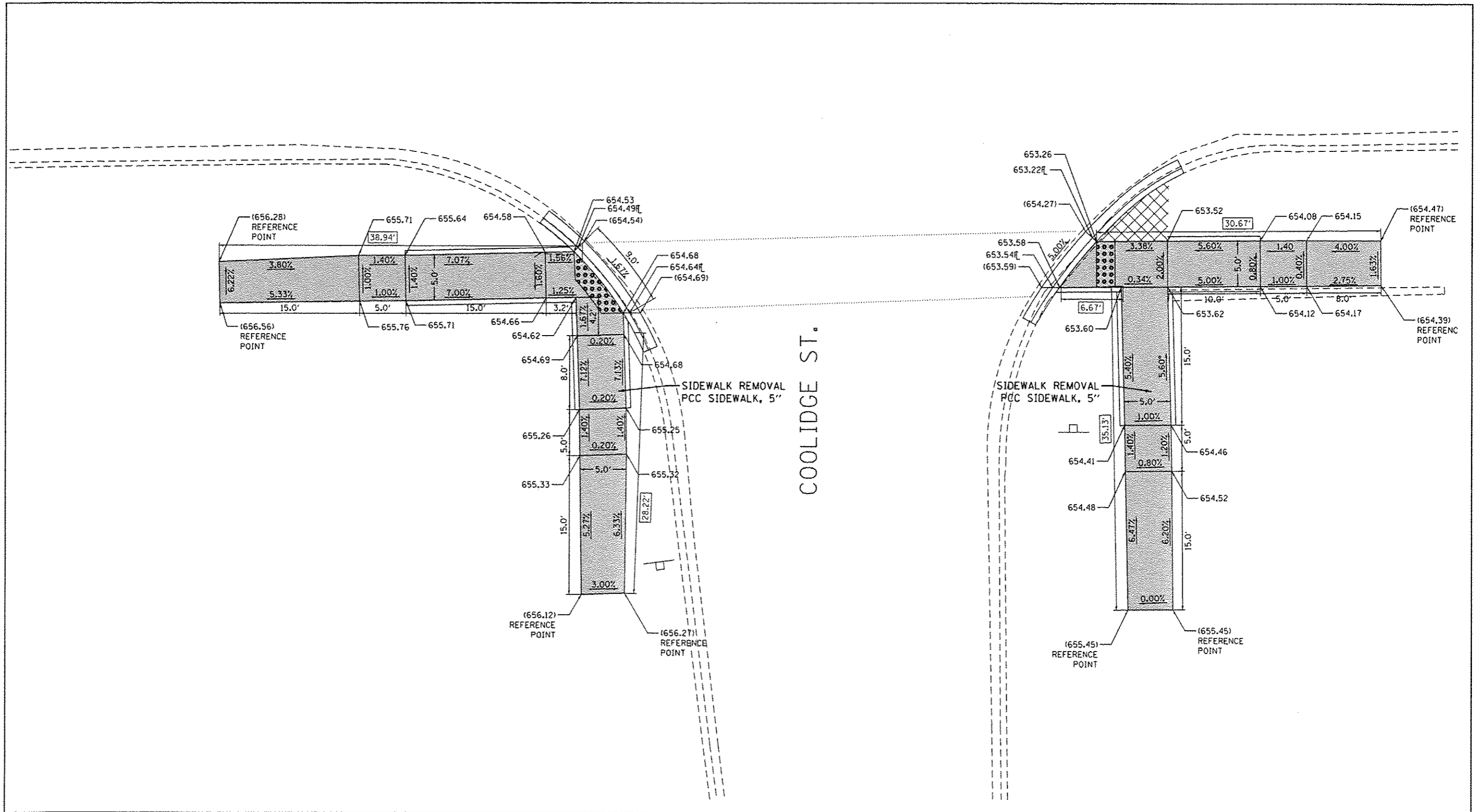

COOLIDGE ST.

REFERENCE BENCH MARK ELEV 665.12 BENCHMARK : CUT SQUARE LOCATION : NE CORNER OF TRAFFIC CONT. FOUNDATION AT NW QUAD OF INTERSECITON				LEGEND <div style="display: flex; justify-content: space-between;"> <div style="width: 45%;"> <p>xx.xx' EXISTING LENGTH</p> <p> PROPOSED SIDE CURB</p> <p>() EXISTING ELEVATION/SLOPE</p> </div> <div style="width: 45%;"> <p> PROPOSED SIDEWALK</p> <p> DETECTABLE WARNINGS</p> <p> SIDEWALK REMOVAL REPLACE W/TOPSOIL & SOD</p> </div> </div>																	
FILE NAME : <small>p:\11\04\EBID\ITEG\illinois.gov\WIDOT\Documents\DOT Offices\District 1\Projects\0136216\Design\0136216-ehd-details.dgn</small>	USER NAME : ladezorn DESIGNED - CHECKED - DATE -	REVISED - REVISED - REVISED - REVISED -	STATE OF ILLINOIS DEPARTMENT OF TRANSPORTATION		ADA RAMP DETAILS (JOE ORR RD AND COOLIDGE ST) JOE ORR RD (ASHLAND AVE TO STATE ST) SCALE: 1"=5' SHEET OF SHEETS STA. TO STA.	<table border="1" style="width: 100%; border-collapse: collapse; font-size: 8px;"> <tr> <th>F.A.U. RTE.</th> <th>SECTION</th> <th>COUNTY</th> <th>TOTAL SHEETS</th> <th>SHEET NO.</th> </tr> <tr> <td>1631</td> <td>0404.1-R5</td> <td>COOK</td> <td>27</td> <td>17F</td> </tr> <tr> <td colspan="3" style="text-align: right;">CONTRACT NO. 62C55</td> <td colspan="2" style="text-align: right;">ILLINOIS FED. AID PROJECT</td> </tr> </table>	F.A.U. RTE.	SECTION	COUNTY	TOTAL SHEETS	SHEET NO.	1631	0404.1-R5	COOK	27	17F	CONTRACT NO. 62C55			ILLINOIS FED. AID PROJECT	
F.A.U. RTE.	SECTION	COUNTY	TOTAL SHEETS	SHEET NO.																	
1631	0404.1-R5	COOK	27	17F																	
CONTRACT NO. 62C55			ILLINOIS FED. AID PROJECT																		

Sheet Added 6-6-17

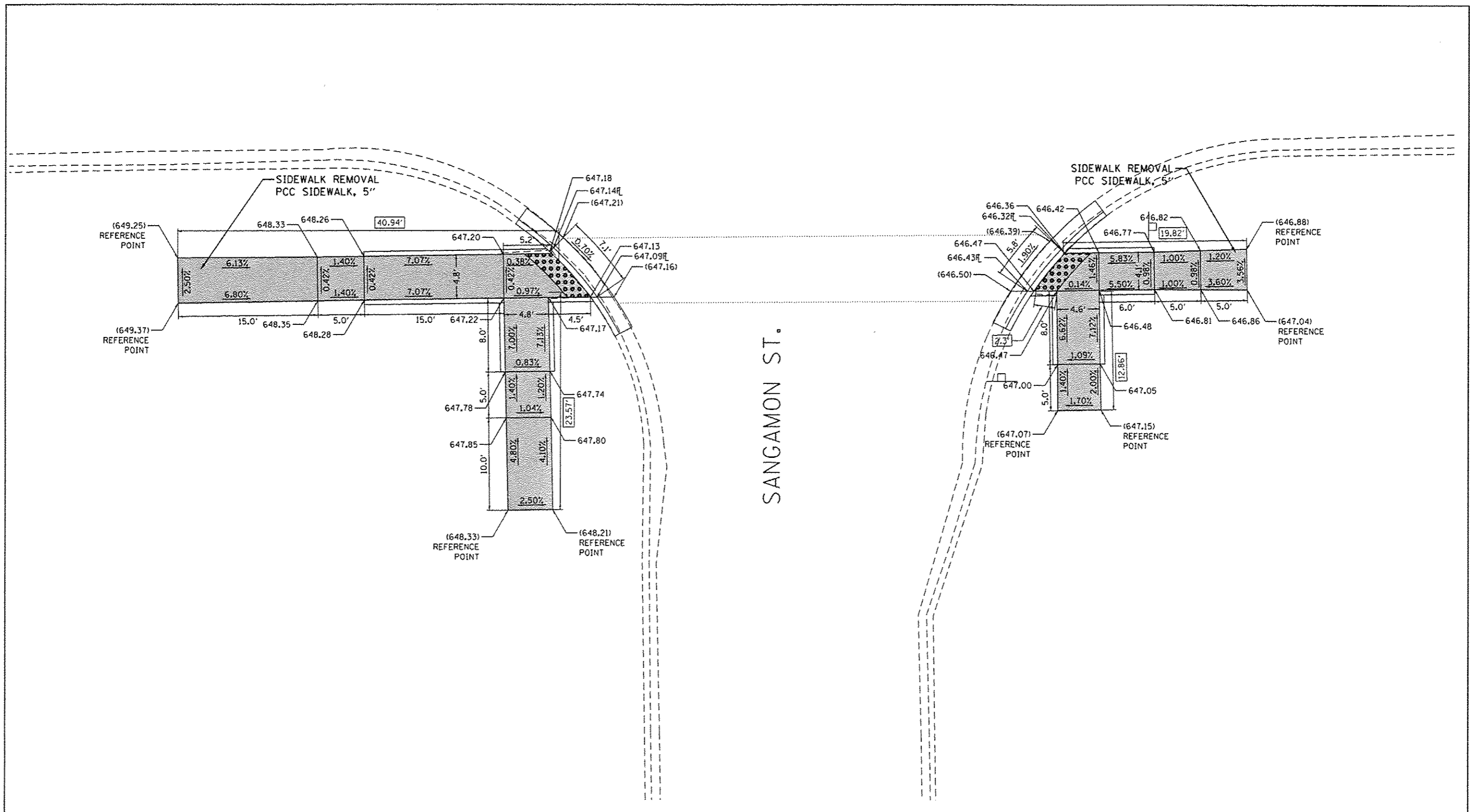

REFERENCE BENCH MARK ELEV 665.12
 BENCHMARK : CUT SQUARE
 LOCATION : NE CORNER OF TRAFFIC CONT. FOUNDATION AT NW QUAD OF INTERSECTON

LEGEND

xx.xx'	EXISTING LENGTH		PROPOSED SIDEWALK
	PROPOSED SIDE CURB		DETECTABLE WARNINGS
()	EXISTING ELEVATION/SLOPE		SIDEWALK REMOVAL REPLACE W/TOPSOIL & SOD

FILE NAME :	USER NAME : <i>tedozmorn</i>	DESIGNED -	REVISED -	STATE OF ILLINOIS DEPARTMENT OF TRANSPORTATION	ADA RAMP DETAILS (JOE ORR RD AND SANGAMON ST) JOE ORR RD (ASHLAND AVE TO STATE ST)	F.A.U. RTE.	SECTION	COUNTY	TOTAL SHEETS	SHEET NO.	
		CHECKED -	REVISED -			1631	0404.1-RS	COOK	27	176	
		DATE -	REVISED -			SCALE: 1"=5'		SHEET OF SHEETS STA. TO STA.		CONTRACT NO. 62C55	
						ILLINOIS FED. AID PROJECT					

Sheet Added 6-6-17

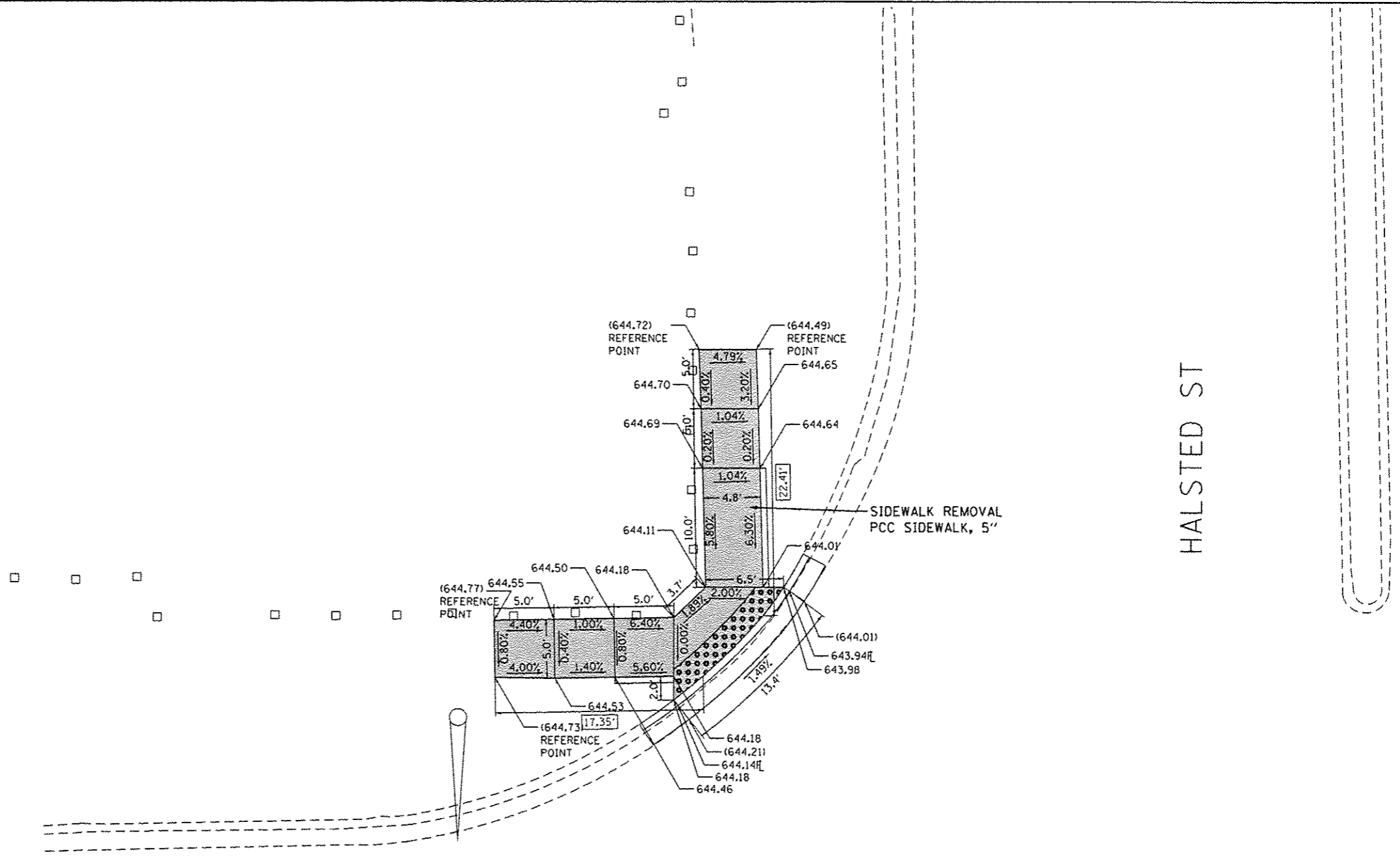

HALSTED ST

REFERENCE BENCH MARK ELEV 645.33

BENCHMARK : CUT SQUARE

LOCATION : SE CORNER OF TRAFFIC CONT. FOUNDATION AT SW QUAD OF JOE ORR RD AND HALSTED ST

	EXISTING LENGTH		PROPOSED SIDEWALK
	PROPOSED SIDE CURB		DETECTABLE WARNINGS
	EXISTING ELEVATION/SLOPE		SIDEWALK REMOVAL REPLACE W/TOPSOIL & SOD

FILE NAME : p:\11\084EB\B\INTEG\11\inora.gov\PWIDOT\Do	USER NAME : ledesmorm	DESIGNED -	REVISED -	STATE OF ILLINOIS DEPARTMENT OF TRANSPORTATION	ADA RAMP DETAILS (JOE ORR RD AND HALSTED ST) JOE ORR RD (ASHLAND AVE TO STATE ST)	F.A.U. RTE. 1631	SECTION 0404.1-RS	COUNTY COOK	TOTAL SHEETS 27	SHEET NO. 17H		
PLLOT SCALE : 10.0000 ' / in	CHECKED -	REVISED -	SCALE: 1"=5'			SHEET OF SHEETS STA. TO STA.	CONTRACT NO. 62C55					
PLLOT DATE : 5/26/2017	DATE -	REVISED -	[ILLINOIS] FED. AID PROJECT									

Sheet Added 6-6-17

JOE ORR RD

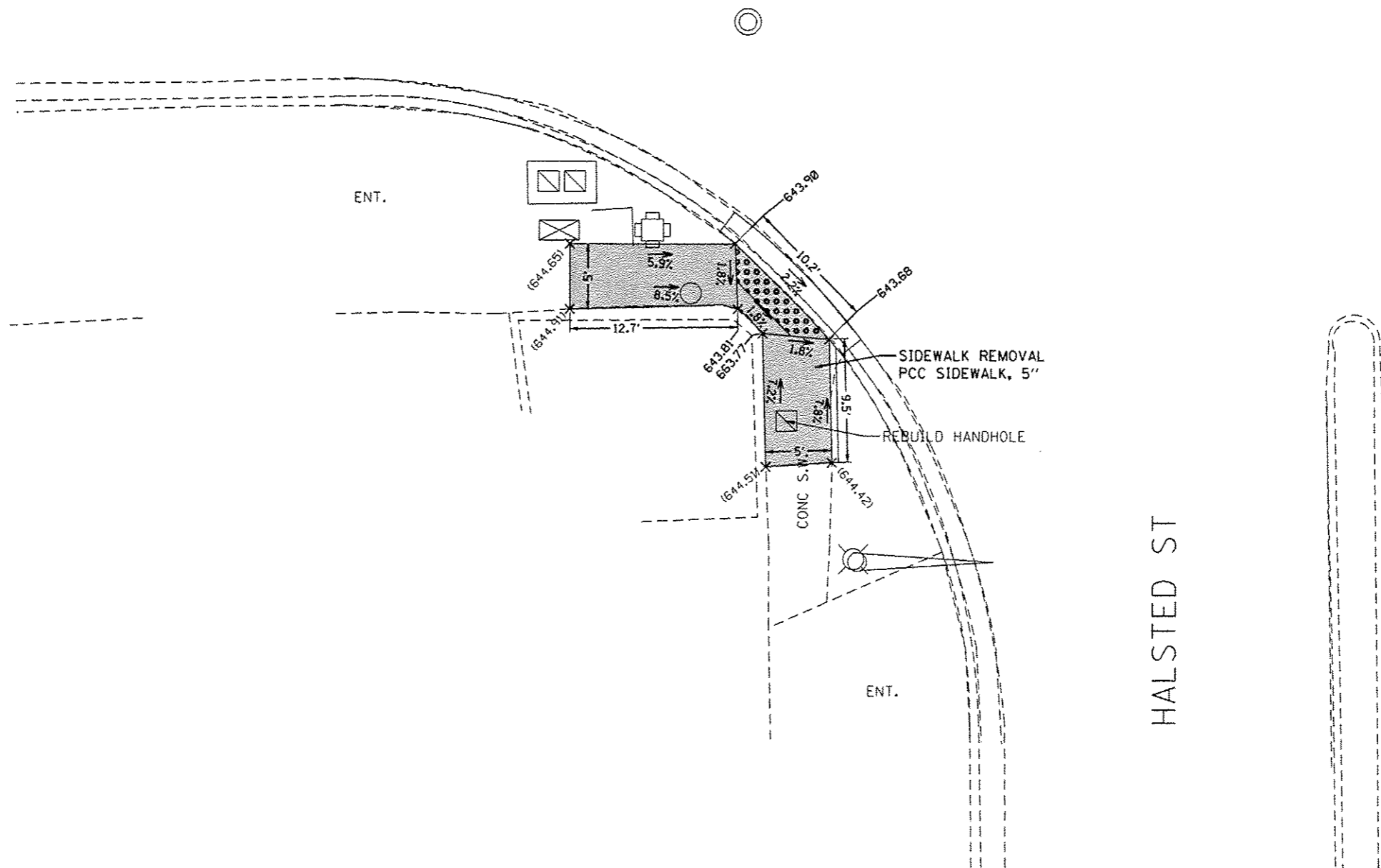

HALSTED ST

REFERENCE BENCH MARK ELEV 636.83

BENCHMARK: CUT SQUARE FLANGE BOLT OF FIRE HYDRANT

LOCATION: SE CORNER OF TRAFFIC CORNER FOUNDATION RD AND WALLACE JOE ORR RD AND HALSTED ST EOP

LEGEND

- xx.xx' EXISTING LENGTH
- ==== PROPOSED SIDE CURB
- () EXISTING ELEVATION/SLOPE
- PROPOSED SIDEWALK
- DETECTABLE WARNINGS
- SIDEWALK REMOVAL
REPLACE W/TOPSOIL & SOD

FILE NAME: p:\11\084E810\INTEG\Illinois.gov\FWIDOT\Documents\DOT Office\District 1\Projects\01262\RAW\Info\Design\0136216-ehd-details.dgn	USER NAME: jedesmon	DESIGNED: -	REVISED: -
PLOT SCALE: 18.0000 1/4 in.	CHECKED: -	REVISED: -	REVISED: -
PLOT DATE: 5/26/2017	DATE: -	REVISED: -	REVISED: -

**STATE OF ILLINOIS
DEPARTMENT OF TRANSPORTATION**

**ADA RAMP DETAILS (JOE ORR RD AND HALSTED ST)
JOE ORR RD (ASHLAND AVE TO STATE ST)**

SCALE: 1"=5' SHEET OF SHEETS STA. TO STA.

F.A.U. RTE. 1631	SECTION 0404.1-RS	COUNTY COOK	TOTAL SHEETS 27	SHEET NO. 171
ILLINOIS FED. AID PROJECT			CONTRACT NO. 62C55	

Sheet Added 6-6-17

EMERALD AVE

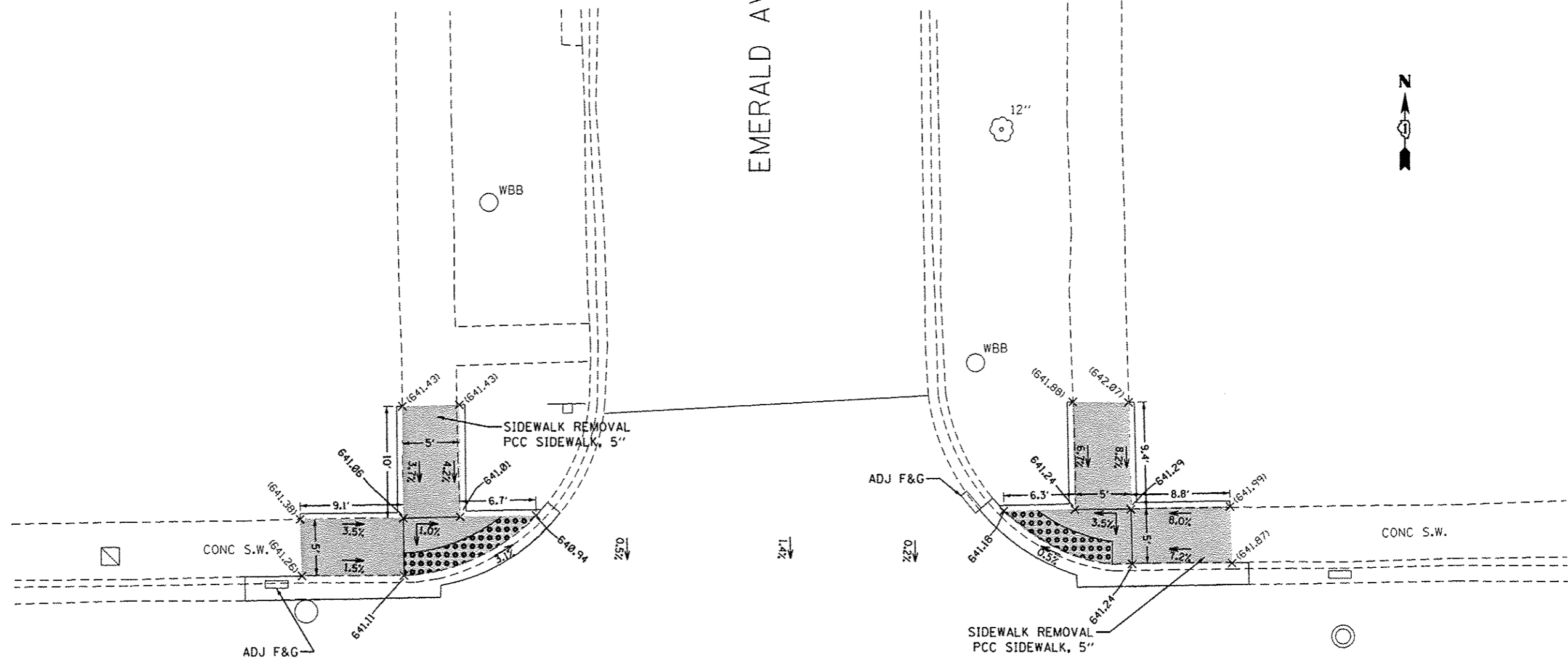

REFERENCE BENCH MARK ELEV 644.89

BENCHMARK : CUT X

LOCATION : N'LY FLANGE BOLT OF FH AT SE QUAD OF JOE ORR RD AND EMERALD AVE

	EXISTING LENGTH		PROPOSED SIDEWALK
	PROPOSED SIDE CURB		DETECTABLE WARNINGS
	EXISTING ELEVATION/SLOPE		SIDEWALK REMOVAL REPLACE W/TOPSOIL & SOD

FILE NAME :	USER NAME = ledzorm	DESIGNED -	REVISED -
p:\1\1894EB\INTEG\111010101\1001\Documents\1001\District 1\Projects\101302\BRW\101302\Design\10130216-shr-details.dgn		CHECKED -	REVISED -
Default	PLOT SCALE = 10.0000 ' / in.	DATE -	REVISED -
	PLOT DATE = 5/26/2017		

STATE OF ILLINOIS
DEPARTMENT OF TRANSPORTATION

ADA RAMP DETAILS (JOE ORR RD AND EMERALD AVE)
JOE ORR RD (ASHLAND AVE TO STATE ST)

SCALE: 1"=5' SHEET OF SHEETS STA. TO STA.

F.A.U. RTE.	SECTION	COUNTY	TOTAL SHEETS	SHEET NO.
1631	0404.1-RS	COOK	27	17J
ILLINOIS FED. AID PROJECT			CONTRACT NO. 62C55	

Sheet Added 10-10-17

CORRUGATED MEDIAN

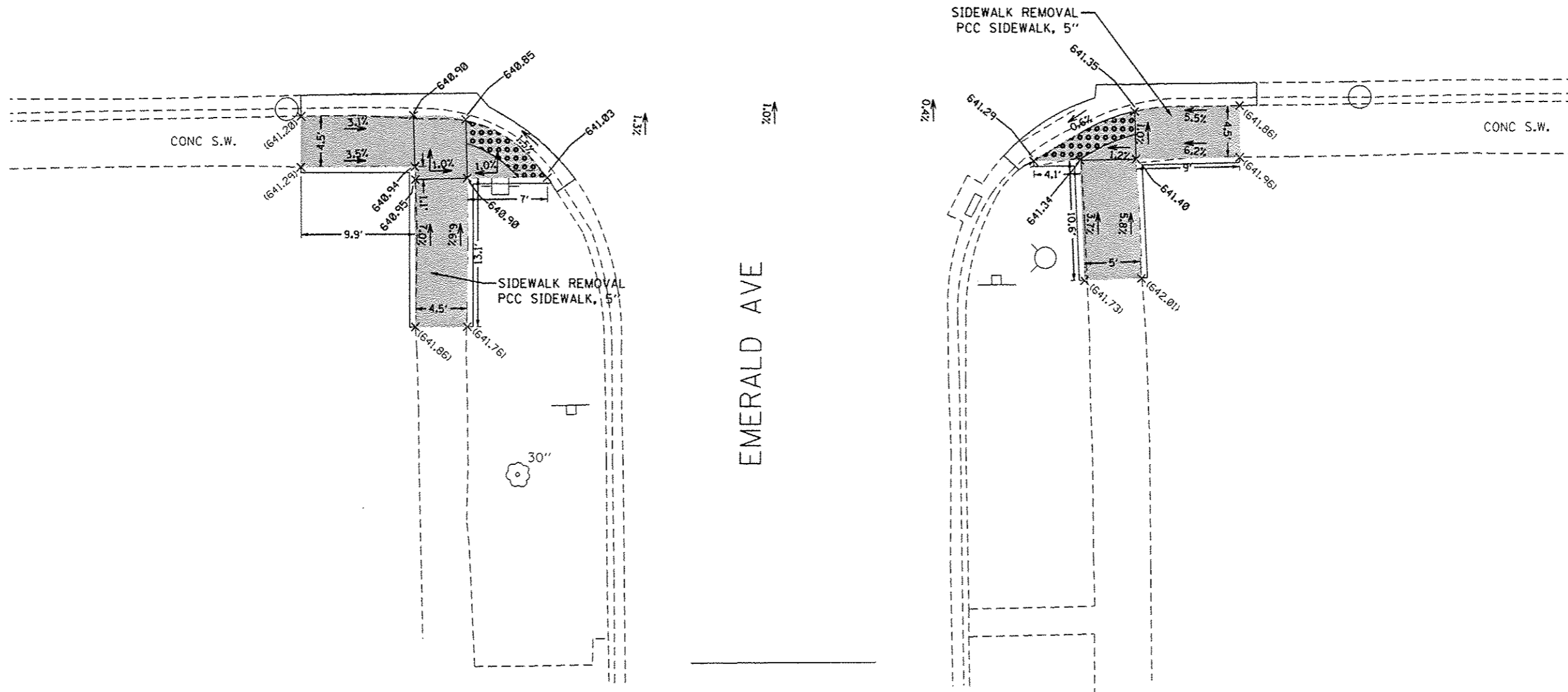

REFERENCE BENCH MARK ELEV 644.89

BENCHMARK : CUT X

LOCATION : N'LY FLANGE BOLT OF FH AT SE QUAD OF JOE ORR RD AND EMERALD AVE

LEGEND

xx.xx'

EXISTING LENGTH

=====

PROPOSED SIDE CURB

()

EXISTING ELEVATION/SLOPE



PROPOSED SIDEWALK



DETECTABLE WARNINGS



SIDEWALK REMOVAL
REPLACE W/TOPSOIL & SOD

FILE NAME :	USER NAME : lodesmarn	DESTONED -	REVISED -
\\IL084EBIDINTEG.illinois.gov\PIW001\Documents\DOT Offices\District 1\Projects\0136216\0136216-ash-detailed.dgn			REVISED -
PLOT SCALE : 10.0000' / in.	CHECKED -		REVISED -
PLOT DATE : 5/26/2017	DATE -		REVISED -

STATE OF ILLINOIS
DEPARTMENT OF TRANSPORTATION

ADA RAMP DETAILS (JOE ORR RD AND EMERALDAVE)
JOE ORR RD (ASHLAND AVE TO STATE ST)

SCALE: 1"=5' SHEET OF SHEETS STA. TO STA.

F.A.U. RTE.	SECTION	COUNTY	TOTAL SHEETS	SHEET NO.
1631	0404.1-RS	COOK	27	17K
CONTRACT NO. 62C55			ILLINOIS FED. AID PROJECT	

Sheet Added 6-6-17

UNION AVE

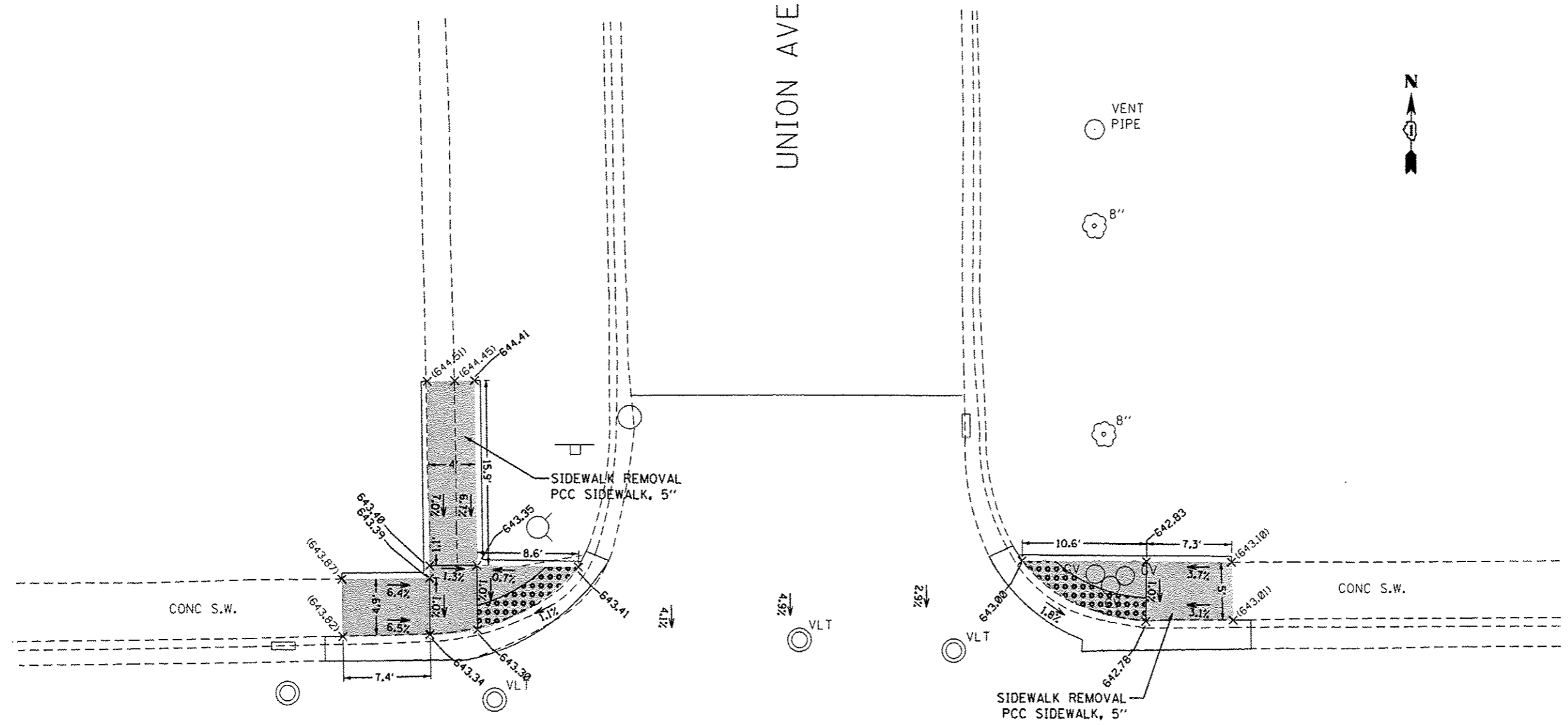

REFERENCE BENCH MARK ELEV 647.14

BENCHMARK : SET X

LOCATION : N'LY FLANGE BOLT OF FH AT NW QUAD OF JOE ORR RD AND UNION AVE

xx.xx'	EXISTING LENGTH		PROPOSED SIDEWALK
	PROPOSED SIDE CURB		DETECTABLE WARNINGS
()	EXISTING ELEVATION/SLOPE		SIDEWALK REMOVAL REPLACE W/TOPSOIL & SOD

FILE NAME *	USER NAME * jdezern	DESIGNED -	REVISED -	STATE OF ILLINOIS DEPARTMENT OF TRANSPORTATION	ADA RAMP DETAILS (JOE ORR RD AND UNION AVE) JOE ORR RD (ASHLAND AVE TO STATE ST)	F.A.U. RTE.	SECTION	COUNTY	TOTAL SHEETS	SHEET NO.	
Default	Documents\DOT Offices\District 11\Projects\DI36216\Drawings\Design\DI36216-ash-ramp-details.dgn	CHECKED -	REVISED -			1631	0404.1-R5	COOK	27	17L	
	PLOT SCALE * 10.0000' / in.	DATE -	REVISED -			SCALE: 1"=5'		SHEET OF SHEETS STA. TO STA.		CONTRACT NO. 62C55	
	PLOT DATE * 5/26/2017					ILLINOIS FED. AID PROJECT					

Sheet Added 6-6-17

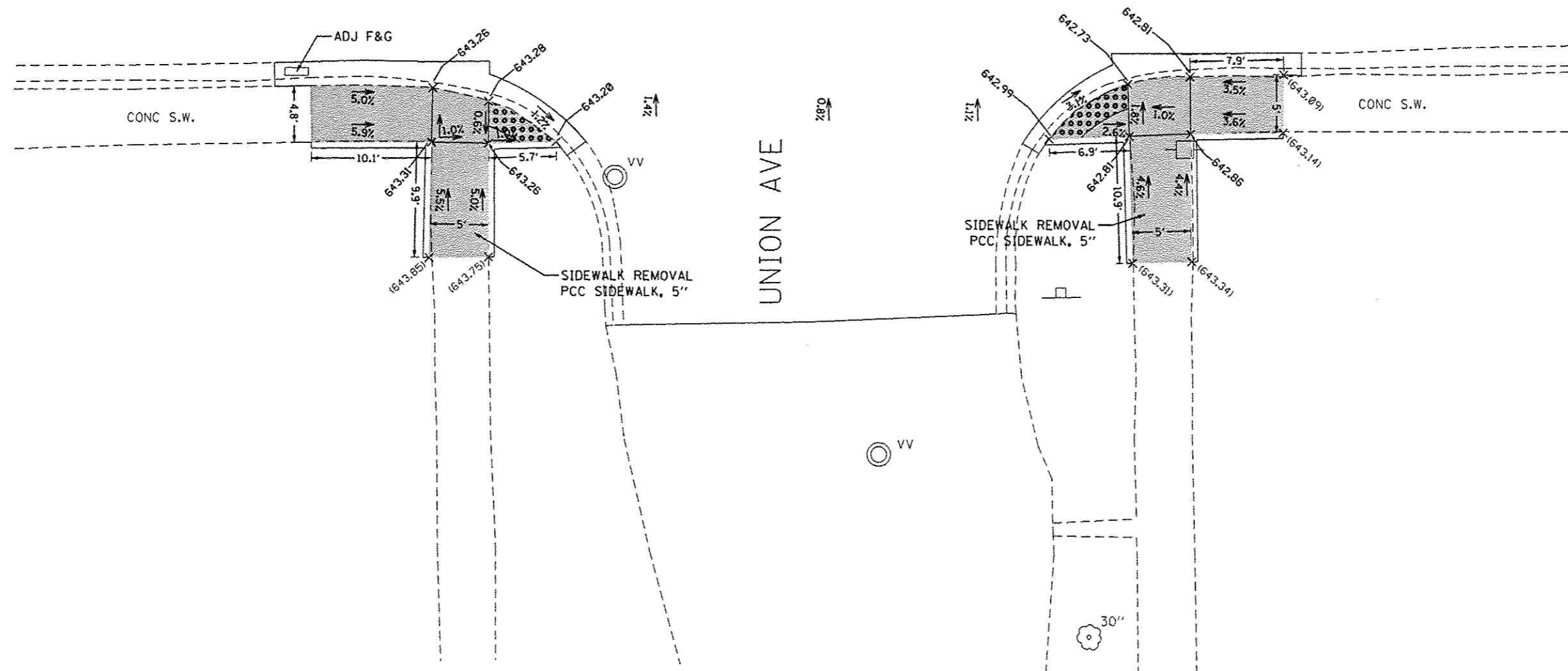

REFERENCE BENCH MARK ELEV 647.14

BENCHMARK : SET X

LOCATION : N'LY FLANGE BOLT OF FH AT NW QUAD OF JOE ORR RD AND UNION AVE

LEGEND

- xx.xx' EXISTING LENGTH
- PROPOSED SIDE CURB
- () EXISTING ELEVATION/SLOPE
- PROPOSED SIDEWALK
- DETECTABLE WARNINGS
- SIDEWALK REMOVAL
REPLACE W/TOPSOIL & SOD

FILE NAME :	USER NAME : ledexmorn	DESIGNED -	REVISED -
p:\11\884EBID\INTEG\Illinois.gov\FWIDOT\Do	umants\DOT Offices\District 1\Projects\0136	BRM\Notes\Design\0136216-ent-details.dgn	REVISED -
Default	PLDT SCALE : 10.0000' / in.	CHECKED -	REVISED -
	PLOT DATE : 5/26/2017	DATE -	REVISED -

**STATE OF ILLINOIS
DEPARTMENT OF TRANSPORTATION**

**ADA RAMP DETAILS (JOE ORR RD AND UNION AVE)
JOE ORR RD (ASHLAND AVE TO STATE ST)**

SCALE: 1"=5' SHEET OF SHEETS STA. TO STA.

F.A.U. RTE.	SECTION	COUNTY	TOTAL SHEETS	SHEET NO.
1631	0404.1-RS	COOK	27	17M
CONTRACT NO. 62C55			ILLINOIS FED. AID PROJECT	

△ Sheet Added 6-6-17

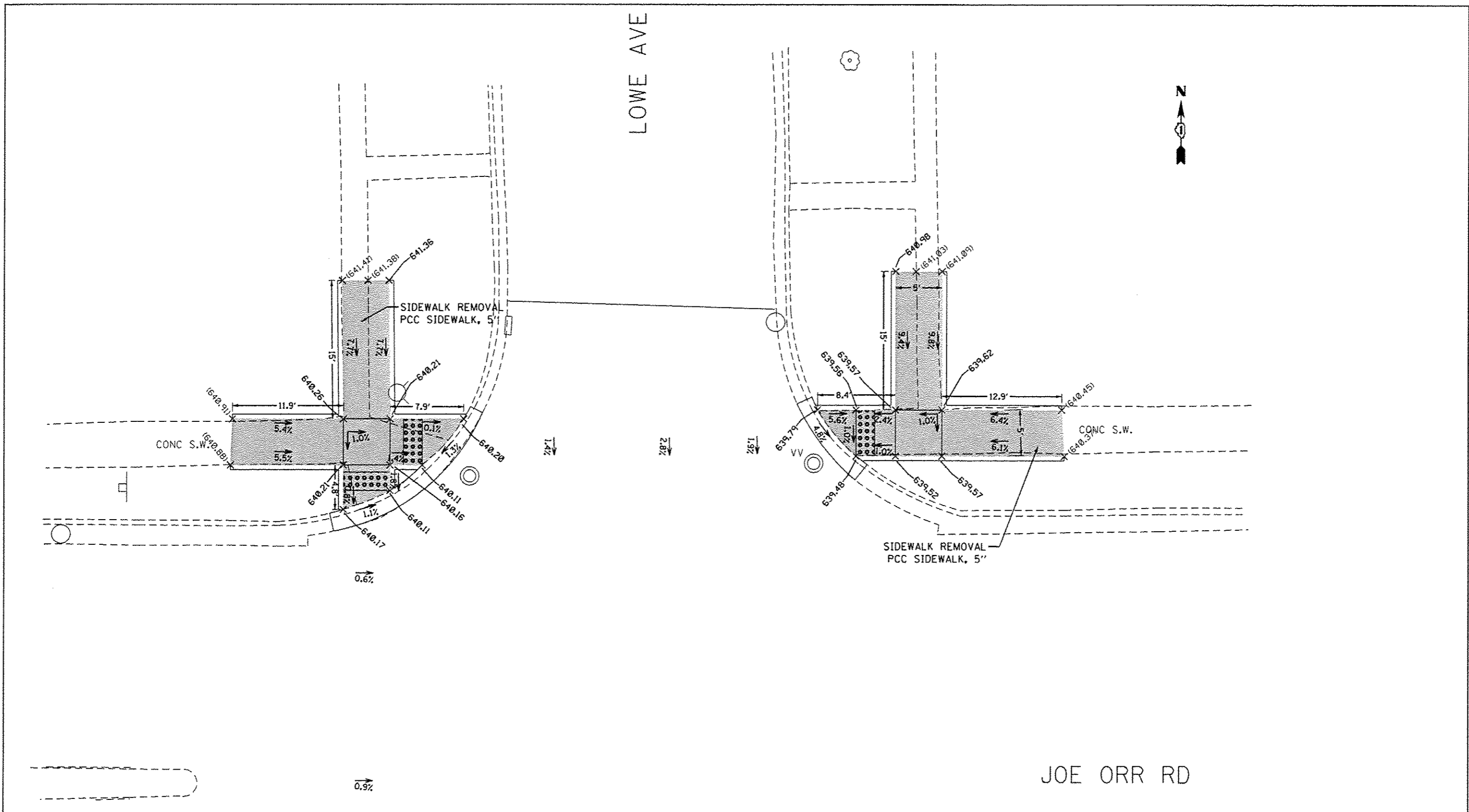

REFERENCE BENCH MARK ELEV 643.08
 BENCHMARK : CUT X
 LOCATION : S'LY FLANGE BOLT OF FH AT NW QUAD OF JOE ORR RD AND LOWE AVE

	EXISTING LENGTH		PROPOSED SIDEWALK
	PROPOSED SIDE CURB		DETECTABLE WARNINGS
	EXISTING ELEVATION/SLOPE		SIDEWALK REMOVAL REPLACE W/TOPSOIL & SOD

FILE NAME :	USER NAME : jedzern	DESIGNED -	REVISED -
PROJECT :	PROJECT :	CHECKED -	REVISED -
PLOT SCALE : 1/8"=1'-0"	DATE :	DATE :	REVISED -
PLOT DATE : 5/26/2017			

**STATE OF ILLINOIS
 DEPARTMENT OF TRANSPORTATION**

**ADA RAMP DETAILS (JOE ORR RD AND LOWE AVE)
 JOE ORR RD (ASHLAND AVE TO STATE ST)**

F.A.J. RTE.:	SECTION:	COUNTY:	TOTAL SHEETS:	SHEET NO.:
1631	0404.1-RS	COOK	27	17N
CONTRACT NO. 62C55			ILLINOIS FED. AID PROJECT	

Sheet Added 6-6-17

JOE ORR RD

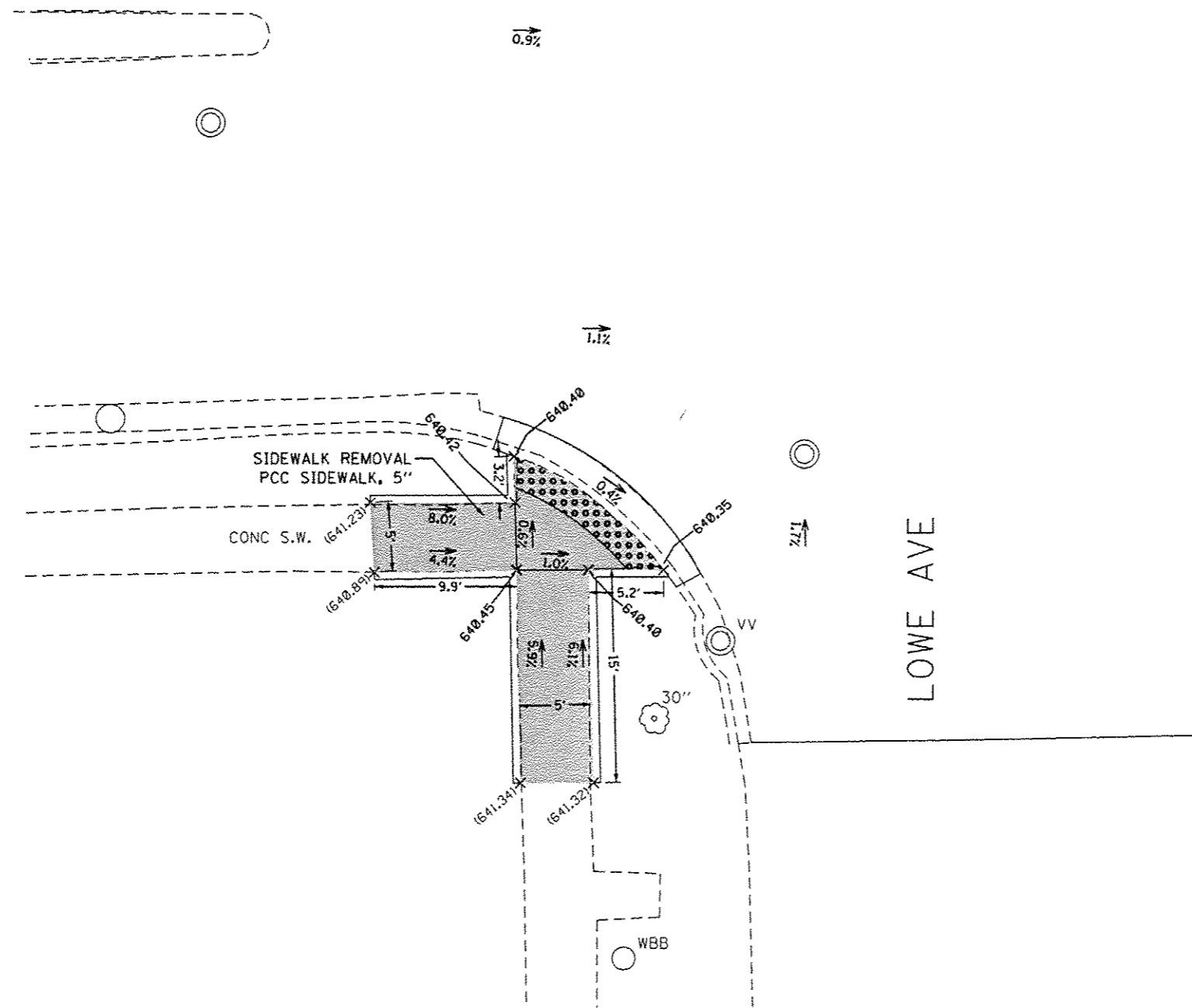

REFERENCE BENCH MARK ELEV 643.08
 BENCHMARK : CUT X
 LOCATION : S'LY FLANGE BOLT OF FH AT NW QUAD OF JOE ORR RD AND LOWE AVE

LEGEND	
xx.xx'	EXISTING LENGTH
=====	PROPOSED SIDE CURB
()	EXISTING ELEVATION/SLOPE
[Shaded Box]	PROPOSED SIDEWALK
[Dotted Box]	DETECTABLE WARNINGS
[Cross-hatched Box]	SIDEWALK REMOVAL REPLACE W/TOPSOIL & SOD

FILE NAME :	USER NAME :	DESIGNED :	REVISED :
pu\1\084EBIDINTEG\Illinois.gov\PI001\Do	usants\1001 Offices\District 1\Projects\01302	BRW\Browns\Design\0136216-shr-details.dgn	REVISED -
Default	PLOT SCALE :	CHECKED :	REVISED :
	10,000 / in.	-	-
	PLOT DATE :	DATE :	REVISED :
	5/26/2017	-	-

**STATE OF ILLINOIS
 DEPARTMENT OF TRANSPORTATION**

**ADA RAMP DETAILS (JOE ORR RD AND LOWE AVE)
 JOE ORR RD (ASHLAND AVE TO STATE ST)**

SCALE: 1"=5' SHEET OF SHEETS STA. TO STA.

F.A.U. RTE.	SECTION	COUNTY	TOTAL SHEETS	SHEET NO.
1631	0404.1-RS	COOK	27	170
CONTRACT NO. 62C55			ILLINOIS FED. AID PROJECT	

Sheet Added 6-6-17

NOTE:
GUTTER FLAG SLOPE IS 5% UNLESS SHOWN OTHERWISE

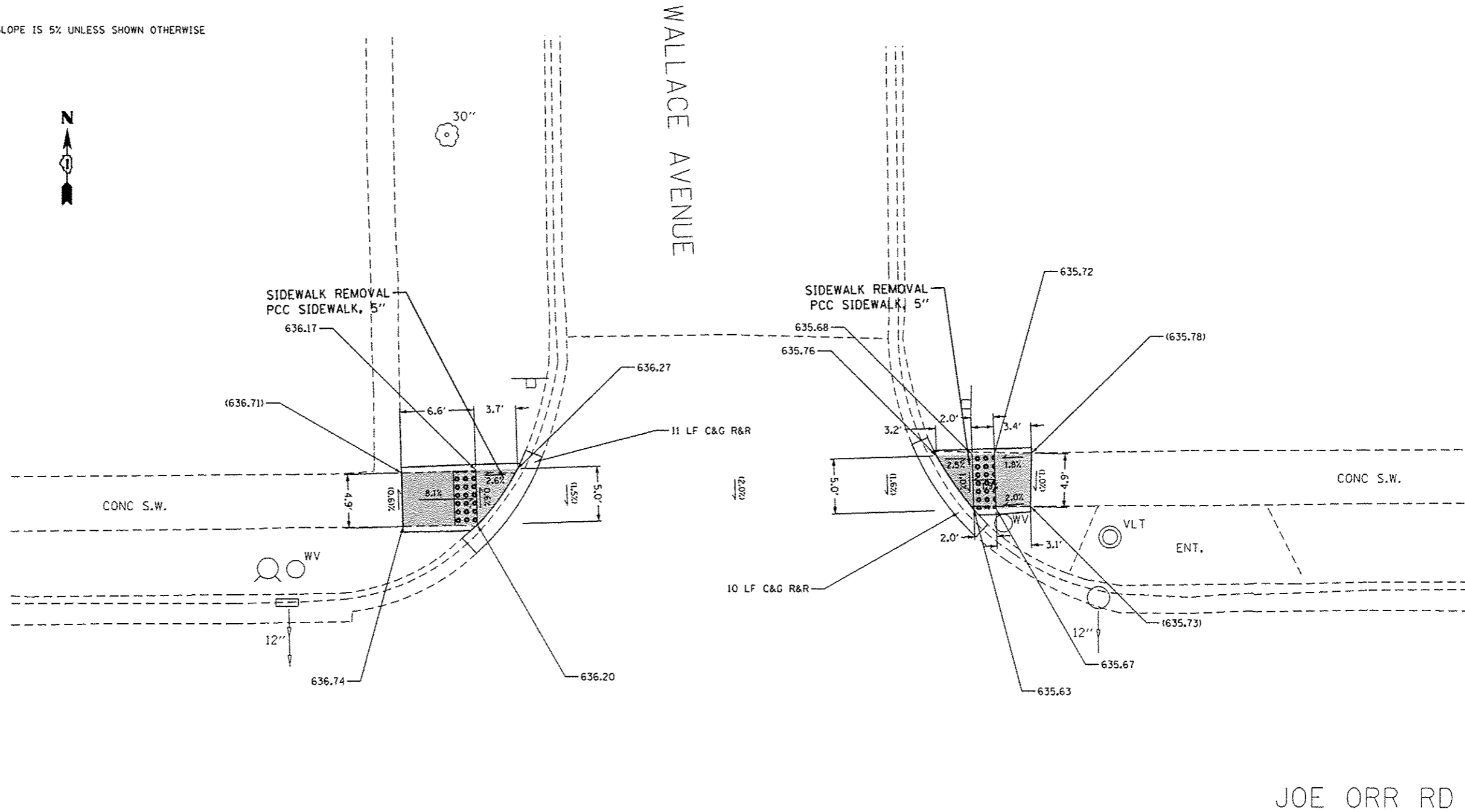

REFERENCE BENCH MARK ELEV 638.633
 BENCHMARK : CUT X ON S FLANGE BOLT OF FIRE HYDRANT
 LOCATION : FIRE HYDRANT ON NW CORNER OF JOE ORR RD AND WALLACE AVE 5'
 FROM JOE ORR RD EOP

LEGEND

- xx.xx' EXISTING LENGTH
- PROPOSED SIDE CURB
- () EXISTING ELEVATION/SLOPE
- PROPOSED SIDEWALK
- DETECTABLE WARNINGS
- SIDEWALK REMOVAL REPLACE W/TOPSOIL & SOD

REFERENCE BENCH MARK ELEV 638.633
 BENCHMARK : CUT X ON S FLANGE BOLT OF FIRE HYDRANT
 LOCATION : FIRE HYDRANT ON NW CORNER OF JOE ORR RD AND WALLACE AVE 5'
 FROM JOE ORR RD EOP

FILE NAME	USER NAME = lodesmarn	DESIGNED -	REVISED -	STATE OF ILLINOIS DEPARTMENT OF TRANSPORTATION	ADA RAMP DETAILS (JOE ORR RD AND WALLACE AVE) JOE ORR RD (ASHLAND AVE TO STATE ST)	F.A.G. RTE.	SECTION	COUNTY	TOTAL SHEETS	SHEET NO.	
<small>\\IL04EB10INTEG\illinois.gov\p\idot\Documents\DOT Offices\District 1\Projects\DI36216\Design\DI36216-shr-details.02</small>						1631	0404.1-RS	COOK	27	17P	
<small>PLOT SCALE = 10,0000' / in.</small>						CONTRACT NO. 62C55					
<small>PLOT DATE = 5/26/2017</small>						ILLINOIS FED. AID PROJECT					

Sheet Added 6-6-17

NOTE:
GUTTER FLAG SLOPE IS 5% UNLESS SHOWN OTHERWISE

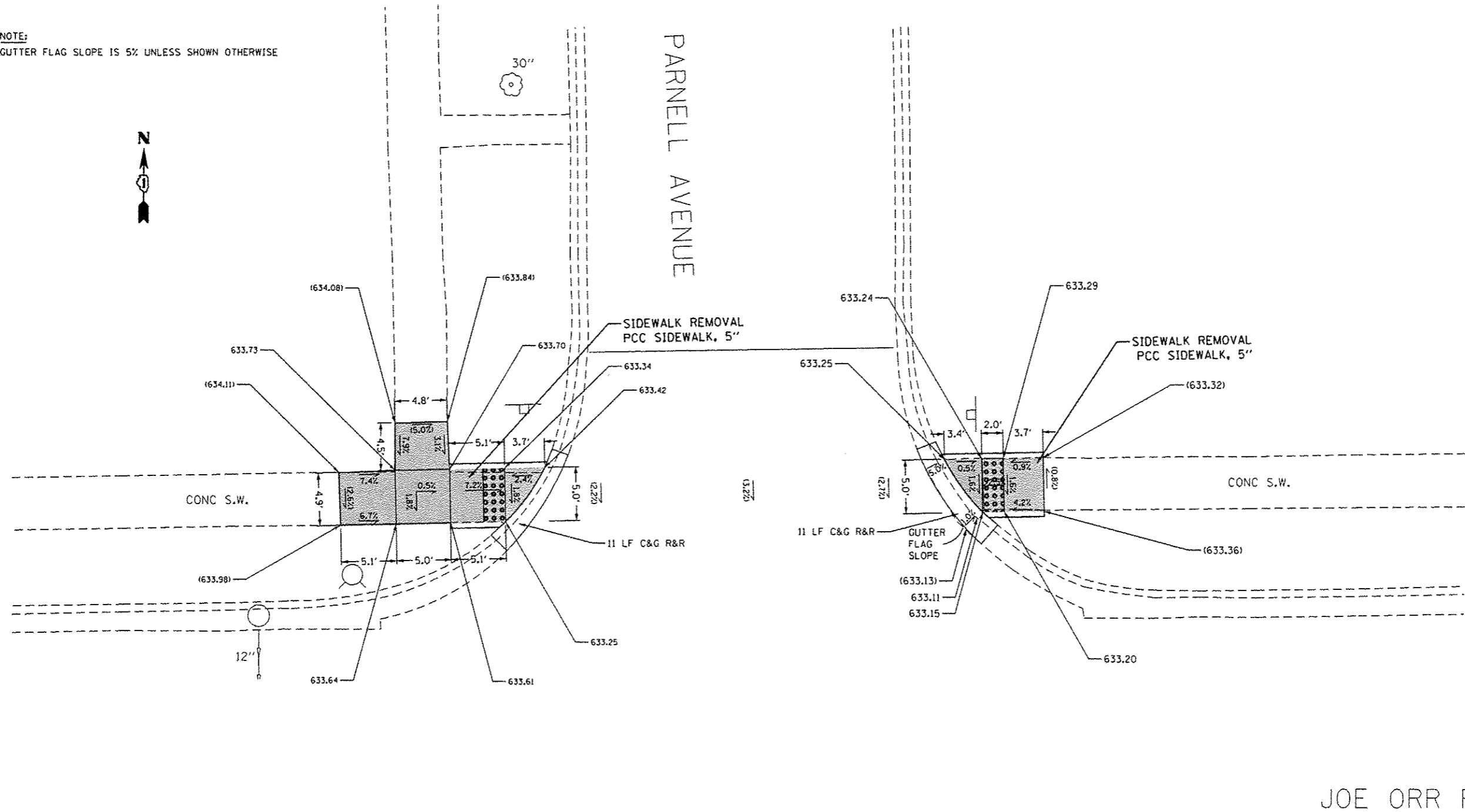

JOE ORR RD

<p>REFERENCE BENCH MARK ELEV 635.540</p> <p>BENCHMARK : CUT X ON N FLANGE BOLT OF FIRE HYDRANT</p> <p>LOCATION : FIRE HYDRANT ON NW CORNER OF JOE ORR RD AND PARNELL AVE ABOUT 5 FT FROM JOE ORR RD EOP</p>	<p>LEGEND</p> <p>xx.xx' EXISTING LENGTH</p> <p>===== PROPOSED SIDE CURB</p> <p>() EXISTING ELEVATION/SLOPE</p> <p>■ PROPOSED SIDEWALK</p> <p>●●●● DETECTABLE WARNINGS</p> <p>⊗ SIDEWALK REMOVAL REPLACE W/TOPSOIL & SOD</p>	<p>REFERENCE BENCH MARK ELEV 635.540</p> <p>BENCHMARK : CUT X ON N FLANGE BOLT OF FIRE HYDRANT</p> <p>LOCATION : FIRE HYDRANT ON NW CORNER OF JOE ORR RD AND PARNELL AVE ABOUT 5 FT FROM JOE ORR RD EOP</p>	<p>STATE OF ILLINOIS</p> <p>DEPARTMENT OF TRANSPORTATION</p>	<p>ADA RAMP DETAILS (JOE ORR RD AND PARNELL AVE)</p> <p>JOE ORR RD (ASHLAND AVE TO STATE ST)</p> <p>SCALE: 1"=5'</p>	<table border="1" style="font-size: 8px;"> <tr> <td>F.A.U. RTE.</td> <td>SECTION</td> <td>COUNTY</td> <td>TOTAL SHEETS</td> <td>SHEET NO.</td> </tr> <tr> <td>1631</td> <td>0404.1-RS</td> <td>COOK</td> <td>27</td> <td>170</td> </tr> <tr> <td colspan="3">CONTRACT NO. 62C55</td> <td colspan="2">ILLINOIS FED. AID PROJECT</td> </tr> </table>	F.A.U. RTE.	SECTION	COUNTY	TOTAL SHEETS	SHEET NO.	1631	0404.1-RS	COOK	27	170	CONTRACT NO. 62C55			ILLINOIS FED. AID PROJECT					
F.A.U. RTE.	SECTION	COUNTY	TOTAL SHEETS	SHEET NO.																				
1631	0404.1-RS	COOK	27	170																				
CONTRACT NO. 62C55			ILLINOIS FED. AID PROJECT																					
<table border="1" style="width: 100%;"> <tr> <td>FILE NAME =</td> <td>USER NAME = jedeznorm</td> <td>DESIGNED -</td> <td>REVISED -</td> </tr> <tr> <td>p:\11\004EBID\HTEG\Illinois.gov\PH\DOT\Documents\DOT Offices\District 1\Projects\01362\01362\Auto\Design\0136216-shi-details.02</td> <td></td> <td>CHECKED -</td> <td>REVISED -</td> </tr> <tr> <td>Default</td> <td></td> <td>DATE -</td> <td>REVISED -</td> </tr> <tr> <td></td> <td>PLOT SCALE = 10,0000 / in.</td> <td></td> <td></td> </tr> <tr> <td></td> <td>PLOT DATE = 5/26/2017</td> <td></td> <td></td> </tr> </table>	FILE NAME =	USER NAME = jedeznorm	DESIGNED -	REVISED -	p:\11\004EBID\HTEG\Illinois.gov\PH\DOT\Documents\DOT Offices\District 1\Projects\01362\01362\Auto\Design\0136216-shi-details.02		CHECKED -	REVISED -	Default		DATE -	REVISED -		PLOT SCALE = 10,0000 / in.				PLOT DATE = 5/26/2017						
FILE NAME =	USER NAME = jedeznorm	DESIGNED -	REVISED -																					
p:\11\004EBID\HTEG\Illinois.gov\PH\DOT\Documents\DOT Offices\District 1\Projects\01362\01362\Auto\Design\0136216-shi-details.02		CHECKED -	REVISED -																					
Default		DATE -	REVISED -																					
	PLOT SCALE = 10,0000 / in.																							
	PLOT DATE = 5/26/2017																							

△ Sheet Added 6-6-17

NOTE:
GUTTER FLAG SLOPE IS 5% UNLESS SHOWN OTHERWISE



NORMAL AVENUE

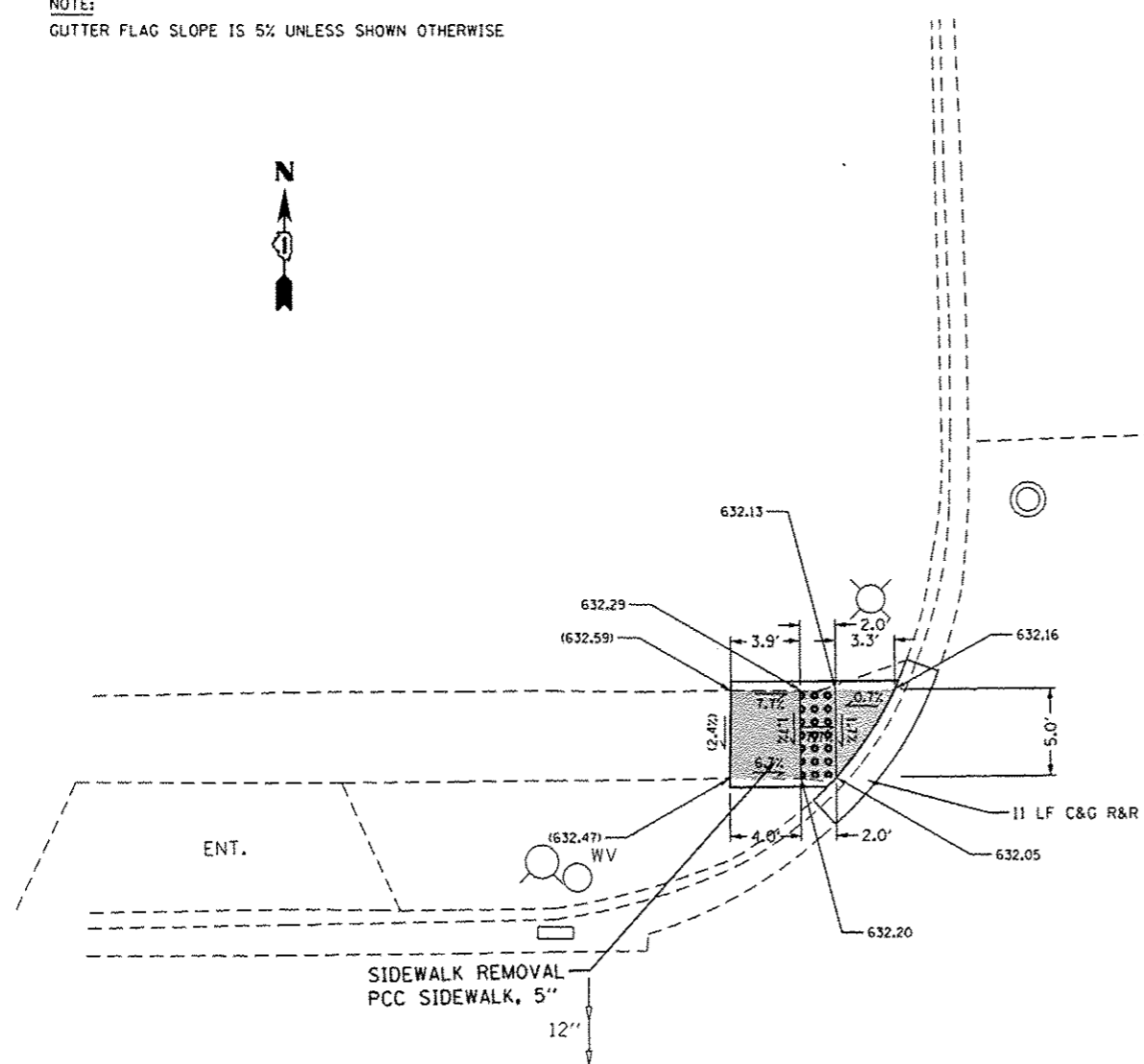

JOE ORR RD

REFERENCE BENCH MARK ELEV 633.372
 BENCHMARK : CUT X ON NE FLANGE BOLT OF FIRE HYDRANT
 LOCATION : FIRE HYDRANT ON NW CORNER OF JOE ORR RD AND NORMAL AVE ABOUT 5 FT FROM JOE RD EOP

LEGEND

- xxx.xx' EXISTING LENGTH
- ===== PROPOSED SIDE CURB
- () EXISTING ELEVATION/SLOPE
- PROPOSED SIDEWALK
- DETECTABLE WARNINGS
- SIDEWALK REMOVAL REPLACE W/TOPSOIL & SOD

FILE NAME *	USER NAME = ladezmorn	DESIGNED -	REVISED -
Documents\1007 Offices\District 1\Projects\DI36216\ent\details.02		REVISOR =	REVISOR =
		CHECKED -	REVISED -
		DATE -	REVISED -

**STATE OF ILLINOIS
DEPARTMENT OF TRANSPORTATION**

**ADA RAMP DETAILS (JOE ORR RD AND NORMAL AVE)
JOE ORR RD (ASHLAND AVE TO STATE ST)**

SCALE: 1"=5' SHEET OF SHEETS STA. TO STA.

F.A.U. RTE.	SECTION	COUNTY	TOTAL SHEETS	SHEET NO.
1631	0404.1-RS	COOK	27	17R
				CONTRACT NO. 62C55
ILLINOIS FED. AID PROJECT				

A Sheet Added 6-6-17

NOTE:
GUTTER FLAG SLOPE IS 5% UNLESS SHOWN OTHERWISE

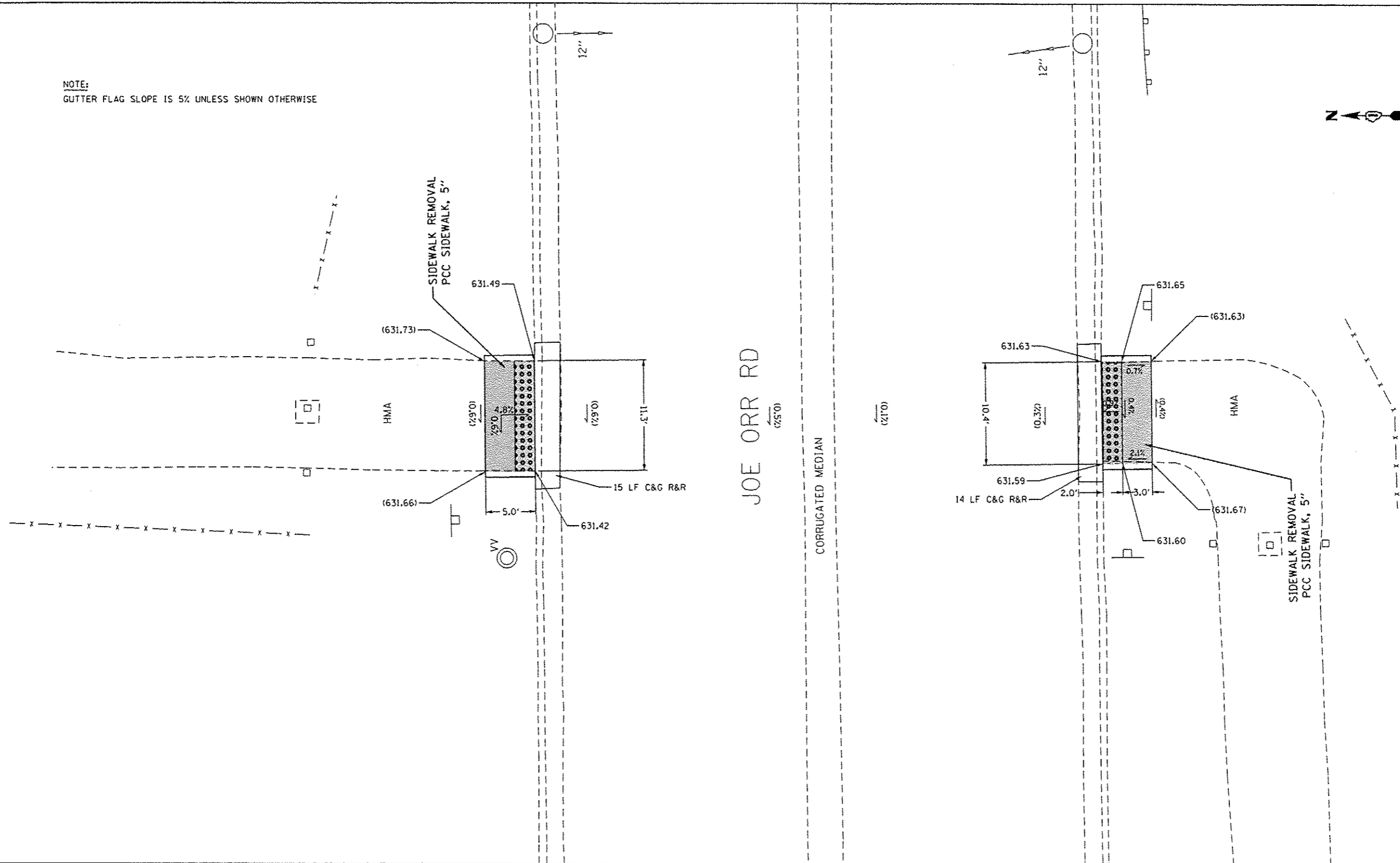

REFERENCE BENCH MARK ELEV 632.050

BENCHMARK : SET MAG NAIL ON N SIDE OF BIKE PATH

LOCATION : BIKE PATH ON S SIDE OF JOE ORR RD ABOUT 100 FT WEST OF BIKE PATH CROSSING

LEGEND

- xx.xx' EXISTING LENGTH
- PROPOSED SIDE CURB
- () EXISTING ELEVATION/SLOPE
- PROPOSED SIDEWALK
- DETECTABLE WARNINGS
- SIDEWALK REMOVAL REPLACE W/TOPSOIL & SOD

REFERENCE BENCH MARK ELEV 632.050

BENCHMARK : SET MAG NAIL ON N SIDE OF BIKE PATH

LOCATION : BIKE PATH ON S SIDE OF JOE ORR RD ABOUT 100 FT WEST OF BIKE PATH CROSSING

FILE NAME :	USER NAME :	DESIGNED :	REVISED :
p:\110804EB10\INTEG.illinois.gov\WIDOT\Documents\DOT Offices\District 1\Projects\0136216\Design\0136216-ramp-details.02	Jedezmann	-	-
PLLOT SCALE :	CHECKED :	DATE :	REVISED :
10.0000' / 1"	-	-	-
PLLOT DATE :	DATE :	REVISED :	REVISED :
5/26/2017	-	-	-

**STATE OF ILLINOIS
DEPARTMENT OF TRANSPORTATION**

**ADA RAMP DETAILS (JOE ORR RD AND THORN CREEK TRAIL)
JOE ORR RD (ASHLAND AVE TO STATE ST)**

SCALE: 1"=5' SHEET OF SHEETS STA. TO STA.

F.A.U. RTE.	SECTION	COUNTY	TOTAL SHEETS	SHEET NO.
1631	0404.1-R5	COOK	27	175
CONTRACT NO. 62C55			ILLINOIS FED. AID PROJECT	

Sheet Added 6-6-17

SCHEDULE OF QUANTITIES FOR ADA PEDESTRIAN RAMPS

CROSS STREET	PCC SIDEWALK, 5" (SF)	SIDEWALK REMOVAL (SF)	CC&G R&R (LF)	DETECTABLE WARNINGS (SF)	F&G ADJUST (EA)	MAINTENANCE OF EXIST TRAFFIC SIGNAL INSTALLATION (EA)	REBUILD HANDHOLE (EA)
Ashland	934	934	142	134.2	0	1	2
Willow Dr	333	333	21	20	0	0	0
De Angelis Ct	258	258	21	20	0	0	0
Bus Shelter	67	67	18	9.2	0	0	0
Coolidge St	719.6	692	43.5	23.2	0	0	0
Sangamon St	465	465	35	23.8	0	0	0
Halsted St	347	347	35	39	0	1	1
Emerald Ave	532	532	111.5	69.2	2	0	0
Union ave	469	495	110.5	61	1	0	0
Lowe Ave	522	582	53	53.2	0	0	0
Wallace Ave	77	77	21	20	0	0	0
Parnell Ave	146	146	21	20	0	0	0
Normal Ave	39	39	10.5	10	0	0	0
Thorncreek Trail	110	110	29	43.4	0	0	0

FILE NAME *	USER NAME * ledazmorn	DESIGNED -	REVISED -	STATE OF ILLINOIS DEPARTMENT OF TRANSPORTATION	ADA RAMP DETAILS (JOE ORR RD AND ASHLAND AVE) JOE ORR RD (ASHLAND AVE TO STATE ST)	F.A.U. RTE.	SECTION	COUNTY	TOTAL SHEETS	SHEET NO.	
pw\14804EBIDINTEG-illinois.gov\PI\DOT\Documents\1001 Offices\District 1\Projects\0136	BRW	DATE	DESIGN			1631	0404.1-RS	COOK	27	17T	
PLT SCALE * 10.0000 ' / in.	CHECKED -	REVISED -	SCALE: 1"=5'			SHEET	OF	SHEETS	STA.	TO STA.	ILLINOIS FED. AID PROJECT
Default	PLT DATE * 5/26/2017	DATE -	REVISED -			CONTRACT NO. 62C55					

△ Sheet Added 6-6-17