

STATE OF ILLINOIS  
DEPARTMENT OF TRANSPORTATION

F.A.I. RTE.	SECTION	COUNTY	TOTAL SHEETS	SHEET NO.
70	(12-53)RA-2	CLARK	19	1
		ILLINOIS	CONTRACT NO. 74788	

FOR INDEX OF SHEETS, SEE SHEET NO. 2

ADT = 22,000 (2015)

# PROPOSED HIGHWAY PLANS

FAI ROUTE 70 (I-70)  
SECTION (12-53)RA-2

REST AREA IMPROVEMENT  
CLARK COUNTY

C-97-019-17

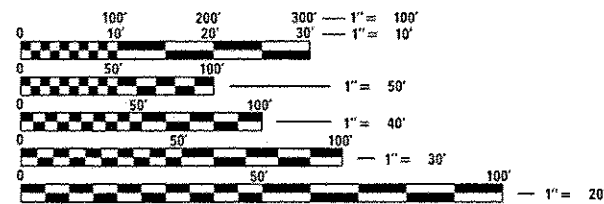
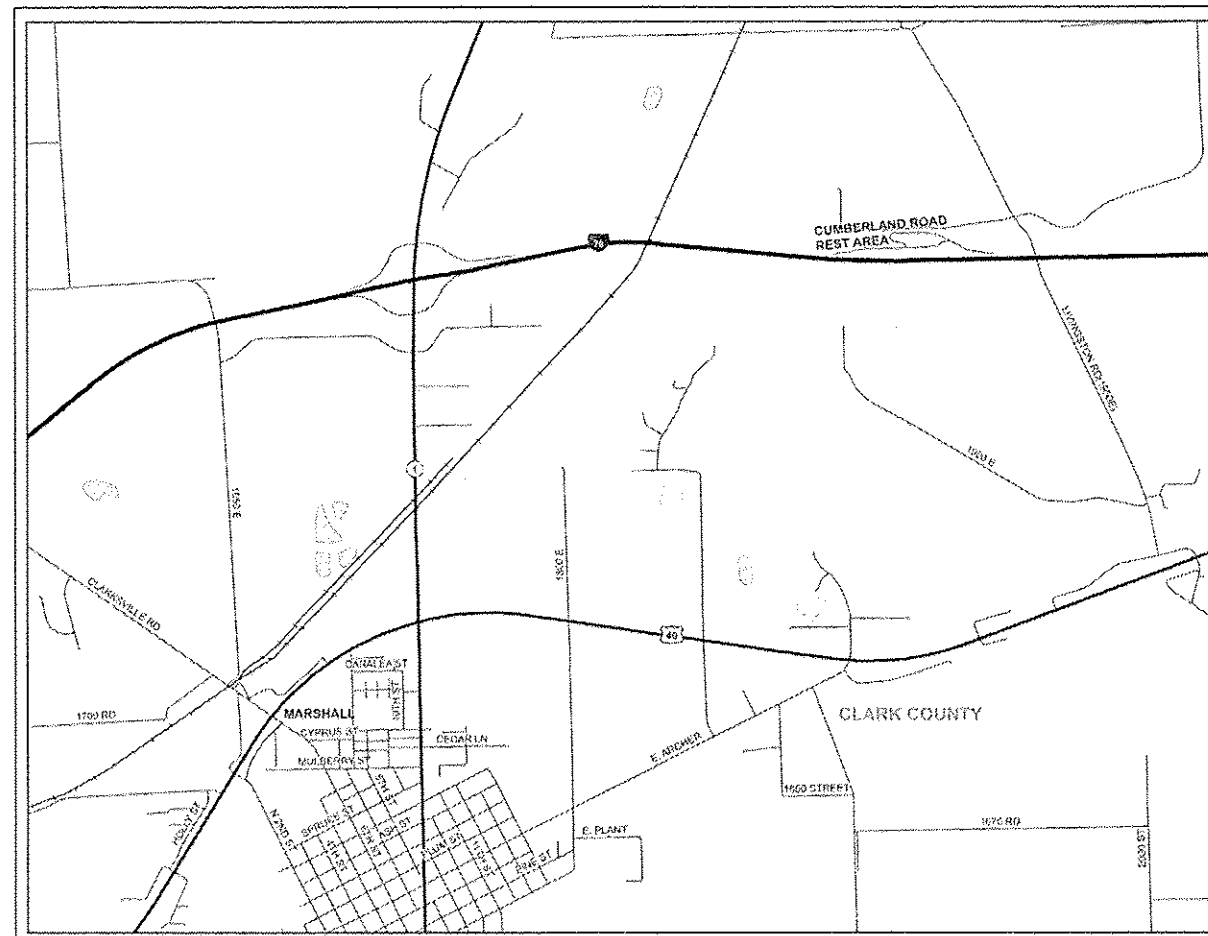
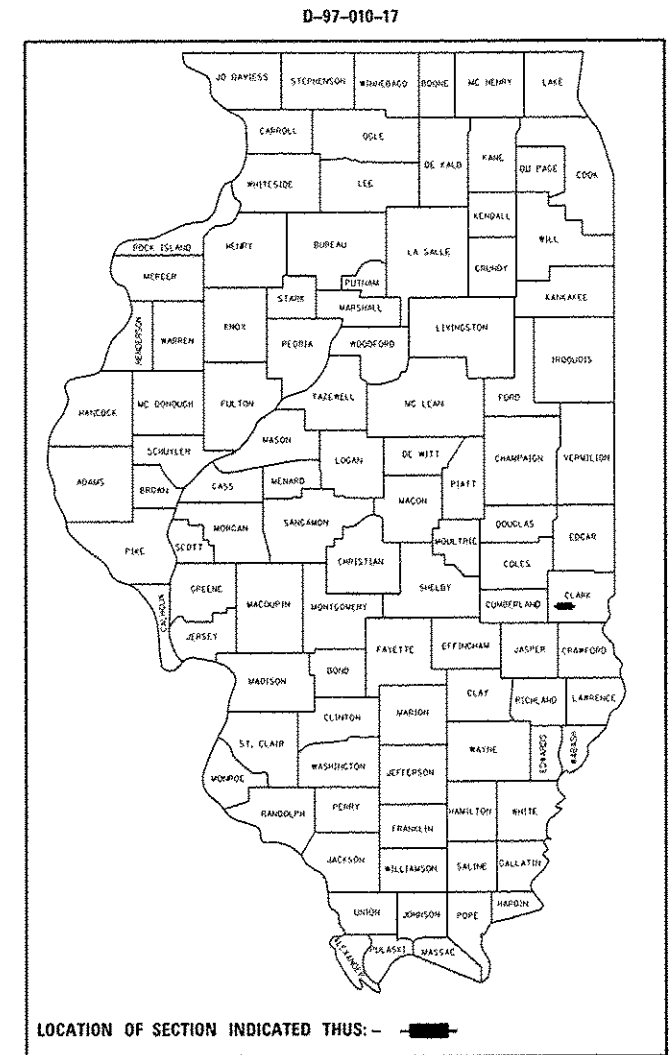

FULL SIZE PLANS HAVE BEEN PREPARED USING STANDARD ENGINEERING SCALES. REDUCED SIZED PLANS WILL NOT CONFORM TO STANDARD SCALES. IN MAKING MEASUREMENTS ON REDUCED PLANS, THE ABOVE SCALES MAY BE USED.

J.U.L.I.E.  
JOINT UTILITY LOCATION INFORMATION FOR EXCAVATION  
1-800-892-0123  
OR 811

PROJECT ENGINEER: TOM RONAN  
PROJECT MANAGER: KALEB HIRTZEL

CONTRACT NO. 74788

STATE OF ILLINOIS  
DEPARTMENT OF TRANSPORTATION

SUBMITTED April 7 2017  
Jeffrey M. South  
REGIONAL ENGINEER

May 12 2017  
Maureen M. Addis  
ENGINEER OF DESIGN AND ENVIRONMENT

May 12 2017  
Michael J. [Signature]  
DIRECTOR OF PROGRAM DEVELOPMENT

PRINTED BY THE AUTHORITY  
OF THE STATE OF ILLINOIS

## INDEX OF SHEETS

SHEET NO.	ITEM
1	COVER SHEET
2	INDEX OF SHEETS, LIST OF HIGHWAY STANDARDS AND GENERAL NOTES
3	SUMMARY OF QUANTITIES
4	TYPICAL SECTIONS
5	SCHEDULE OF QUANTITIES
6-9	REMOVAL PLANS
10-12	SIDEWALK AND PAVEMENT PLAN
13-15	GRADING PLAN
16-18	PAVEMENT MARKING AND SIGNAGE PLAN
19	DISTRICT DETAILS

THE FOLLOWING STANDARDS ARE A PART OF THESE PLANS AND ARE INCLUDED AFTER SHEET NO. 19:

STD. NO.	DESCRIPTION
000001-06	STANDARD SYMBOLS, ABBREVIATIONS AND PATTERNS
001001-02	AREAS OF REINFORCEMENT BARS
001006	DECIMAL OF AN INCH AND OF A FOOT
420001-08	PAVEMENT JOINTS
420101-05	24' JOINTED PCC PAVEMENT
424001-09	PERPENDICULAR CURB RAMPS
606001-06	CONCRETE CURB TYPE B AND COMBINATION CONCRETE CURB AND GUTTER
701451-04	RAMP CLOSURE FREEWAY/EXPRESSWAY
701901-06	TRAFFIC CONTROL DEVICES
780001-05	TYPICAL PAVEMENT MARKINGS
725001-01	OBJECT AND TERMINAL MARKERS
728001-01	TELESCOPING STEEL SIGN SUPPORT
780001-05	TYPICAL PAVEMENT MARKINGS
781001-04	TYPICAL APPLICATIONS RAISED REFLECTIVE PAVEMENT MARKERS
782006	GUARDRAIL AND BARRIER WALL REFLECTOR MOUNTING DETAILS
805001-01	ELECTRICAL SERVICE INSTALLATION DETAILS

## GENERAL NOTES

THIS SECTION SHALL BE CONSTRUCTED IN ACCORDANCE WITH THE PLANS; THE "STANDARD SPECIFICATIONS FOR ROAD AND BRIDGE CONSTRUCTION", ADOPTED APRIL 1, 2016; THE "SUPPLEMENTAL SPECIFICATIONS AND RECURRING SPECIAL PROVISIONS", ADOPTED JANUARY 1, 2017, AND THE SPECIAL PROVISIONS INCLUDED IN THE PROPOSAL.

THE WORK INCLUDED IN THIS SECTION IS LOCATED AT THE WESTBOUND CUMBERLAND ROAD REST AREA. THE REST AREA IS LOCATED ON I-70 IN CLARK COUNTY. THE WORK INCLUDED IN THIS SECTION CONSISTS OF SIDEWALK REMOVAL, CONSTRUCTION OF ADA RAMPS, EARTHWORK, CURB & GUTTER REMOVAL AND REPLACEMENT, TRAFFIC CONTROL, AND ANY OTHER WORK NECESSARY TO COMPLETE THIS SECTION.

ALL ELEVATIONS SHOWN IN THE PLANS ARE BASED ON NORTH AMERICA VERTICAL DATUM OF 1988 (NAVD88).

THE PROPOSED SIDEWALKS AND SIDEWALK REMOVAL WILL REQUIRE GRADING AND SHAPING TO BLEND THE SIDEWALK IN WITH THE EXISTING TERRAIN TO THE SATISFACTION OF THE ENGINEER. ALL DISTURBED AREAS WILL REQUIRE SEEDING, CLASS 2 AS WELL AS NITROGEN, PHOSPHORUS AND POTASSIUM FERTILIZER NUTRIENTS. THE APPLICATION OF THE REQUIRED SEEDING AND FERTILIZER NUTRIENTS SHALL CONFORM TO ARTICLE 250 OF THE STANDARD SPECIFICATIONS. THE GRADING AND SHAPING, SEEDING AND FERTILIZERS SHALL NOT BE PAID FOR SEPARATELY BUT SHALL BE INCLUDED IN THE COSTS OF PORTLAND CEMENT CONCRETE SIDEWALK, 5".

THE LOCATIONS OF THE PAVEMENT JOINTS FOR THE PROPOSED PORTLAND CEMENT CONCRETE PAVEMENT, 12" (JOINTED) SHALL MATCH THE EXISTING JOINT LOCATIONS OF THE PARKING LOTS OF THE REST AREA.

EACH PARKING STALL IN THE REST AREA SHALL RECEIVE NEW PAVEMENT MARKINGS. THE REMOVAL OF THE EXISTING PAVEMENT MARKINGS SHALL NOT BE PAID FOR SEPARATELY BUT SHALL BE INCLUDED IN THE COST OF GROOVING FOR RECESSED PAVEMENT MARKINGS PAY ITEMS EXCEPT IN LOCATIONS THAT SPECIFY PAVEMENT MARKING REMOVAL - WATER BLASTING AS SHOWN IN THE PLANS.

THE FOLLOWING RATES OF APPLICATION HAVE BEEN USED IN CALCULATING PLAN QUANTITIES:

GRANULAR MATERIAL                      2.05 TONS/CU YD

FILE NAME =	USER NAME = steffenmk	DESIGNED -	REVISED -	<b>STATE OF ILLINOIS DEPARTMENT OF TRANSPORTATION</b>	<b>INDEX, STANDARDS AND GENERAL NOTES</b>	F.A.I. RTE.	SECTION	COUNTY	TOTAL SHEETS	SHEET NO.
						70	(12-53)RA-2	CLARK	19	2
						CONTRACT NO. 74788				
Default	PLOT SCALE = 100.0000' / in.	CHECKED -	REVISED -	SCALE: N/A	SHEET 1 OF 1 SHEETS	STA.	TO STA.	ILLINOIS FED. AID PROJECT		
	PLOT DATE = 4/7/2017	DATE -	REVISED -							

RURAL

RURAL

SUMMARY OF QUANTITIES			TOTAL QUANTITIES	CONSTRUCTION TYPE CODE		
CODE NO	ITEM	UNIT		STATE 100% 0021		
42000541	PORTLAND CEMENT CONCRETE PAVEMENT 12" (JOINTED)	SO YD	514	514		
42400200	PORTLAND CEMENT CONCRETE SIDEWALK 5 INCH	SO FT	6266	6266		
42400300	PORTLAND CEMENT CONCRETE SIDEWALK 6 INCH	SO FT	288	288		
44000100	PAVEMENT REMOVAL	SO YD	516	516		
44000500	COMBINATION CURB AND GUTTER REMOVAL	FOOT	242	242		
44000600	SIDEWALK REMOVAL	SO FT	6185	6185		
44213204	TIE BARS 3/4"	EACH	60	60		
60604400	COMBINATION CONCRETE CURB AND GUTTER, TYPE B-6.18	FOOT	176	176		
67000500	ENGINEER'S FIELD OFFICE, TYPE B	CAL MO	2	2		
67100100	MOBILIZATION	LSUM	1	1		
70100820	TRAFFIC CONTROL AND PROTECTION, STANDARD 701451	LSUM	1	1		
* 78009000	MODIFIED URETHANE PAVEMENT MARKING - LETTERS AND SYMBOLS	SO FT	18.4	18.4		

SUMMARY OF QUANTITIES			TOTAL QUANTITIES	CONSTRUCTION TYPE CODE		
CODE NO	ITEM	UNIT		STATE 100% 0021		
* 78009004	MODIFIED URETHANE PAVEMENT MARKING - LINE 4"	FOOT	6749	6749		
X0327008	REMOVE AND RELOCATE SIGN (SPECIAL)	EACH	3	3		
X0327980	PAVEMENT MARKING REMOVAL - WATER BLASTING	SO FT	162	162		
X6060064	COMBINATION CONCRETE CURB AND GUTTER, TYPE B-9.18 (SPECIAL)	FOOT	65.5	65.5		
* X7301035	SIGN POST - SERIES 218	FOOT	19	19		
* X7830060	GROOVING FOR RECESSED PAVEMENT MARKING, LETTERS AND SYMBOLS	SO FT	18.4	18.4		
* X7830070	GROOVING FOR RECESSED PAVEMENT MARKING 5"	FOOT	6749	6749		

\* SPECIALTY ITEM

EXISTING CAR PARKING TYPICAL SECTION

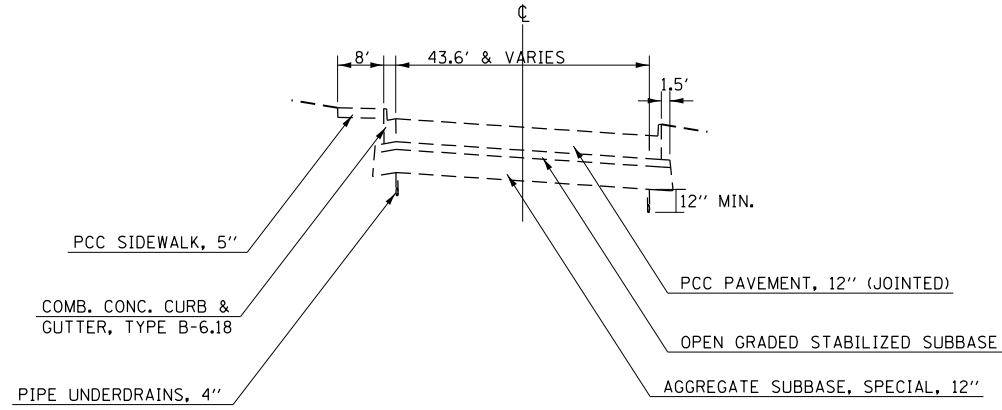

EXISTING TRUCK PARKING TYPICAL SECTION

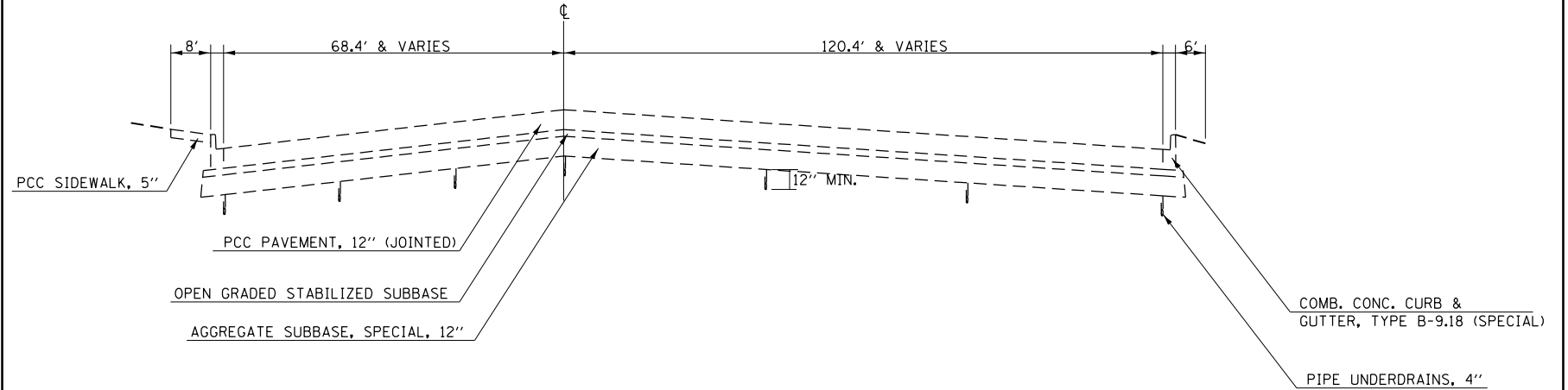

PROPOSED CAR PARKING TYPICAL SECTION

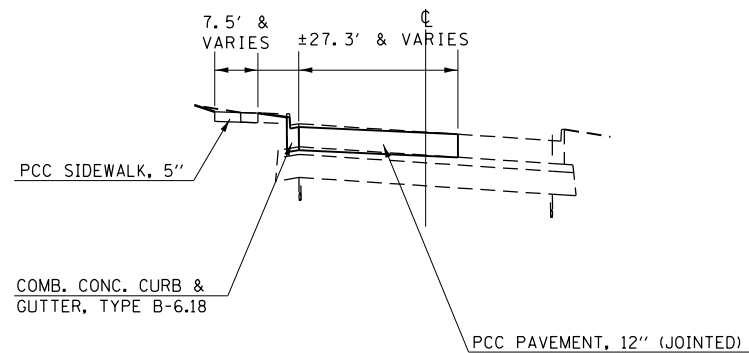

PROPOSED TRUCK PARKING TYPICAL SECTION

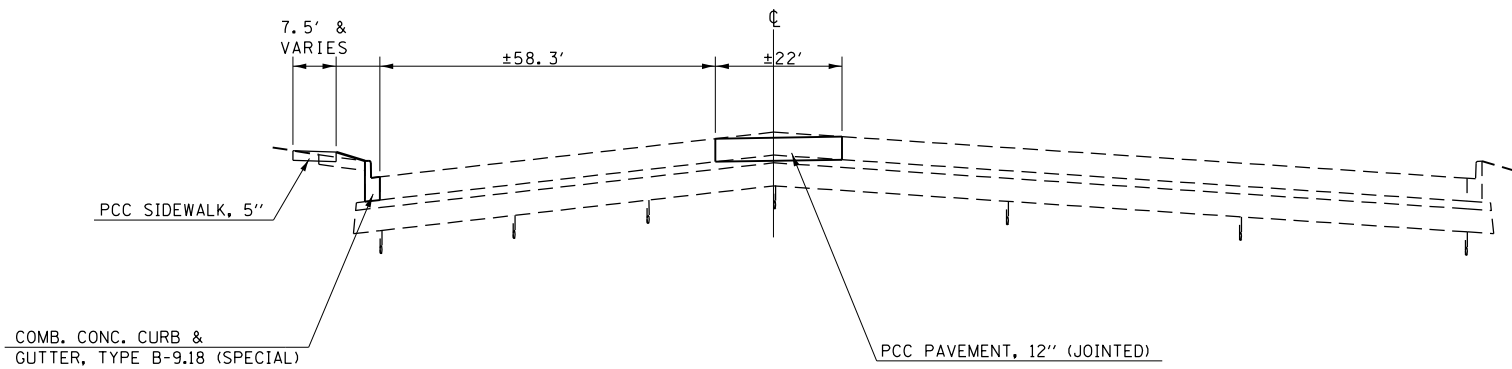

FILE NAME =	USER NAME = steffenmk	DESIGNED -	REVISED -
p:\11\084EBIDINTEG.illinois.gov\PI\DOT\Documents\IDOT Offices\District 7\Projects\74788\Drawings\CAD\Drawings\74788-shr-typical.dwg		DRAWN -	REVISED -
Default	PLOT SCALE = 100.0000' / 1in.	CHECKED -	REVISED -
	PLOT DATE = 4/7/2017	DATE -	REVISED -

**STATE OF ILLINOIS  
DEPARTMENT OF TRANSPORTATION**

**TYPICAL CROSS SECTIONS**

SCALE: N/A SHEET 1 OF 1 SHEETS STA. TO STA.

F.A.I. RTE.	SECTION	COUNTY	TOTAL SHEETS	SHEET NO.
70	(12-53)RA-2	CLARK	19	4
CONTRACT NO. 74788			ILLINOIS FED. AID PROJECT	

SIDEWALK SCHEDULE	PORTLAND CEMENT CONCRETE SIDEWALK, 5"	PORTLAND CEMENT CONCRETE SIDEWALK, 6"
	SQ FT	SQ FT
CAR PARKING		
SIDEWALK	2569.8	-
TRASH RECEPTICLES	45.0	-
PICNIC AREA	-	288.0
TOTALS:	2614.8	288.0
TRUCK PARKING		
SIDEWALK	3595.5	-
TRASH RECEPTICLES	27.0	-
RECYCLING BINS	28.1	-
TOTALS:	3650.6	0.0
PROJECT TOTALS:	6266	288

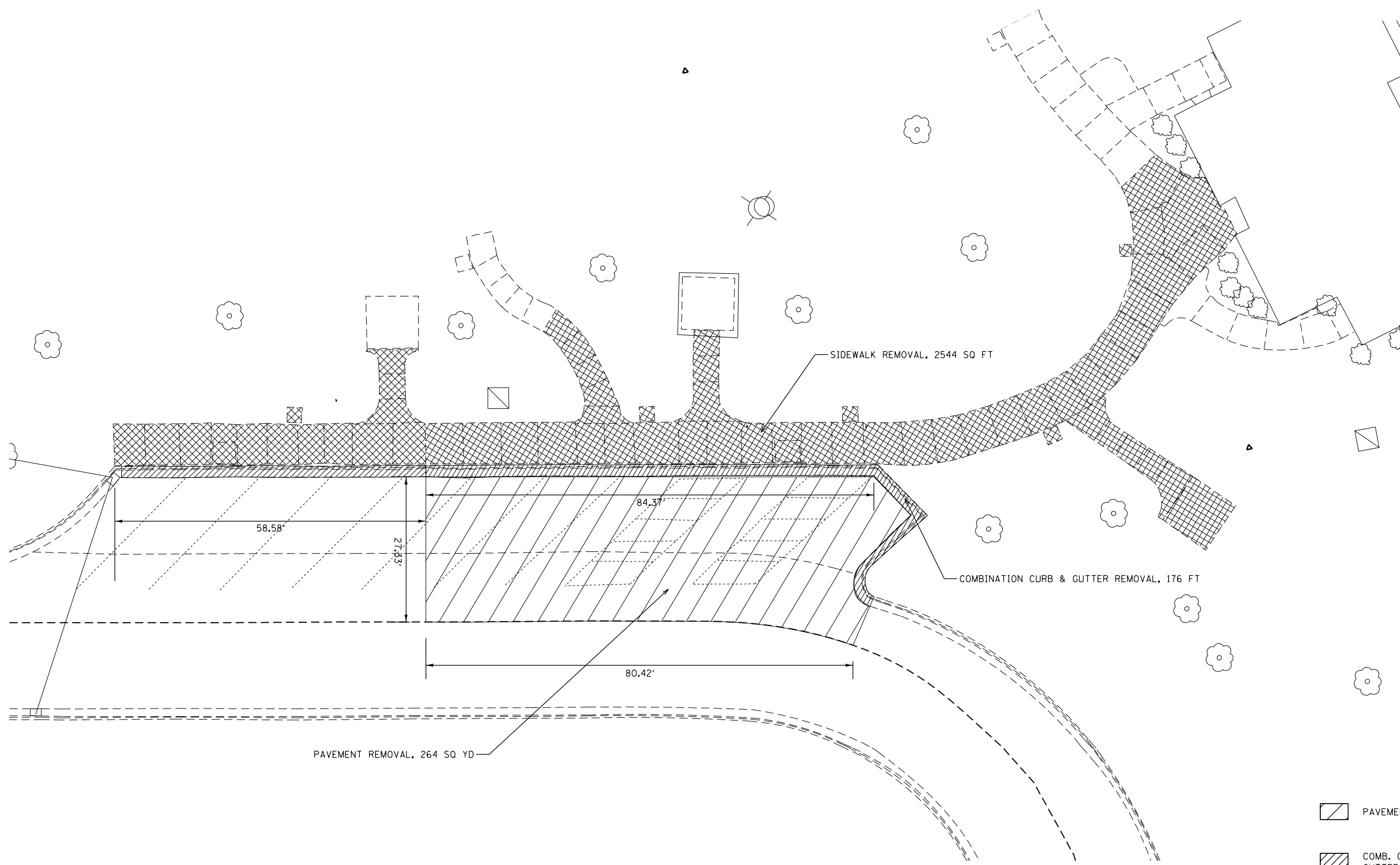

PAVEMENT MARKING SCHEDULE	PAVEMENT MARKING REMOVAL - WATER BLASTING	MODIFIED URETHANE PAVEMENT MARKING - LETTERS & SYMBOLS	GROOVING FOR RECESSED PAVEMENT MARKING, LETTERS & SYMBOLS	MODIFIED URETHANE PAVEMENT MARKING - LINE 4"	GROOVING FOR RECESSED PAVEMENT MARKING, 5"
	SQ FT	SQ FT	SQ FT	FOOT	FOOT
CAR PARKING	161.5	9.2	9.2	1493.0	1493.0
TRUCK PARKING	-	9.2	9.2	5256.0	5256.0
TOTALS:	162	18.4	18.4	6749	6749



PAVEMENT REMOVAL, 264 SQ YD

SIDEWALK REMOVAL, 2544 SQ FT

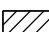
COMBINATION CURB & GUTTER REMOVAL, 176 FT

-  PAVEMENT REMOVAL
-  COMB. CURB & GUTTER REMOVAL
-  SIDEWALK REMOVAL

FILE NAME =	USER NAME = steffenmk	DESIGNED -	REVISED -
pw:\IL\084EBIDINTEG.illinois.gov\PWIDOT\Documents\IDOT Offices\District 7\Projects\74788\Drawings\CAD\Sheets\D774788-sht-removal		DRAWN -	REVISED -
Default	PLOT SCALE = 20.0000' / in.	CHECKED -	REVISED -
	PLOT DATE = 4/7/2017	DATE -	REVISED -



**STATE OF ILLINOIS  
DEPARTMENT OF TRANSPORTATION**

**REMOVAL PLAN  
CAR PARKING**

SCALE: 10 SHEET 1 OF 4 SHEETS STA. TO STA.

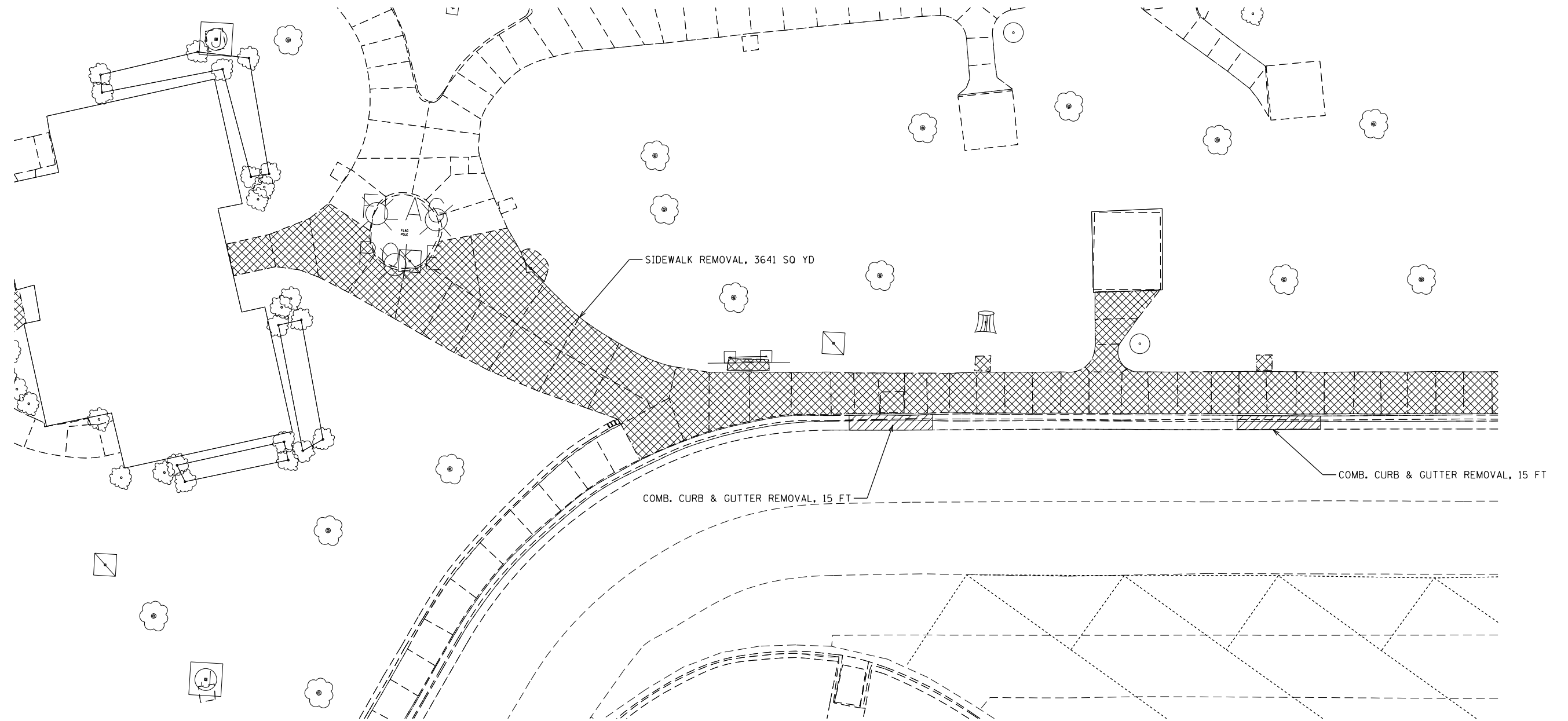
F.A.I. RTE.	SECTION	COUNTY	TOTAL SHEETS	SHEET NO.
70	(12-53)RA-2	CLARK	19	6
CONTRACT NO. 74788			ILLINOIS FED. AID PROJECT	

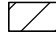
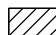

-  PAVEMENT REMOVAL
-  COMB. CURB & GUTTER REMOVAL
-  SIDEWALK REMOVAL

FILE NAME =	USER NAME = steffenmk	DESIGNED -	REVISED -
p:\11\084EBIDINTEG.illinois.gov\PWIDOT\Documents\IDOT Offices\District 7\Projects\74788\Drawings\CAD\Sheets\0774788-sht-removal		DRAWN -	REVISED -
Default	PLOT SCALE = 20.0000' / in.	CHECKED -	REVISED -
	PLOT DATE = 4/7/2017	DATE -	REVISED -

**STATE OF ILLINOIS  
DEPARTMENT OF TRANSPORTATION**

**REMOVAL PLAN  
TRUCK PARKING**

SCALE: 10 SHEET 2 OF 4 SHEETS STA. TO STA.

F.A.I. RTE.	SECTION	COUNTY	TOTAL SHEETS	SHEET NO.
70	(12-53)RA-2	CLARK	19	7
CONTRACT NO. 74788			ILLINOIS FED. AID PROJECT	

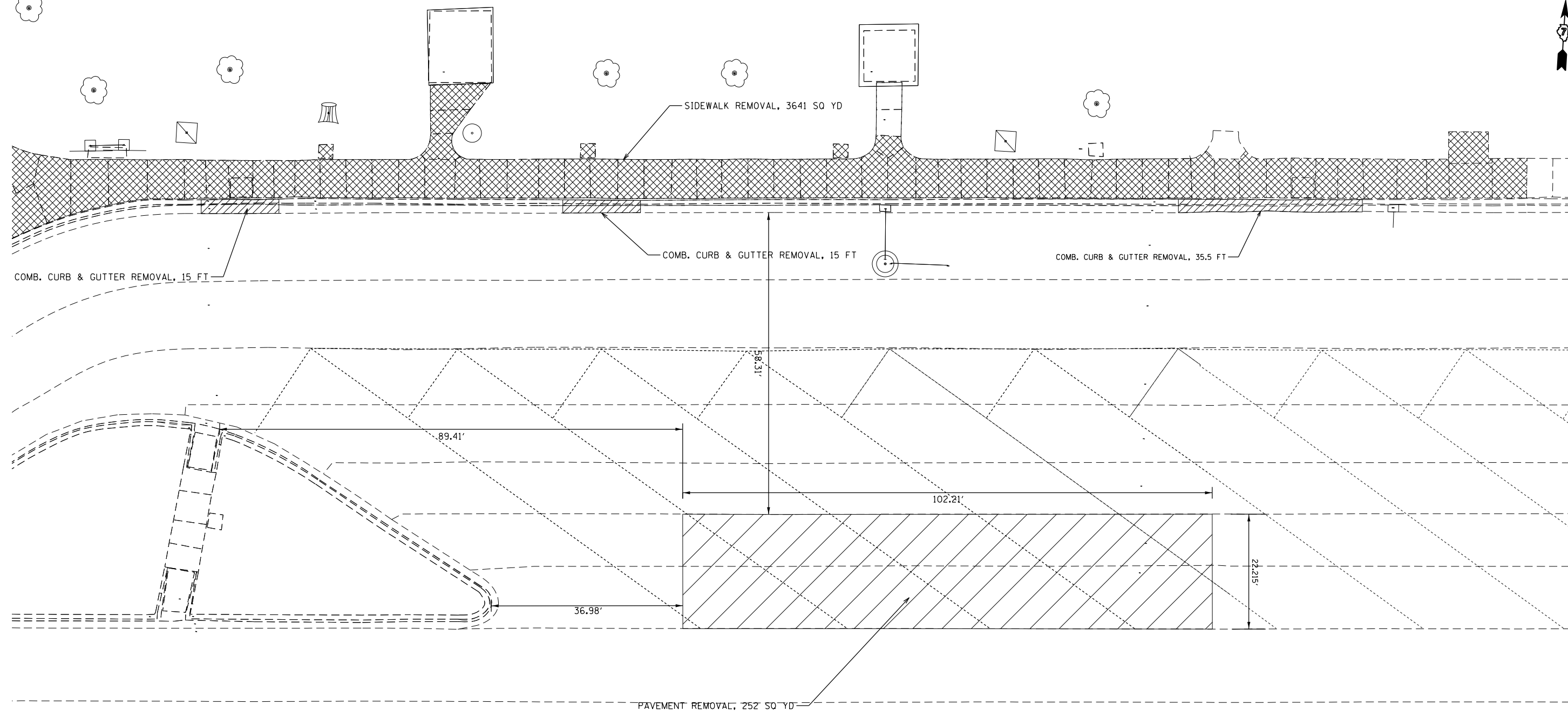

- PAVEMENT REMOVAL
- COMB. CURB & GUTTER REMOVAL
- SIDEWALK REMOVAL

FILE NAME =	USER NAME = steffenmk	DESIGNED -	REVISED -
pw:\IL\084EBIDINTEG\illinois.gov\PI\DOT\Documents\DOT Offices\District 7\Projects\74788\Drawings\CAD\Sheets\0774788-sht-removal		DRAWN -	REVISED -
Default	PLOT SCALE = 20.0000' / in.	CHECKED -	REVISED -
	PLOT DATE = 4/7/2017	DATE -	REVISED -



**STATE OF ILLINOIS  
DEPARTMENT OF TRANSPORTATION**

**REMOVAL PLAN  
TRUCK PARKING**

SCALE: 10 SHEET 3 OF 4 SHEETS STA. TO STA.

F.A.I. RTE.	SECTION	COUNTY	TOTAL SHEETS	SHEET NO.
70	(12-53)RA-2	CLARK	19	8
ILLINOIS FED. AID PROJECT			CONTRACT NO. 74788	

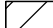

-  PAVEMENT REMOVAL
-  COMB. CURB & GUTTER REMOVAL
-  SIDEWALK REMOVAL

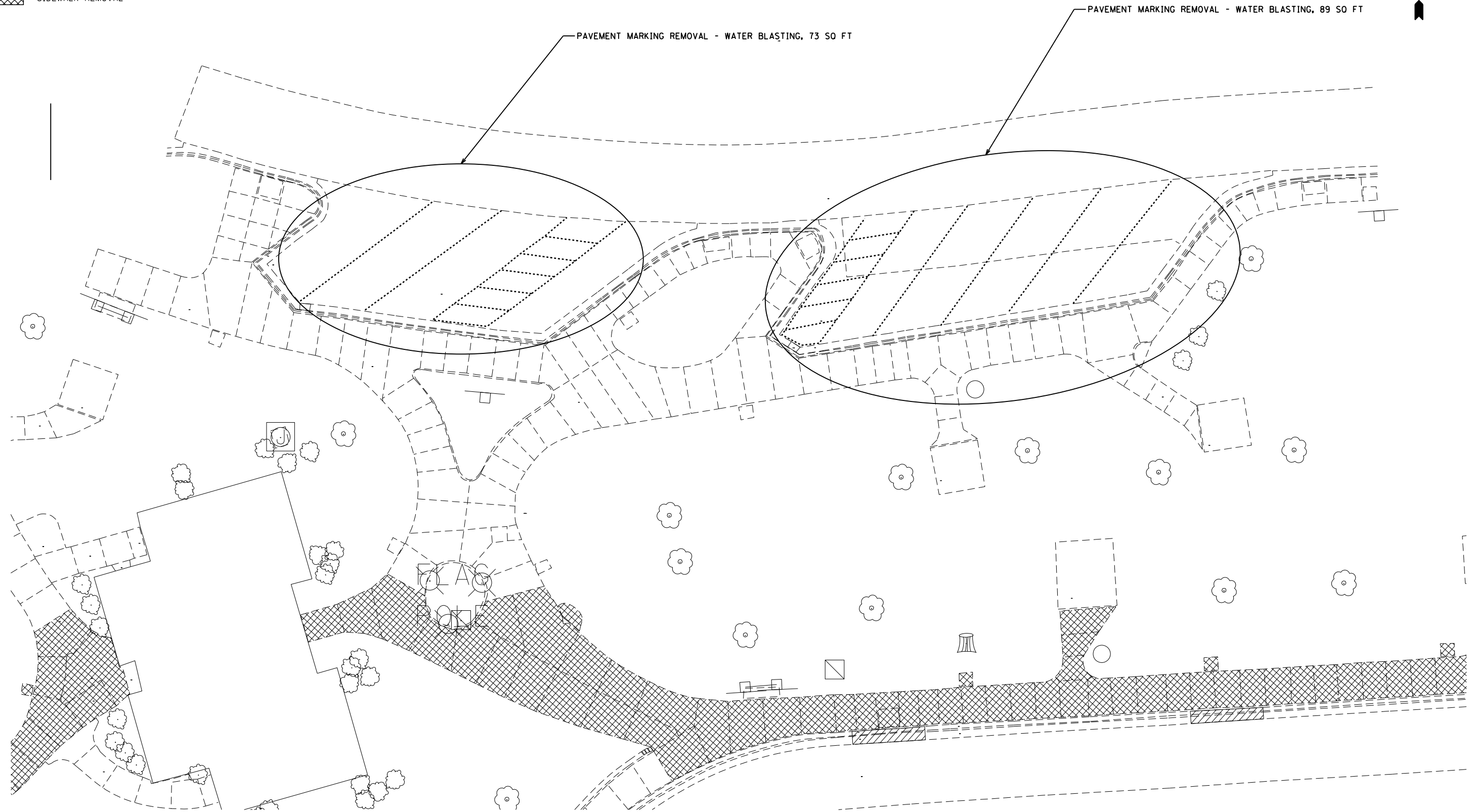

FILE NAME =	USER NAME = steffenk	DESIGNED -	REVISED -
pw:\IL\084EBIDINTEG\Illinois.gov\PWIDOT\Documents\IDOT Offices\District 7\Projects\74788\Drawings\CAD\Sheets\0774788-sht-removal		DRAWN -	REVISED -
Default	PLOT SCALE = 20.0000' / in.	CHECKED -	REVISED -
	PLOT DATE = 4/7/2017	DATE -	REVISED -

**STATE OF ILLINOIS  
DEPARTMENT OF TRANSPORTATION**

**REMOVAL PLAN  
TRUCK PARKING**

SCALE: 10      SHEET 4      OF 4      SHEETS      STA.      TO STA.

F.A.I. RTE.	SECTION	COUNTY	TOTAL SHEETS	SHEET NO.
70	(12-53)RA-2	CLARK	19	9
CONTRACT NO. 74788			ILLINOIS FED. AID PROJECT	



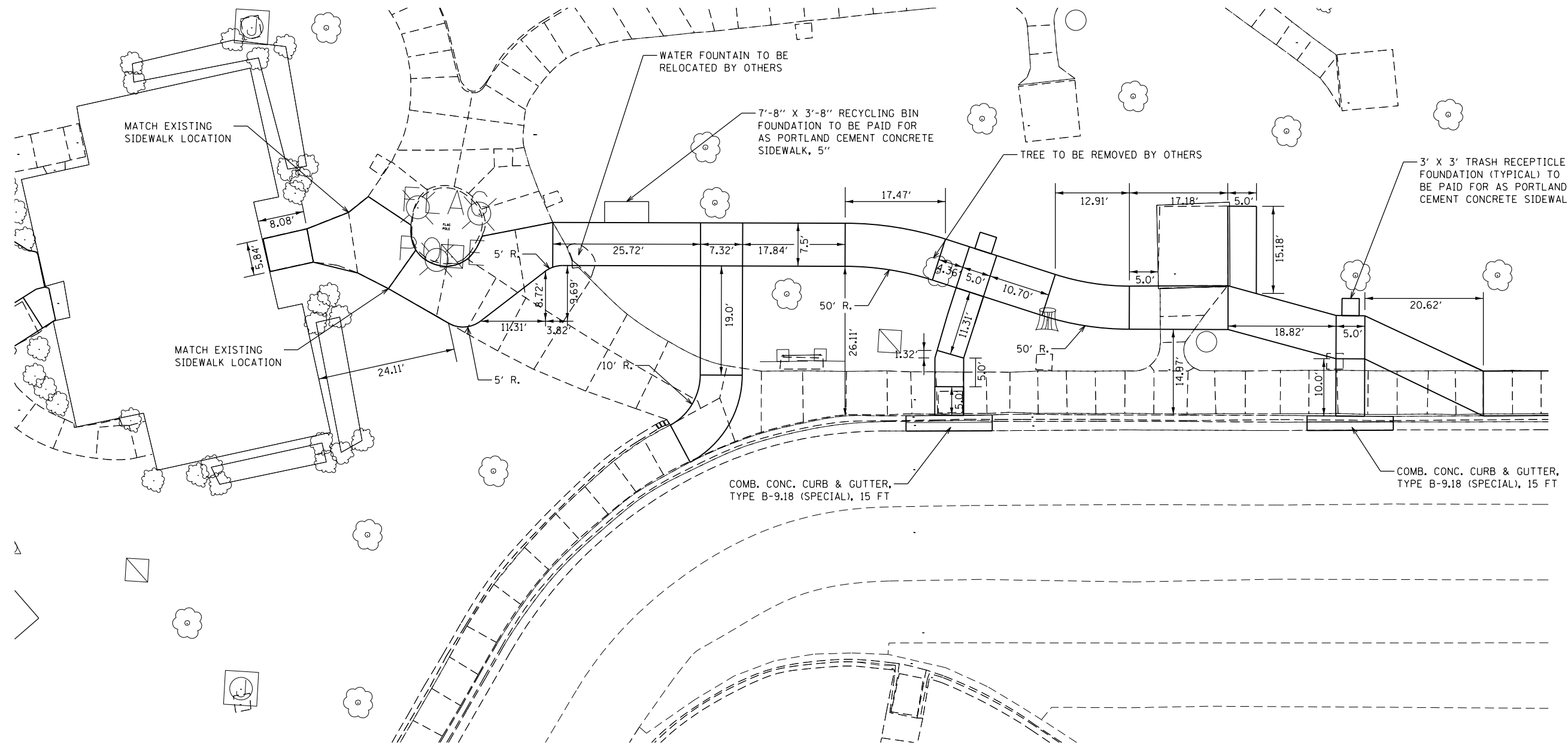

FILE NAME =	USER NAME = steffenmk	DESIGNED -	REVISED -
p:\11\084EBIDINTEG.illinois.gov\PIWIDOT\Documents\IDOT Offices\District 7\Projects\74788\Drawings\CAD\Drawings\74788-sht-plan.dgn		DRAWN -	REVISED -
Default	PLOT SCALE = 20.0000' / in.	CHECKED -	REVISED -
	PLOT DATE = 4/7/2017	DATE -	REVISED -

**STATE OF ILLINOIS  
DEPARTMENT OF TRANSPORTATION**

**SIDEWALK & PAVEMENT PLAN  
TRUCK PARKING**

SCALE: 10 SHEET 2 OF 3 SHEETS STA. TO STA.

F.A.I. RTE.	SECTION	COUNTY	TOTAL SHEETS	SHEET NO.
70	(12-53)RA-2	CLARK	19	11
CONTRACT NO. 74788			ILLINOIS FED. AID PROJECT	

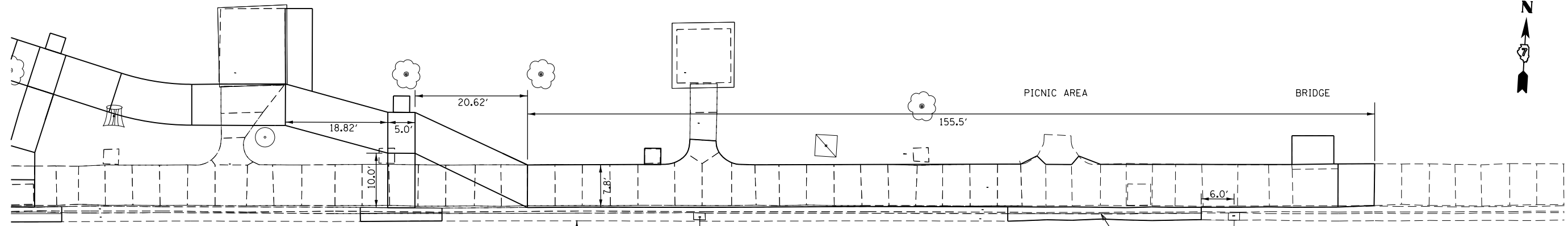

COMB. CONC. CURB & GUTTER,  
TYPE B-9.18 (SPECIAL), 35.5 FT

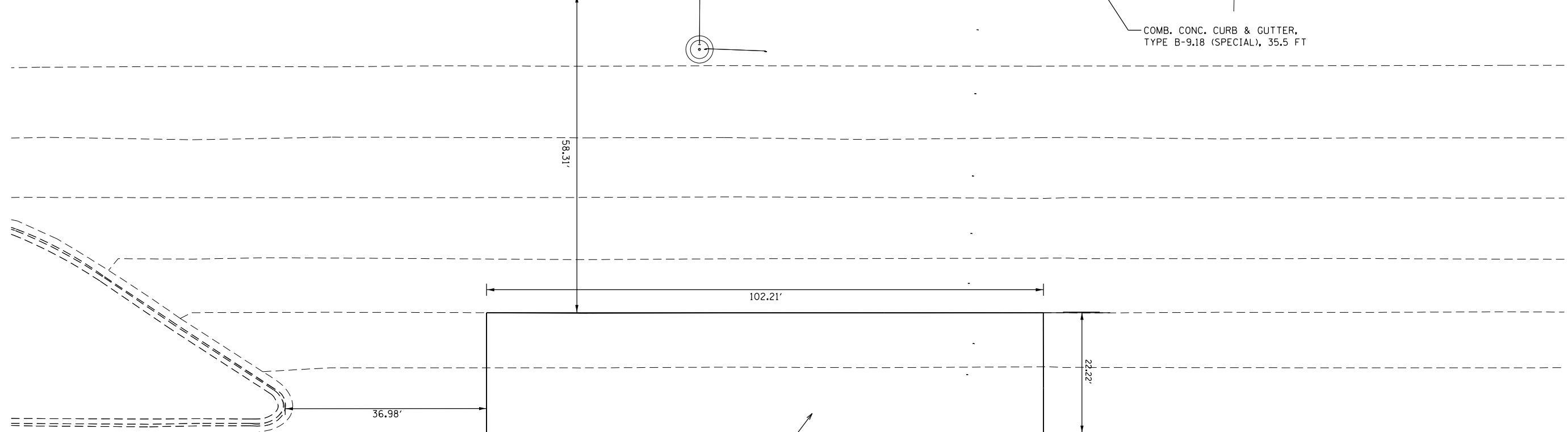

PORTLAND CEMENT CONCRETE PAVEMENT, 12" (JOINTED), 252 SQ YD

FILE NAME =	USER NAME = steffenmk	DESIGNED -	REVISED -
p:\11\084EBIDINTEG.illinois.gov\PIWIDOT\Documents\IDOT Offices\District 7\Projects\74788\Drawings\CAD\Sheets\0774788-sht-plan.dgn		DRAWN -	REVISED -
Default	PLOT SCALE = 20.0000' / in.	CHECKED -	REVISED -
	PLOT DATE = 4/7/2017	DATE -	REVISED -

**STATE OF ILLINOIS  
DEPARTMENT OF TRANSPORTATION**

**SIDEWALK & PAVEMENT PLAN  
TRUCK PARKING**

SCALE: 10 SHEET 3 OF 3 SHEETS STA. TO STA.

F.A.I. RTE.	SECTION	COUNTY	TOTAL SHEETS	SHEET NO.
70	(12-53)RA-2	CLARK	19	12
CONTRACT NO. 74788			ILLINOIS FED. AID PROJECT	

**BENCHMARKS:**

- BM 706: ELEV. = 577.605, STA 174+20, O/S = 111.7' LT CUT SQUARE ON TOP OF THE SE END OF THE RETAINING WALL FOR THE REST AREA
- BM 707: ELEV. = 588.977 CHISELED "X" ON THE TOP OF THE SOUTH BOLT OF LIGHT POLE 20-502 FOUNDATION IN THE REST AREA (BIG QUAD LIGHT)
- BM 708: ELEV. = 588.631 CUT SQUARE ON THE NORTH END OF THE FOUNDATION OF LIGHT POLE 20-124 IN THE REST AREA

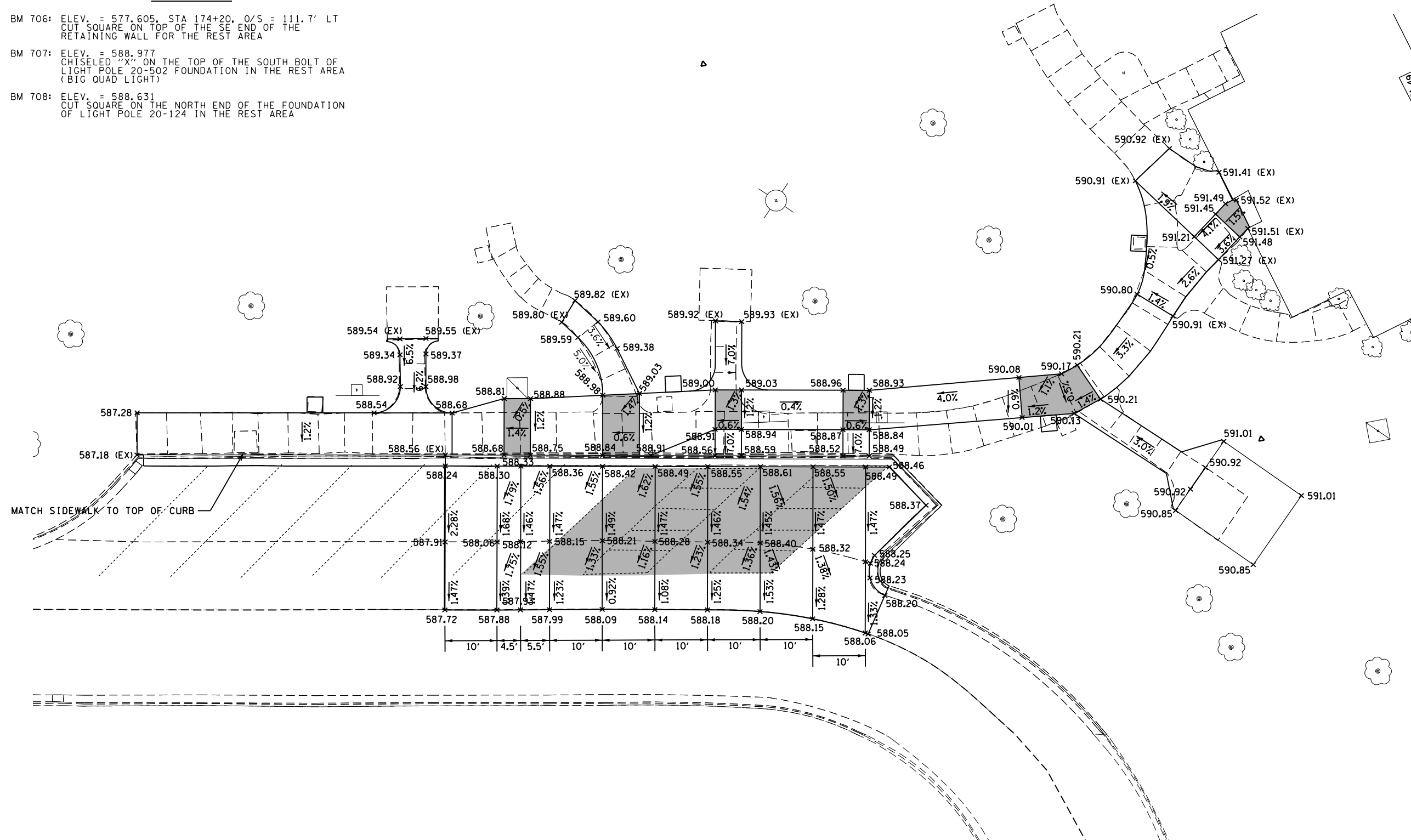

- SIDEWALK TRANSITION PANEL
- LANDING AREA (MAX SLOPE OF 2% IN ANY DIRECTION)

FILE NAME =	USER NAME = steffenmk	DESIGNED -	REVISED -
pw:\11084EBIDINTEG.illinois.gov\PIWIDOT\Documents\IDOT Offices\District 7\Projects\74788\Drawings\CAD\Sheets\0774788-sht-grading		DRAWN -	REVISED -
Default	PLOT SCALE = 20.0000' / in.	CHECKED -	REVISED -
	PLOT DATE = 4/7/2017	DATE -	REVISED -

**STATE OF ILLINOIS  
DEPARTMENT OF TRANSPORTATION**

<b>GRADING PLAN CAR PARKING SIDEWALK &amp; PAVEMENT</b>			
SCALE: 10	SHEET 1	OF 3 SHEETS	STA. TO STA.

F.A.I. RTE.	SECTION	COUNTY	TOTAL SHEETS	SHEET NO.
70	(12-53)RA-2	CLARK	19	13
ILLINOIS FED. AID PROJECT			CONTRACT NO. 74788	





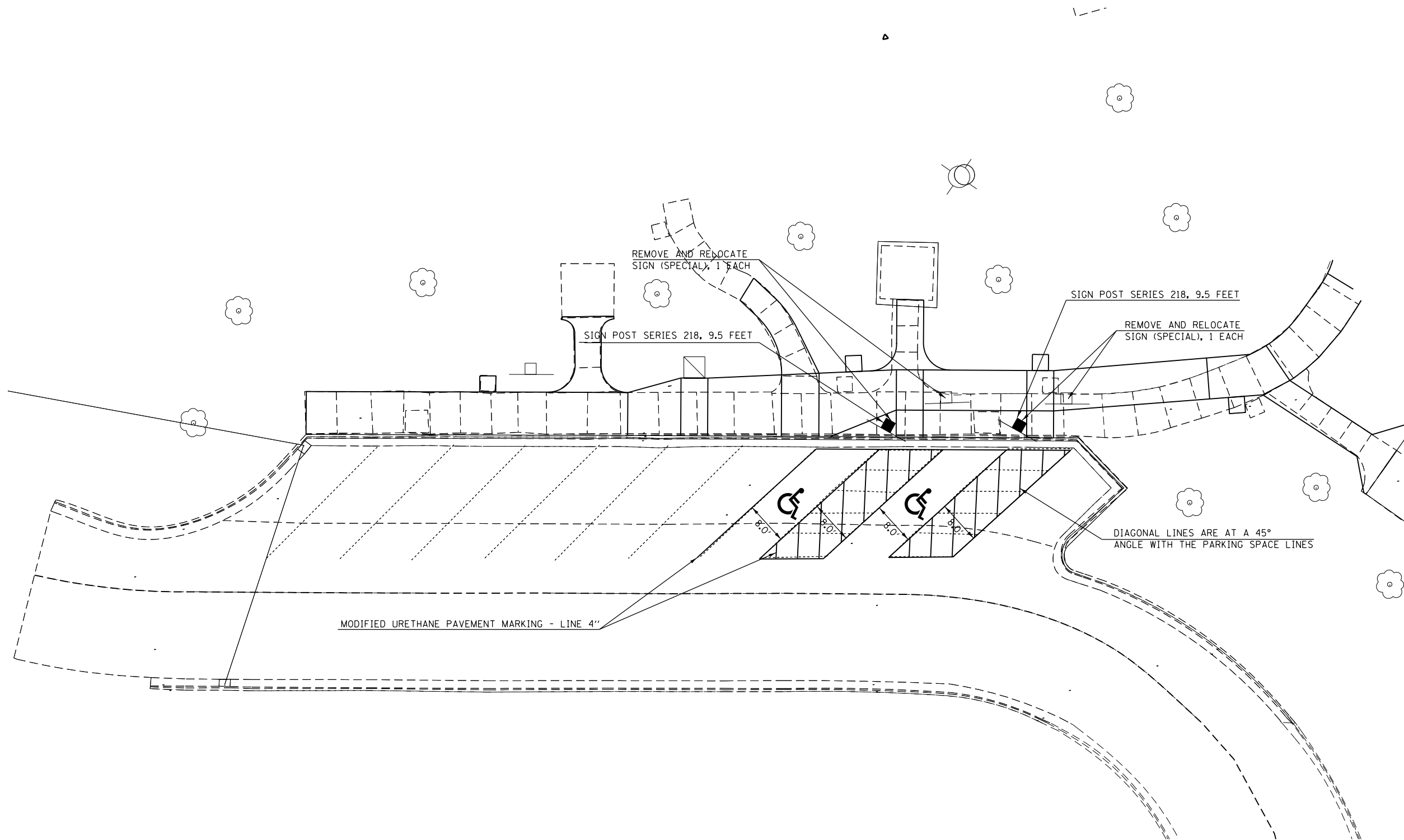

**PAVEMENT MARKING NOTES:**

ALL OF THE PARKING SPACES IN THE REST AREA ARE TO BE RE-STRIPED. ONLY THE ADA SPACES AND THE PARKING AREAS THAT WERE MODIFIED ARE SHOWN. ALL OTHER PAVEMENT MARKINGS SHALL MATCH THE EXISTING MARKINGS.  
 THE ADA PARKING SPACES SHALL BE STRIPED YELLOW, WHILE ALL OTHER PARKING SPACES SHALL BE STRIPED WHITE.

FILE NAME =	USER NAME = steffenmk	DESIGNED -	REVISED -
pw:\IL\084EBIDINTEG\illinois.gov\PI\DOT\Documents\DOT Offices\District 7\Projects\74788\Drawings\CAD\Sheets\0774788-sht-pavtmrk		DRAWN -	REVISED -
Default	PLOT SCALE = 20.0000' / in.	CHECKED -	REVISED -
	PLOT DATE = 4/7/2017	DATE -	REVISED -

**STATE OF ILLINOIS  
DEPARTMENT OF TRANSPORTATION**

**PAVEMENT MARKING & SIGNAGE PLAN**

SCALE: 10 SHEET 1 OF 3 SHEETS STA. TO STA.

F.A.I. RTE.	SECTION	COUNTY	TOTAL SHEETS	SHEET NO.
70	(12-53)RA-2	CLARK	19	16
CONTRACT NO. 74788			ILLINOIS FED. AID PROJECT	



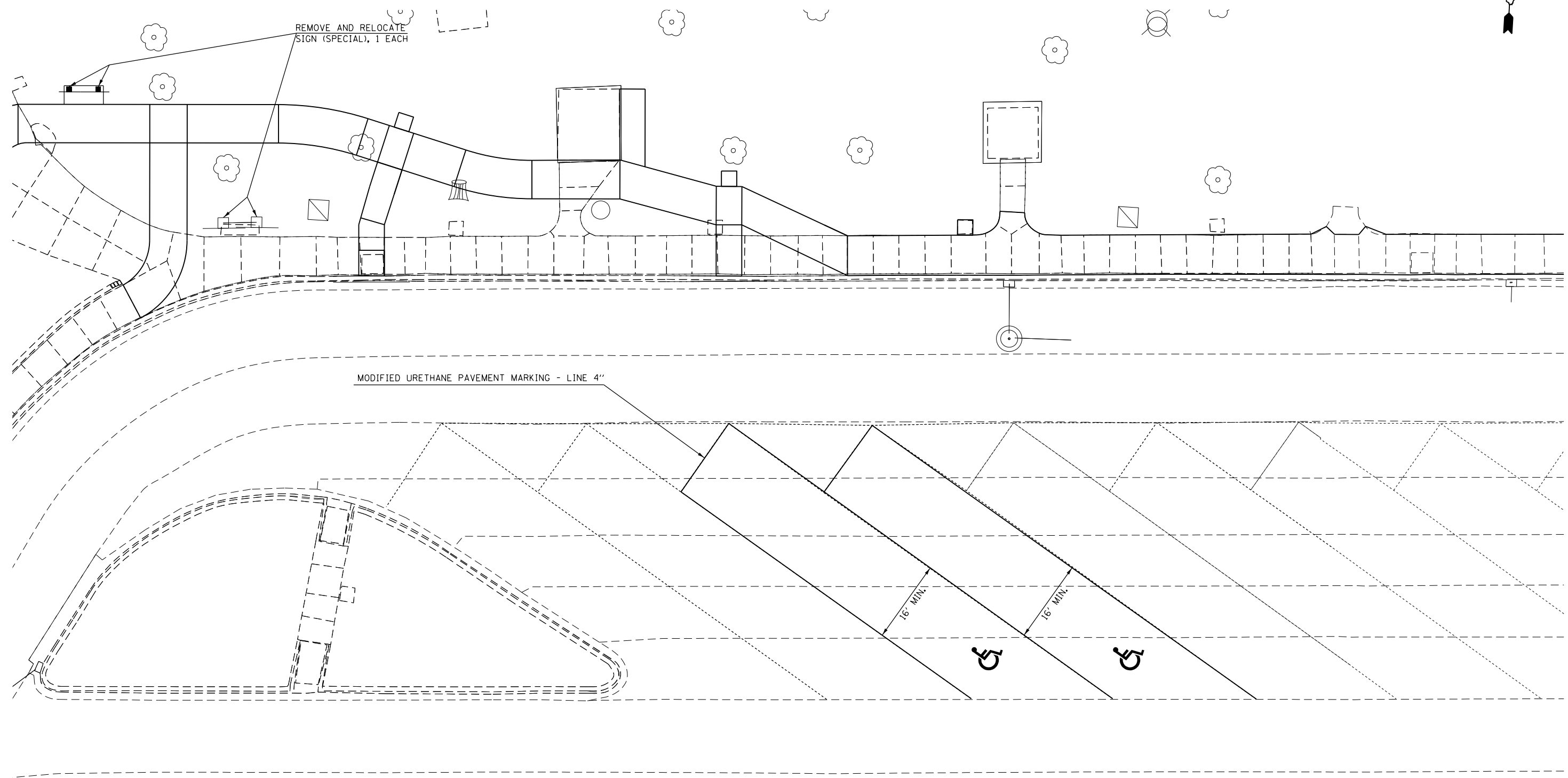

**PAVEMENT MARKING NOTES:**

ALL OF THE PARKING SPACES IN THE REST AREA ARE TO BE RE-STRIPED. ONLY THE ADA SPACES AND THE PARKING AREAS THAT WERE MODIFIED ARE SHOWN. ALL OTHER PAVEMENT MARKINGS SHALL MATCH THE EXISTING MARKINGS. THE ADA PARKING SPACES SHALL BE STRIPED YELLOW, WHILE ALL OTHER PARKING SPACES SHALL BE STRIPED WHITE.

FILE NAME =	USER NAME = steffenk	DESIGNED -	REVISED -
p:\11\084EBIDINTEG.illinois.gov\PI\DOT\Documents\IDOT Offices\District 7\Projects\74788\Drawings\CAD\Drawings\074788-sh-pavmark.dwg		DRAWN -	REVISED -
Default	PLOT SCALE = 20.0000' / in.	CHECKED -	REVISED -
	PLOT DATE = 4/7/2017	DATE -	REVISED -

**STATE OF ILLINOIS  
DEPARTMENT OF TRANSPORTATION**

**PAVEMENT MARKING & SIGNAGE PLAN**

SCALE: 10 SHEET 2 OF 3 SHEETS STA. TO STA.

F.A.I. RTE.	SECTION	COUNTY	TOTAL SHEETS	SHEET NO.
70	(12-53)RA-2	CLARK	19	17
				<b>CONTRACT NO. 74788</b>
ILLINOIS FED. AID PROJECT				



MODIFIED URETHANE PAVEMENT MARKING - LINE 4"  
 (USE MIN. STALL WIDTHS OF 9' WITH LINES AT 45° ANGLES)

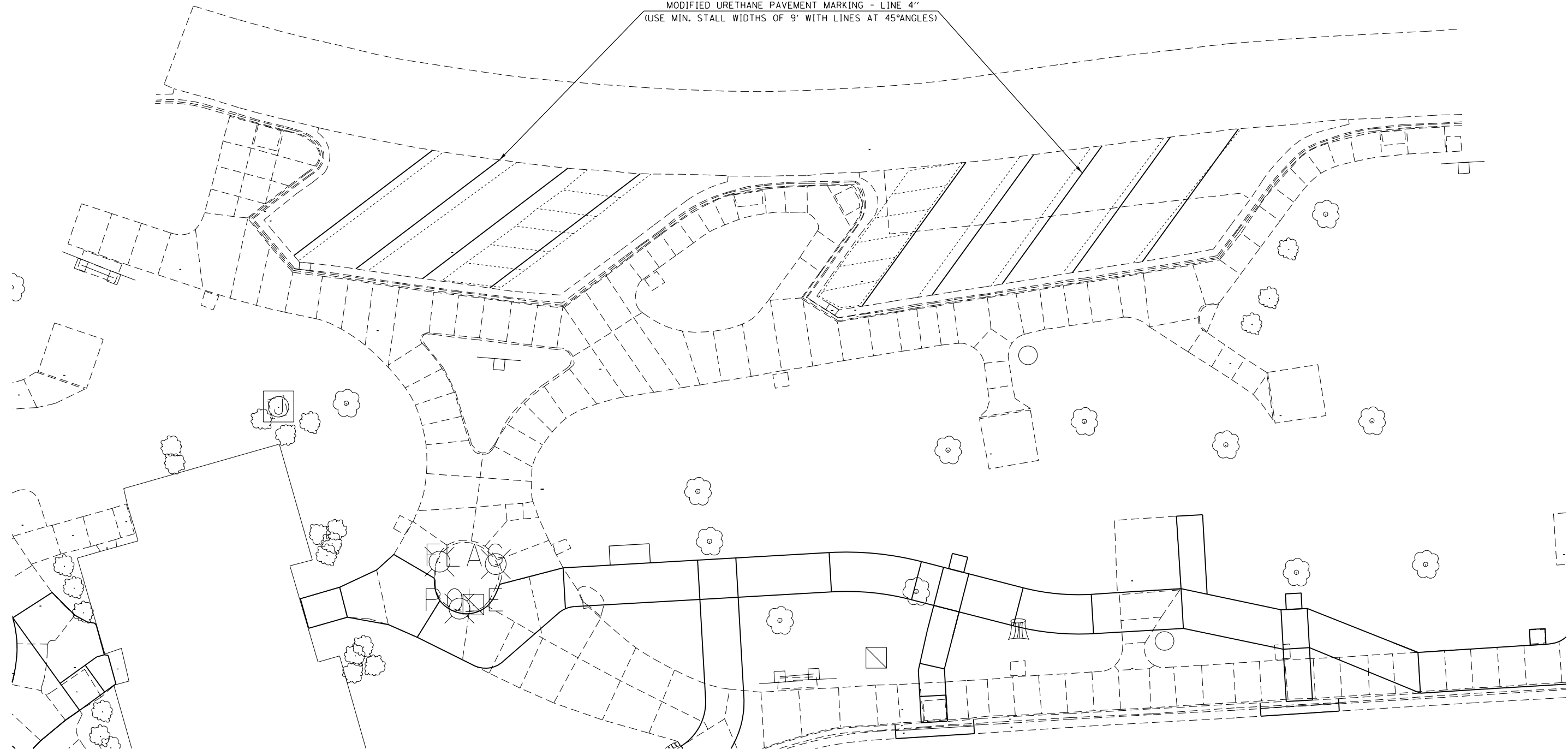

FILE NAME =	USER NAME = steffenk	DESIGNED -	REVISED -	<b>STATE OF ILLINOIS DEPARTMENT OF TRANSPORTATION</b>	<b>PAVEMENT MARKING &amp; SIGNAGE PLAN</b>			F.A.I. RTE.	SECTION	COUNTY	TOTAL SHEETS	SHEET NO.
pw:\IL\084EBIDINTEG\illinois.gov\PWIDOT\Documents\IDOT Offices\District 7\Projects\74788\Drawings\CAD\Drawings\74788-sht-pavtmrk\74788-sht-pavtmrk.dwg	PLotted	CHECKED -	REVISED -					70	(12-53)RA-2	CLARK	19	18
Default	PLOT SCALE = 20.0000' / in.	DATE -	REVISED -		CONTRACT NO. 74788			ILLINOIS FED. AID PROJECT				
	PLOT DATE = 4/7/2017	DATE -	REVISED -		SCALE: 10	SHEET 3	OF 3	SHEETS	STA.	TO STA.		

COMBINATION CONCRETE CURB AND GUTTER,  
TYPE B-9.24 (SPECIAL)

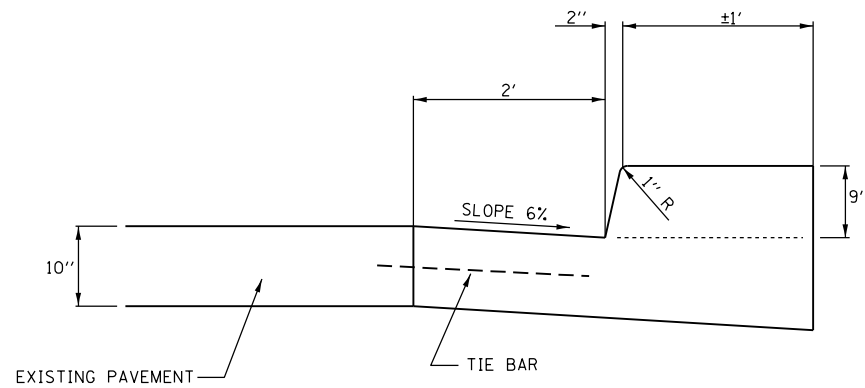

SIGN POST INSTALLATION  
DIRECT BURIAL IN CONCRETE

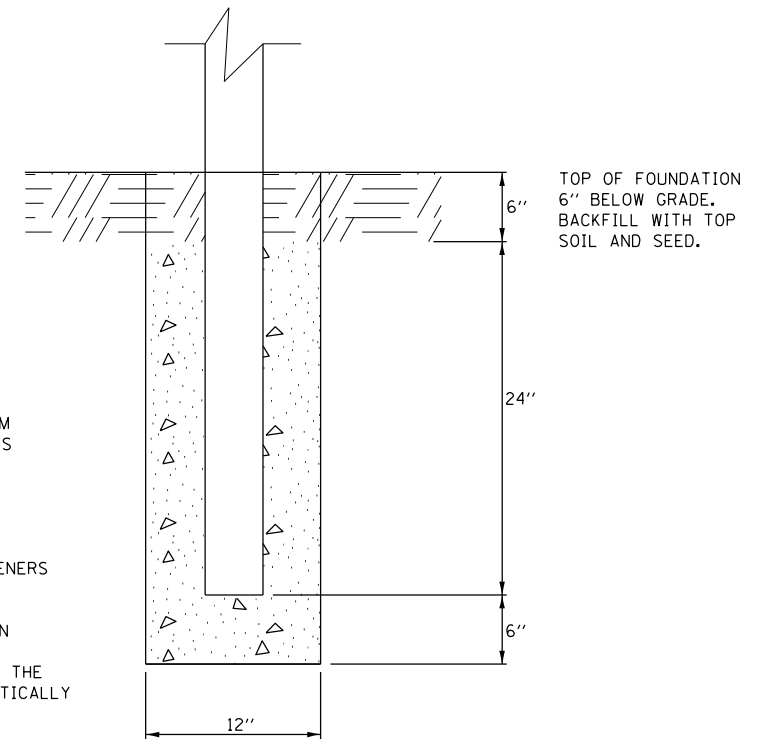

NOTES:

ALL POSTS AND FRAMES SHALL BE MANUFACTURED FROM HEAVY DUTY 6063 ALLOY ALUMINUM EXTRUSIONS. POSTS SHALL BE TEMPER T6 AND FRAMES TEMPER T5.

ALL EXTRUSIONS SHALL BE PRODUCED TO ALUMINUM ASSOCIATION STANDARDS AND ASTM B221.

ALL HARDWARE SHALL BE STAINLESS STEEL. ALL FASTENERS SHALL BE TAMPER RESISTANT.

FRAMES AND POSTS SHALL BE FINISHED IN DARK BROWN MEETING THE APPROVAL OF THE ENGINEER. COLOR SAMPLES SHALL BE FURNISHED PRIOR TO FABRICATION. THE FINISH IS TO BE ACRYLIC POLYURETHANE, ELECTROSTATICALLY APPLIED TO PRETREATED AND PRIMED SURFACES AND OVEN BAKED.

SINGLE SIGN POST INSTALLATION

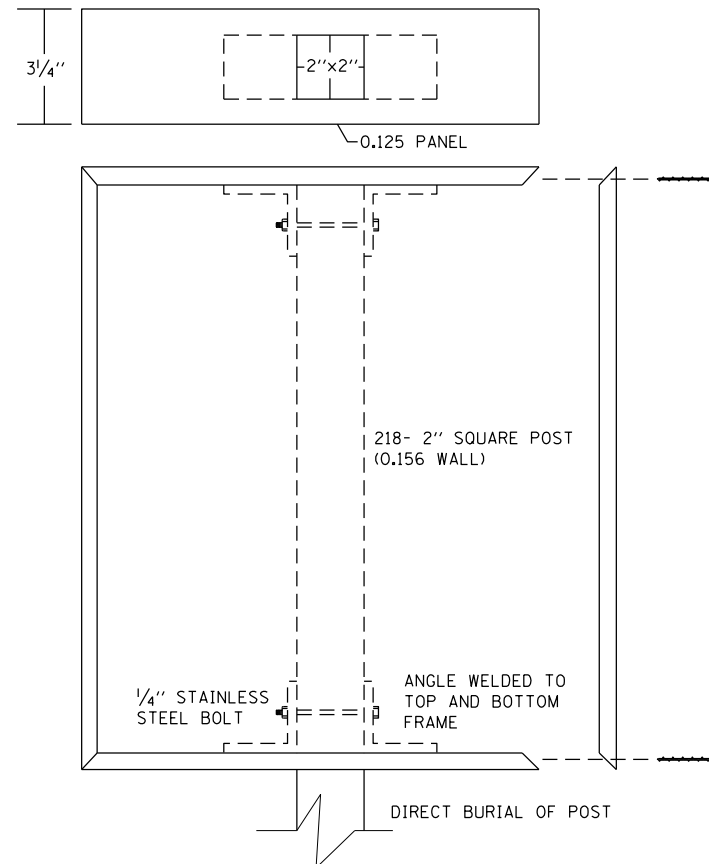

NOTES:

ALL POSTS AND FRAMES SHALL BE MANUFACTURED FROM HEAVY DUTY 6063 ALLOY ALUMINUM EXTRUSIONS. POSTS SHALL BE TEMPER T6 AND FRAMES TEMPER T5.

ALL EXTRUSIONS SHALL BE PRODUCED TO ALUMINUM ASSOCIATION STANDARDS AND ASTM B221.

ALL HARDWARE SHALL BE STAINLESS STEEL. ALL FASTENERS SHALL BE TAMPER RESISTANT.

FRAMES AND POSTS SHALL BE FINISHED IN DARK BROWN MEETING THE APPROVAL OF THE ENGINEER. COLOR SAMPLES SHALL BE FURNISHED PRIOR TO FABRICATION. THE FINISH IS TO BE ACRYLIC POLYURETHANE, ELECTROSTATICALLY APPLIED TO PRETREATED AND PRIMED SURFACES AND OVEN BAKED.

FILE NAME =	USER NAME = steffenmk	DESIGNED -	REVISED -
pw:\IL\084EBIDINTEG\illinois.gov\PWIDOT\Documents\IDOT Offices\District 7\Projects\74788\Drawings\CAD\Sheets\0774788-sht-details.dwg		DRAWN -	REVISED -
Default	PLOT SCALE = 100.0000' / in.	CHECKED -	REVISED -
	PLOT DATE = 4/7/2017	DATE -	REVISED -

STATE OF ILLINOIS  
DEPARTMENT OF TRANSPORTATION

DISTRICT DETAILS

SCALE: NA SHEET 1 OF 1 SHEETS STA. TO STA.

F.A.I. R.E.	SECTION	COUNTY	TOTAL SHEETS	SHEET NO.
70	(12-53)RA-2	CLARK	19	19
CONTRACT NO. 74788				
ILLINOIS FED. AID PROJECT				