

STATE OF ILLINOIS  
DEPARTMENT OF TRANSPORTATION

F.A.P. RTE.	SECTION	COUNTY	TOTAL SHEETS	SHEET NO.
68	(105)PP	LIVINGSTON	9	1
		ILLINOIS	CONTRACT NO. 66H30	

- INDEX OF SHEETS**
- COVER SHEET
  - GENERAL NOTES
  - SUMMARY OF QUANTITIES
  - TYPICAL SECTIONS
  - 5-6. SCHEDULES
  7. TEMPORARY INFORMATION SIGNING
  - 8-9. CLASS B PATCHING DETAILS

- STANDARDS**
- 000001-06 STANDARD SYMBOLS, ABBREVIATIONS AND PATTERNS
  - 001006 DECIMAL OF AN INCH AND OF A FOOT
  - 420701-03 PAVEMENT WELDED WIRE REINFORCEMENT
  - 701006-05 OFF-ROAD OPERATIONS 2L, 2W, 15' (4.5 m) TO 24" (600 mm) FROM PAVEMENT EDGE
  - 701201-04 LANE CLOSURE, 2L, 2W, DAY ONLY, FOR SPEEDS ≥ 45 MPH
  - 701301-04 LANE CLOSURE, 2L, 2W, SHORT TIME OPERATIONS
  - 701901-02 TRAFFIC CONTROL DEVICES

# PROPOSED HIGHWAY PLANS

F.A.P. ROUTE 68 (IL 23)  
SECTION (105)PP  
PAVEMENT PATCHING  
LIVINGSTON COUNTY

C-93-067-17

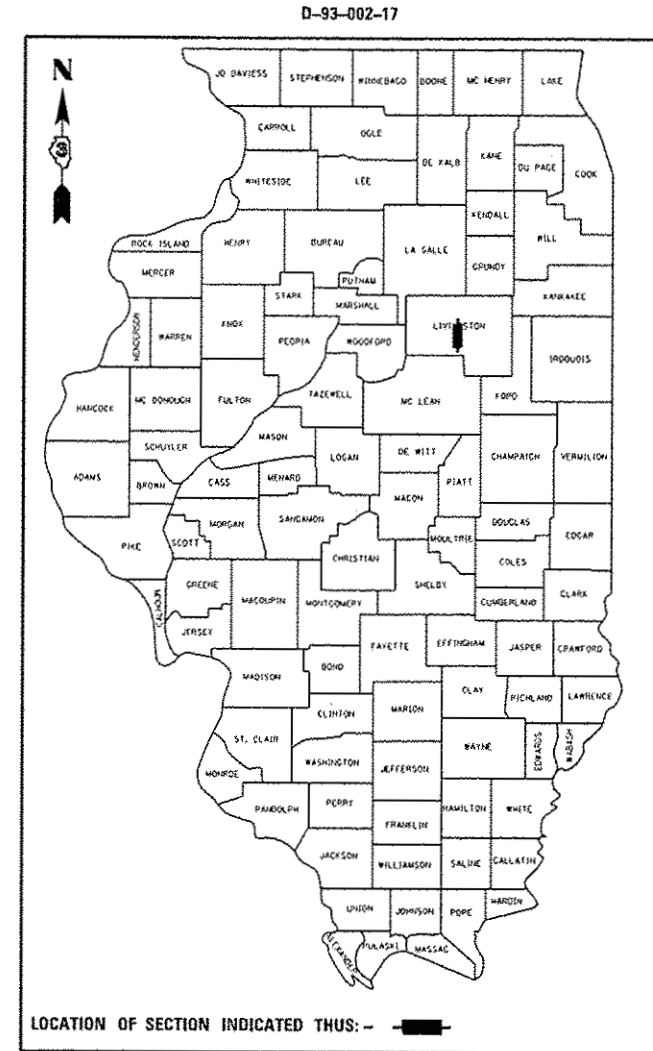

**PROJECT LIMITS**  
APPROXIMATELY 0.36 MILES NORTH OF I-55  
(CONCRETE SECTION)

**PROJECT LIMITS**  
APPROXIMATELY 0.38 MILES SOUTH OF I-55  
(CONCRETE SECTION)

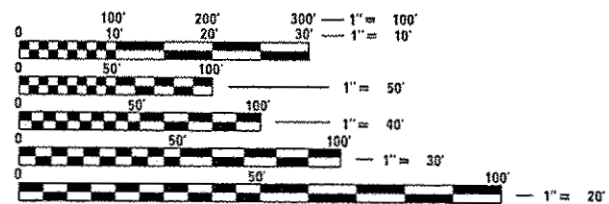

FULL SIZE PLANS HAVE BEEN PREPARED USING STANDARD ENGINEERING SCALES. REDUCED SIZED PLANS WILL NOT CONFORM TO STANDARD SCALES. IN MAKING MEASUREMENTS ON REDUCED PLANS, THE ABOVE SCALES MAY BE USED.

J.U.L.I.E.  
JOINT UTILITY LOCATION INFORMATION FOR EXCAVATION  
1-800-892-0123  
OR 811

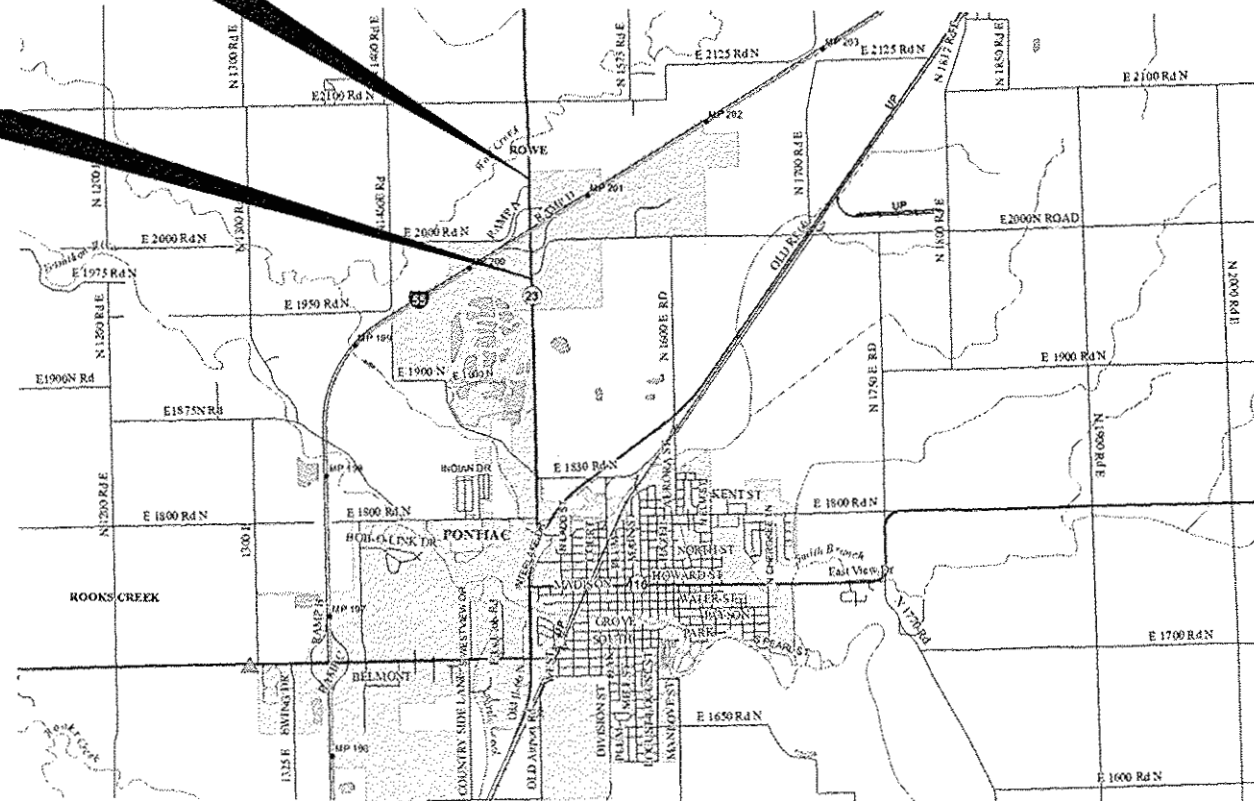

**PROJECT ENGINEER: JOE KANNEL, P.E.**  
**UNIT CHIEF: RON WOODSHANK**  
DISTRICT 3 NO. (815) 434-6131  
CONTRACT NO. 66H30

GROSS LENGTH = 3960 FT. = 0.750 MILE  
NET LENGTH = 3665 FT. = 0.694 MILE

URBAN	
OTHER ARTERIAL	
IL 23	
2015	
ADT	3850
P. V.	68.8%
S. U.	18.2%
M. U.	13.0%

STATE OF ILLINOIS  
DEPARTMENT OF TRANSPORTATION

SUBMITTED 04/06 20 17  
Kevin Macintosh REGIONAL ENGINEER

Maureen M. Addis P.E.  
ENGINEER OF DESIGN AND ENVIRONMENT

Maureen M. Addis 2  
DIRECTOR OF PROGRAM DEVELOPMENT

PRINTED BY THE AUTHORITY  
OF THE STATE OF ILLINOIS

REV

**GENERAL NOTES**

PLAN DIMENSIONS AND DETAILS RELATIVE TO EXISTING PLANS ARE SUBJECT TO NOMINAL CONSTRUCTION VARIATIONS. THE CONTRACTOR SHALL FIELD VERIFY EXISTING DIMENSIONS AND DETAILS AFFECTING NEW CONSTRUCTION AND MAKE NECESSARY APPROVED ADJUSTMENTS PRIOR TO CONSTRUCTION OR ORDERING OF MATERIALS. SUCH VARIATIONS SHALL NOT BE CAUSE FOR ADDITIONAL COMPENSATION FOR A CHANGE IN SCOPE OF WORK; HOWEVER, THE CONTRACTOR WILL BE PAID FOR THE QUANTITY ACTUALLY FURNISHED AT THE UNIT PRICE BID FOR THE WORK.

ALL EXCAVATED MATERIAL, WHICH INCLUDES DIGGING OR GRADING OF ANY SOIL OR FILL MATERIAL, WITH THE EXCEPTION OF AGGREGATE FILLS, MUST BE INCORPORATED WITHIN THE IDOT RIGHT OF WAY DUE TO ENVIRONMENTAL DOCUMENTATION REQUIREMENTS.

ANY REFERENCE TO A STANDARD IN THESE PLANS SHALL BE INTERPRETED TO MEAN THE EDITION AS INDICATED BY THE SUBNUMBER SHOWN IN THE LIST OF STANDARDS OR THE COPY INCLUDED IN THESE PLANS.

THE CONTRACTOR SHALL CONTACT JULIE AT LEAST 48 HOURS PRIOR TO EXCAVATION TO DETERMINE WHICH UTILITIES ARE IN THE AREA.

THE CONTRACTOR'S ATTENTION IS DIRECTED TO THE PRESENCE OF DEPARTMENT-OWNED UNDERGROUND ELECTRICAL CABLE WITHIN THE LIMITS OF THE PROPOSED IMPROVEMENT. THE CONTRACTOR SHALL REQUEST THE ILLINOIS DEPARTMENT OF TRANSPORTATION IN OTTAWA (815-434-8417) TO LOCATE THE UNDERGROUND FACILITIES, PROVIDING A MINIMUM OF 72 HOURS NOTICE. THE DEPARTMENT IS NOT A MEMBER OF THE JOINT UTILITY LOCATING INFORMATION FOR EXCAVATORS (JULIE) SYSTEM.

ALL DAMAGE TO DEPARTMENT OWNED UNDERGROUND FACILITIES, CAUSED BY THE CONTRACTOR SHALL BE REPAIRED TO THE SATISFACTION OF THE DEPARTMENT AT THE CONTRACTOR'S EXPENSE. THIS SHALL INCLUDE ALL TEMPORARY REPAIRS REQUIRED TO KEEP THE FACILITY OPERATIONAL WHILE MATERIAL IS BEING OBTAINED TO MAKE PERMANENT REPAIRS. SPLICING OF ELECTRIC CABLE WILL NOT BE ALLOWED. ELECTRIC CABLE SHALL BE REPLACED FROM POLE TO POLE OR CONTROLLER.

**COMMITMENTS**

**MONUMENT RECORD**

GPS NUMBER	DESCRIPTION	EXISTING MONUMENT TYPE	PROPOSED MONUMENT TYPE	MONUMENT RECORD TO BE RECORDED	RESPONSIBILITY
023010	NW CORNER SECTION 10 T28N, R5E, 3RD PM (LOCATED IN SOUTHBOUND LEFT TURN LANE)	PLAQUE	TYPE 1	YES	1
<p>THE LISTED MONUMENT LOCATION HAS BEEN RECORDED BY GPS. PRE CONSTRUCTION TIES BY THE R.E. ARE NOT REQUIRED. THE R.E. MUST TIE AND BRING TO THE ATTENTION OF THE PLATS AND PLANS MANAGER AND ADDITIONAL UNLISTED MONUMENTS FOUND. UPON PATCHING COMPLETION, IF THIS PLAQUE HAS BEEN DESTROYED, THE R.E. WILL DIRECT THE PLATS AND PLANS MANAGER TO STAKE THE LOCATION FOR A TYPE 1 MONUMENT CORING.</p> <p>IDOT PLATS AND PLANS WILL PREPARE AND RECORD THE REQUIRED MONUMENT RECORD.</p> <p><b>RESPONSIBILITY:</b>                      1) RESIDENT TO RE-ESTABLISH MONUMENT (PAY ITEM REQUIRED. PERMANENT SURVEY MARKER, TYPE 1)                      2) PLATS AND PLANS TO RE-ESTABLISH MONUMENT</p>					

STATE OF ILLINOIS  
DEPARTMENT OF TRANSPORTATION  
DISTRICT THREE  
AS BUILT INFORMATION

DATE: 4-6-17

\_\_\_\_\_  
SUPERVISING CONSTRUCTION FIELD ENGINEER

PREPARED BY: Dr. Benin L  
DISTRICT STUDIES & PLANS ENGINEER

\_\_\_\_\_  
RESIDENT ENGINEER / TECHNICIAN

START & END DATES  
OF CONSTRUCTION:

EXAMINED BY: Joseph W. St.  
DISTRICT CONSTRUCTION ENGINEER

INSPECTORS: \_\_\_\_\_

Michael A. Short  
DISTRICT MATERIALS ENGINEER

Jim Hefner  
DISTRICT OPERATIONS ENGINEER

STATE OF ILLINOIS  
DEPARTMENT OF TRANSPORTATION

**GENERAL NOTES**

FILE NAME: c:\illob4e\BID\INTC\Illinois.gov\IDOT\Documents\IDOT Offices\District 3\Projects\036-DRAWING\66H30-TRT-details.dgn	DESIGNED - TP	REVISED -	F.A.P. RTE. 68	SECTION 11051PP	COUNTY LIVINGSTON	TOTAL SHEETS 9	SHEET NO. 2
PLLOT SCALE = 100,0000 1" = 100'	CHECKED - RW	REVISED -	CONTRACT NO. 66H30				
PLLOT DATE = 4/5/2017	DATE = 2/24/2017	REVISED -	ILLINOIS FED. AID PROJECT				
SCALE: _____			SHEET OF SHEETS STA. TO STA.				

CONSTR. CODE
CONT. MAINT.
100% STATE
ROADWAY
0004
URBAN ✓

CODE NO.	ITEM	UNIT	TOTAL QUANTITY	
44200050	WELDED WIRE REINFORCEMENT	SQ YD	461	461
44200956	CLASS B PATCHES, TYPE II, 9 INCH	SQ YD	828	828
44200962	CLASS B PATCHES, TYPE III, 9 INCH	SQ YD	222	222
44200964	CLASS B PATCHES, TYPE IV, 9 INCH	SQ YD	239	239
44201299	DOWEL BARS 1 1/2"	EACH	2492	2492
44213200	SAW CUTS	FOOT	6870	6870
44213204	TIE BARS 3/4"	EACH	77	77
66700205	PERMANENT SURVEY MARKERS, TYPE I	EACH	1	1
67100100	MOBILIZATION	LSUM	1	1
X7010520	TRAFFIC CONTROL AND PROTECTION, STANDARD 701201 (SPECIAL)	LSUM	1	1
Z0030850	TEMPORARY INFORMATION SIGNING	SO FT	42	42

✦

|| \* SPECIALTY ITEM

FILE NAME :	USER NAME : pltschtr	DESIGNED - TP	REVISED -	<b>STATE OF ILLINOIS DEPARTMENT OF TRANSPORTATION</b>	<b>SUMMARY OF QUANTITIES</b>	F.A.P. RTE.	SECTION	COUNTY	TOTAL SHEETS	SHEET NO.	
Default	\\IL084E8ID\TEG\Illinois.gov\PIWIDOT\Documents\1007 Offices\District 3\Projects\0306-DRAWN\66H30 TR-Details.dgn	CHECKED - RW	REVISED -			68	1105IPP	LIVINGSTON	9	3	
	PLOT SCALE = 100.0000' / 1" =	DATE - 2/24/2017	REVISED -			CONTRACT NO. 66H30					
	PLOT DATE = 4/5/2017					[ILLINOIS] FED. AID PROJECT					

REV

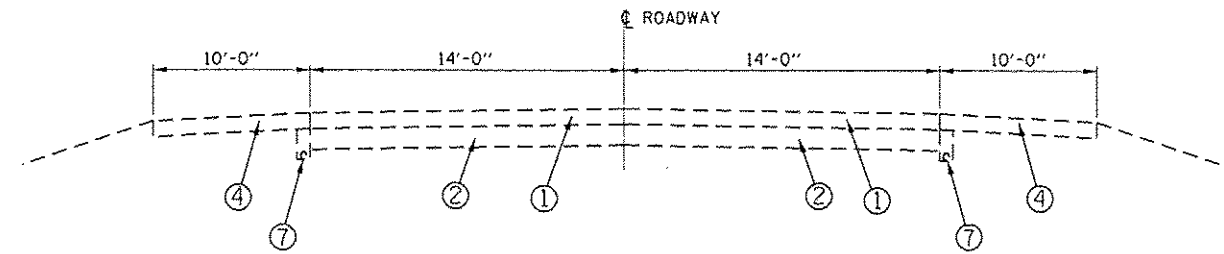

**TYPICAL SECTION 1**  
 L.M. 0.00 – L.M. 0.10  
 L.M. 0.67 – L.M. 0.75

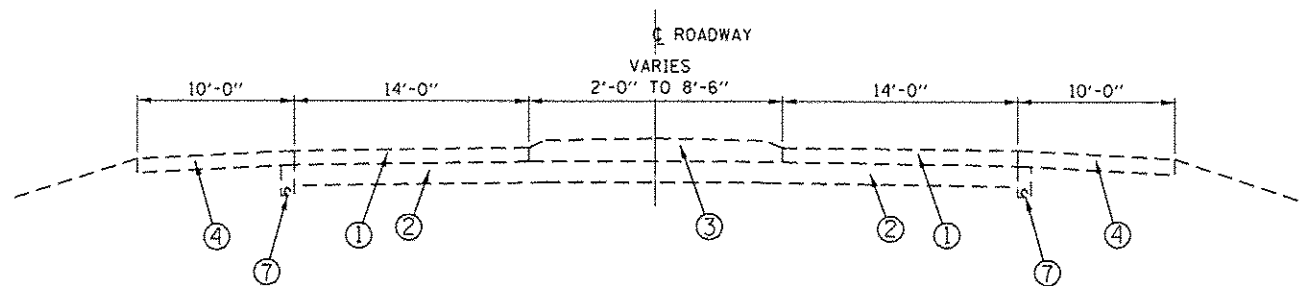

**TYPICAL SECTION 2**  
 L.M. 0.10 – L.M. 0.13  
 L.M. 0.64 – L.M. 0.67

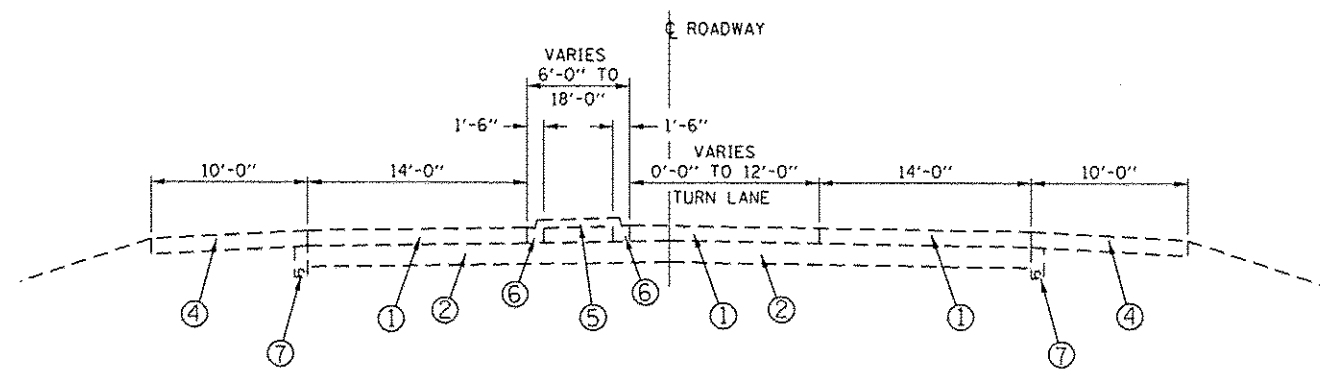

**TYPICAL SECTION 3**  
 L.M. 0.13 – L.M. 0.35  
 L.M. 0.35 – L.M. 0.42 STRUCTURE OMISSION  
 L.M. 0.42 – L.M. 0.64

**KEY**

- ① PORTLAND CEMENT CONCRETE PAVEMENT 9"
- ② STABILIZED SUB-BASE, 4"
- ③ CONCRETE MEDIAN TY. C-4
- ④ STABILIZED SHOULDERS (9")
- ⑤ PORTLAND CEMENT CONCRETE MEDIAN SURFACE, 4"
- ⑥ COMBINATION CONCRETE CURB AND GUTTER, TY. M-6.06
- ⑦ SUB-SURFACE DRAIN

FILE NAME : p:\11084E810\INTEG.1\inois.gov\PW\DOT\Documents\DOT Offices\District 3\Projects\036\DRAWING\66H30\TP-detailed.dgn	USER NAME : woodshankr1	DESIGNED - TP	REVISED -	<b>STATE OF ILLINOIS DEPARTMENT OF TRANSPORTATION</b>	<b>TYPICAL SECTIONS</b>	F.A.P. RATE:	SECTION	COUNTY	TOTAL SHEETS	SHEET NO.
	PLLOT SCALE : 100.0000 / 1 in.	CHECKED - RW	REVISED -			68	(105)PP	LIVINGSTON	9	4
Default	PLLOT DATE : 4/1/2017	DATE - 2/24/2017	REVISED -	SCALE:	SHEET OF SHEETS	STA.	TO STA.	CONTRACT NO. 66H30 ILLINOIS FED. AID PROJECT		

PATCHING SCHEDULE FOR NORTHBOUND LANES

LOCATION LOG MILE	DRIVING LANE								LEFT TURN LANE							
	PATCH LENGTH (FT)	CLASS B			DOWEL BARS 1 1/2"	SAW CUTS FOOT	WELDED WIRE REINF. SQ YD	TIE BARS 3/4" EACH	PATCH LENGTH (FT)	CLASS B			DOWEL BARS 1 1/2" EACH	SAW CUTS FOOT	WELDED WIRE REINF. SQ YD	TIE BARS 3/4" EACH
		TYPE II 9" SQ YD	TYPE III 9" SQ YD	TYPE IV 9" SQ YD						TYPE II 9" SQ YD	TYPE III 9" SQ YD	TYPE IV 9" SQ YD				
0.00	6	9			24	54										
0.01	6	9			24	54										
0.01	6	9			24	54										
0.01	6	9			24	54										
0.03	6	9			24	54										
0.05	12		19		24	66	19									
0.08	6	9			24	54										
0.12	12		19		24	66	19									
0.13	20			31	24	82	31	10								
0.14	6	9			24	54										
0.15	6	9			24	54										
0.16	10		16		24	62	16									
0.17	6	9			24	54										
0.17	12		19		24	66	19									
0.18	6	9			24	54										
0.19	8	12			24	58										
0.19	20			31	24	82	31	10								
0.19	6	9			24	54										
0.21	24			37	24	90	37	12								
0.21	12		19		24	66	19									
0.22	12		19		24	66	19									
0.22	6	9			24	54										
0.23	30			47	24	102	47	15								
0.24	6	9			24	54										
0.24	8	12			24	58										
0.25	6	9			24	54										
0.25	6	9			24	54										
0.32	6	9			24	54										
0.32	8	12			24	58										
0.33	10		16		24	62	16									
0.34	6	9			24	54										
0.34	8	12			24	58										
0.35	6	9			24	54										
0.42	6	9			24	54										
0.42	6	9			24	54										
0.43	6	9			24	54										
0.44	12		19		24	66	19									
0.44	6	9			24	54										
0.51	6	9			24	54										
0.52	6	9			24	54										
0.54	6	9			24	54										
0.55	12		19		24	66	19									
0.55	12		19		24	66	19									
0.56	6	9			24	54										
0.60	6	9			24	54										
0.62	12		19		24	66	19									
0.62	8	12			24	58										
0.63	6	9			24	54										
0.64	6	9			24	54										
0.64	6	9			24	54										
0.66	60			93	24	162	93	30								
0.71	6	9			24	54										
0.72	6	9			24	54										
0.73	6	9			24	54										
0.74	6	9			24	54										
NB TOTAL	526	378	203	239	1320	3362	442	77								

TYPE II 9" SQ YD	CLASS B TYPE III 9" SQ YD	TYPE IV 9" SQ YD	DOWEL BARS 1 1/2" EACH	SAW CUTS FOOT	WELDED WIRE REINF. SQ YD	TIE BARS 3/4" EACH
378	203	239	1320	3362	442	77

FILE NAME :	USER NAME : woodshankr1	DESIGNED - TP	REVISED -
p:\11084EBID\INTEG\Illinois.gov\PWIDOT\Do	uranta\DOT Offices\District 3\Projects\030	DRAWN Data\66H30\TR-detailes.dgn	REVISED -
Default	PLOT SCALE = 100.0000' / in.	CHECKED - RW	REVISED -
	PLOT DATE = 4/17/2017	DATE = 2/24/2017	REVISED -

STATE OF ILLINOIS  
DEPARTMENT OF TRANSPORTATION

SCHEDULES

SCALE: SHEET 1 OF 2 SHEETS STA. TO STA.

F.A.P. RTE.	SECTION	COUNTY	TOTAL SHEETS	SHEET NO.
66	(105)PP	LIVINGSTON	9	5
CONTRACT NO. 66H30				
ILLINOIS FED. AID PROJECT				

PATCHING SCHEDULE FOR SOUTHBOUND LANES

LOCATION LOG MILE	DRIVING LANE								LEFT TURN LANE							
	PATCH LENGTH (FT)	CLASS B TYPE II 9"	CLASS B TYPE III 9"	CLASS B TYPE IV 9"	DOWEL BARS 1 1/2"	SAW CUTS FOOT	WELDED WIRE REINF. SO YD	TIE BARS 3/4" EACH	PATCH LENGTH (FT)	CLASS B TYPE II 9"	CLASS B TYPE III 9"	CLASS B TYPE IV 9"	DOWEL BARS 1 1/2" EACH	SAW CUTS FOOT	WELDED WIRE REINF. SO YD	TIE BARS 3/4" EACH
0.01	6	9			24	54										
0.01	6	9			24	54										
0.02	6	9			24	54										
0.03	6	9			24	54										
0.04	6	9			24	54										
0.04	6	9			24	54										
0.05	6	9			24	54										
0.05	6	9			24	54										
0.07	6	9			24	54										
0.08	6	9			24	54										
0.08	6	9			24	54										
0.09	6	9			24	54										
0.12	6	9			24	54										
0.15	6	9			24	54										
0.16	12		19		24	66	19									
0.21	8	12			24	58										
0.22	6	9			24	54										
0.23	6	9			24	54										
0.25	6	9			24	54										
0.25	6	9			24	54										
0.30	6	9			24	54										
0.31	6	9			24	54										
0.31	6	9			24	54										
0.32	6	9			24	54										
0.42	6	9			24	54										
0.44	6	9			24	54			6	8			20	54		
0.44	6	9			24	54			6	8			20	54		
0.45	6	9			24	54			6	8			20	54		
0.50	6	9			24	54			6	8			20	54		
0.51	6	9			24	54			6	8			20	54		
0.51	6	9			24	54			6	8			20	54		
0.52	6	9			24	54			6	8			20	54		
0.52	6	9			24	54			6	8			20	54		
0.61	6	9			24	54										
0.61	6	9			24	54										
0.62	6	9			24	54										
0.62	6	9			24	54										
0.63	6	9			24	54										
0.67	6	9			24	54										
0.68	6	9			24	54										
0.70	6	9			24	54										
0.72	6	9			24	54										
0.73	6	9			24	54										
0.75	6	9			24	54										
SB TOTAL		394	19		1032	2338	19			56			140	378		

TYPE II 9"	CLASS B TYPE III 9"	CLASS B TYPE IV 9"	DOWEL BARS 1 1/2" EACH	SAW CUTS FOOT	WELDED WIRE REINF. SO YD	TIE BARS 3/4" EACH
450	19		1172	2716	19	

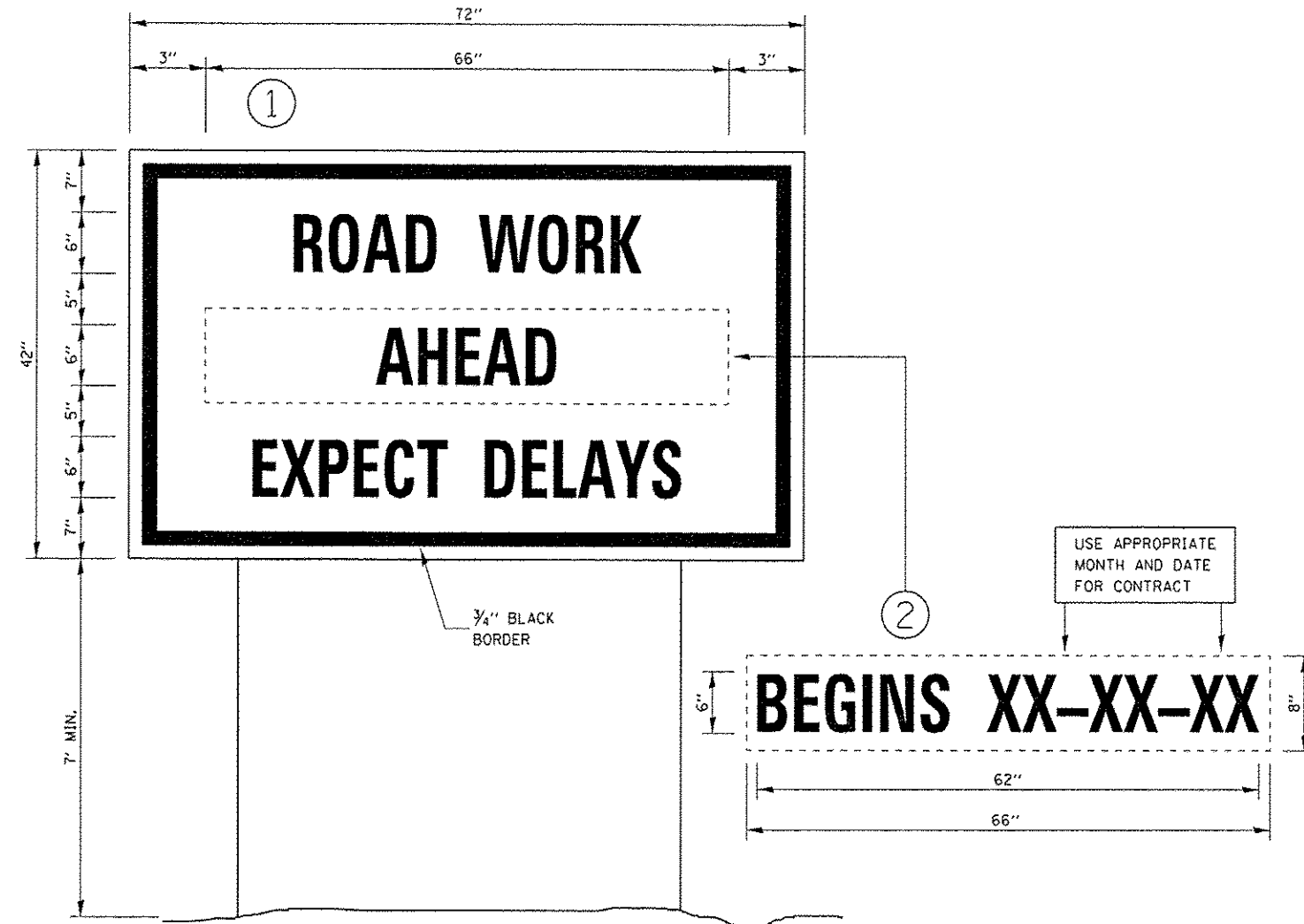

**TEMPORARY INFORMATION SIGNING**

**NOTES:**

1. USE 6" D BLACK LETTERING ON FLUORESCENT ORANGE BACKGROUND.
2. ERECT SIGNS AT LOCATIONS IN ADVANCE OF THE "ROAD CONSTRUCTION AHEAD" SIGNS AS DIRECTED BY THE ENGINEER.
3. ERECT SIGN ① WITH INSTALLED PANEL ② A MINIMUM OF ONE WEEK PRIOR TO THE START OF THE LANE CLOSURE.
4. REMOVE PANEL ② ON THAT DATE.
5. SEE SPECIAL PROVISION "TEMPORARY INFORMATION SIGNING" FOR ADDITIONAL INFORMATION.
6. WILL BE PAID FOR PER 50 FT AS "TEMPORARY INFORMATION SIGNING". EACH SIGN = 21 SQ FT AND THE DATE PANEL ② WILL NOT BE MEASURED SEPARATELY FOR PAYMENT.

**720-8**

FILE NAME :	USER NAME :	DESIGNED -	REVISED -	<b>STATE OF ILLINOIS DEPARTMENT OF TRANSPORTATION</b>	<b>TEMPORARY INFORMATION SIGNING</b>	F.A.P. RTE.	SECTION	COUNTY	TOTAL SHEETS	SHEET NO.	
ps:\IL084EBIDINTEG.illinois.gov\PI\DOT\Documents\DOT Offices\District 3\Projects\036	woodshankr1	TP	-			68	(105)PP	LIVINGSTON	9	7	
		CHECKED -	REVISED -			CONTRACT NO. 66H30					
		RW	-			ILLINOIS FED. AID PROJECT					
Default	PLOT SCALE = 100.0000 1/16"	DATE -	REVISED -	SCALE:	SHEET	OF	SHEETS	STA.	TO	STA.	
	PLOT DATE : 4/1/2017	2/24/2017	-								

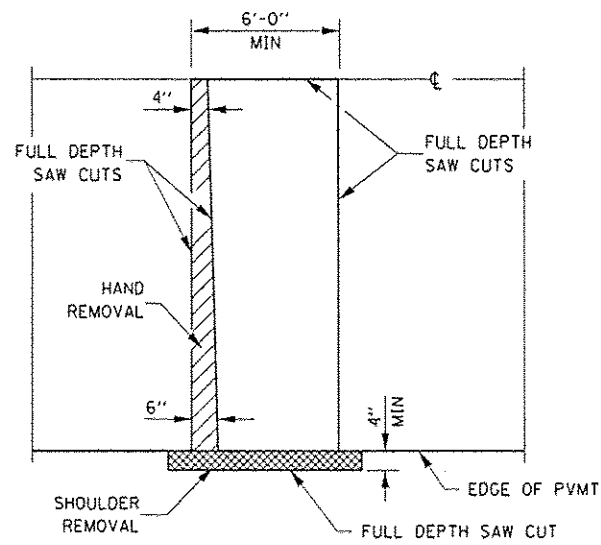

**PAVEMENT SAWING DETAIL**

(HMA SHOULDER)

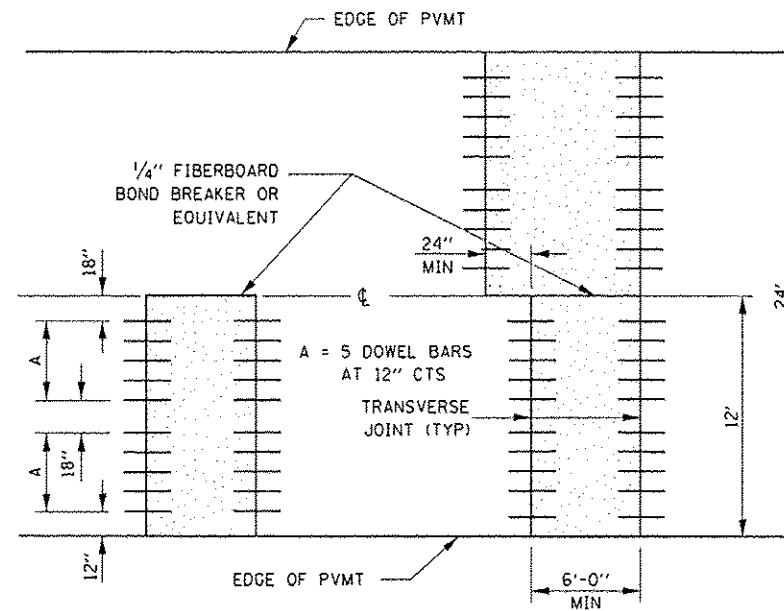

**12' WIDE LANES**

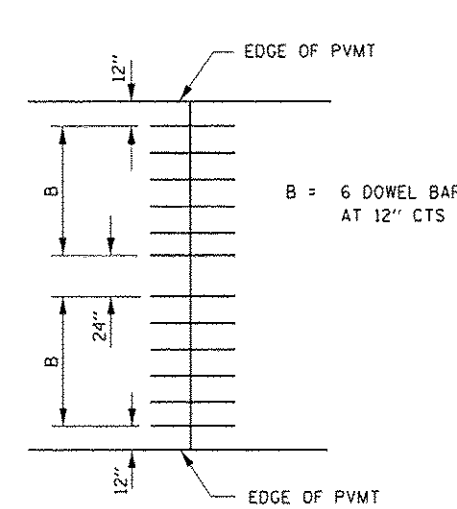

**14' WIDE RAMP**

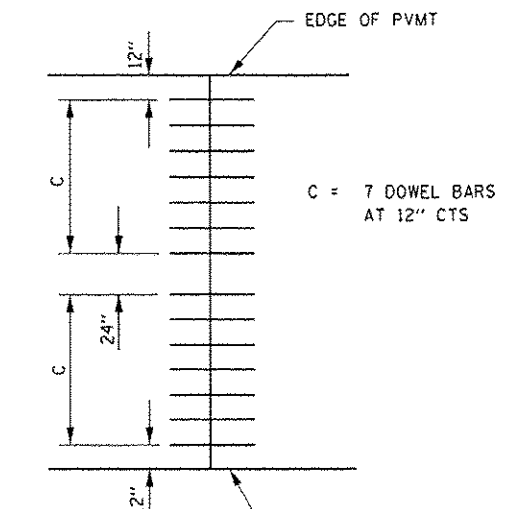

**16' WIDE RAMP**

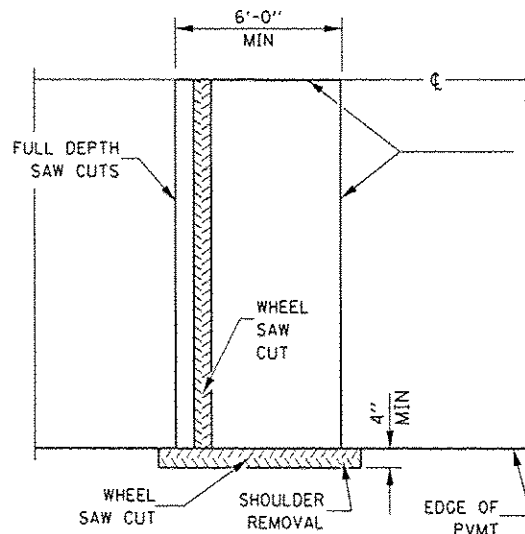

**ALTERNATE SAWING DETAIL**

(HMA SHOULDER)

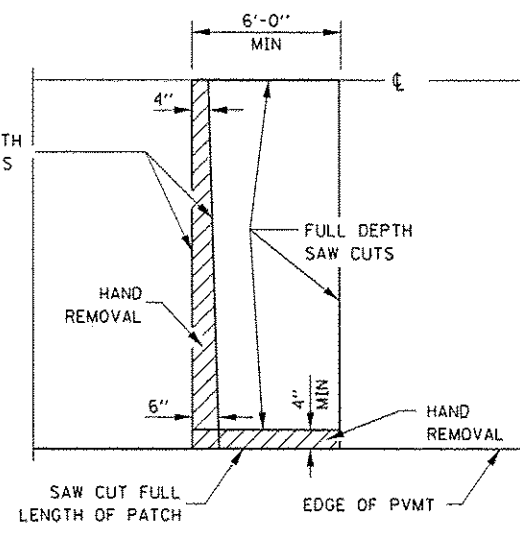

**PAVEMENT SAWING DETAIL**

(PCC SHOULDER)

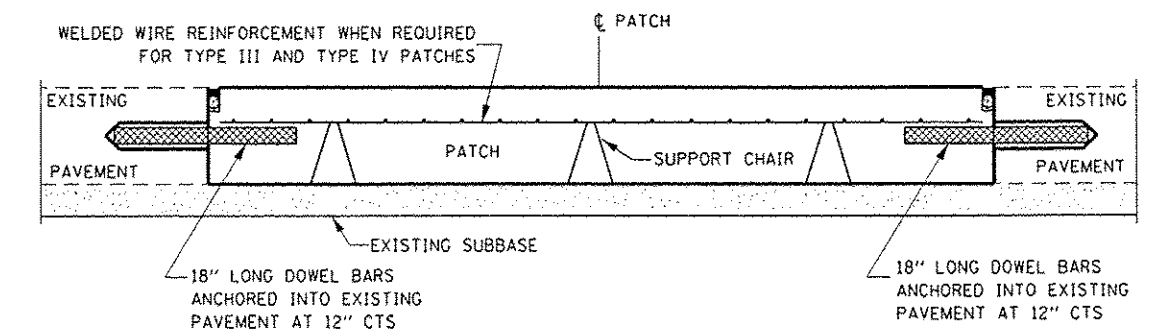

**PATCHING WITHOUT HMA OVERLAY**

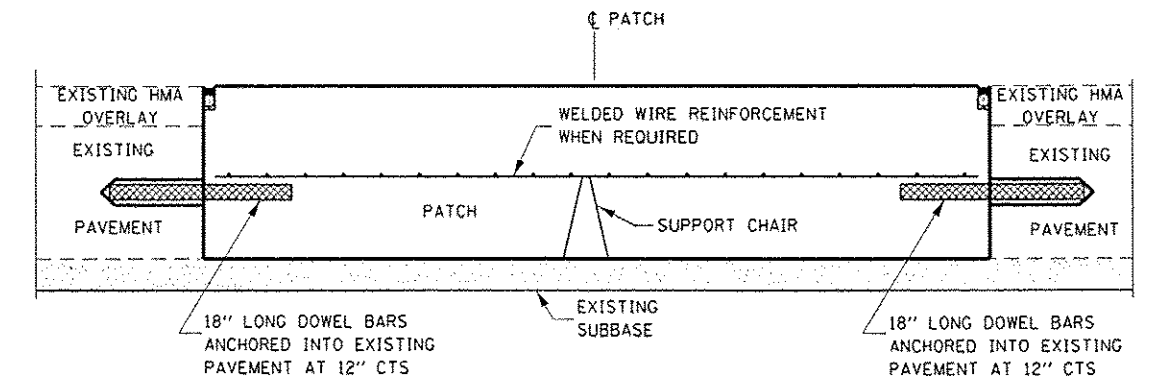

**PATCHING WITH HMA OVERLAY**

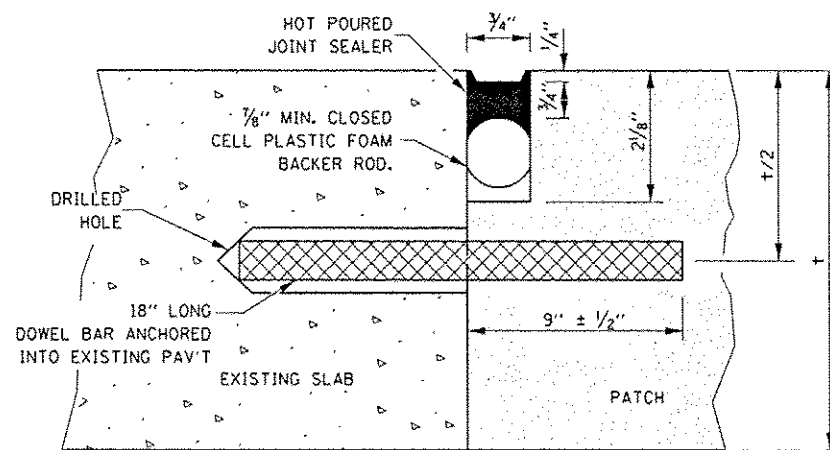

**TRANSVERSE JOINT**

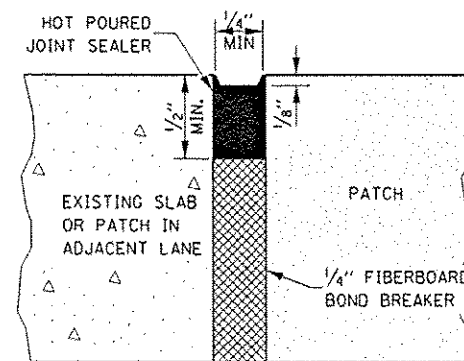

**CENTERLINE JOINT**

DOWEL BAR TABLE		
PAVEMENT THICKNESS	DOWEL BAR DIAMETER	HOLE DIAMETER
8" OR GREATER	1 1/2"	1 5/8"
7" THRU 7.99"	1 1/4"	1 3/8"
LESS THAN 7"	1"	1 1/8"

**GENERAL NOTES**

THE TRANSVERSE JOINTS FOR CLASS B PATCHES SHALL ALIGN WITH JOINTS OR CRACKS IN THE ADJACENT LANE WHENEVER POSSIBLE.

SEE STANDARD 420701 FOR DETAILS OF PAVEMENT WELDED WIRE REINFORCEMENT.

STATE OF ILLINOIS  
DEPARTMENT OF TRANSPORTATION

**CLASS B PATCHING DETAILS**

SCALE: SHEET 1 OF 2 SHEETS STA. TO STA.

F.A.P. R.I.E. 68	SECTION 1105/PP	COUNTY LIVINGSTON	TOTAL SHEETS 9	SHEET NO. 8
ILLINOIS FED. AID PROJECT			CONTRACT NO. 66H30	

442-3

SHEET 1 OF 2

FILE NAME: p:\11084E\BID\INTEG\11084E\DOT Documents\DOT Office\District 3\Projects\036\DRAWN\036\66H30\TP\details.dgn	DESIGNED - TP	REVISIONS -
USER NAME: woodshank1	CHECKED - RW	REVISIONS -
PLOT SCALE: 100.0000 1" = 10'	DATE - 2/24/2017	REVISIONS -



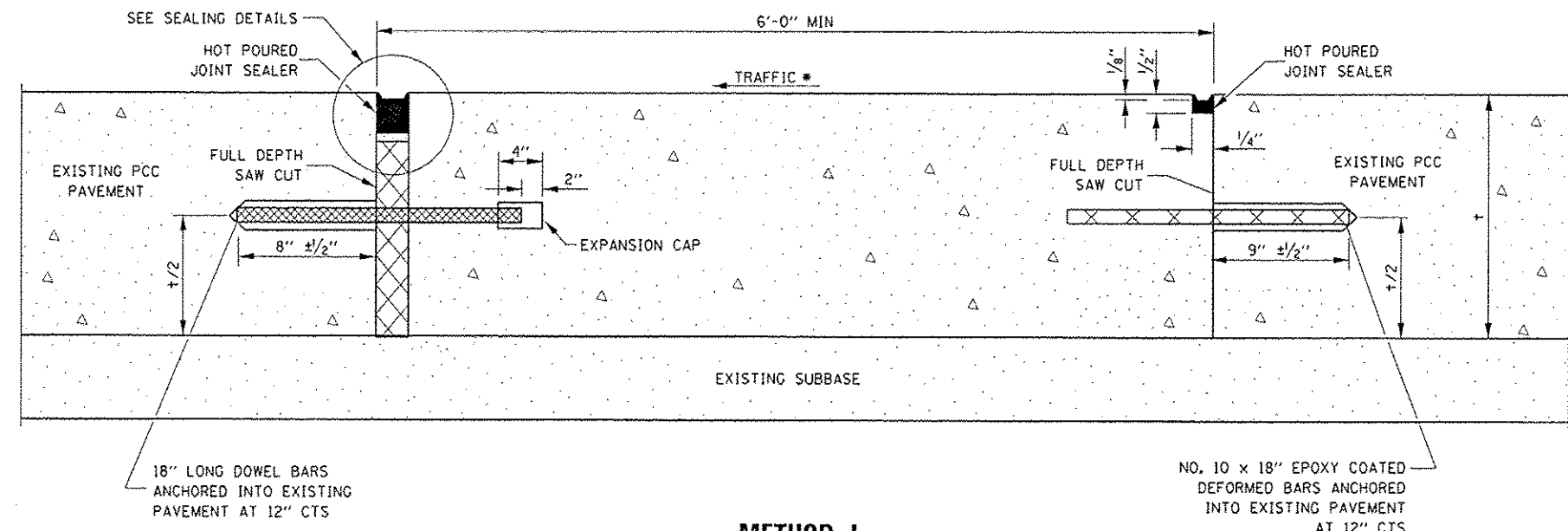

**METHOD I**  
(WITHOUT HMA OVERLAY)

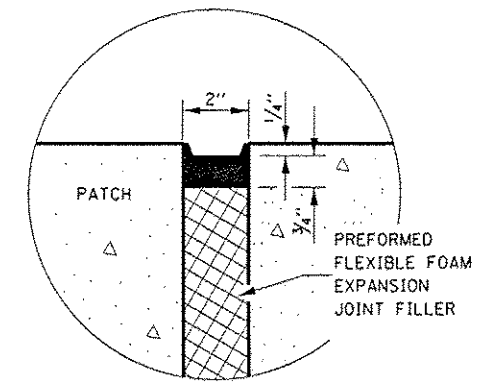

**SEALING DETAIL**

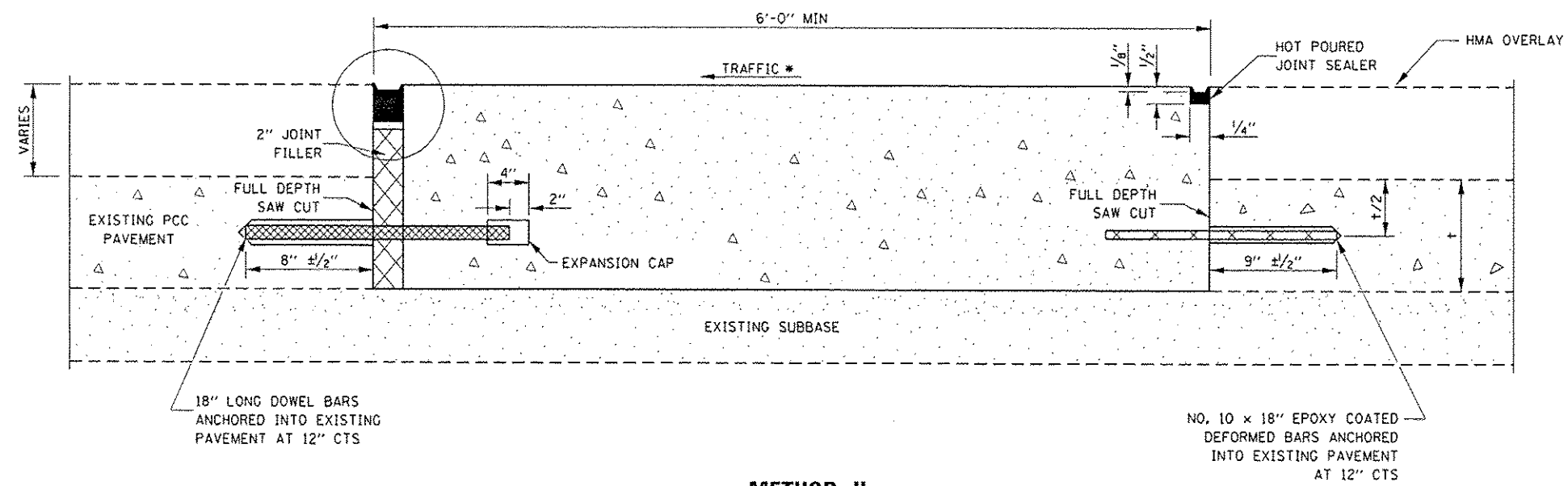

**METHOD II**  
(WITH HMA OVERLAY)

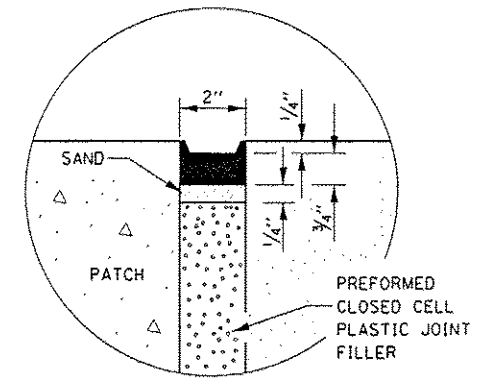

**SEALING DETAIL**

**NOTE**

\* WHEN RE-ESTABLISHING A TRANSVERSE EXPANSION JOINT ON A TWO-WAY ROAD, REVERSE THE ORIENTATION OF THE DOWEL BARS WITH RESPECT TO TRAFFIC FOR ONE OF THE PATCHES SUCH THAT THE JOINT WILL BE CONTINUOUS ACROSS BOTH LANES.

FILE NAME: p:\110846B10\INTEC\Illinois.gov\PW001\Documents\1001\Offices\District 3\Projects\036\DRAWN\036\66H30 TR details.dgn	USER NAME: woodshankr1	DESIGNED: TP	REVISED:	<b>STATE OF ILLINOIS DEPARTMENT OF TRANSPORTATION</b>	<b>CLASS B PATCHING DETAILS</b>	F.A.P. RTE.: 68	SECTION: (105)PP	COUNTY: LIVINGSTON	TOTAL SHEETS: 9	SHEET NO.: 9		
PLOT SCALE: 1/8" = 1'-0"	CHECKED: RW	DATE: 2/24/2017	REVISED:			SCALE:	SHEET 1 OF 2 SHEETS	STA. TO STA.	CONTRACT NO. 66H30			
PLOT DATE: 4/1/2017	DATE: 2/24/2017	REVISED:	REVISED:			ILLINOIS FED. AID PROJECT						