

INDEX OF SHEETS

1. COVER SHEET
2. GENERAL NOTES
3. SUMMARY OF QUANTITIES
4. TYPICAL SECTION
5. SCHEDULES - WESTBOUND
6. SCHEDULES - EASTBOUND

STANDARDS

- | | |
|-----------|--|
| 000001-06 | STANDARD SYMBOLS, ABBREVIATIONS AND PATTERNS |
| 001006 | DECIMAL OF AN INCH AND OF A FOOT |
| 701001-02 | OFF-ROAD OPERATIONS 2L, 2W, MORE THAN 15' (4.5 m) AWAY |
| 701006-05 | OFF-ROAD OPERATIONS 2L, 2W, 15' (4.5 m) TO 24" (600 mm) FROM PAVEMENT EDGE |
| 701336-06 | LANE CLOSURE, 2L, 2W, WORK AREAS IN SERIES, FOR SPEEDS ≥ 45 MPH |
| 701901-06 | TRAFFIC CONTROL DEVICES |

**STATE OF ILLINOIS
DEPARTMENT OF TRANSPORTATION**

**PROPOSED
HIGHWAY PLANS**

**F.A.P. ROUTE 603 (US 52)
SECTION (122,123)PP
HMA PARTIAL DEPTH PATCHING
LASALLE COUNTY**

C-93-075-17

F.A.P. RTE.	SECTION	COUNTY	TOTAL SHEETS	SHEET NO.
603	(122,123)PP	LASALLE	6	1
		ILLINOIS	CONTRACT NO. 66H38	



BEGIN IMPROVEMENT EASTBOUND
E. 8th RD. (L.M. 0.00)

END IMPROVEMENT WESTBOUND
E. 8th RD. (L.M. 9.00)

BEGIN IMPROVEMENT WESTBOUND
SOUTH IL 23 (L.M. 0.00)

END IMPROVEMENT EASTBOUND
SOUTHIL 23 (L.M. 9.00)

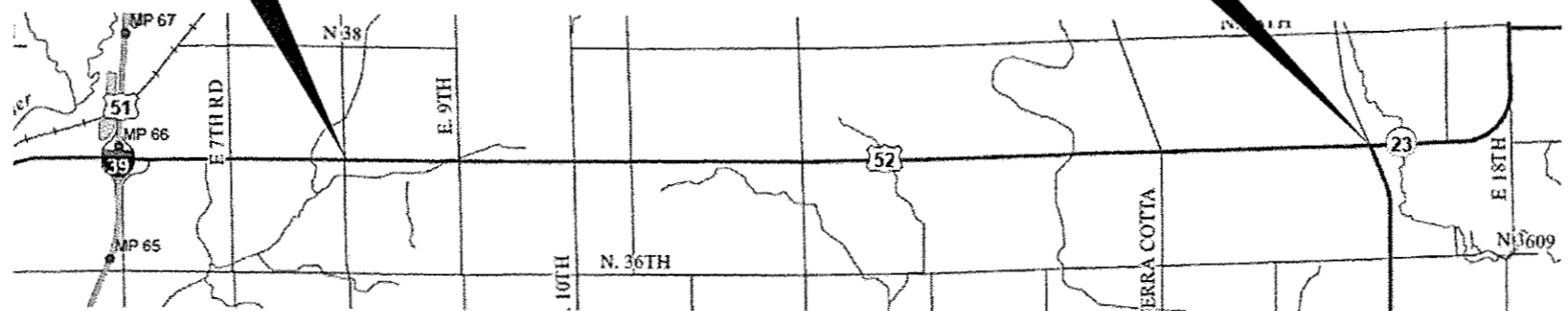

GENERAL NOTES

THE THICKNESS OF HMA SHOWN ON THE PLANS IS THE NOMINAL THICKNESS. DEVIATIONS FROM THE NOMINAL THICKNESS WILL BE PERMITTED WHEN SUCH DEVIATIONS OCCUR DUE TO IRREGULARITIES IN THE EXISTING SURFACE OR BASE ON WHICH THE HMA IS PLACED.

THE ENGINEER WILL BE THE SOLE JUDGE CONCERNING CURING TIME FOR THE VARIOUS HMA LIFTS.

ALL EXCAVATED MATERIAL, WHICH INCLUDES DIGGING OR GRADING OF ANY SOIL OR FILL MATERIAL, WITH THE EXCEPTION OF AGGREGATE FILLS, MUST BE INCORPORATED WITHIN THE IDOT RIGHT OF WAY DUE TO ENVIRONMENTAL DOCUMENTATION REQUIREMENTS.

ON EXISTING PAVEMENT WHICH MAY BE SUPERELEVATED, THE NEW HMA PAVEMENT SHALL BE BUILT WITH THE SAME SUPERELEVATION UNLESS NEW SUPERELEVATION RATES ARE GIVEN ON THE PLANS.

ANY REFERENCE TO A STANDARD IN THESE PLANS SHALL BE INTERPRETED TO MEAN THE EDITION AS INDICATED BY THE SUBNUMBER SHOWN IN THE LIST OF STANDARDS OR THE COPY INCLUDED IN THESE PLANS.

THE FOLLOWING RATES OF APPLICATION HAVE BEEN USED IN CALCULATING PLAN QUANTITIES:

HMA RESURFACING	112	LBS / SQ YD / IN
-----------------	-----	------------------

THE CONTRACTOR SHALL CONTACT JULIE AT LEAST 48 HOURS PRIOR TO EXCAVATION TO DETERMINE WHICH UTILITIES ARE IN THE AREA.

COMMITMENTS

STATE OF ILLINOIS
DEPARTMENT OF TRANSPORTATION
DISTRICT THREE
AS BUILT INFORMATION

SUPERVISING CONSTRUCTION FIELD ENGINEER

RESIDENT ENGINEER / TECHNICIAN

START & END DATES
OF CONSTRUCTION:

INSPECTORS:

DATE:

4-6-17

PREPARED BY:

Don Benoit
DISTRICT STUDIES & PLANS ENGINEER

EXAMINED BY:

Chris C. West
DISTRICT CONSTRUCTION ENGINEER

Michael A. Short
DISTRICT MATERIALS ENGINEER

Jim DeGroot
DISTRICT OPERATIONS ENGINEER

STATE OF ILLINOIS
DEPARTMENT OF TRANSPORTATION

GENERAL NOTES

FILE NAME: p:\11004E81D1NTEG\Illinois.gov\PI100T\Documents\100T Offices\District 3\Projects\0366\DRAWN\66H38 RW\11.dgn	USER NAME: rplntachr	DESIGNED - RW	REVISED -	STATE OF ILLINOIS DEPARTMENT OF TRANSPORTATION	GENERAL NOTES		F.A.P. RTE.	SECTION	COUNTY	TOTAL SHEETS	SHEET NO.		
		CHECKED - EP	REVISED -				603	(122,123)PP		6	2		
		DATE - 3/20/2017	REVISED -				CONTRACT NO. 66H38		ILLINOIS FED. AID PROJECT				
							SCALE:	SHEET 1	OF 1	SHEETS	STA.	TO STA.	

CODE NO.	ITEM	UNIT	TOTAL QUANTITY	CONSTR. CODE
				CONTRACT MAINT. 100% STATE ✓
				ROADWAY
				0005 ✓
				RURAL ✓
40600275	BITUMINOUS MATERIALS (PRIME COAT)	POUND	1295	1295
67100100	MOBILIZATION	LSUM	1	1
70100600	TRAFFIC CONTROL AND PROTECTION, STANDARD 701336	LSUM	1	1
X4421000	PARTIAL DEPTH PATCHING	TON	1290	1290
Z0030850	TEMPORARY INFORMATION SIGNING	50 FT	42	42

5

FILE NAME :	USER NAME : pletschr	DESIGNED - RW	REVISED -	STATE OF ILLINOIS DEPARTMENT OF TRANSPORTATION	SUMMARY OF QUANTITIES				F.A.P. RTE.	SECTION	COUNTY	TOTAL SHEETS	SHEET NO.
p:\L084EBID\INTEG\Illinois.gov\PWDDT\Documents\1001 Offices\District 3\Projects\0306\DRAWN\Data\66H38RW\title.dgn		DRAWN	REVISED		603	022.123PP		6	3				
PLOT SCALE : 100.0000 1/16"	CHECKED - EP	REVISED -			CONTRACT NO. 66H38								
PLOT DATE : 4/5/2017	DATE - 3/20/2017	REVISED -			SCALE:	SHEET 1 OF 1 SHEETS	STA.	TO STA.	ILLINOIS FED. AID PROJECT				

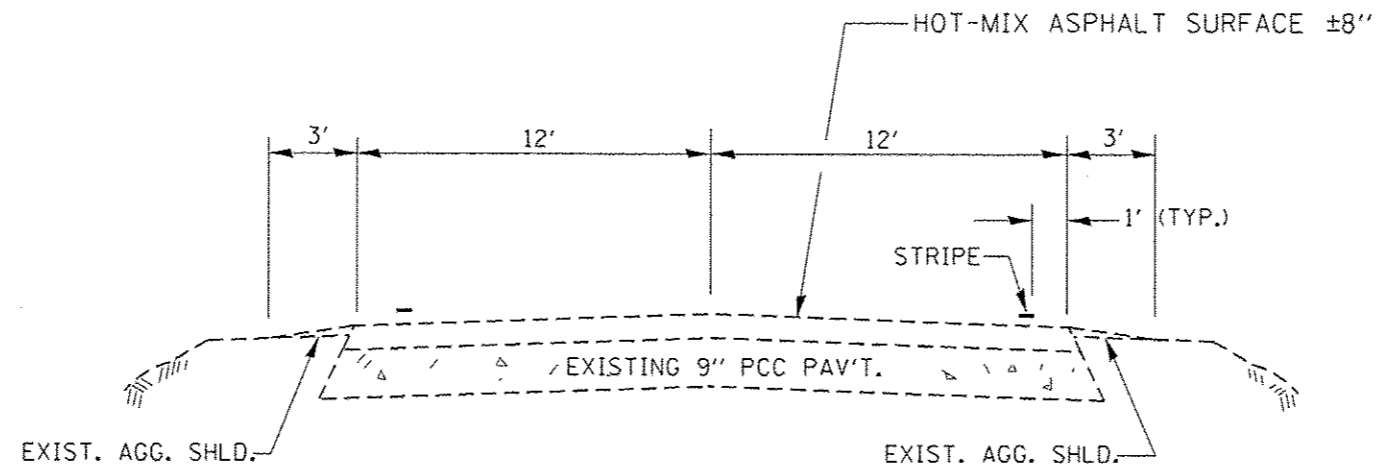

TYPICAL SECTION

HMA MIXTURE REQUIREMENT TABLE	
LOCATION(S):	US 52
MIXTURE USE(S):	HMA
BINDER GRADE (PG):	BINDER
DESIGN AIR VOIDS:	PG64-22
MIXTURE COMPOSITION: (MIXTURE GRADATION):	4% @ N50
FRICTION AGGREGATE:	IL 19.0
MIXTURE WEIGHT:	112.0 LB/SY/IN
QUALITY MANAGEMENT PROGRAM:	QC/OA
SUBLOT SIZE:	
DENSITY TEST METHOD:	CORES

FILE NAME :	USER NAME :	DESIGNED :	REVISED :	STATE OF ILLINOIS DEPARTMENT OF TRANSPORTATION	TYPICAL SECTION	F.A.P. RTE.	SECTION	COUNTY	TOTAL SHEETS	SHEET NO.	
p:\1\1084EBID\INTEG\Illinois.gov\PWIDOT\Documents\IDOT Offices\District 3\Projects\030	plntechr	RW	-			603	(122,123)PP		6	4	
		DRAWN:	REVISED:			CONTRACT NO. 66H38					
		3/20/2017	-			ILLINOIS FED. AID PROJECT					
Default	PLOT SCALE = 100.0000' / 1"	CHECKED :	REVISED :	SCALE:	SHEET 1 OF 1 SHEETS	STA.	TO STA.				

PATCHING SCHEDULE

EASTBOUND LANE				
LOCATION	PATCH LENGTH	PATCH WIDTH	BITUMINOUS MATERIALS (PRIME COAT)	PARTIAL DEPTH PATCHING
LOG MILE	FT	FT	POUND	TON
0.00	INTERSECTION E. 8TH RD.			
0.10	6	12	4	4
0.10	6	12	4	4
0.10	6	12	4	4
0.20	6	12	4	4
0.20	30	6	9	9
0.30	6	12	4	4
0.30	6	12	4	4
0.40	6	12	4	4
0.50	6	12	4	4
0.60	60	6	18	18
0.70	12	12	7	7
0.90	20	6	6	6
0.90	6	12	4	4
1.00	20	6	6	6
1.20	10	12	6	6
1.20	10	12	6	6
1.30	15	6	5	4
1.40	30	12	18	18
1.50	6	12	4	4
1.70	6	12	4	4
1.80	6	12	4	4
1.90	6	12	4	4
2.00	200	6	60	60
2.10	10	12	6	6
2.20	6	12	4	4
2.60	6	12	4	4
2.60	6	12	4	4
2.60	6	12	4	4
2.70	6	12	4	4
2.80	6	12	4	4
2.80	6	12	4	4
3.00	6	12	4	4
3.10	30	6	9	9
3.40	20	12	12	12
3.60	30	6	9	9
3.60	6	12	4	4
3.70	6	12	4	4
3.90	6	12	4	4
4.10	10	6	3	3
4.10	15	12	9	9
4.30	8	12	5	5
4.60	6	12	4	4
4.80	6	12	4	4
4.90	6	12	4	4
5.00	6	12	4	4
5.10	6	12	4	4
5.20	6	12	4	4
5.50	6	12	4	4
5.70	200	6	60	60
5.80	40	6	12	12
5.90	8	12	5	5
6.10	8	12	5	5
6.10	6	12	4	4
6.10	6	12	4	4
6.10	6	12	4	4
6.40	6	12	4	4
6.50	20	12	12	12

PATCHING SCHEDULE

EASTBOUND LANE				
LOCATION	PATCH LENGTH	PATCH WIDTH	BITUMINOUS MATERIALS (PRIME COAT)	PARTIAL DEPTH PATCHING
LOG MILE	(FT)	FT	POUND	TON
6.50	6	12	4	4
6.70	6	12	4	4
6.70	6	12	4	4
6.70	6	12	4	4
6.90	6	12	4	4
7.20	10	12	6	6
7.60	6	12	4	4
7.60	6	12	4	4
7.70	6	12	4	4
7.90	6	12	4	4
8.20	6	12	4	4
8.20	6	12	4	4
8.60	6	12	4	4
8.70	8	12	5	5
8.80	8	15	6	6
8.90	6	15	5	4
SUBTOTALS			70	69

EB TOTALS

BITUMINOUS MATERIALS (PRIME COAT)	PARTIAL DEPTH PATCHING
POUND	TON
498	427