

06-16-2017 LETTING ITEM 236

STATE OF ILLINOIS
DEPARTMENT OF TRANSPORTATION

F.A.P. RTE.	SECTION	COUNTY	TOTAL SHEETS	SHEET NO.
749	(120)SR	DOUGLAS	10	1
		ILLINOIS	CONTRACT NO. 70C86	

FOR INDEX OF SHEETS, SEE SHEET NO. 2
FOR SUMMARY OF QUANTITIES, SEE SHEET NO. 3

**PROPOSED
HIGHWAY PLANS**

F.A.P. ROUTE 749 (IL 133)
SECTION (120)SR

SHOULDER REPAIR
DOUGLAS COUNTY

C-95-042-17
MOULTRIE COUNTY LINE TO 1 MILE EAST OF CHESTERVILLE

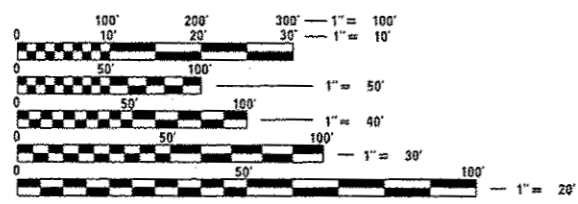

FULL SIZE PLANS HAVE BEEN PREPARED USING STANDARD ENGINEERING SCALES. REDUCED SIZED PLANS WILL NOT CONFORM TO STANDARD SCALES. IN MAKING MEASUREMENTS ON REDUCED PLANS, THE ABOVE SCALES MAY BE USED.

J.U.L.I.E.
JOINT UTILITY LOCATION INFORMATION FOR EXCAVATION
1-800-892-0123
OR 811
BOURBON TOWNSHIP

PROJECT ENGINEER: KEVIN TRAPP
PHONE: 217-465-4181

CONTRACT NO. 70C86

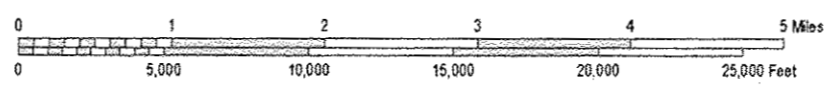
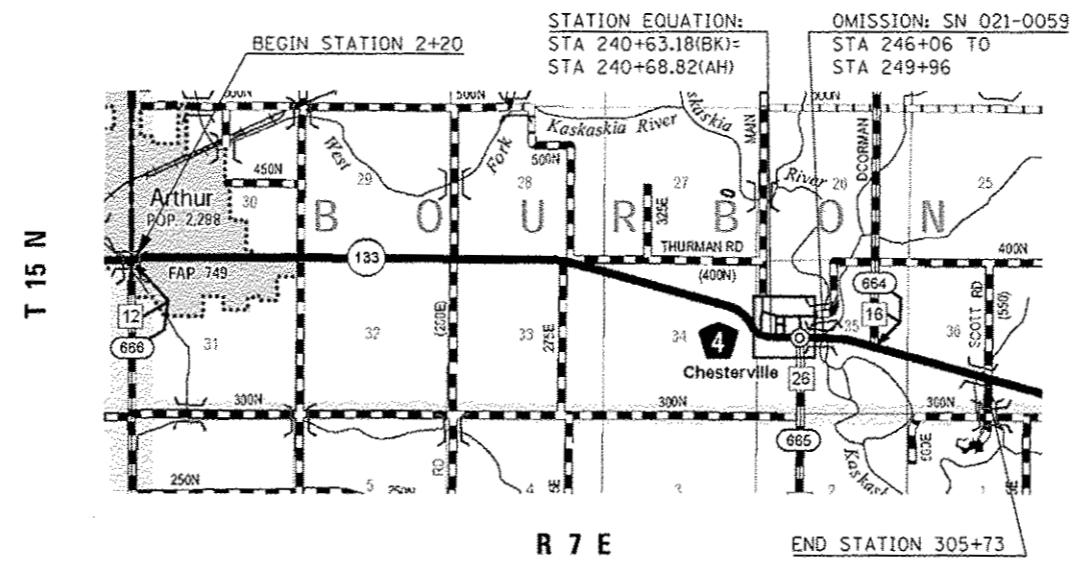

GROSS LENGTH = 30,347.36 FT. = 5.804 MILES
NET LENGTH = 29,957.36 FT. = 5.673 MILES

STATE OF ILLINOIS
DEPARTMENT OF TRANSPORTATION

SUBMITTED APRIL 6 2017
Kensel A. Jameth
REGIONAL ENGINEER

MAY 12 2017
Maureen M. Addis PE
ENGINEER OF DESIGN AND ENVIRONMENT

MAY 12 2017
[Signature]
DIRECTOR OF PROGRAM DEVELOPMENT

PRINTED BY THE AUTHORITY
OF THE STATE OF ILLINOIS

INDEX OF SHEETS

SHEET NO.	DESCRIPTION
1	COVER SHEET
2	INDEX OF SHEETS
2	LIST OF STANDARDS
2	GENERAL NOTES
3	SUMMARY OF QUANTITIES
4-9	TYPICAL CROSS SECTIONS
10	SCHEDULE OF QUANTITIES

GENERAL NOTES

G.N.-100
ENGLISH UNITS OF MEASUREMENT SHALL GOVERN OVER AND SUPERSEDE ANY METRIC UNITS SHOWN IN THIS CONTRACT. WHERE INCLUDED, METRIC UNITS ARE FOR INFORMATION ONLY.

G.N.-100A
ELECTRONIC FILES AND/OR ELECTRONIC SURVEY INFORMATION INCLUDING CADD FILES WILL NOT BE AVAILABLE TO THE CONTRACTOR.

G.N.-105.09A
ALL ELEVATIONS SHOWN IN THE PLANS ARE BASED ON NORTH AMERICAN VERTICAL DATUM OF 1988. (NAVD 88)

G.N.-406
THE QUANTITIES INCLUDED IN THE PLANS FOR HOT-MIX ASPHALT RESURFACING ARE INTENDED TO GIVE THE COVERAGE SHOWN ON THE TYPICAL CROSS SECTIONS. IT IS NOT INTENDED TO INCREASE THE THICKNESS OF THE HOT-MIX ASPHALT MIXTURE IN ORDER TO USE ALL OF THE QUANTITIES INCLUDED IN THE CONTRACT.

G.N. -406H

MIXTURE REQUIREMENTS

THE FOLLOWING MIXTURE REQUIREMENTS ARE APPLICABLE FOR THIS PROJECT:

LOCATION(S):	IL 133 SHOULDERS
MIXTURE USE(S):	HMA SHOULDER SPECIAL
AC/PG:	SBS PG 70 - 22
DESIGN AIR VOIDS	4.0% @ Ndes=50
MIXTURE COMP (GRADATION)	IL 9.5, SEE HMA SPECIAL PROVISION FOR REQUIREMENTS
FRICTION AGGREGATE	MIX "E"
MIXTURE WEIGHT	112
QUALITY MANAGEMENT PROGRAM	QC/QA
SUBLOT SIZE	N.A.

G.N.- 667
THE RESIDENT ENGINEER SHALL CONTACT THE PROGRAM DEVELOPMENT CHIEF OF SURVEYS PRIOR TO THE PRE-CONSTRUCTION CONFERENCE FOR INSTRUCTION AS TO SETTING OF TEMPORARY OR PERMANENT TIES FOR CENTERLINE ALIGNMENT CONTROL SURVEY MARKERS (PC'S, PT'S, AND PI'S). PROJECT IMPLEMENTATION PERSONNEL WILL BE RESPONSIBLE FOR LAYOUT OF THESE MARKERS.

COMMITMENTS

THERE ARE NO COMMITMENTS FOR THIS CONTRACT.

HIGHWAY STANDARDS

STANDARD NO.	NAME OF STANDARD
000001-06	STANDARD SYMBOLS, ABBREVIATIONIS AND PATTERNS
001006	DECIMAL OF AN INCH AND OF A FOOT
701006-05	OFF-ROAD OPERATIONS, 2L, 2W, 15' TO 24" FROM PAVEMENT EDGE
701301-04	LANE CLOSURE, 2L, 2W, SHORT TERM OPERATIONS
701306-03	LANE CLOSURE, 2L, 2W, SLOW MOVING OPERATIONS DAY ONLY FOR SPEEDS ≥ 45 MPH
701501-06	URBAN LANE CLOSURE, 2L, 2W, UNDIVIDED
701801-06	SIDEWALK, CORNER OR CROSSWALK CLOSURE
701901-06	TRAFFIC CONTROL DEVICES

**STATE OF ILLINOIS
DEPARTMENT OF TRANSPORTATION**

**INDEX OF SHEETS, HIGHWAY STANDARDS,
& GENERAL NOTES**

F.A.P. RTE.	SECTION	COUNTY	TOTAL SHEETS	SHEET NO.
749	(120)SR	DOUGLAS	10	2
CONTRACT NO. 70C86				
[ILLINOIS] FED. AID PROJECT				

FILE NAME =	USER NAME = oearlockjd	DESIGNED -	REVISED -
p:\IL\204EBID\TEG\illinois.gov\PWIDOT\Documents\DOT Offices\District 5\Projects\0577\DRAWING\DATA\640\sheet\05770C86-sht-Gen		CHECKED -	REVISED -
#MODELNAME#	PLOT SCALE = 48.0000 ' / in.	DATE -	REVISED -
	PLOT DATE = 4/6/2017		

SCALE: SHEET 1 OF 1 SHEETS STA. TO STA.

005 0 7 876

LOCATION OF WORK: F. A. P. 749 (IL 133)

2 LANE RURAL ✓

COUNTY: DOUGLAS

STA. 2+20.00 TO STA. 305+73.00

FUNDING BREAKOUT: 100% STATE ✓

CONSTRUCTION TYPE CODE: 0005 ✓

CODE NO.	ITEM	UNIT	TOTAL
40600290	BITUMINOUS MATERIALS (TACK COAT)	POUND	7,490.0
44000158	HOT-MIX ASPHALT SURFACE REMOVAL, 2 1/4"	SQ YD	16,643.0
67100100	MOBILIZATION	L SUM	1.0
70100460	TRAFFIC CONTROL AND PROTECTION, STANDARD 701306	L SUM	1.0
70102620	TRAFFIC CONTROL AND PROTECTION, STANDARD 701501	L SUM	1.0
70102640	TRAFFIC CONTROL AND PROTECTION, STANDARD 701801	L SUM	1.0
X4823105	HOT-MIX ASPHALT SHOULDERS, SPECIAL	TON	2,097.0

① EXISTING TYPICAL CROSS SECTION ①

STATION TO STATION
2+20.00 143+95.00 ②

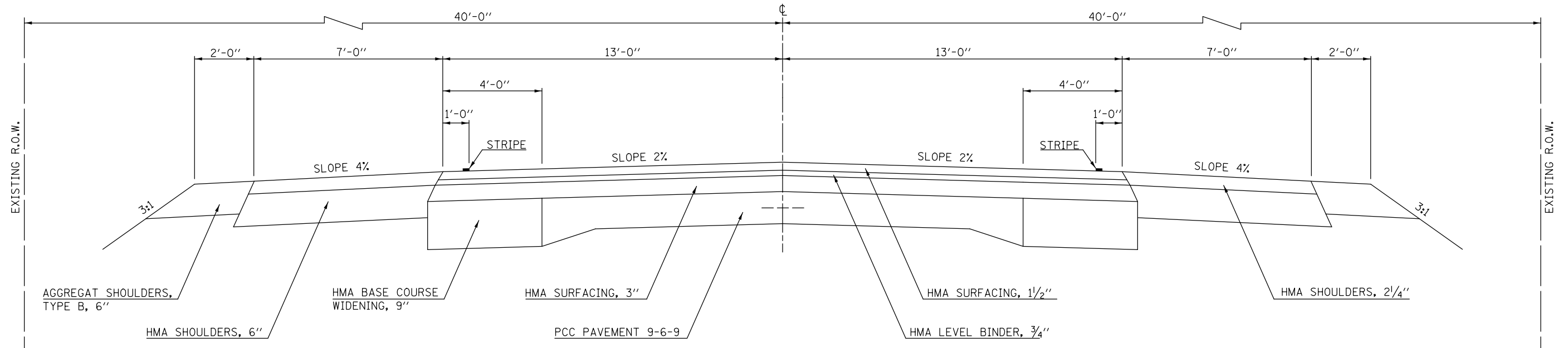

① PROPOSED TYPICAL CROSS SECTION ①

STATION TO STATION
2+20.00 143+95.00 ②

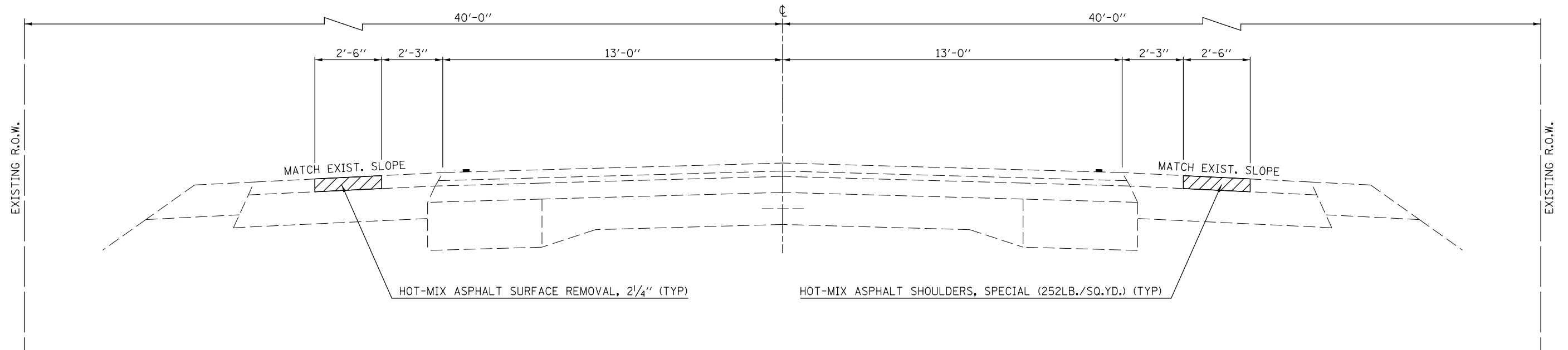

FILE NAME =	USER NAME = ceerlockjd	DESIGNED -	REVISED -	STATE OF ILLINOIS DEPARTMENT OF TRANSPORTATION	TYPICAL CROSS SECTIONS			F.A.P. RTE.	SECTION	COUNTY	TOTAL SHEETS	SHEET NO.	
DRAWN BY =								SCALE:			749	(120)SR	DOUGLAS
CHECKED -					SHEET 1 OF 6 SHEETS			CONTRACT NO. 70C86		ILLINOIS FED. AID PROJECT			
DATE -					STA. TO STA.								

② EXISTING TYPICAL CROSS SECTION ②

	STATION	TO	STATION	
①	143+95.00		156+25.00	③
④	209+04.00		220+42.50	⑤
③	252+50.00		259+22.00	③

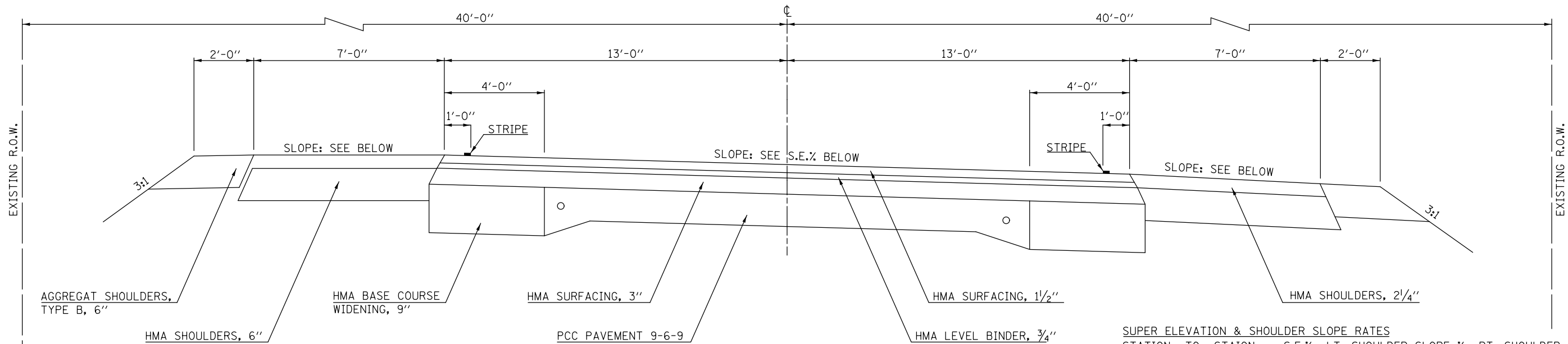

SUPER ELEVATION & SHOULDER SLOPE RATES				
STATION	TO STAION	S.E. %	LT. SHOULDER SLOPE %	RT. SHOULDER SLOPE %
143+95.00	156+25.00	4%	-4%	4%
209+04.00	220+42.50	6%	-4%	4%
250+09.00	259+22.00	4%	-4%	4%

② PROPOSED TYPICAL CROSS SECTION ②

	STATION	TO	STATION	
①	143+95.00		156+25.00	③
④	209+04.00		220+42.50	⑤
③	252+50.00		259+22.00	③

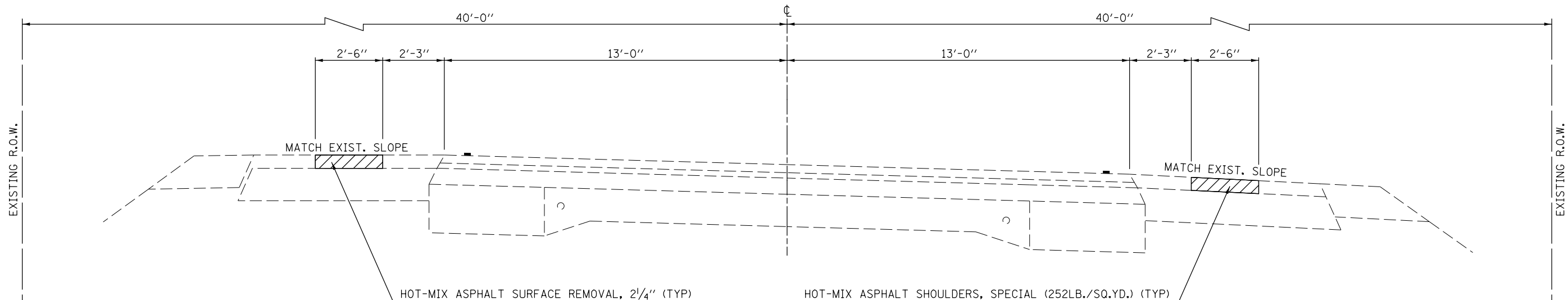

③ EXISTING TYPICAL CROSS SECTION ③

STATION EQUATION:
STA. 240+63.18(BK) = STA. 240+68.62 (AH)

STATION	TO	STATION	
② 156+25.00		④ 160+00.00	
⑤ 229+65.00		② 243+50.00	
② 259+22.00		⑥ 264+99.00	

OMISSION: SN 021-0059
STA 246+06 TO STA 249+96

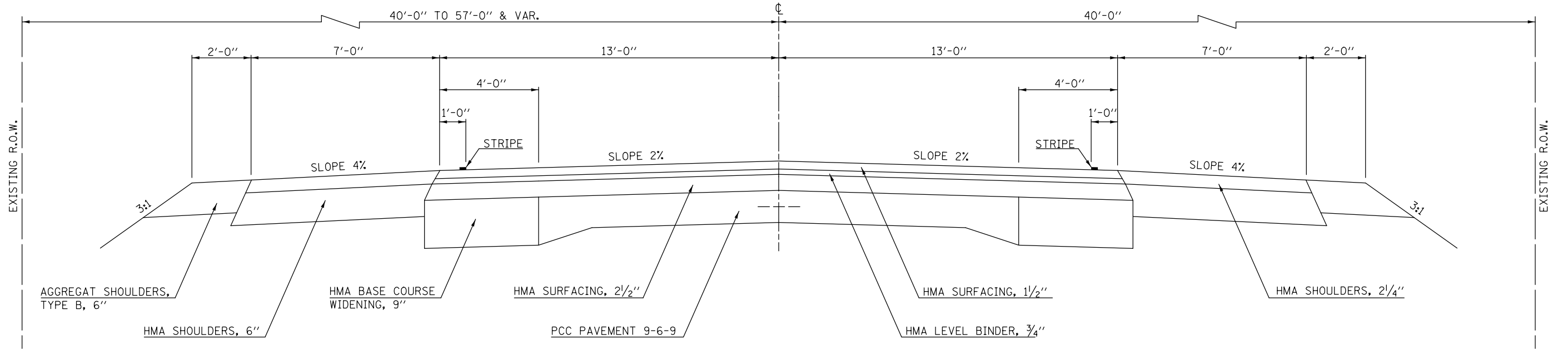

③ PROPOSED TYPICAL CROSS SECTION ③

STATION EQUATION:
STA. 240+63.18(BK) = STA. 240+68.62 (AH)

STATION	TO	STATION	
② 156+25.00		④ 160+00.00	
⑤ 229+65.00		② 243+50.00	
② 259+22.00		⑥ 264+99.00	

OMISSION: SN 021-0059
STA 246+06 TO STA 249+96

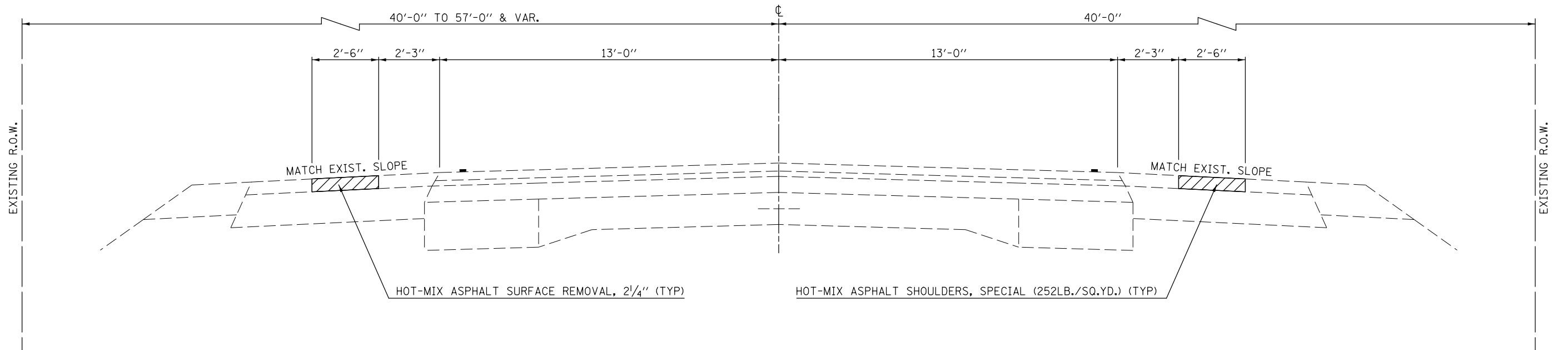

④ EXISTING TYPICAL CROSS SECTION ④

③ STATION 160+00.00 TO STATION 209+04.00 ②

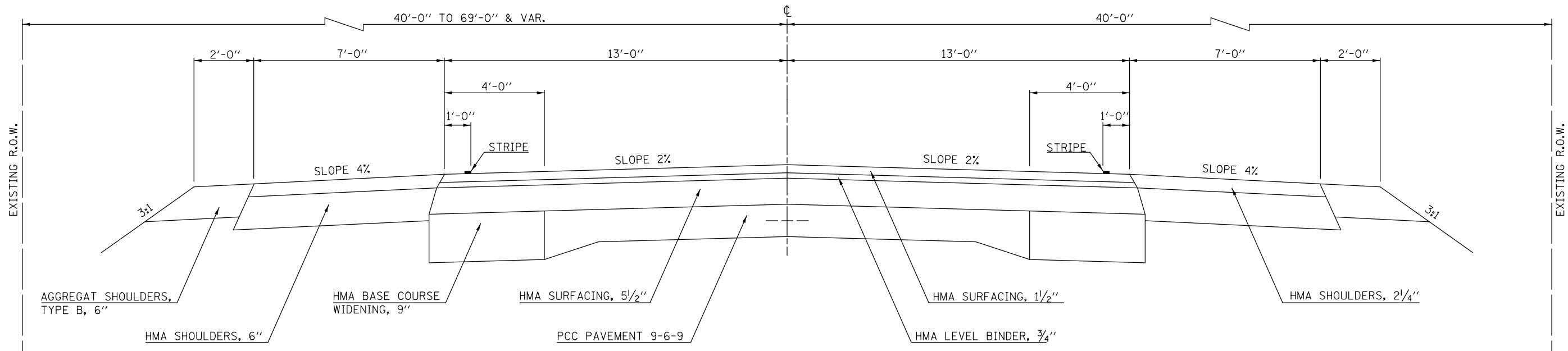

④ PROPOSED TYPICAL CROSS SECTION ④

③ STATION 160+00.00 TO STATION 209+04.00 ②

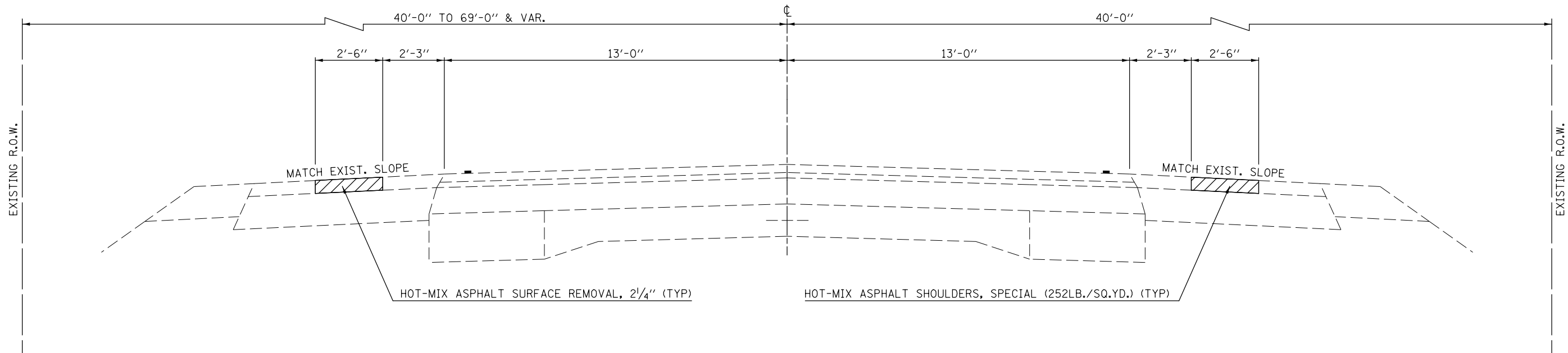

FILE NAME =	USER NAME = ceerlockjd	DESIGNED -	REVISED -	STATE OF ILLINOIS DEPARTMENT OF TRANSPORTATION	TYPICAL CROSS SECTIONS			F.A.P. RTE.	SECTION	COUNTY	TOTAL SHEETS	SHEET NO.
p:\11\084EBID\INTEG.illinois.gov\PIWIDOT\Documents\IDOT Offices\District 5\Projects\057\KBRAND\Drawings\60\Sheets\0570C86-sht-Typical	DRAWN -	CHECKED -	REVISED -					749	(120)SR	DOUGLAS	10	7
PLOT SCALE = 40.0000' / in.	CHECKED -	REVISED -	REVISED -		SCALE: SHEET 4 OF 6 SHEETS STA. TO STA.			CONTRACT NO. 70C86				
*MODELNAME#	DATE -	REVISED -	REVISED -		ILLINOIS FED. AID PROJECT							

⑤ EXISTING TYPICAL CROSS SECTION ⑤

② STATION 220+42.50 TO STATION 229+65.00 ③

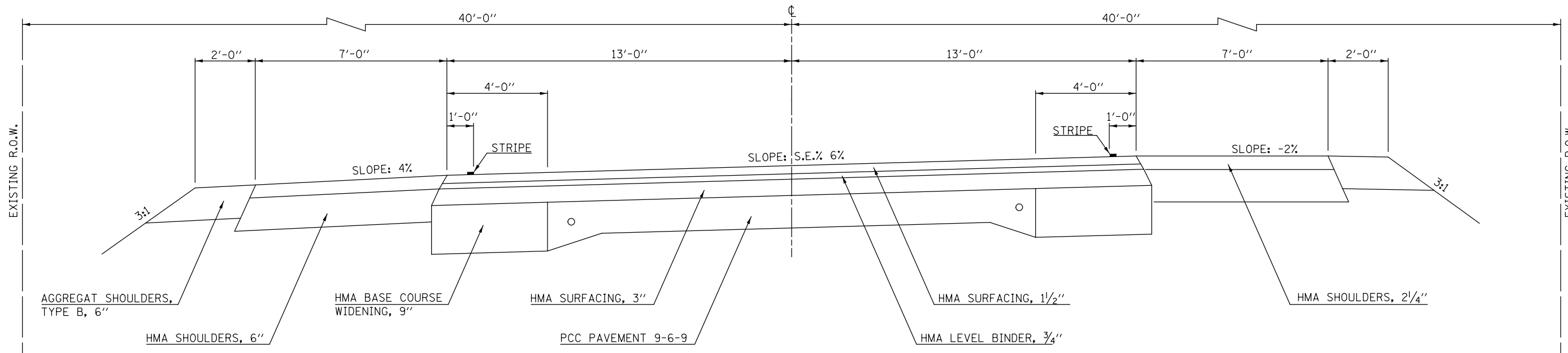

⑤ PROPOSED TYPICAL CROSS SECTION ⑤

② STATION 220+42.50 TO STATION 229+65.00 ③

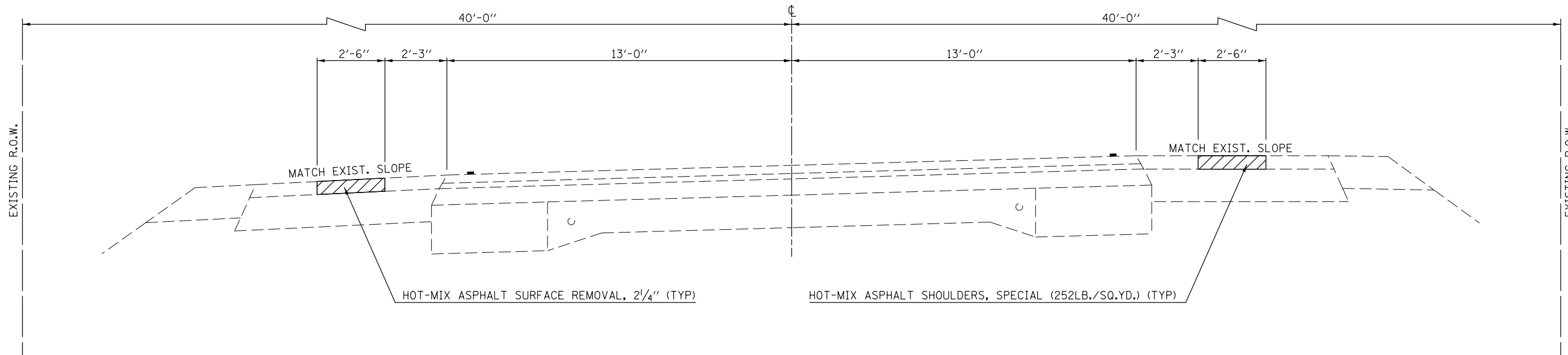

FILE NAME =	USER NAME = ceerlockjd	DESIGNED -	REVISED -	STATE OF ILLINOIS DEPARTMENT OF TRANSPORTATION	TYPICAL CROSS SECTIONS				F.A.P. RTE.	SECTION	COUNTY	TOTAL SHEETS	SHEET NO.
p:\11\084EBID\INTEG.illinois.gov\PWIDOT\Documents\IDOT Offices\District 5\Projects\057\KBR\Drawings\EA0\Sheets\0570C86-sh-typical	DRAWN BY =	CHECKED -	REVISED -		749	(120)SR	DOUGLAS	10	8				
PLOT SCALE = 40.0000' / in.	DATE =	DATE =	DATE =		CONTRACT NO. 70C86								
*MODELNAME#	PLOT DATE = 4/6/2017	DATE =	DATE =		SCALE:	SHEET 5 OF 6 SHEETS	STA.	TO STA.	ILLINOIS FED. AID PROJECT				

44000158 - HOT-MIX ASPHALT SURFACE REMOVAL, 2 1/4"

ROUTE	LOCATION	STATION	TO	STATION	LENGTH (FT)	AVERAGE WIDTH (FT)	QUANTITY (SQ YD)
FAP 749	E.B. SHLDR	2+20.00		305+73.00	29,957.4	2.5	8,321.5
FAP 749	W.B.SHLDR	2+20.00		305+73.00	29,957.4	2.5	8,321.5
SUB TOTAL =							16,643.0
TOTAL =							16,643.0
							SQ YD

STATION EQUATION:
 STA 240+63.18(BK)=
 STA 240+68.82(AH)

OMISSION: SN 021-0059
 STA 246+06 TO
 STA 249+96

HOT-MIX ASPHALT SCHEDULE

ROUTE	LOCATION	STATION	TO	STATION	LENGTH (FT)	AVERAGE WIDTH (FT)	AREA (SQ YD)	HMA SURFACE THICKNESS (INCHES)	40600290	X4823105
									BITUMINOUS MATERIAL TACK COAT (POUND)	HOT-MIX ASPHALT SHOULDERS, SPL (TON)
FAP 749	E.B. SHLDR	2+20.00		305+73.00	29,957.4	2.5	8,321.5	2.25	3,744.7	1,048.5
FAP 749	W.B.SHLDR	2+20.00		305+73.00	29,957.4	2.5	8,321.5	2.25	3,744.7	1,048.5
SUB TOTAL =									7,489.4	2,097.0
TOTAL =									7,490.0	2,097.0
									POUND	TON

STATION EQUATION:
 STA 240+63.18(BK)=
 STA 240+68.82(AH)

OMISSION: SN 021-0059
 STA 246+06 TO
 STA 249+96