

CODE NO.	ITEM	UNIT	TOTAL QUANTITY	CONSTRUCTION CODE			
				80% FEDERAL 20% LOCAL	80% FEDERAL 20% LOCAL	80% FEDERAL 20% LOCAL	100% LOCAL
				ROADWAY	STRUCTURES	SIGNALS	NON-PART.
				0005 URBAN	0011 URBAN	0021 URBAN	0043 URBAN
54003000	CONCRETE BOX CULVERTS	CU YD	466.4	0	466.4	0	0
54213657	PRECAST REINFORCED CONCRETE FLARED END SECTIONS 12"	EACH	3	3	0	0	0
54213663	PRECAST REINFORCED CONCRETE FLARED END SECTIONS 18"	EACH	1	1	0	0	0
550A0040	STORM SEWERS, CLASS A, TYPE 1 10"	FOOT	65	0	0	0	65
550A0050	STORM SEWERS, CLASS A, TYPE 1 12"	FOOT	134	134	0	0	0
SP 55100400	STORM SEWER REMOVAL 10"	FOOT	68	0	0	0	68
SP 55100700	STORM SEWER REMOVAL 15"	FOOT	26	26	0	0	0
60218400	MANHOLES, TYPE A, 4' -DIAMETER, TYPE 1 FRAME, CLOSED LID	EACH	1	1	0	0	0
60240220	INLETS, TYPE B, TYPE 3 FRAME AND GRATE	EACH	1	1	0	0	0
60500060	REMOVING INLETS	EACH	3	3	0	0	0
SP 60603800	COMBINATION CONCRETE CURB AND GUTTER, TYPE B-6.12	FOOT	40	40	0	0	0
SP 60604400	COMBINATION CONCRETE CURB AND GUTTER, TYPE B-6.18	FOOT	1,025	1025	0	0	0
SP 67000400	ENGINEER'S FIELD OFFICE, TYPE A	CAL MO	12	12	0	0	0
67100100	MOBILIZATION	LSUM	1	1	0	0	0

SP SEE SPECIAL PROVISION
* SPECIALTY ITEM

DESIGNED	MWH	01/04/17
DRAWN	MWH	4/18/17
REVIEWED	KMA	4/18/17

FILE NAME = 14L0113-sh-t-S00-04.dgn	USER NAME = anderr02833	DESIGNED - MWH	REVISED - REV. 6/6/2017
		DRAWN - MWH	REVISED -
		CHECKED - KMA	REVISED -
		DATE - 4/19/17	REVISED -

**STATE OF ILLINOIS
DEPARTMENT OF TRANSPORTATION**

SUMMARY OF QUANTITIES

SCALE: NTS SHEET NO. OF SHEETS STA. TO STA.

F.A.P. RTE.	SECTION	COUNTY	TOTAL SHEETS	SHEET NO.
0412	14-00609-00-BR	WINNEBAGO	89	5
CONTRACT NO. 85656			ILLINOIS FED. AID PROJECT	

S00-04

CODE NO.	ITEM	UNIT	TOTAL QUANTITY	CONSTRUCTION CODE			
				80% FEDERAL 20% LOCAL ROADWAY	80% FEDERAL 20% LOCAL STRUCTURES	80% FEDERAL 20% LOCAL SIGNALS	100% LOCAL NON-PART.
				0005	0011	0021	0043
				URBAN	URBAN	URBAN	URBAN
* 78000400	THERMOPLASTIC PAVEMENT MARKING - LINE 6"	FOOT	767	767	0	0	0
* 78000500	THERMOPLASTIC PAVEMENT MARKING - LINE 8"	FOOT	359	359	0	0	0
* 78000600	THERMOPLASTIC PAVEMENT MARKING - LINE 12"	FOOT	257	257	0	0	0
* 78000650	THERMOPLASTIC PAVEMENT MARKING - LINE 24"	FOOT	149	149	0	0	0
* 78100100	RAISED REFLECTIVE PAVEMENT MARKER	EACH	87	87	0	0	0
* 81028320	UNDERGROUND CONDUIT, PVC, 1" DIA.	FOOT	20	0	0	20	0
* 81028350	UNDERGROUND CONDUIT, PVC, 2" DIA.	FOOT	59	0	0	59	0
SP * 85000200	MAINTENANCE OF EXISTING TRAFFIC SIGNAL INSTALLATION	EACH	2	0	0	2	0
* 87301215	ELECTRIC CABLE IN CONDUIT, SIGNAL NO. 14 2C	FOOT	597	0	0	597	0
* 87301225	ELECTRIC CABLE IN CONDUIT, SIGNAL NO. 14 3C	FOOT	642	0	0	642	0
SP * 87301900	ELECTRIC CABLE IN CONDUIT, EQUIPMENT GROUNDING CONDUCTOR, NO. 6 1C	FOOT	88	0	0	88	0
SP * 87502440	TRAFFIC SIGNAL POST, GALVANIZED STEEL 10 FT.	EACH	3	0	0	3	0
SP * 87800100	CONCRETE FOUNDATION, TYPE A	FOOT	9	0	0	9	0
* 87900200	DRILL EXISTING HANDHOLE	EACH	5	0	0	5	0

SP SEE SPECIAL PROVISION
 * SPECIALTY ITEM

DESIGNED	01/06/17
DRAWN	4/18/17
REVIEWED	KMA
	4/18/17

FILE NAME = 14L0113-shv-s00-06.dgn	USER NAME = andr-00033	DESIGNED - MWH	REVISED - REV. 6/6/2017
		DRAWN - MWH	REVISED -
		CHECKED - KMA	REVISED -
		DATE - 4/19/17	REVISED -

**STATE OF ILLINOIS
 DEPARTMENT OF TRANSPORTATION**

SUMMARY OF QUANTITIES

SCALE: NTS SHEET NO. OF SHEETS STA. TO STA.

F.A.P. RTE.	SECTION	COUNTY	TOTAL SHEETS	SHEET NO.
0412	14-00609-00-BR	WINNEBAGO	89	8
CONTRACT NO. 85656			S00-06	
ILLINOIS FED. AID PROJECT				

HMA PAVEMENT (FULL-DEPTH), 8" SCHEDULE				
SHEET	FROM	TO	TOTAL (SQ FT)	TOTAL (SQ YD)
RDY-02	29+45.00	30+55.00	5370	600.0
TOTAL			5370	600.0

PCC SIDEWALK 5 INCH SCHEDULE				
SHEET	FROM	TO	OFFSET	TOTAL (SQ FT)
RDY-01	21+19.0	21+52.5	LT	197.4
RDY-01	20+98.7	21+28.6	RT	311.1
RDY-02	27+18.4	27+59.2	LT	296.9
RDY-02	27+72.8	28+22.2	LT	258.3
RDY-02	27+47.0	31+00.0	RT	3,466.5
RDY-02	28+29.2	28+49.6	LT	129.5
RDY-02	29+04.7	31+00.0	LT	1,727.4
RDY-03	31+00.0	35+05.0	RT	3,893.5
RDY-03	33+28.4	33+49.8	LT	109.2
RDY-03	33+84.2	34+23.9	LT	205.3
RDY-04	37+26.5	37+53.9	LT	147.5
RDY-04	38+00.1	38+30.9	LT	157.9
RDY-05	46+76.2	46+99.3	LT	89.5
RDY-05	46+04.9	46+20.5	RT	66.5
RDY-05	46+52.6	47+32.6	RT	293.4
TOTAL			11,351.0	

DETECTABLE WARNINGS SCHEDULE				
SHEET	FROM	TO	OFFSET	TOTAL (SQ FT)
RDY-01	21+19.00	21+24.00	LT	10.2
RDY-01	20+99.33	21+22.50	RT	25.8
RDY-02	27+43.62	27+51.12	LT	15.2
RDY-02	27+75.90	27+78.00	LT	10.0
RDY-02	28+15.48	28+17.68	LT	10.0
RDY-02	28+34.83	28+40.68	LT	10.8
RDY-03	33+44.05	33+46.05	LT	10.0
RDY-03	33+88.13	33+90.13	LT	10.0
RDY-04	37+49.79	37+51.79	LT	10.0
RDY-04	38+00.71	38+10.27	LT	17.7
RDY-05	46+90.98	46+98.77	LT	16.7
RDY-05	46+92.50	46+97.50	RT	10.0
TOTAL			155	

HOT-MIX ASPHALT SURFACE REMOVAL, 2" SCHEDULE					
SHEET	FROM	TO	TOTAL (SQ FT)	TOTAL (SQ YD)	NOTES
REM-01	29+05.00	29+45.00	2,186.5	242.9	FOR STAGES 2 AND 3
REM-01	30+55.00	31+00.00	2,243.7	249.3	FOR STAGES 2 AND 3
REM-01	21+03.00	25+00.00	25,007.2	2,778.6	FOR FINAL HMA SURFACE
REM-01	25+00.00	31+00.00	30,134.9	3,348.3	FOR FINAL HMA SURFACE
REM-02	31+00.00	37+00.00	33,120.1	3,680.0	FOR FINAL HMA SURFACE
REM-02	37+00.00	42+35.00	28,411.2	3,156.8	FOR FINAL HMA SURFACE
REM-03	46+79.11	47+06.52	765.1	85.0	FOR FINAL HMA SURFACE
TOTAL			13,541.0		

COMBINATION CURB AND GUTTER REMOVAL SCHEDULE					
SHEET	FROM	TO	OFFSET	TOTAL (FOOT)	TOTAL (SQ FT)
REM-01	21+13.57	62.48' LT	21+37.08	46.55' LT	28.6
REM-01	21+03.35	29.80' RT	21+35.09	26.00' RT	32.3
REM-01	27+43.41	42.61' LT	27+56.32	56.99' LT	19.1
REM-01	27+46.00	25.37' RT	31+00.00	26.14' RT	354.0
REM-01	27+69.60	43.94' LT	27+77.42	58.62' LT	16.7
REM-01	28+13.36	60.79' LT	28+28.50	43.83' LT	22.8
REM-01	28+32.05	63.55' LT	28+41.04	54.81' LT	12.6
REM-01	29+05.00	31.97' LT	31+00.00	26.63' LT	195.1
REM-02	31+00.00	26.14' RT	33+03.26	28.55' RT	203.3
REM-02	33+32.41	29.52' LT	33+52.85	51.65' LT	33.2
REM-02	33+80.99	51.65' LT	34+03.08	29.73' LT	34.6
REM-02	37+51.16	39.13' LT	37+55.99	50.97' LT	12.9
REM-02	37+95.98	50.28' LT	38+11.16	39.77' LT	18.6
REM-03	46+79.17	31.50' LT	47+02.47	44.09' LT	28.4
REM-03	46+02.20	25.26' RT	46+22.92	26.15' RT	20.7
REM-03	46+56.80	26.06' RT	46+76.10	25.95' RT	19.3
REM-03	46+87.01	25.88' RT	47+03.01	25.60' RT	16.0
TOTAL			1068.0		

SIDEWALK REMOVAL SCHEDULE					
SHEET	FROM	TO	OFFSET	TOTAL (SQ FT)	TOTAL (SQ YD)
REM-01	20+98.73	33.92' RT	21+28.59	37.02' RT	251.28
REM-01	21+28.01	52.48' LT	21+52.58	53.44' LT	98.59
REM-01	27+23.38	48.05' LT	27+59.23	65.73' LT	215.12
REM-01	27+47.00	31.05' RT	31+00.00	27+62' RT	1964.60
REM-01	27+72.77	47.01' LT	28+22.21	48.96' LT	258.54
REM-01	28+29.17	68.27' LT	28+49.55	61.84' LT	130.54
REM-01	29+04.67	38.30' LT	31+00.00	32.14' LT	1134.39
REM-02	31+00.00	27.72' RT	35+05.02	34.44' RT	2378.80
REM-02	33+28.37	32.79' LT	33+46.96	37.84' LT	69.41
REM-02	33+87.03	38.00' LT	34+23.92	37.84' LT	162.51
REM-02	37+39.29	45.87' LT	37+54.80	50.04' LT	71.74
REM-02	37+98.45	49.21' LT	38+30.88	46.88' LT	144.27
REM-03	46+76.08	35.39' RT	47+07.57	35.52' RT	156.08
REM-03	46+81.07	35.89' LT	46+99.48	41.84' LT	84.05
REM-03	46+52.60	30.80' RT	46+57.60	30.80' RT	25.00
TOTAL			7145		

CLASS D PATCHES, TYPE II, 8 INCH SCHEDULE					
SHEET	FROM	TO	TOTAL (SQ FT)	TOTAL (SQ YD)	NOTES
RDY-01	22+55.92	22+59.92	45.00	5.00	Stage 1
RDY-01	22+55.92	22+59.92	93.00	10.33	Stage 2
RDY-01	22+55.92	22+59.92	52.44	5.83	Stage 3
TOTAL			21		

COMB. CONC. CURB AND GUTTER, TYPE B-6.12 SCHEDULE					
SHEET	FROM	TO	OFFSET	TOTAL (FOOT)	NOTES
RDY-02	27+69.19	27+76.55	LT	16.80	
RDY-02	28+13.75	28+28.86	LT	22.80	
TOTAL			40.0		

COMB. CONC. CURB AND GUTTER, TYPE B-6.18 SCHEDULE					
SHEET	FROM	TO	OFFSET	TOTAL (FOOT)	NOTES
RDY-01	21+03.58	21+35.08	RT	32.11	
RDY-01	21+14.25	21+37.45	LT	28.20	
RDY-02	27+43.10	27+55.91	LT	18.95	
RDY-02	27+46.00	31+00.00	RT	354.00	
RDY-02	28+32.05	28+41.04	LT	12.56	
RDY-02	29+05.00	31+00.00	LT	195.18	
RDY-03	31+00.00	33+03.26	RT	203.26	
RDY-03	33+32.38	34+03.08	LT	66.20	
RDY-04	37+50.74	37+55.50	LT	12.67	
RDY-04	37+95.35	38+11.35	LT	18.39	
RDY-05	46+79.17	47+01.56	LT	27.26	
RDY-05	46+02.19	46+22.93	RT	20.73	
RDY-05	46+56.81	46+76.10	RT	19.30	
RDY-05	46+87.00	47+03.00	RT	16.00	
TOTAL			1025.0		

TEMPORARY SIDEWALK SCHEDULE					
SHEET	ALIGN	FROM	TO	TOTAL (SQ FT)	TOTAL (SQ YD)
MOT-06	ALPINE	27+55.00	32+00.00	2018.60	
MOT-07	ALPINE	32+00.00	33+22.30	588.00	
TOTAL			2607		

TEMPORARY PAVEMENT SCHEDULE						
SHEET	ALIGN	FROM	TO	TOTAL (SQ FT)	TOTAL (SQ YD)	
MOT-06	ALPINE	27+46.00	23.80' RT	32+00.00	27.80' RT	604.71
MOT-07	ALPINE	32+00.00	27.80' RT	33+03.26	28.04' RT	72.55
TOTAL			677			

PAVEMENT MARKING SCHEDULE														
SHEET	LOCATION					DESCRIPTION	AREA (SF)		PAY LENGTH (FOOT)					
							78000100	78000200	78000400	78000500	78000600	78000650		
							LTR-SYM	LINE - 4"	LINE - 6"	LINE - 8"	LINE - 12"	LINE - 24"		
PMK-01	21+17.0	LT	TO	21+17.0	RT	WHITE CROSSWALK BAR (SOUTH)			83.2					
PMK-01	21+17.0	LT	TO	21+17.0	RT	SECOND APPLICATION OF ABOVE			83.2					
PMK-01	21+23.0	LT	TO	21+23.0	RT	WHITE CROSSWALK BAR (NORTH)			78.2					
PMK-01	21+23.0	LT	TO	21+23.0	RT	SECOND APPLICATION OF ABOVE			78.2					
PMK-01	21+28.3	LT	TO	21+28.3	LT	WHITE STOP BAR								50.5
PMK-01	21+28.3	LT	TO	21+28.3	LT	SECOND APPLICATION OF ABOVE								50.5
PMK-01	21+27.3	RT	TO	29+93.0	RT	DOUBLE YELLOW CL		1,745.5						
PMK-01	21+29.3	LT	TO	22+48.0	LT	SOLID WHITE LINE				118.8				
PMK-01	21+29.3	LT	TO	22+48.0	LT	SOLID WHITE LINE				118.8				
PMK-01	21+29.3	LT	TO	31+00.0	LT	WHITE SKIP DASH		242.8						
PMK-01	21+29.3	RT	TO	31+00.0	RT	WHITE SKIP DASH		243.2						
PMK-01	21+47.0	LT	TO	21+55.0	LT	LEFT ARROW	15.6							
PMK-01	21+47.0	LT	TO	21+57.0	LT	THRU ARROW	12.3							
PMK-01	21+47.0	LT	TO	21+59.6	LT	THRU/RIGHT ARROW	24.3							
PMK-01	21+84.0	LT	TO	21+92.0	LT	LEFT ARROW	15.6							
PMK-01	22+21.0	LT	TO	22+29.0	LT	LEFT ARROW	15.6							
PMK-01	22+50.6	LT	TO	25+27.0	LT	DOUBLE YELLOW CL		560.3						
PMK-01	22+48.0	LT	TO	23+61.0	LT	WHITE SKIP DASH				37.7				
PMK-01	22+48.0	LT	TO	25+27.0	LT	YELLOW DIAGONAL SET					95.5			
PMK-01	27+48.4	LT	TO	27+70.9	LT	WHITE CROSSWALK BAR (EAST)			22.6					
PMK-01	27+54.2	LT	TO	27+74.4	LT	WHITE CROSSWALK BAR (WEST)			20.2					
PMK-01	27+57.7	LT	TO	27+76.8	LT	WHITE STOP BAR								19.2
PMK-01	28+19.1	LT	TO	28+32.6	LT	WHITE CROSSWALK BAR (WEST)			14.8					
PMK-01	28+23.4	LT	TO	28+37.1	LT	WHITE CROSSWALK BAR (EAST)			15.1					
PMK-01	29+93.0	LT	TO	31+00.0	LT	DOUBLE YELLOW CL		214.1						
PMK-01	29+93.0	RT	TO	31+00.0	RT	DOUBLE YELLOW CL		214.1						
PMK-01	30+58.5	CT	TO	31+00.0	CT	YELLOW DIAGONAL SET					11.5			
PMK-02	31+00.0	CT	TO	32+93.0	CT	YELLOW DIAGONAL SET					65.6			
PMK-02	31+00.0	RT	TO	32+93.0	RT	DOUBLE YELLOW CL		387						

NOTES:

1. THE STOP BAR AND CROSSWALK AT MORSAY DRIVE SHALL REQUIRE TWO APPLICATIONS: ONCE WHEN THE SIDEWALK RAMPS AND SIGNAL WORK HAVE BEEN COMPLETED AND ONCE AFTER ALPINE ROAD HAS BEEN RESURFACED.

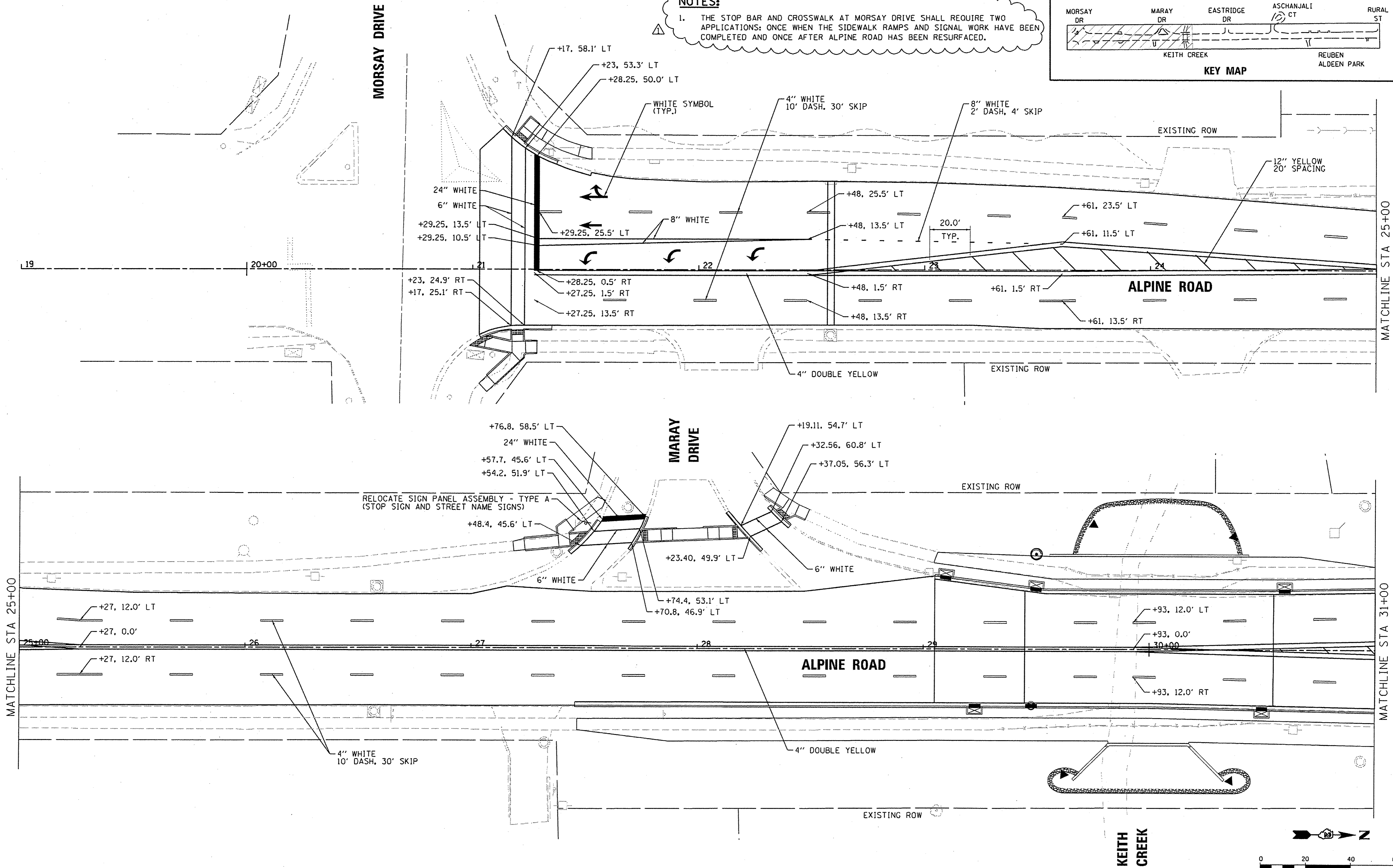
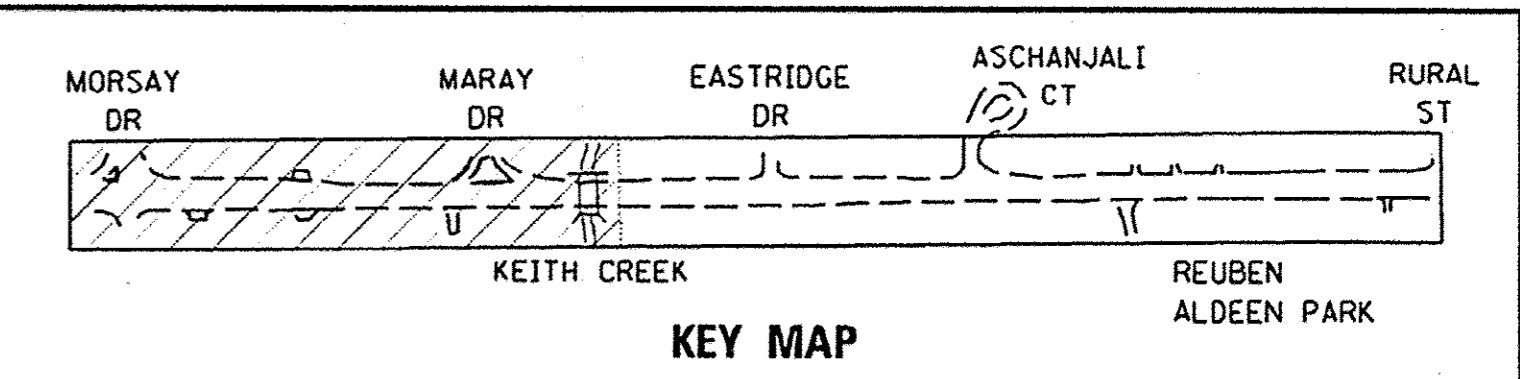

MATCHLINE STA 25+00

MATCHLINE STA 25+00

MATCHLINE STA 31+00

DESIGNED	KAS	12/30/16
DRAWN	MWH	4/18/17
REVIEWED	KMA	4/18/17

FILE NAME = 14L0113-shr-pmk-01.dgn	USER NAME = ande-02833	DESIGNED - KAS	REVISED - REV. 6/6/2017
		DRAWN - MWH	REVISED -
		CHECKED - KMA	REVISED -
		DATE - 4/19/17	REVISED -

**STATE OF ILLINOIS
 DEPARTMENT OF TRANSPORTATION**

PAVEMENT MARKING AND SIGNING PLAN

SCALE: 1" = 20' SHEET NO. OF SHEETS STA. TO STA.

F.A.P. RTE. 0412	SECTION 14-00609-00-BR	COUNTY WINNEBAGO	TOTAL SHEETS 89	SHEET NO. 47
				CONTRACT NO. 85656



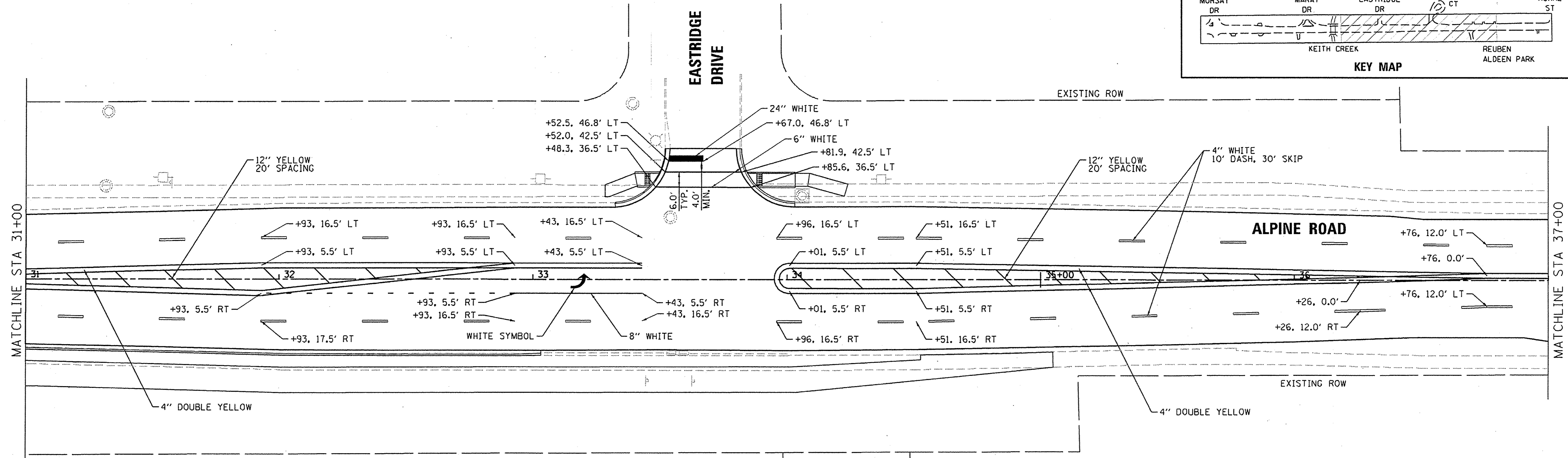
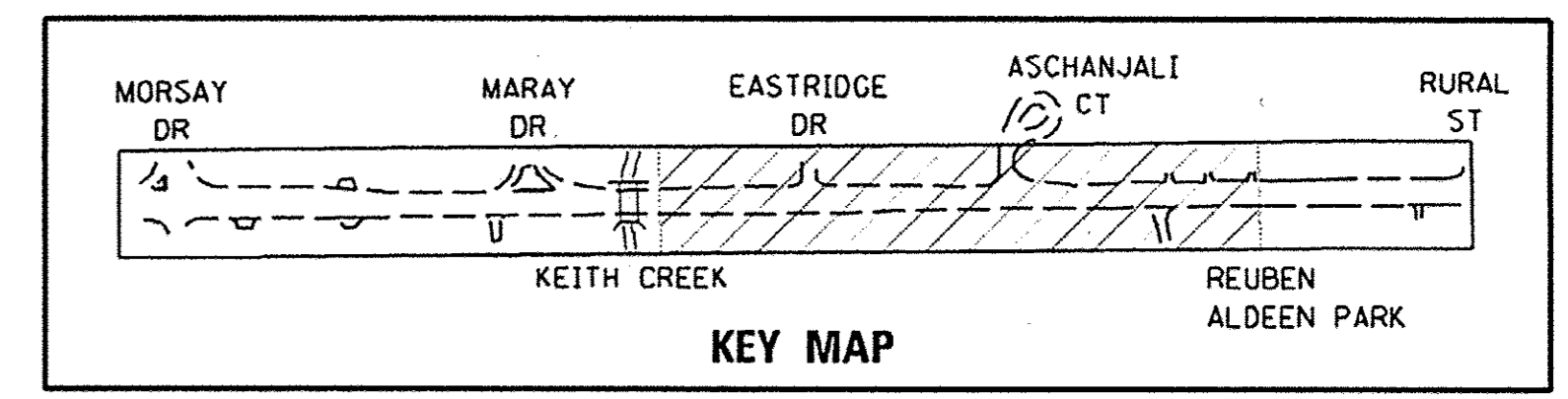

NOTES:
 1. THE CROSSWALK AT ASCHANJALI COURT SHALL REQUIRE TWO APPLICATIONS: ONCE WHEN THE SIDEWALK RAMPS HAVE BEEN COMPLETED AND ONCE AFTER ALPINE ROAD HAS BEEN RESURFACED.

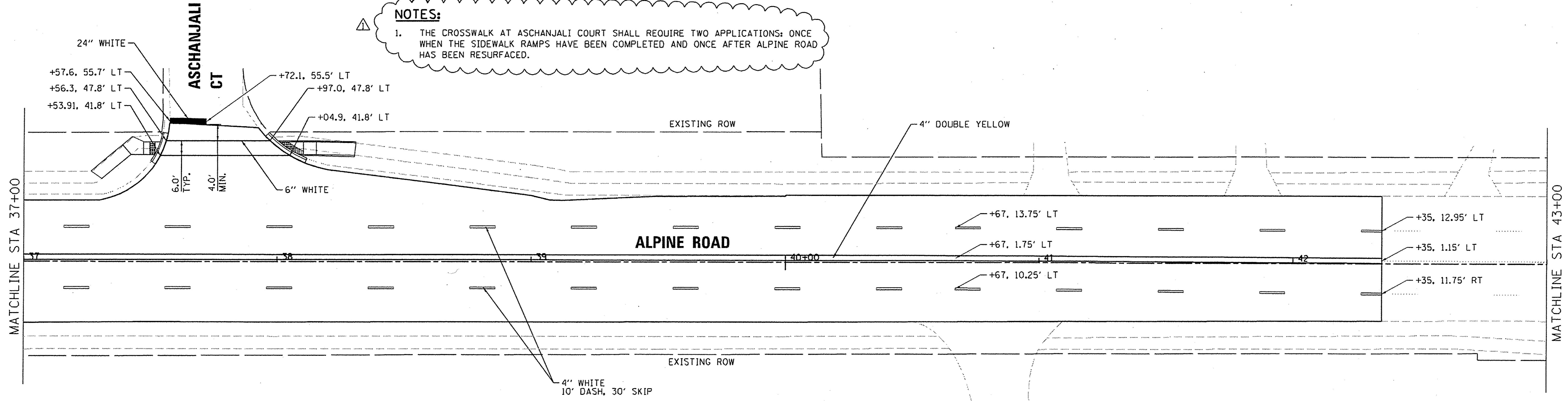

REUBEN ALDEEN PARK

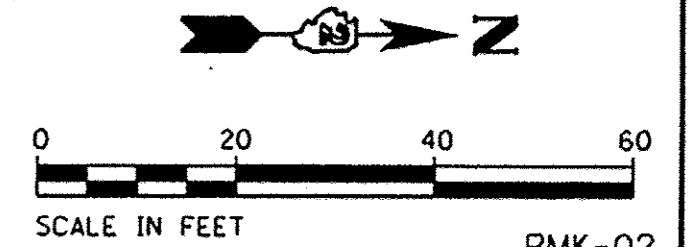

DESIGNED	KAS	12/30/16
DRAWN	MWH	4/18/17
REVIEWED	KMA	4/18/17

FILE NAME = 14L0113-shr-pmk-02.dgn	USER NAME = andr-20833	DESIGNED - KAS	REVISED - REV. 6/6/2017
		DRAWN - MWH	REVISED -
		CHECKED - KMA	REVISED -
		DATE - 4/19/17	REVISED -

**STATE OF ILLINOIS
 DEPARTMENT OF TRANSPORTATION**

PAVEMENT MARKING AND SIGNING PLAN

SCALE: 1" = 20' SHEET NO. OF SHEETS STA. TO STA.

F.A.P. RTE. 0412	SECTION 14-00609-00-BR	COUNTY WINNEBAGO	TOTAL SHEETS 89	SHEET NO. 48
				CONTRACT NO. 85656
ILLINOIS FED. AID PROJECT				