

F.A.U. RTE.	SECTION	COUNTY	TOTAL SHEETS	SHEET NO.
3545	54 WRS-7	DuPage	235	80
STA. 254+24		TO STA. 267+00		
FED. ROAD DIST. NO.	ILLINOIS		FED. AID PROJECT	

CONTRACT NO. 62291

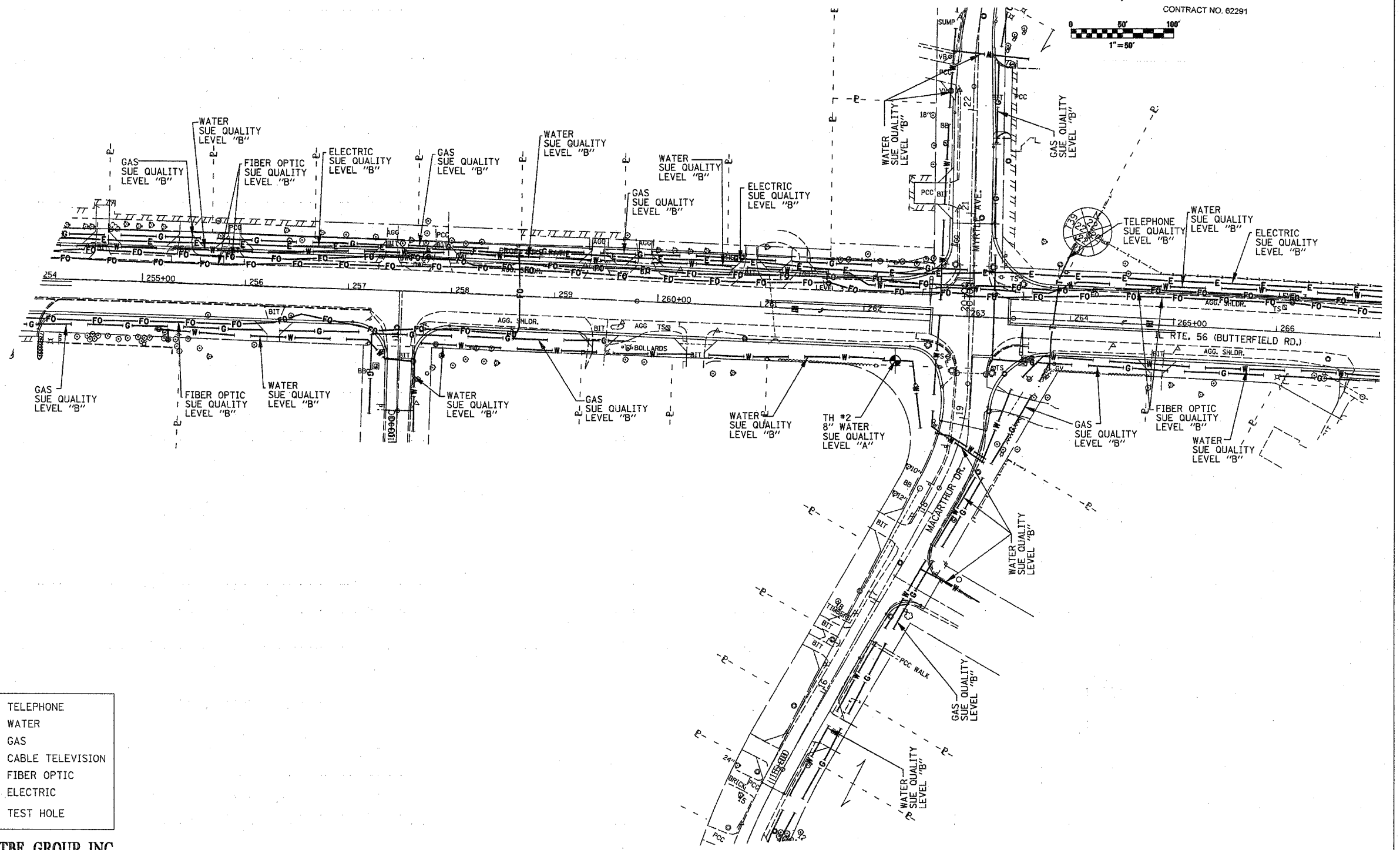
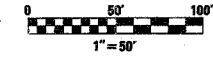

— T — T —	TELEPHONE
— W — W —	WATER
— G — G —	GAS
— CTV — CTV —	CABLE TELEVISION
— FO — FO —	FIBER OPTIC
— E — E —	ELECTRIC
⊙	TEST HOLE

**TBE GROUP, INC.**  
 CIVIL ENGINEERING \* TRANSPORTATION \* ENVIRONMENTAL  
 \* PLANNING \* UTILITY ENGINEERING/LOCATING  
 SOUTHERN REGION: FL, GA, SC, NC  
 NORTHERN REGION: IL, IN, MI, OH, MD, NJ, NY  
 PA, VA, CANADA  
 WESTERN REGION: AZ, NV, NM, TX, CA, OR, UT, WA

IL09500159, IL09500173  
 TBE SUE PAGE NO: 4 of 7  
 Checked by: *S. J. [Signature]*  
 SUE Quality Level "A" : Test Holes  
 SUE Quality Level "B" : Designating

Utilities shown on these plans as depicted in the legend have been investigated by TBE Group, Inc in accordance with SUE Industry Standards. All other information shown has been provided to TBE Group, Inc by others.

 205 W. WACKER DRIVE SUITE 1020 CHICAGO, IL 60606 (312) 704-1970	REVISIONS		ILLINOIS DEPARTMENT OF TRANSPORTATION  SUE Investigation of Underground Utilities IL RT. 56 (Butterfield Rd.) West of Summit Road to IL RT. 83 Contract No.: 62291  SOL "A" DATE : 8/26/03 SOL "B" DATE : 2/24/03
	NAME	DATE	
DRAWN BY : KLC		SCALE : 1" = 50'	