

F.A.U. RTE.	SECTION	COUNTY	TOTAL SHEETS	SHEET NO.
3545	54-WRS-7	DUPAGE	235	208
STA. 276+00		TO STA. 277+00		
FED. ROAD DIST. NO.		ILLINOIS FED. AID PROJECT		
CONTRACT NO.: 62291				

IL ROUTE 56

DATE: \_\_\_\_\_  
 BY: \_\_\_\_\_  
 CHECKED: \_\_\_\_\_  
 APPROVED: \_\_\_\_\_  
 TITLE: \_\_\_\_\_  
 ORIGINAL SURVEY: \_\_\_\_\_  
 NOTE BOOK: \_\_\_\_\_  
 AREAS CHECKED: \_\_\_\_\_  
 M.P.: \_\_\_\_\_

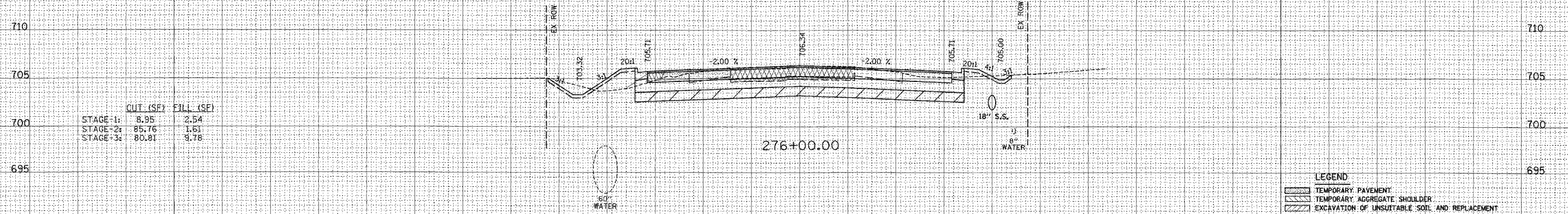
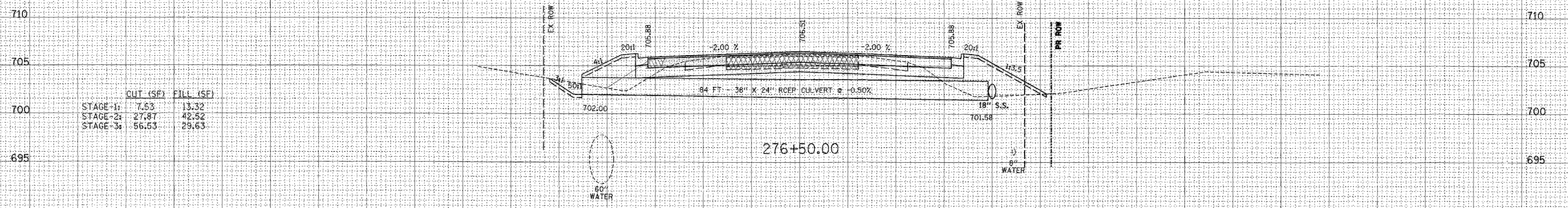
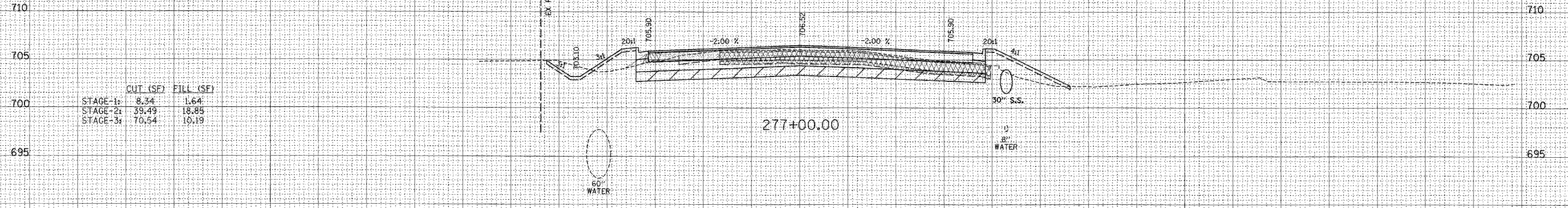

**LEGEND**  
 TEMPORARY PAVEMENT  
 TEMPORARY AGGREGATE SHOULDER  
 EXCAVATION OF UNSUITABLE SOIL AND REPLACEMENT WITH POROUS GRANULAR EMBANKMENT, SPECIAL

DATE: \_\_\_\_\_  
 BY: \_\_\_\_\_  
 CHECKED: \_\_\_\_\_  
 APPROVED: \_\_\_\_\_  
 TITLE: \_\_\_\_\_  
 ORIGINAL SURVEY: \_\_\_\_\_  
 NOTE BOOK: \_\_\_\_\_  
 AREAS CHECKED: \_\_\_\_\_  
 M.P.: \_\_\_\_\_