

F.A.J. RTE.	SECTION	COUNTY	TOTAL SHEETS	SHEET NO.
3545	54-WRS-7	DUPAGE	235	225
STA. 102+14.55		TO STA. 102+75.09		
FED. ROAD DIST. NO.		ILLINOIS	FED. AID PROJECT	
CONTRACT NO. 62291				

B SUMMIT AVENUE

DATE: _____
 SURVEYED BY: _____
 CHECKED BY: _____
 DATE: _____
 SURVEYED BY: _____
 CHECKED BY: _____

DATE: _____
 SURVEYED BY: _____
 CHECKED BY: _____
 DATE: _____
 SURVEYED BY: _____
 CHECKED BY: _____

	CUT (SF)	FILL (SF)
STAGE-1:		
STAGE-2:		
STAGE-3:	0.00	0.00

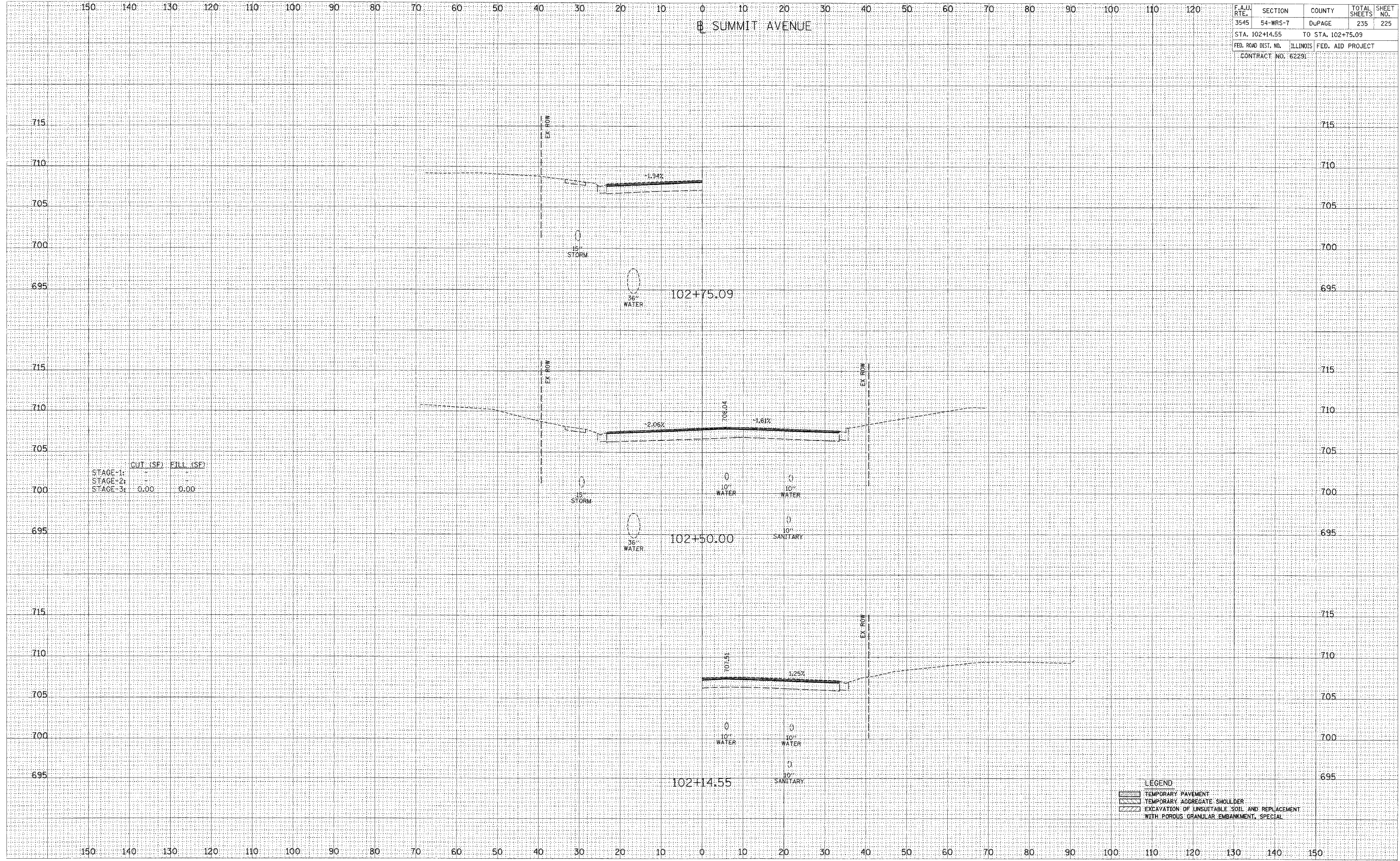

LEGEND
 [Symbol] TEMPORARY PAVEMENT
 [Symbol] TEMPORARY AGGREGATE SHOULDER
 [Symbol] EXCAVATION OF UNSUITABLE SOIL AND REPLACEMENT WITH POROUS GRANULAR EMBANKMENT, SPECIAL