

F.A.U. RITE	SECTION	COUNTY	TOTAL SHEETS	SHEET NO.
3545	54-WRS-7	DUPAGE	235	227
STA. 103+80.17		TO STA. 104+50		
FED. ROAD DIST. NO.	ILLINOIS	FED. AID PROJECT		
CONTRACT NO. 62291				

B SUMMIT AVENUE

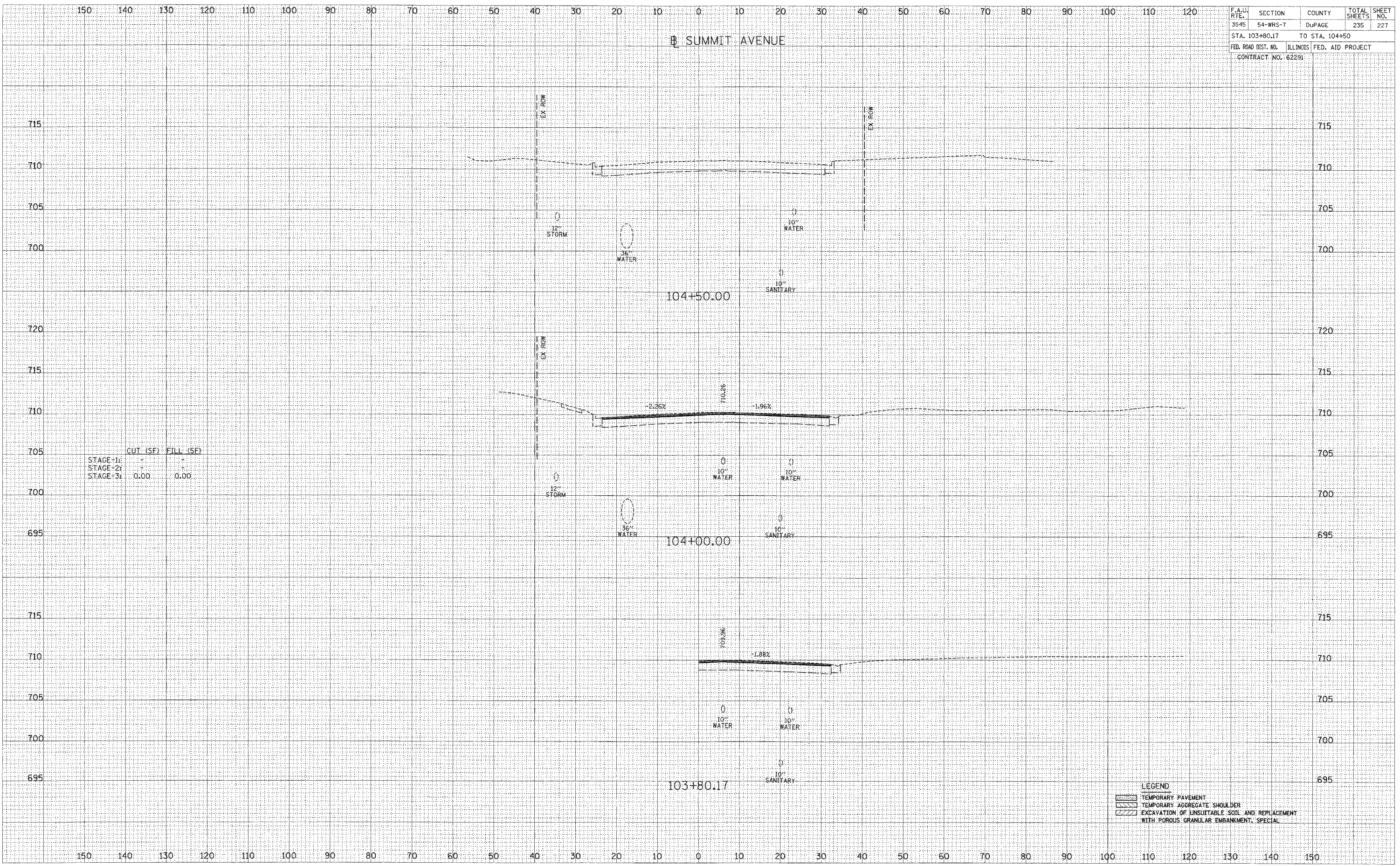

FINAL SURVEY  
SURVEYED  
PLOTTED  
NOTE BOOK  
AREAS CHECKED

ORIGINAL SURVEY  
SURVEYED  
PLOTTED  
NOTE BOOK  
AREAS CHECKED

	CUT (SF)	FILL (SF)
STAGE-1:	-	-
STAGE-2:	-	-
STAGE-3:	0.00	0.00

LEGEND

[Symbol]	TEMPORARY PAVEMENT
[Symbol]	TEMPORARY AGGREGATE SHOULDER
[Symbol]	EXCAVATION OF UNSUITABLE SOIL AND REPLACEMENT WITH POROUS GRANULAR ENHANCEMENT, SPECIAL