

PROPOSED LEGEND

△ NEW STRUCTURE

○ NEW STORM PIPE

EXISTING CONDITIONS

PROPOSED IMPROVEMENT

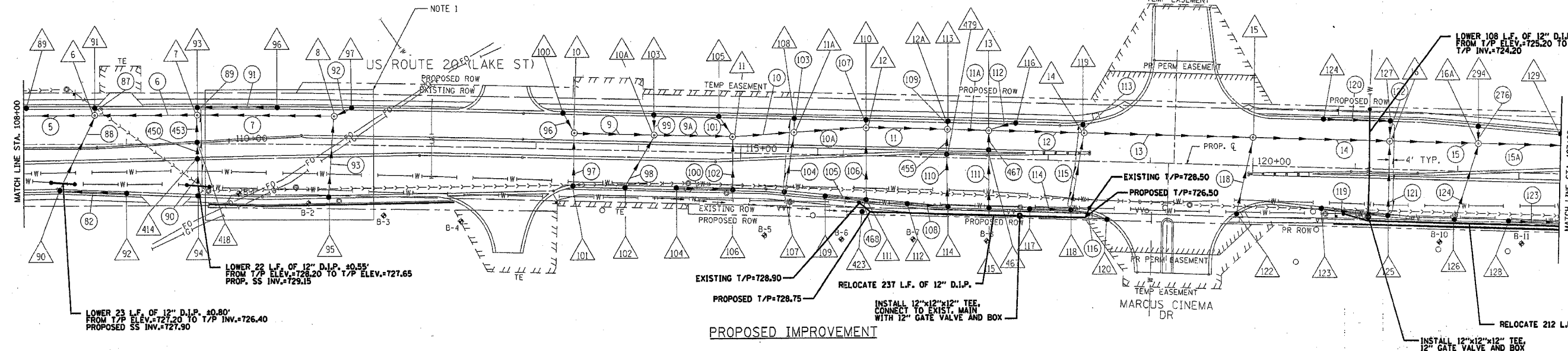

NOTE

1. WARNING (PETROLEUM PRODUCTS PIPELINES)
 EXCAVATION AND CONSTRUCTION PROHIBITED WITHOUT
 WRITTEN PERMISSION FROM WILLIAMS PIPE LINE COMPANY
 ONE WILLIAMS CENTER, TULSA, OK
 (918) 573-3373 OR (800) 331-4020

DATE: _____ BY: _____

PLAN

DESIGNED: _____
 CHECKED: _____
 ALIGNED: _____
 CADD FILE NAME: _____
 NO. _____

DATE: _____ BY: _____

PROFILE

DESIGNED: _____
 CHECKED: _____
 GRADES: _____
 STRUCTURE: _____
 NOTATION: CHD
 NO. _____

SHEET 3 OF 19

REVISIONS	
NAME	DATE

ILLINOIS DEPARTMENT OF TRANSPORTATION

PROPOSED WATERMAIN RELOCATIONS
 STA. 108+00 STA. 123+00
 U.S. ROUTE 20 (LAKE ST.)

SCALE: VERT. 1"=5'
 HORIZ. 1"=50'
 DATE: 03/01/05

DRAWN BY J.R.H.
 CHECKED BY J.R.S.

△ Added 6/3/05